

PHASING DIAGRAM

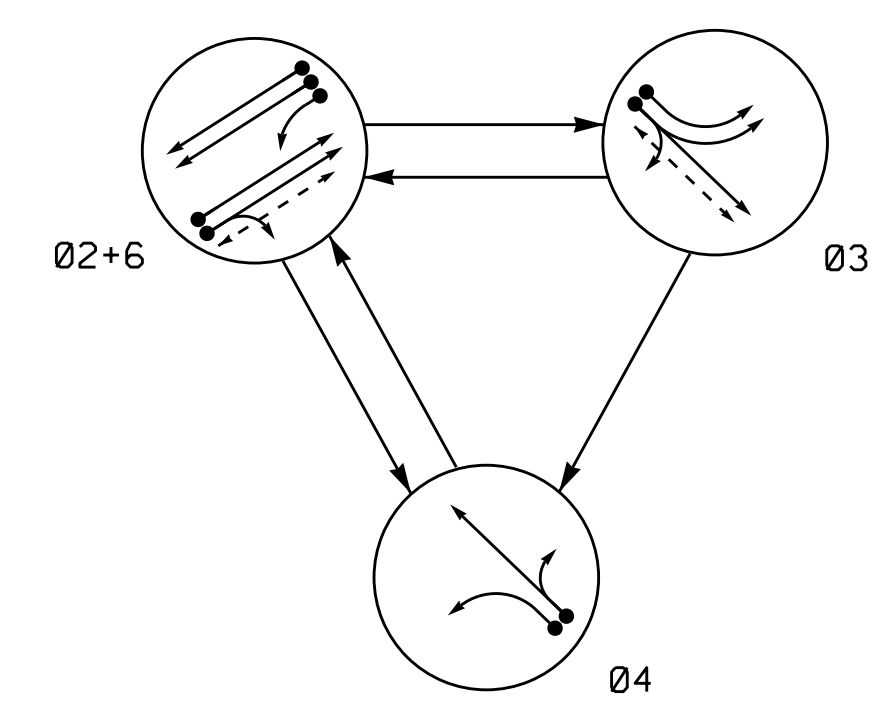

PHASING DIAGRAM DETECTION LEGEND

- DETECTED MOVEMENT
- UNDETECTED MOVEMENT (OVERLAP)
- UNSIGNALIZED MOVEMENT
- PEDESTRIAN MOVEMENT

TABLE OF OPERATION

SIGNAL FACE	PHASE			
	02+6	03	04	FLIGHT
21,22	G	R	R	Y
31	R	G	R	R
32	R	G	R	R
41	R	R	G	R
42	R	R	G	R
61,62	G	R	R	Y
P21,P22	W	DW	DW	DRK
P31,P32	DW	W	DW	DRK

SIGNAL FACE I.D.

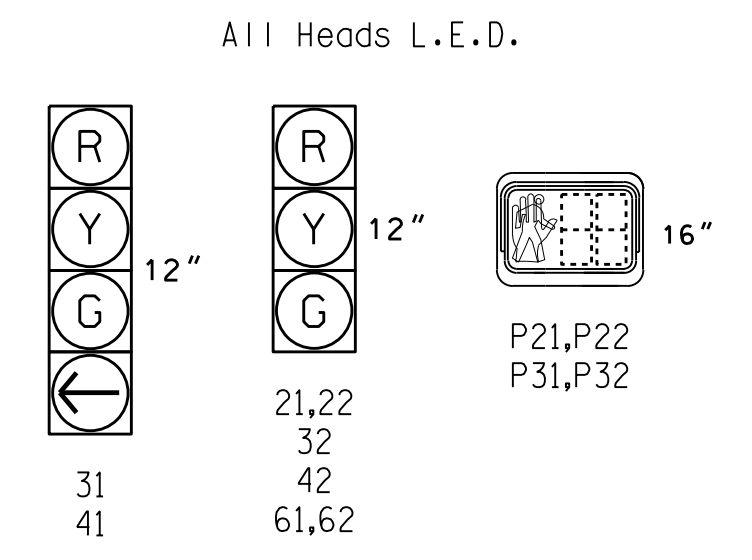

OASIS 2070 LOOP & DETECTOR INSTALLATION CHART

LOOP	SIZE (FT)	DISTANCE FROM STOPBAR (FT)	TURNS	NEW LOOP	DETECTOR PROGRAMMING				SYSTEM LOOP	NEW CARD	
					PHASE	CALLING	EXTENSION	FULL TIME DELAY			
2A,2B	6x6	70	3	Y	2	Y	Y	-	-	-	Y
3A	6x40	0	2-4-2	Y	3	Y	Y	-	-	-	Y
3B	6x40	0	2-4-2	Y	3	Y	Y	-	-	5	Y
4A	6x40	0	2-4-2	Y	4	Y	Y	-	-	3	Y
4B	6x40	0	2-4-2	Y	4	Y	Y	-	-	10	Y
6A,6B	6x6	70	3	Y	6	Y	Y	-	-	-	Y
6C	6x40	0	2-4-2	Y	6	Y	Y	-	-	-	Y
S15	6x6	+130	3	Y	-	-	-	-	-	-	Y
S16	6x6	+130	3	Y	-	-	-	-	-	-	Y
S17	6x6	+130	3	Y	-	-	-	-	-	-	Y
S18	6x6	70*	3	Y	-	-	-	-	-	-	Y

\*Loop located on free right turn ramp adjacent to loops 6A and 6B.

3 Phase Fully Actuated NC 18-268 (2nd St) CLS

NOTES

- Refer to "Roadway Standard Drawings NCDOT" dated January 2012 and "Standard Specifications for Roads and Structures" dated January 2012.
- Do not program signal for late night flashing operation unless otherwise directed by the Engineer.
- The order of phase 3 and phase 4 may be reversed.
- Set all detector units to presence mode.
- In the event of loop replacement, refer to the current ITS and Signals Design Manual and submit a Plan of Record to the Signal Design Section.
- Omit "WALK" and flashing "DON'T WALK" with no pedestrian calls.
- Program pedestrian heads to countdown the flashing "Don't Walk" time only.
- Pedestrian pedestals are conceptual and shown for reference only. See sheets P1-P3 for pushbutton location details.
- Pavement markings are existing.
- Maximum times shown in timing chart are for free-run operation only. Coordinated signal system timing values supersede these values.
- Closed loop system data: Controller Asset #0979.

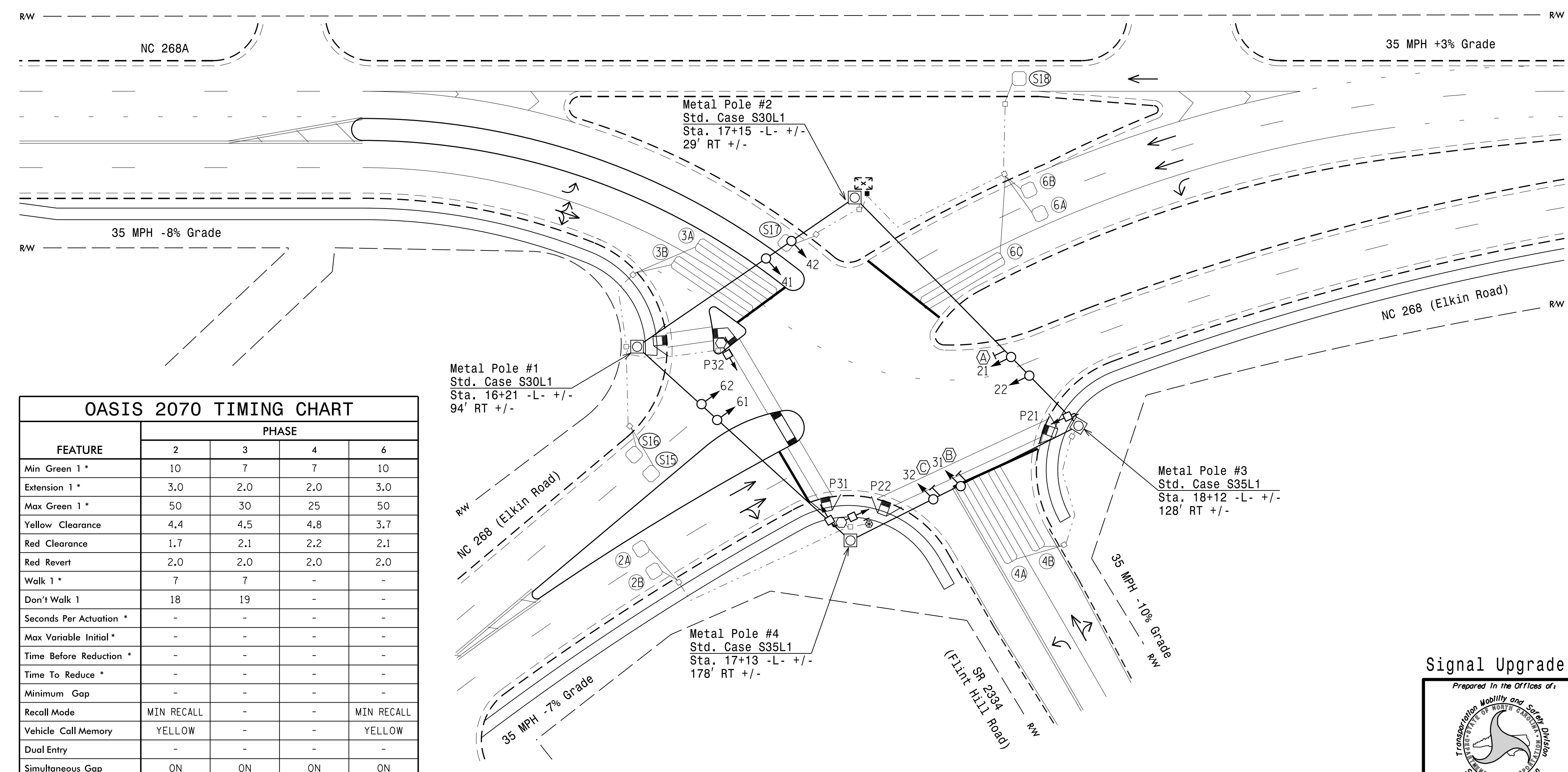

OASIS 2070 TIMING CHART

FEATURE	PHASE			
	2	3	4	6
Min Green 1 *	10	7	7	10
Extension 1 *	3.0	2.0	2.0	3.0
Max Green 1 *	50	30	25	50
Yellow Clearance	4.4	4.5	4.8	3.7
Red Clearance	1.7	2.1	2.2	2.1
Red Revert	2.0	2.0	2.0	2.0
Walk 1 *	7	7	-	-
Don't Walk 1	18	19	-	-
Seconds Per Actuation *	-	-	-	-
Max Variable Initial *	-	-	-	-
Time Before Reduction *	-	-	-	-
Time To Reduce *	-	-	-	-
Minimum Gap	-	-	-	-
Recall Mode	MIN RECALL	-	-	MIN RECALL
Vehicle Call Memory	YELLOW	-	-	YELLOW
Dual Entry	-	-	-	-
Simultaneous Gap	ON	ON	ON	ON

\* These values may be field adjusted. Do not adjust Min Green and Extension times for phases 2 and 6 lower than what is shown. Min Green for all other phases should not be lower than 4 seconds.

LEGEND

- | PROPOSED  | EXISTING  |
|---|---|
| ○ → Traffic Signal Head                               | ● → Traffic Signal Head                               |
| ○ → Modified Signal Head                              | N/A   |
| ○ → Signal Pole with Guy                              | ○ → Signal Pole with Guy                              |
| ○ → Signal Pole with Sidewalk Guy                     | ○ → Signal Pole with Sidewalk Guy                     |
| □ → Inductive Loop Detector                           | □ → Inductive Loop Detector                           |
| □ → Controller & Cabinet                              | □ → Controller & Cabinet                              |
| □ → Junction Box                                      | □ → Junction Box                                      |
| --- 2-in Underground Conduit                          | --- 2-in Underground Conduit                          |
| N/A   | → Right of Way  |
| → Directional Arrow                                   | → Directional Arrow                                   |
| ○ → Metal Strain Pole                                 | ○ → Metal Strain Pole                                 |
| ⊗ → Type I Pushbutton Post                            | ⊗ → Type I Pushbutton Post                            |
| ○ → Type II Signal Pedestal                           | ○ → Type II Signal Pedestal                           |
| ○ → Pedestrian Signal Head                            | ○ → Pedestrian Signal Head                            |
| + → Push Button & Sign                                | + → Push Button & Sign                                |
| Ⓐ → No Left Turn Sign (R3-2)                          | Ⓐ → No Left Turn Sign (R3-2)                          |
| Ⓑ → Left Arrow "ONLY" Sign (R3-5L)                    | Ⓑ → Left Arrow "ONLY" Sign (R3-5L)                    |
| Ⓒ → Left / Through / Right Arrow Sign (Modified R3-6) | Ⓒ → Left / Through / Right Arrow Sign (Modified R3-6) |

Signal Upgrade - Final Design

Prepared In the Offices of:

TRANSPORTATION MOBILITY AND SAFETY DIVISION  
 NORTH CAROLINA DEPARTMENT OF TRANSPORTATION  
 SIGNAL DESIGN SECTION

750 N. Greenfield Pkwy, Garner, NC 27529

NC 268 (Elkin Road) at NC 268A / SR 2334 (Flint Hill Road)

Division 11 Wilkes County North Wilkesboro

PLAN DATE: December 2014 REVIEWED BY: Z.M. Little

PREPARED BY: C.L. Sweeney REVIEWED BY:

REVISIONS: \_\_\_\_\_ INIT. DATE

SCALE: 1"=30'

DocuSigned by: *Carlynn M. Little* 1/29/2015

SIG. INVENTORY NO. 11-0979

09-1116-2015 1:22:30  
 R:\Projects\2015\11-0979\Signal Design\11-0979-Sig-050-201412.dwg  
 ZML:llt