

PROJECT NOTES

- TP YELLOW DIAGONAL (8", 90 MIL)
- UA LEFT TURN ARROW (90MIL)
- UB RIGHT TURN ARROW (90MIL)
- VA WHITE EDGELINE (4")
- VC 10 FT. WHITE SKIP (4")
- VD 3FT.-9FT./SP WHITE MINISKIP (4")
- VI YELLOW DOUBLE CENTER (4")

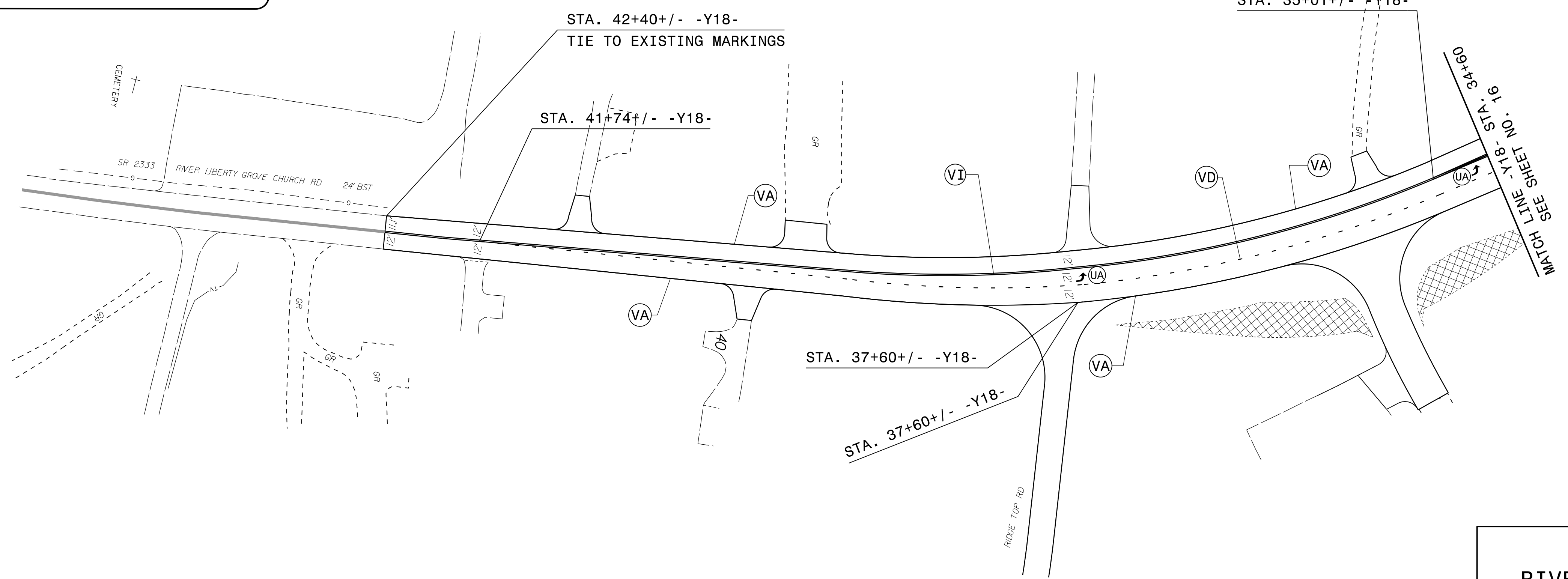
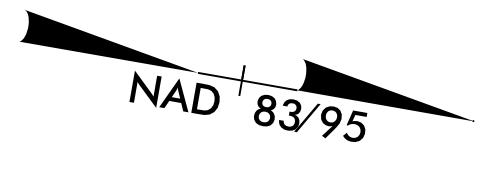

**AIRPORT RD AND
RIVER LIBERTY GROVE CHURCH RD
PAVEMENT MARKING DETAIL**