

RW SHEET NO.

ROADWAY DESIGN ENGINEER

DAVID BURKE EVANS

PROFESSIONAL ENGINEER

SEAL 19724

DocuSigned by:
David Burke
8/10/2015

M A Engineering Consultants, Inc.

NC License: F-0160

598 East Chatham Street Suite 137 Cary, NC 27511
Phone: 919.297.0220 Fax: 919.297.0221

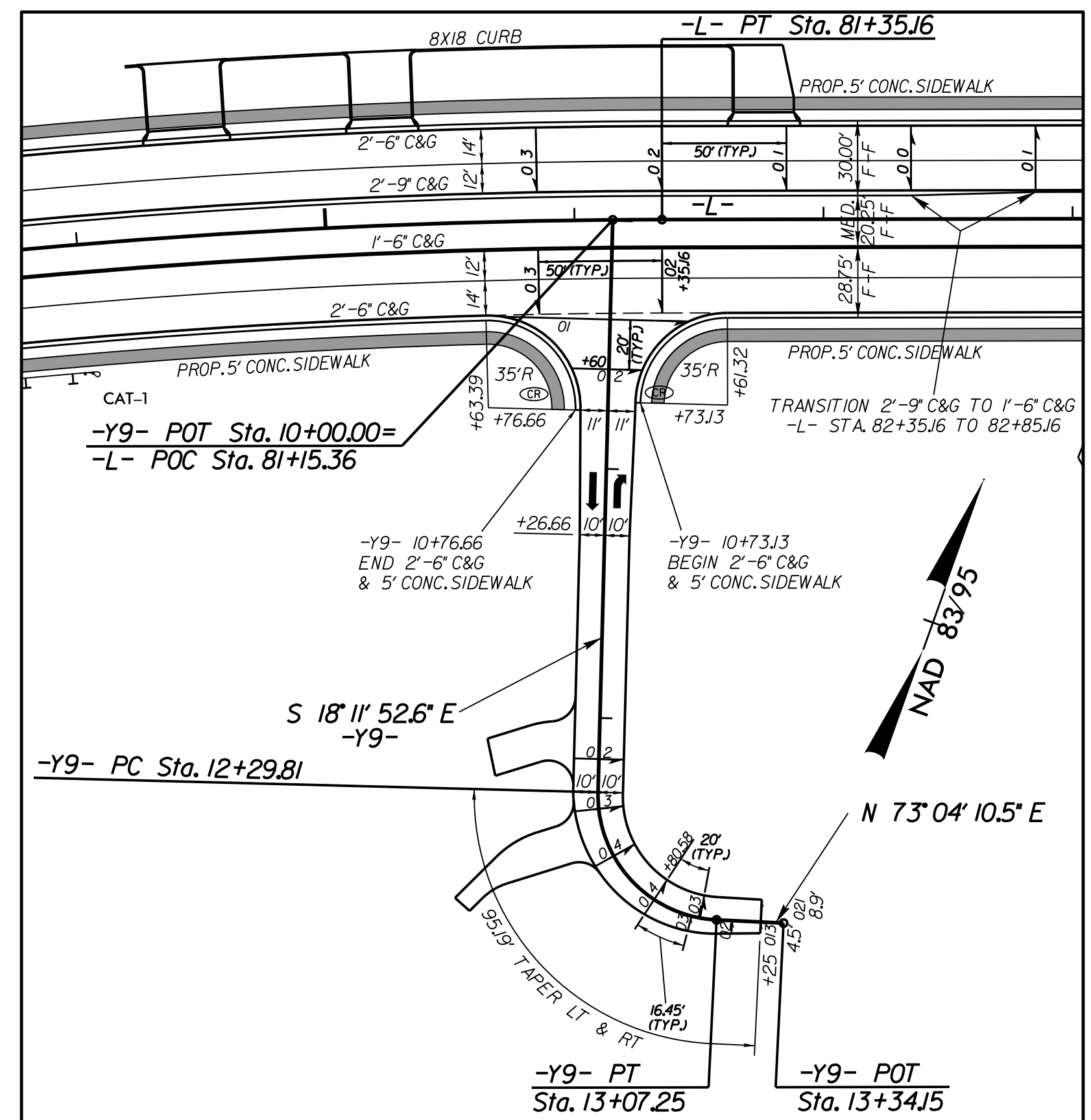
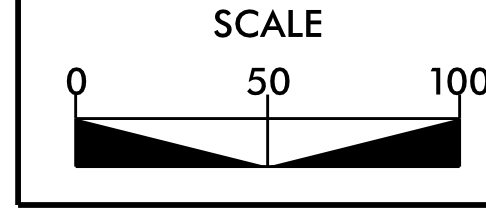

NC 268 (-L-) ELKIN RD. /
SIDNEY AVE. (-Y9-) INTERSECTION DETAIL
SEE SHEET 9 FOR PLAN VIEW

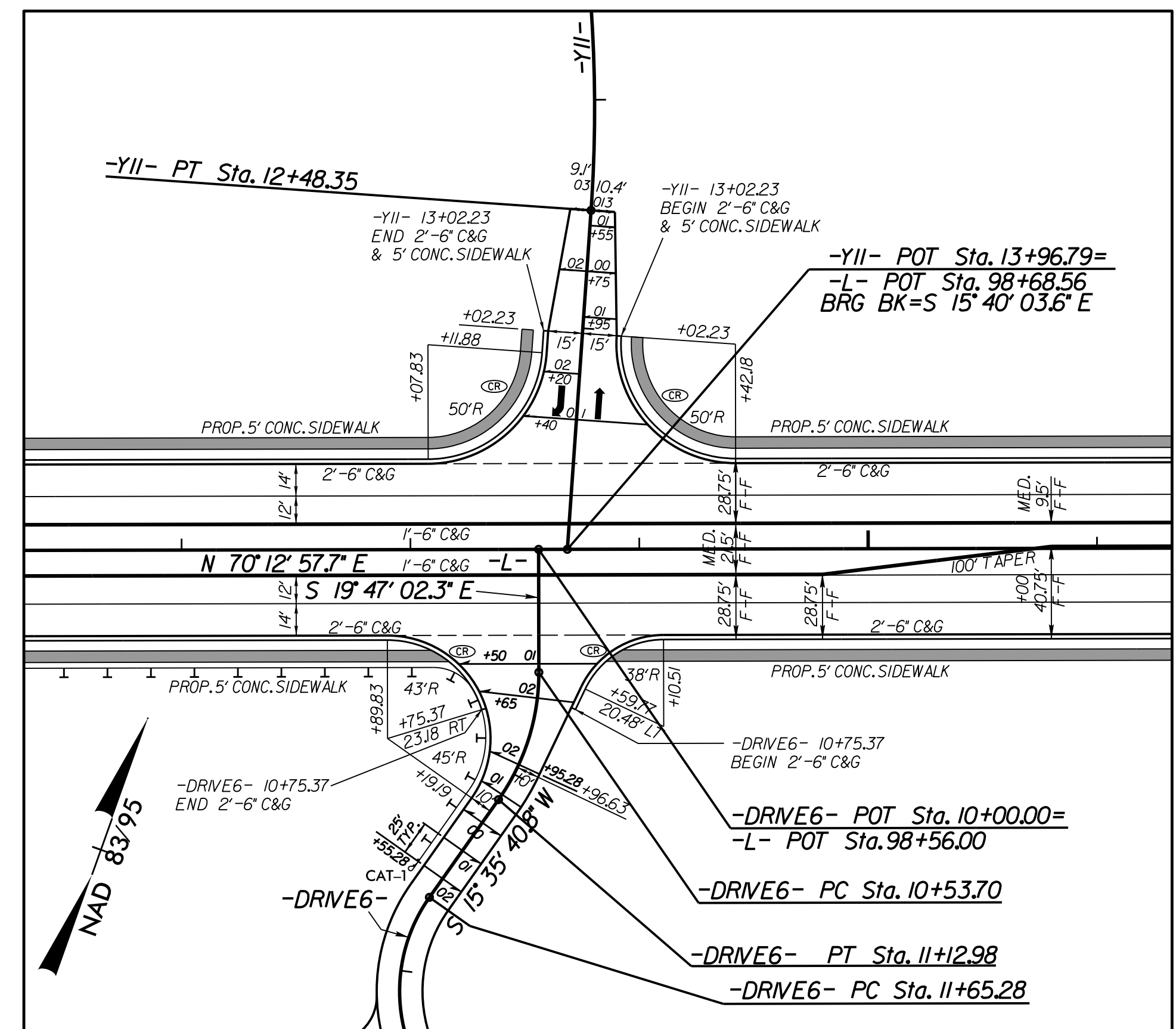

NC 268 (-L-) ELKIN RD. /
AARON CALL RD. (-Y11-) INTERSECTION DETAIL
SEE SHEET 10 FOR PLAN VIEW

INTERSECTION DETAILS

NOTE:
LOCATIONS OF WHEELCHAIR RAMP SYMBOLS (♿) ARE APPROXIMATE. REFER TO THE PAVEMENT MARKING PLANS FOR EXACT LOCATIONS.

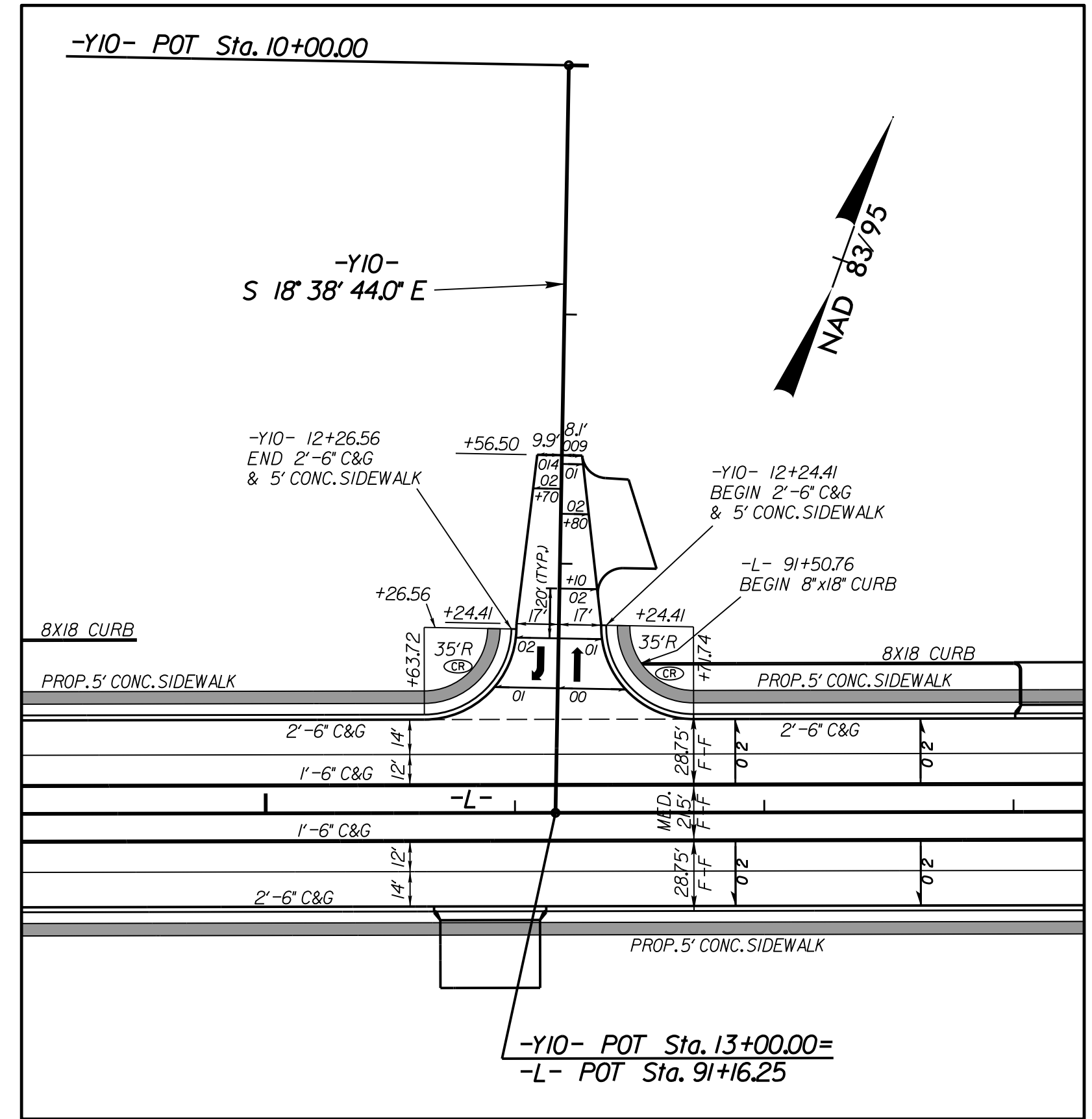

NC 268 (-L-) ELKIN RD. /
PEBBLE ST. (-Y10-) INTERSECTION DETAIL
SEE SHEET 9 FOR PLAN VIEW

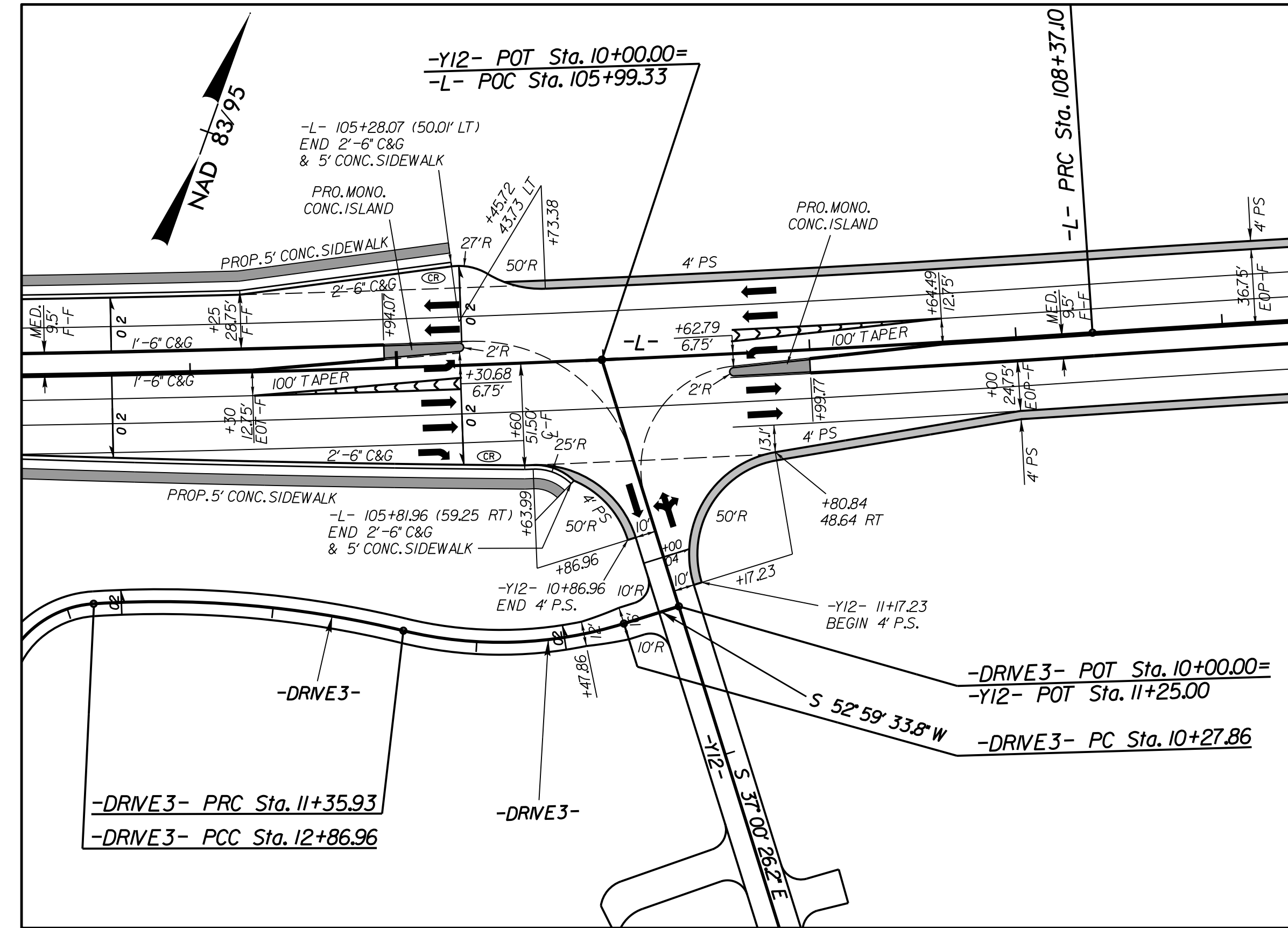

NC 268 (-L-) ELKIN RD. /
FLINT HILL RD. (-Y12-) INTERSECTION DETAIL
SEE SHEET 11 FOR PLAN VIEW

8/17/15

7/2/2015 11:53:30 AM pr-oj\p2603-Rdy-sh02B-07.dgn