



STATE OF NORTH CAROLINA
DEPARTMENT OF TRANSPORTATION

PAT MCCRORY
GOVERNOR

NICHOLAS J. TENNYSON
SECRETARY

September 4, 2015

Addendum No. 1

RE: Contract ID C203755

WBS # 2016CPT.03.03.10651, 41867.3.2

F. A. # STPNHS-0421(46)

New Hanover County (W-5103A)

US-421 From Bridge #30 To North Of George Anderson Avenue

September 15, 2015 Letting

To Whom It May Concern:

Reference is made to the plans and proposal form furnished to you on this project.

The following revisions have been made to the Roadway plans:

Sheet No.	Revisions
3D-6	Revise drainage summary to reflect the below noted drainage quantity changes
23	Added drainage Str. # 2301

Please void the above listed sheets in your plans and staple the revised sheets thereto.

The following revisions have been made to the proposal:

Page No.	Revisions
Proposal Cover	Note added that reads "Includes Addendum No. 1 Dated September 4, 2015".
R-30 & New R-31	Added the project special provision entitled "Shoulder Reconstruction Per Shoulder Mile"

Please void the above listed pages in your proposal and staple the revised pages thereto.

Please staple New Page No. R-31 after revised Page No. R-30.

MAILING ADDRESS:
NC DEPARTMENT OF TRANSPORTATION
CONTRACT STANDARDS AND DEVELOPMENT UNIT
1591 MAIL SERVICE CENTER
RALEIGH NC 27699-1591

TELEPHONE: 919-707-6900
FAX: 919-250-4119

WEBSITE: www.ncdot.gov

LOCATION:
CENTURY CENTER COMPLEX
ENTRANCE B-2
1020 BIRCH RIDGE DRIVE
RALEIGH NC 27610

On the item sheets the following pay item changes have been made:

<u>Item</u>	<u>Description</u>	<u>Old Quantity</u>	<u>New Quantity</u>
046-2286000000-N-840	Masonry Drainage Structures	121 EA	122 EA
048-2364000000-N-840	Frame With Two Grates, STD 840.16	52 EA	53 EA
055-2440000000-N-852	Concrete Transitional Section For Catch Basin	13 EA	14 EA
128-0225000000-E-SP	Generic Grading Item Aggregate Shoulder Borrow	NEW ITEM	1,671 TON
129-1245000000-E-SP	Shoulder Reconstruction	NEW ITEM	10.76 SMI

The Contractor's bid must include these pay item changes and new pay items. The contract will be prepared accordingly.

The Expedite File has been updated to reflect these revisions. Please download the Expedite Addendum File and follow the instructions for applying the addendum. Bid Express will not accept your bid unless the addendum has been applied.

Sincerely,

R. A. Garris, PE
Contract Officer

RAG/jag
Attachments

cc: Mr. Ron Hancock, PE
Ms. Karen Collette, PE
Ms. D. M. Barbour, PE
Mr. Rodger Rochelle, PE
Mr. Mike Gwyn
Ms. Marsha Sample
Project File (2)

Mr. Ray Arnold, PE
Ms. Theresa Canales, PE
Mr. R.E. Davenport, PE
Mr. Ken Kennedy, PE
Ms. Lori Strickland
Ms. Jaci Kincaid
Ms. Penny Higgins

STATE OF NORTH CAROLINA
DEPARTMENT OF TRANSPORTATION
RALEIGH, N.C.

PROPOSAL

INCLUDES ADDENDUM No.1 DATED 09-04-15

DATE AND TIME OF BID OPENING: **SEPTEMBER 15, 2015 AT 2:00 PM**

CONTRACT ID C203755
WBS 2016CPT.03.03.10651, 41867.3.2

FEDERAL-AID NO. STATE FUNDED, STPNHS-0421(46)
COUNTY NEW HANOVER
T.I.P. NO. W-5103A
MILES 8.245
ROUTE NO. US 421
LOCATION US-421 FROM BRIDGE #30 TO NORTH OF GEORGE ANDERSON DRIVE.

TYPE OF WORK GRADING, DRAINAGE, PAVING & SIGNALS.

NOTICE:

ALL BIDDERS SHALL COMPLY WITH ALL APPLICABLE LAWS REGULATING THE PRACTICE OF GENERAL CONTRACTING AS CONTAINED IN CHAPTER 87 OF THE GENERAL STATUTES OF NORTH CAROLINA WHICH REQUIRES THE BIDDER TO BE LICENSED BY THE N.C. LICENSING BOARD FOR CONTRACTORS WHEN BIDDING ON ANY NON-FEDERAL AID PROJECT WHERE THE BID IS \$30,000 OR MORE, EXCEPT FOR CERTAIN SPECIALTY WORK AS DETERMINED BY THE LICENSING BOARD. BIDDERS SHALL ALSO COMPLY WITH ALL OTHER APPLICABLE LAWS REGULATING THE PRACTICES OF ELECTRICAL, PLUMBING, HEATING AND AIR CONDITIONING AND REFRIGERATION CONTRACTING AS CONTAINED IN CHAPTER 87 OF THE GENERAL STATUTES OF NORTH CAROLINA. NOTWITHSTANDING THESE LIMITATIONS ON BIDDING, THE BIDDER WHO IS AWARDED ANY FEDERAL - AID FUNDED PROJECT SHALL COMPLY WITH CHAPTER 87 OF THE GENERAL STATUTES OF NORTH CAROLINA FOR LICENSING REQUIREMENTS WITHIN 60 CALENDAR DAYS OF BID OPENING.

BIDS WILL BE RECEIVED AS SHOWN BELOW:

THIS IS A ROADWAY PROPOSAL

5% BID BOND OR BID DEPOSIT REQUIRED

1003-7 MIXING AND DELIVERY

Use grout free of any lumps and undispersed cement. When using an approved packaged grout, mix grout in accordance with the manufacturer's instructions. Otherwise, comply with Articles 1000-8 through 1000-12 to the extent applicable for grout instead of concrete.

SHOULDER RECONSTRUCTION PER SHOULDER MILE:

(1-18-00) (Rev. 5-17-11)

560

R1 R07 (Rev)

Description

This work consists of reconstructing each shoulder (including median shoulders as applicable) in accordance with Standard Drawing No. 560.01 and 560.02 of the *2012 Roadway Standard Drawings* except that the rate of slope and width will be as shown on typical section, or to the existing shoulder point, whichever is nearer, as long as the desired typical is achieved, and when completed. This work shall be performed immediately after the resurfacing operations are complete as directed by the Engineer.

Materials

The Contractor is required to use **Aggregate Shoulder Borrow (ASB)** as directed by the Engineer. ASB shall meet the following gradation:

<u>Sieve</u>	<u>Percent Passing</u>
1 1/2"	100
1/2"	55 - 95
#4	35 - 74

Construction Methods

Prior to adding Aggregate Shoulder Borrow, the existing shoulder shall be scarified to provide the proper bond and shall be compacted to the satisfaction of the Engineer.

Any excess material generated by the shoulder reconstruction shall be disposed of by the Contractor in an approved disposal site.

Measurement and Payment

Shoulder Reconstruction will be measured and paid as the actual number of miles of shoulders that have been reconstructed. Measurement will be made along the surface of each shoulder to the nearest 0.01 of a mile. Such price will include disposing of any excess material in an approved disposal site, and for all labor, tools, equipment, and incidentals necessary to complete the work.

Where ASB is used, Incidental Stone will not be required

Aggregate Shoulder Borrow will be measured and paid at the contract unit price per ton.

C203755 W-5103A

R-31

New Hanover County

Payment will be made under:

Pay Item
Shoulder Reconstruction
Aggregate Shoulder Borrow

Pay Unit
Shoulder Mile
Ton

County : New Hanover

Line #	Item Number	Sec #	Description	Quantity	Unit Cost	Amount
ROADWAY ITEMS						
0001	0000100000-N	800	MOBILIZATION	Lump Sum	L.S.	
0002	0000400000-N	801	CONSTRUCTION SURVEYING	Lump Sum	L.S.	
0003	0001000000-E	200	CLEARING & GRUBBING .. ACRE(S)	Lump Sum	L.S.	
0004	0008000000-E	200	SUPPLEMENTARY CLEARING & GRUBBING	1 ACR		
0005	0022000000-E	225	UNCLASSIFIED EXCAVATION	12,010 CY		
0006	0036000000-E	225	UNDERCUT EXCAVATION	1,000 CY		
0007	0134000000-E	240	DRAINAGE DITCH EXCAVATION	1,800 CY		
0008	0156000000-E	250	REMOVAL OF EXISTING ASPHALT PAVEMENT	880 SY		
0009	0195000000-E	265	SELECT GRANULAR MATERIAL	1,000 CY		
0010	0196000000-E	270	GEOTEXTILE FOR SOIL STABILIZATION	8,500 SY		
0011	0318000000-E	300	FOUNDATION CONDITIONING MATERIAL, MINOR STRUCTURES	1,350 TON		
0012	0320000000-E	300	FOUNDATION CONDITIONING GEOTEXTILE	4,240 SY		
0013	0335200000-E	305	15" DRAINAGE PIPE	60 LF		
0014	0335400000-E	305	24" DRAINAGE PIPE	198 LF		
0015	0335500000-E	305	30" DRAINAGE PIPE	576 LF		
0016	0448200000-E	310	15" RC PIPE CULVERTS, CLASS IV	6,148 LF		
0017	0448300000-E	310	18" RC PIPE CULVERTS, CLASS IV	3,688 LF		
0018	0448400000-E	310	24" RC PIPE CULVERTS, CLASS IV	1,598 LF		
0019	0448500000-E	310	30" RC PIPE CULVERTS, CLASS IV	412 LF		

County : New Hanover

Line #	Item Number	Sec #	Description	Quantity	Unit Cost	Amount
0020	0448600000-E	310	36" RC PIPE CULVERTS, CLASS IV	32 LF		
0021	0453000000-E	310	*** PIPE END SECTION (15")	2 EA		
0022	0995000000-E	340	PIPE REMOVAL	2,806 LF		
0023	0996000000-N	350	PIPE CLEAN-OUT	8 EA		
0024	1011000000-N	500	FINE GRADING	Lump Sum	L.S.	
0025	1099500000-E	505	SHALLOW UNDERCUT	2,500 CY		
0026	1099700000-E	505	CLASS IV SUBGRADE STABILIZATION	4,780 TON		
0027	1111000000-E	SP	CLASS IV AGGREGATE STABILIZATION	500 TON		
0028	1220000000-E	545	INCIDENTAL STONE BASE	700 TON		
0029	1297000000-E	607	MILLING ASPHALT PAVEMENT, **** DEPTH (4")	75,509 SY		
0030	1308000000-E	607	MILLING ASPHALT PAVEMENT, **** TO ***** (1-1/2" TO 4")	4,070 SY		
0031	1330000000-E	607	INCIDENTAL MILLING	6,212 SY		
0032	1489000000-E	610	ASPHALT CONC BASE COURSE, TYPE B25.0B	15,850 TON		
0033	1498000000-E	610	ASPHALT CONC INTERMEDIATE COURSE, TYPE I19.0B	36,340 TON		
0034	1519000000-E	610	ASPHALT CONC SURFACE COURSE, TYPE S9.5B	23,420 TON		
0035	1575000000-E	620	ASPHALT BINDER FOR PLANT MIX	3,850 TON		
0036	1693000000-E	654	ASPHALT PLANT MIX, PAVEMENT REPAIR	1,161 TON		
0037	1704000000-E	SP	PATCHING EXISTING PAVEMENT	750 TON		

County : New Hanover

Line #	Item Number	Sec #	Description	Quantity	Unit Cost	Amount
0038	1891000000-E	SP	GENERIC PAVING ITEM 1-1/2" FINE MILLING	99,826 SY		
0039	2022000000-E	815	SUBDRAIN EXCAVATION	112 CY		
0040	2026000000-E	815	GEOTEXTILE FOR SUBSURFACE DRAINS	500 SY		
0041	2036000000-E	815	SUBDRAIN COARSE AGGREGATE	84 CY		
0042	2044000000-E	815	6" PERFORATED SUBDRAIN PIPE	500 LF		
0043	2070000000-N	815	SUBDRAIN PIPE OUTLET	1 EA		
0044	2077000000-E	815	6" OUTLET PIPE	6 LF		
0045	2253000000-E	840	PIPE COLLARS	3.15 CY		
0046	2286000000-N	840	MASONRY DRAINAGE STRUCTURES	122 EA		
0047	2308000000-E	840	MASONRY DRAINAGE STRUCTURES	4.4 LF		
0048	2364000000-N	840	FRAME WITH TWO GRATES, STD 840.16	53 EA		
0049	2366000000-N	840	FRAME WITH TWO GRATES, STD 840.24	49 EA		
0050	2367000000-N	840	FRAME WITH TWO GRATES, STD 840.29	1 EA		
0051	2374000000-N	840	FRAME WITH GRATE & HOOD, STD 840.03, TYPE ** (E)	4 EA		
0052	2374000000-N	840	FRAME WITH GRATE & HOOD, STD 840.03, TYPE ** (F)	5 EA		
0053	2374000000-N	840	FRAME WITH GRATE & HOOD, STD 840.03, TYPE ** (G)	4 EA		
0054	2396000000-N	840	FRAME WITH COVER, STD 840.54	6 EA		

County : New Hanover

Line #	Item Number	Sec #	Description	Quantity	Unit Cost	Amount
0055	2440000000-N	852	CONCRETE TRANSITIONAL SECTION FOR CATCH BASIN	14 EA		
0056	2451000000-N	852	CONCRETE TRANSITIONAL SECTION FOR DROP INLET	47 EA		
0057	2549000000-E	846	2'-6" CONCRETE CURB & GUTTER	2,490 LF		
0058	2577000000-E	846	CONCRETE EXPRESSWAY GUTTER	150 LF		
0059	2612000000-E	848	6" CONCRETE DRIVEWAY	320 SY		
0060	2627000000-E	852	4" CONCRETE ISLAND COVER	1,180 SY		
0061	2647000000-E	852	5" MONOLITHIC CONCRETE ISLANDS (SURFACE MOUNTED)	4,690 SY		
0062	2752000000-E	SP	GENERIC PAVING ITEM REMOVE & REPLACE 2'-6" CURB & GUTTER	50 LF		
0063	2830000000-N	858	ADJUSTMENT OF MANHOLES	1 EA		
0064	3628000000-E	876	RIP RAP, CLASS I	30 TON		
0065	3649000000-E	876	RIP RAP, CLASS B	60 TON		
0066	3656000000-E	876	GEOTEXTILE FOR DRAINAGE	775 SY		
0067	4025000000-E	901	CONTRACTOR FURNISHED, TYPE *** SIGN (E)	780.75 SF		
0068	4025000000-E	901	CONTRACTOR FURNISHED, TYPE *** SIGN (F)	314.13 SF		
0069	4072000000-E	903	SUPPORTS, 3-LB STEEL U-CHANNEL	1,500 LF		
0070	4102000000-N	904	SIGN ERECTION, TYPE E	83 EA		
0071	4108000000-N	904	SIGN ERECTION, TYPE F	37 EA		
0072	4589000000-N	SP	GENERIC TRAFFIC CONTROL ITEM WORK ZONE TRAFFIC CONTROL	Lump Sum	L.S.	

County : New Hanover

Line #	Item Number	Sec #	Description	Quantity	Unit Cost	Amount
0073	4685000000-E	1205	THERMOPLASTIC PAVEMENT MARKING LINES (4", 90 MILS)	97,167 LF		
0074	4686000000-E	1205	THERMOPLASTIC PAVEMENT MARKING LINES (4", 120 MILS)	31,893 LF		
0075	4695000000-E	1205	THERMOPLASTIC PAVEMENT MARKING LINES (8", 90 MILS)	36,439 LF		
0076	4697000000-E	1205	THERMOPLASTIC PAVEMENT MARKING LINES (8", 120 MILS)	840 LF		
0077	4710000000-E	1205	THERMOPLASTIC PAVEMENT MARKING LINES (24", 120 MILS)	1,606 LF		
0078	4721000000-E	1205	THERMOPLASTIC PAVEMENT MARKING CHARACTER (120 MILS)	40 EA		
0079	4725000000-E	1205	THERMOPLASTIC PAVEMENT MARKING SYMBOL (90 MILS)	326 EA		
0080	4900000000-N	1251	PERMANENT RAISED PAVEMENT MARKERS	739 EA		
0081	4905000000-N	1253	SNOWPLOWABLE PAVEMENT MARKERS	3,594 EA		
0082	5255000000-N	1413	PORTABLE LIGHTING	Lump Sum	L.S.	
0083	6000000000-E	1605	TEMPORARY SILT FENCE	46,890 LF		
0084	6006000000-E	1610	STONE FOR EROSION CONTROL, CLASS A	1,815 TON		
0085	6009000000-E	1610	STONE FOR EROSION CONTROL, CLASS B	145 TON		
0086	6012000000-E	1610	SEDIMENT CONTROL STONE	2,035 TON		
0087	6015000000-E	1615	TEMPORARY MULCHING	24.5 ACR		
0088	6018000000-E	1620	SEED FOR TEMPORARY SEEDING	1,600 LB		
0089	6021000000-E	1620	FERTILIZER FOR TEMPORARY SEEDING	8 TON		
0090	6024000000-E	1622	TEMPORARY SLOPE DRAINS	200 LF		

County : New Hanover

Line #	Item Number	Sec #	Description	Quantity	Unit Cost	Amount
0091	6029000000-E	SP	SAFETY FENCE	6,400 LF		
0092	6030000000-E	1630	SILT EXCAVATION	1,860 CY		
0093	6036000000-E	1631	MATTING FOR EROSION CONTROL	1,000 SY		
0094	6037000000-E	SP	COIR FIBER MAT	100 SY		
0095	6042000000-E	1632	1/4" HARDWARE CLOTH	2,550 LF		
0096	6071010000-E	SP	WATTLE	2,460 LF		
0097	6071020000-E	SP	POLYACRYLAMIDE (PAM)	265 LB		
0098	6071030000-E	1640	COIR FIBER BAFFLE	30 LF		
0099	6084000000-E	1660	SEEDING & MULCHING	15 ACR		
0100	6087000000-E	1660	MOWING	15 ACR		
0101	6090000000-E	1661	SEED FOR REPAIR SEEDING	251 LB		
0102	6093000000-E	1661	FERTILIZER FOR REPAIR SEEDING	0.75 TON		
0103	6096000000-E	1662	SEED FOR SUPPLEMENTAL SEEDING	525 LB		
0104	6108000000-E	1665	FERTILIZER TOPDRESSING	16 TON		
0105	6114500000-N	1667	SPECIALIZED HAND MOWING	11 MHR		
0106	6117000000-N	SP	RESPONSE FOR EROSION CONTROL	25 EA		
0107	6132000000-N	SP	GENERIC EROSION CONTROL ITEM CONCRETE WASHOUT STRUCTURE	4 EA		
0108	7060000000-E	1705	SIGNAL CABLE	1,310 LF		
0109	7120000000-E	1705	VEHICLE SIGNAL HEAD (12", 3 SECTION)	7 EA		
0110	7132000000-E	1705	VEHICLE SIGNAL HEAD (12", 4 SECTION)	3 EA		

County : New Hanover

Line #	Item Number	Sec #	Description	Quantity	Unit Cost	Amount
0111	7144000000-E	1705	VEHICLE SIGNAL HEAD (12", 5 SECTION)	1 EA		
0112	7252000000-E	1710	MESSENGER CABLE (1/4")	500 LF		
0113	7264000000-E	1710	MESSENGER CABLE (3/8")	600 LF		
0114	7300000000-E	1715	UNPAVED TRENCHING (*****) (1, 2")	475 LF		
0115	7300000000-E	1715	UNPAVED TRENCHING (*****) (4, 2")	25 LF		
0116	7301000000-E	1715	DIRECTIONAL DRILL (*****) (1, 2")	250 LF		
0117	7324000000-N	1716	JUNCTION BOX (STANDARD SIZE)	19 EA		
0118	7360000000-N	1720	WOOD POLE	4 EA		
0119	7372000000-N	1721	GUY ASSEMBLY	8 EA		
0120	7408000000-E	1722	1" RISER WITH WEATHERHEAD	3 EA		
0121	7420000000-E	1722	2" RISER WITH WEATHERHEAD	4 EA		
0122	7444000000-E	1725	INDUCTIVE LOOP SAWCUT	11,925 LF		
0123	7456000000-E	1726	LEAD-IN CABLE (*****) (14-2)	27,575 LF		
0124	7636000000-N	1745	SIGN FOR SIGNALS	5 EA		
0125	7780000000-N	1751	DETECTOR CARD (TYPE 2070L)	1 EA		
0126	7980000000-N	SP	GENERIC SIGNAL ITEM FURNISH & INSTALL AUXILLARY OUTPUT FILE	2 EA		
0127	7980000000-N	SP	GENERIC SIGNAL ITEM FURNISH & INSTALL MODEL 2010 ENHANCED CONFLICT MONITOR	1 EA		
0128	0255000000-E	SP	GENERIC GRADING ITEM AGGREGATE SHOULDER BORROW	1,671 TON		

County : New Hanover

Line #	Item Number	Sec #	Description	Quantity	Unit Cost	Amount
0129	1245000000-E	SP	SHOULDER RECONSTRUCTION	10.76	SMI	

1604/Sep03/Q621047.74/D471925360000/E129

Total Amount Of Bid For Entire Project :

8/17/99

13-AUG-2015 10:01 NEW HANDOVER.V-5103_41867.1.1.L1.JS 421 Median Crossover Relet use this file\ROADWAY\Pro\Plan_Sheets\W5103A.DWG.PSH.23.dgn

REVISIONS

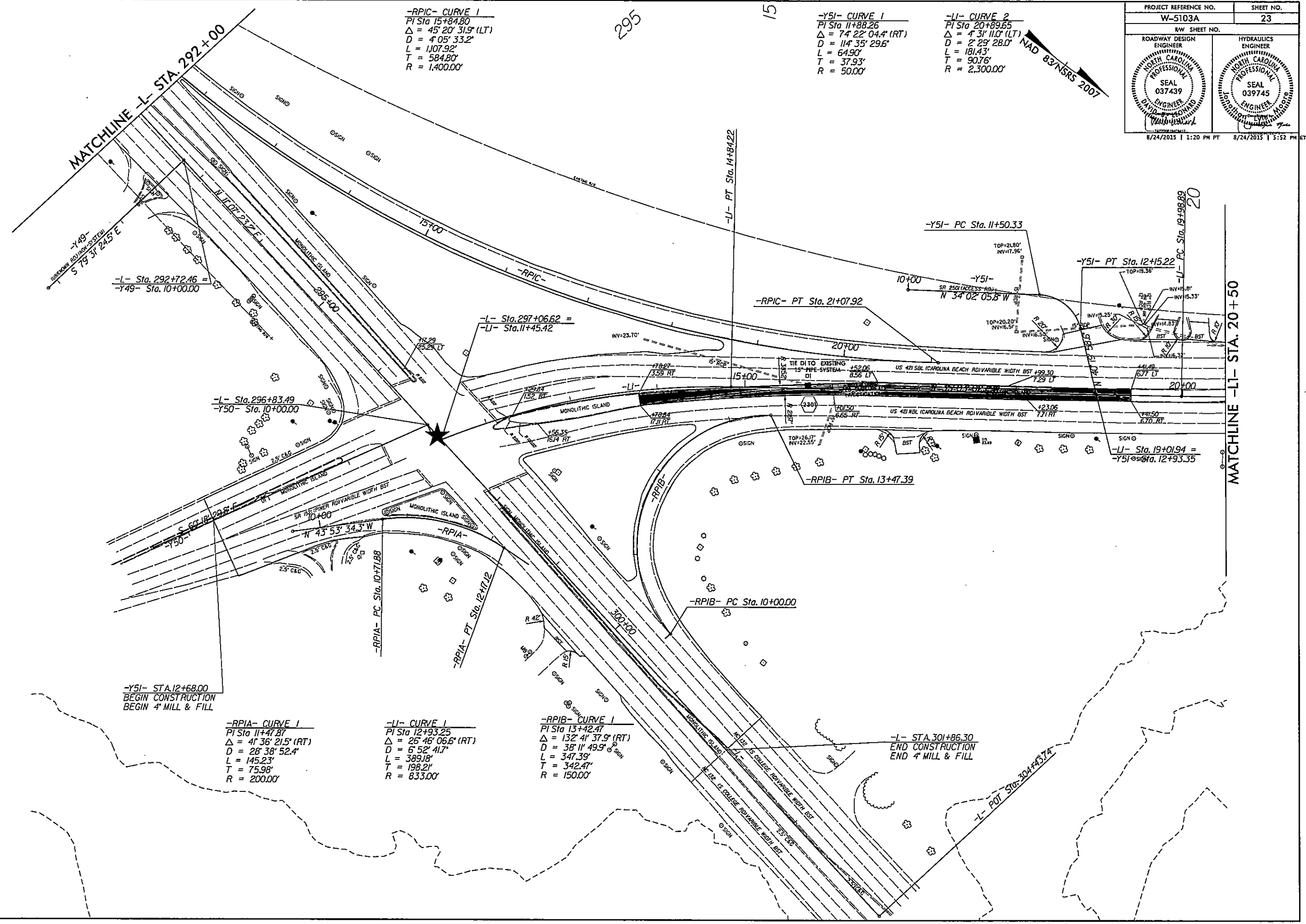

-RPIC- CURVE 1
 PI Sta 15+84.80
 $\Delta = 45^\circ 20' 31.9" (LT)$
 $D = 405' 33.2"$
 $L = 1107.92'$
 $T = 584.80'$
 $R = 1,400.00'$

-Y5I- CURVE 1
 PI Sta 11+88.26
 $\Delta = 74^\circ 22' 04.4" (RT)$
 $D = 114' 35' 29.6"$
 $L = 64.90'$
 $T = 37.93'$
 $R = 50.00'$

-LI- CURVE 2
 PI Sta 20+89.65
 $\Delta = 4^\circ 31' 11.0" (LT)$
 $D = 2' 29' 28.0"$
 $L = 181.43'$
 $T = 90.76'$
 $R = 2,300.00'$

PROJECT REFERENCE NO. W-5103A	SHEET NO. 23
RW SHEET NO.	
ROADWAY DESIGN ENGINEER NORTH CAROLINA PROFESSIONAL SEAL 037439	HYDRAULICS ENGINEER NORTH CAROLINA PROFESSIONAL SEAL 039745
8/24/2015 1:20 PM PT	8/24/2015 5:52 PM ET

-Y5I- STA. 12+68.00
 BEGIN CONSTRUCTION
 BEGIN 4" MILL & FILL

-RPIA- CURVE 1
 PI Sta 11+47.87
 $\Delta = 41^\circ 36' 21.5" (RT)$
 $D = 28^\circ 38' 52.4"$
 $L = 145.23'$
 $T = 75.98'$
 $R = 200.00'$

-LI- CURVE 1
 PI Sta 12+93.25
 $\Delta = 26^\circ 46' 06.6" (RT)$
 $D = 6^\circ 52' 41.7"$
 $L = 389.18'$
 $T = 198.21'$
 $R = 833.00'$

-RPIB- CURVE 1
 PI Sta 13+42.47
 $\Delta = 132^\circ 41' 37.9" (RT)$
 $D = 38^\circ 11' 49.9"$
 $L = 347.39'$
 $T = 342.47'$
 $R = 150.00'$

-L- STA. 301+86.30
 END CONSTRUCTION
 END 4" MILL & FILL