

6 Phase Fully Actuated  
Wilmington Signal System

PHASING DIAGRAM

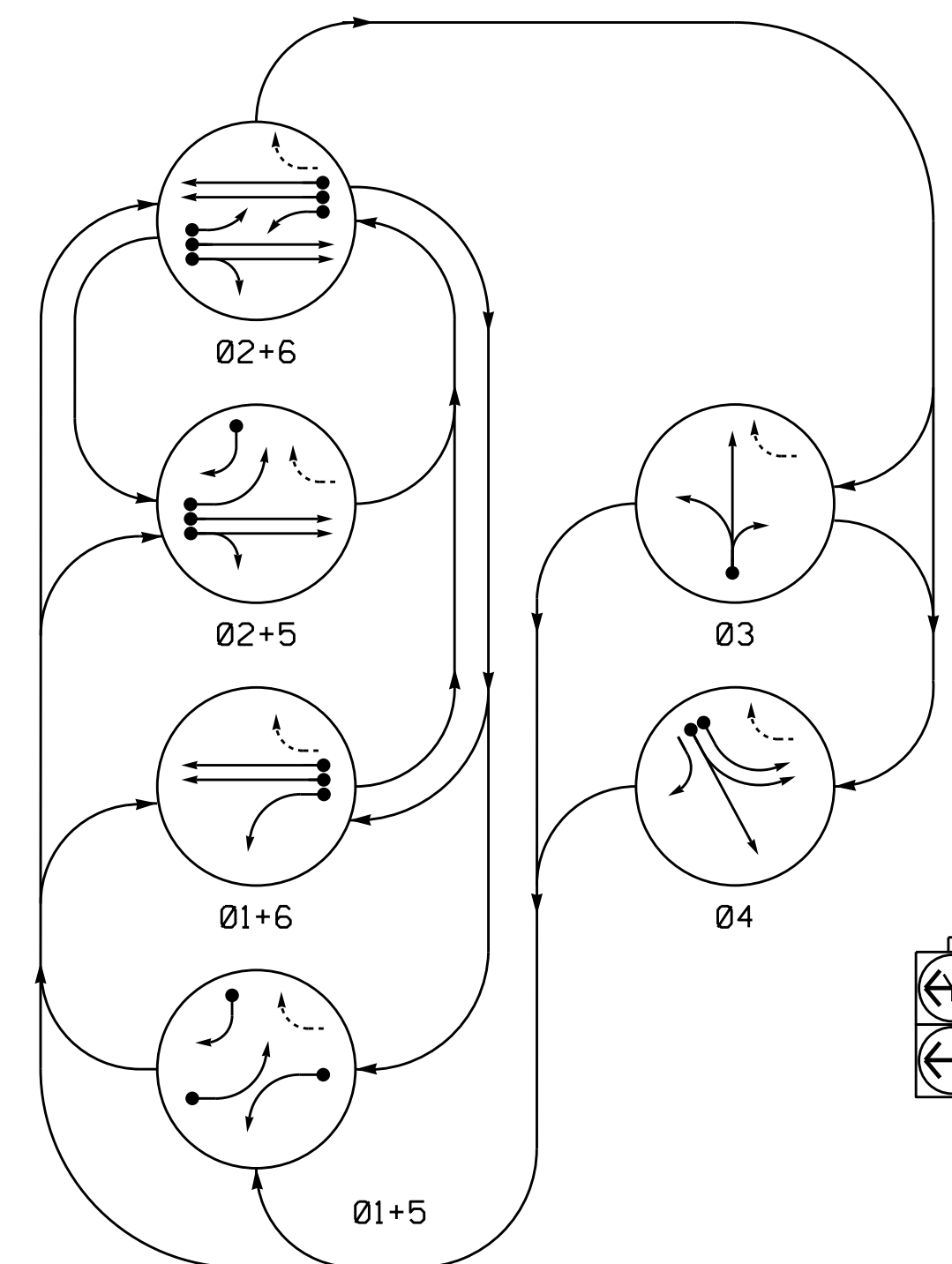
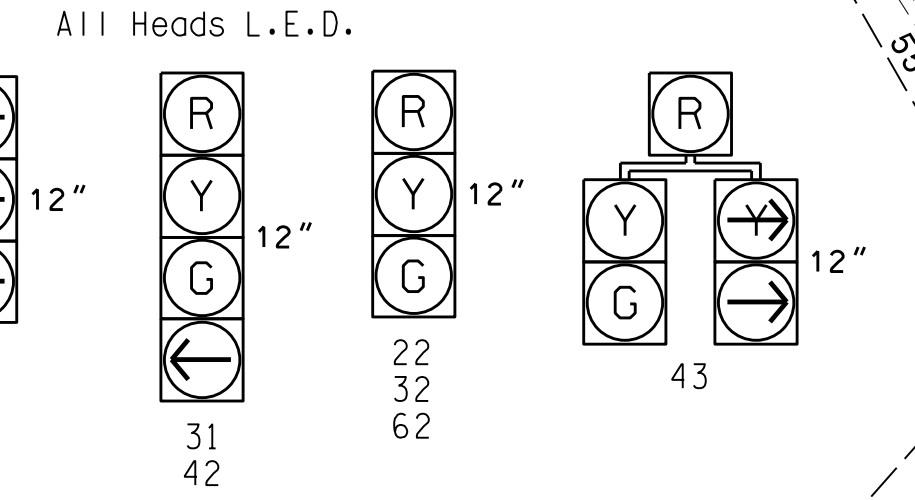

TABLE OF OPERATION

SIGNAL FACE	PHASE						FLASH
	01+5	01+6	02+5	02+6	03	04	
21	R	R	G	G	R	R	Y
22	R	R	G	G	R	R	Y
31	R	R	R	R	G	R	R
32	R	R	R	R	G	R	R
41	R	R	R	R	R	R	R
42	R	R	R	R	R	G	R
43	R	R	R	R	R	G	R
61	R	G	R	G	R	R	Y
62	R	G	R	G	R	R	Y

SIGNAL FACE I.D.



OASIS 2070 LOOP & DETECTOR INSTALLATION CHART

LOOP	SIZE (FT)	DISTANCE FROM STOPBAR (FT)	TURNS	NEW LOOP	DETECTOR PROGRAMMING				SYSTEM LOOP	NEW CARD
					PHASE	CALLING	EXTENSION	STRETCH TIME		
1A	6X40	0	2-4-2	Y	1	Y	Y	-	10	-
2A	6X6	420	5	Y	2	Y	Y	-	-	-
2B	6X6	420	5	Y	2	Y	Y	-	-	-
3A	6X20	0	2-4-2	-	3	Y	Y	-	10	-
4A	6X40	0	2-4-2	-	4	Y	Y	-	-	-
4B	6X40	0	2-4-2	-	4	Y	Y	-	-	-
5A	6X40	0	2-4-2	Y	2	Y	Y	Y	3	-
5B	6X40	0	2-4-2	-	5	Y	Y	-	15	-
6A	6X6	420	5	Y	6	Y	Y	-	-	-
6B	6X6	420	5	Y	6	Y	Y	-	-	-
S1	6X6	145	5	Y	-	-	-	-	-	Y
S2	6X6	220	5	Y	-	-	-	-	-	Y
S3	6X6	195	5	-	-	-	-	-	-	Y
S4	6X6	195	5	-	-	-	-	-	-	Y
S5	6X6	195	5	-	-	-	-	-	-	Y

NOTES

- Refer to "Roadway Standard Drawings NCDOT" dated January 2012 and "Standard Specifications for Roads and Structures" dated January 2012.
- Do not program signal for late night flashing operation unless otherwise directed by the Engineer.
- Enable Backup Protect for phase 2+6 to allow the controller to clear from phase 2+6 to phase 1 and/or 5 by progressing through an all red display.
- The order of phase 3 and phase 4 may be reversed.
- Set all detector units to presence mode.
- Existing "Left Turn Yield on Green" ball sign(s)-(R10-12) may be removed at the discretion of the Regional Traffic Engineer.
- Maximum times shown in timing chart are for free-run operation only. Coordinated signal system timing values supersede these values.
- Signal system data: Controller Asset # 0733.

PHASING DIAGRAM DETECTION LEGEND

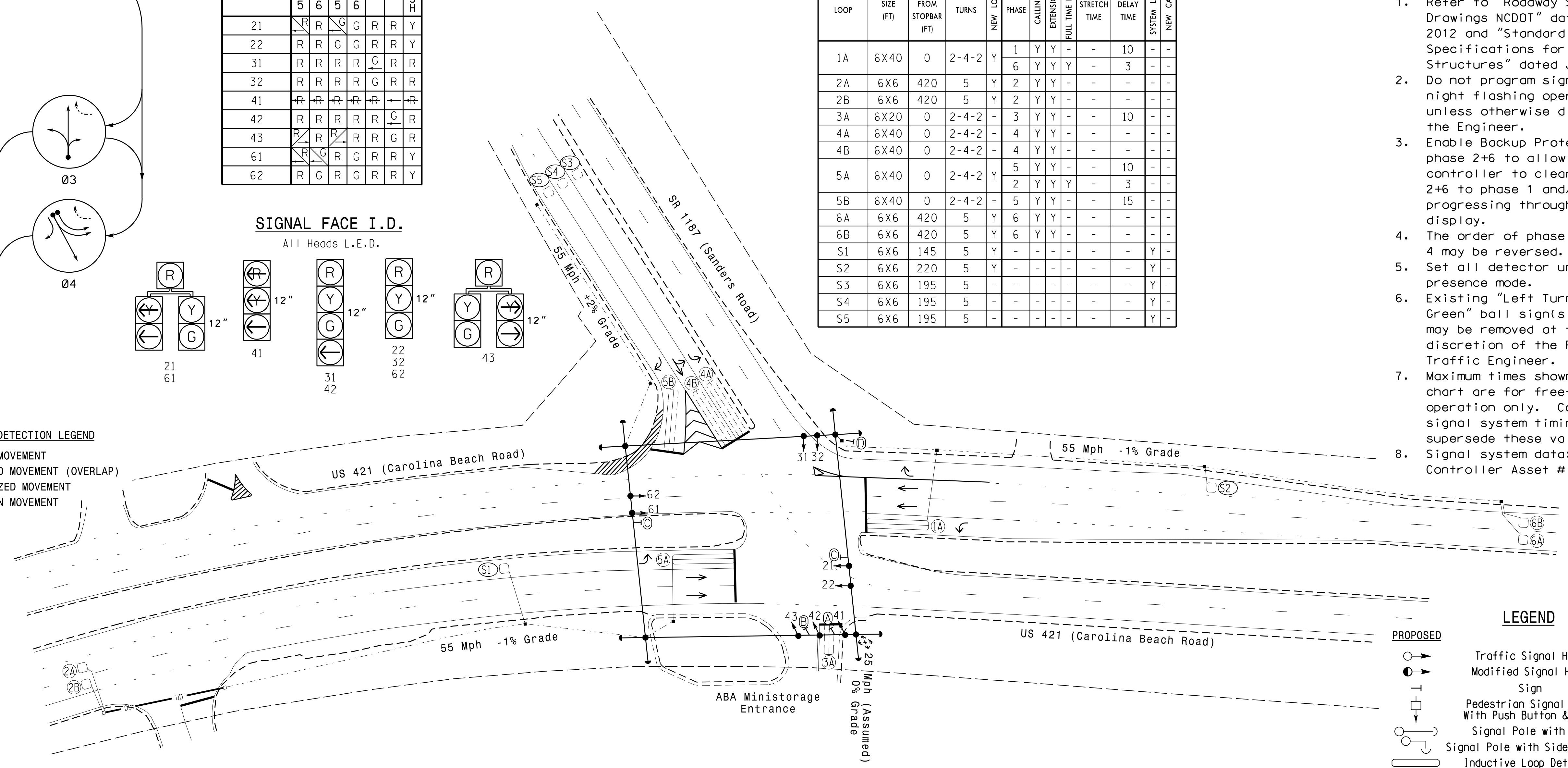
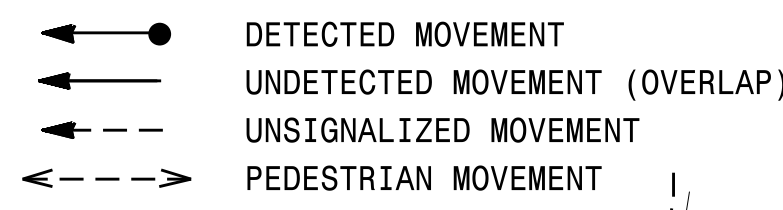

LEGEND

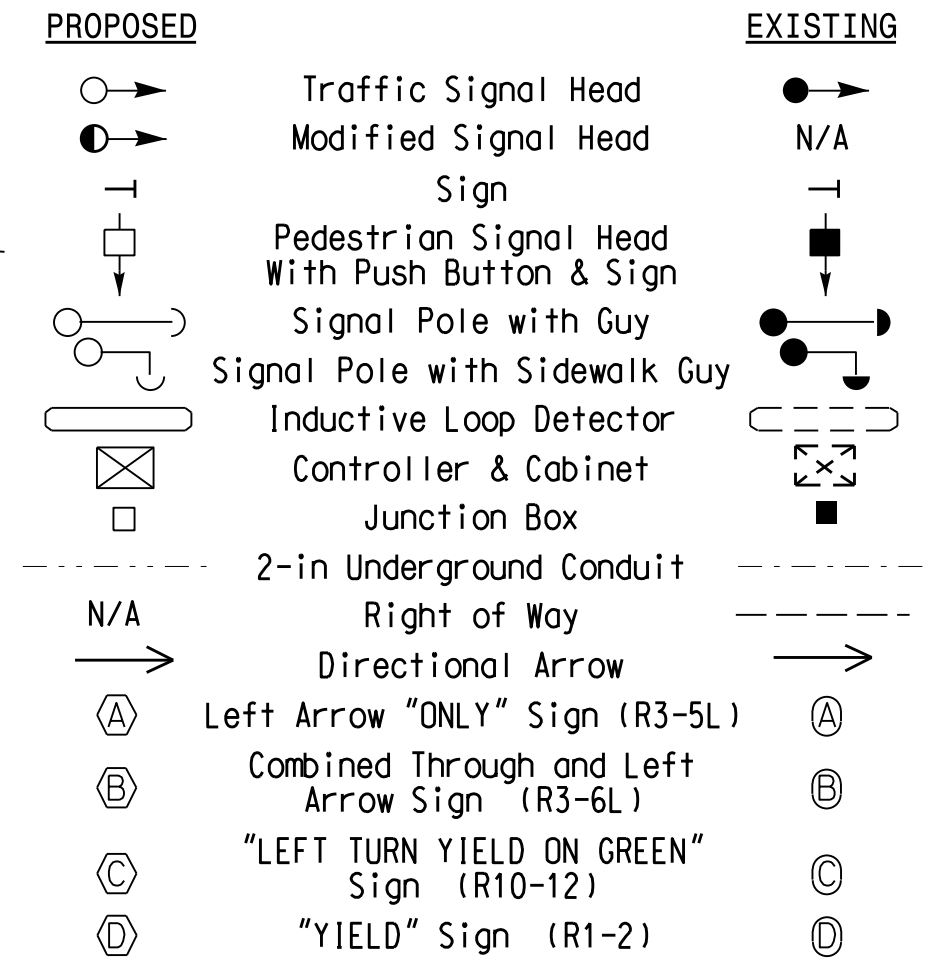

OASIS 2070 TIMING CHART

FEATURE	PHASE					
	1	2	3	4	5	6
Min Green 1 *	7	14	7	7	7	14
Extension 1	2.0	6.0	2.0	2.0	2.0	6.0
Max Green 1 *	15	120	20	45	20	120
Yellow Clearance	3.0	5.3	3.2	5.0	3.0	5.3
Red Clearance	2.9	1.0	3.2	1.9	3.1	1.3
Red Revert	2.0	5.0	2.0	2.0	2.0	5.0
Walk 1 *	-	-	-	-	-	-
Don't Walk 1	-	-	-	-	-	-
Seconds Per Actuation *	-	1.5	-	-	-	1.5
Max Variable Initial *	-	46	-	-	-	46
Time Before Reduction *	-	15	-	-	-	15
Time To Reduce *	-	45	-	-	-	45
Minimum Gap	-	3.4	-	-	-	3.4
Recall Mode	-	MIN RECALL	-	-	-	MIN RECALL
Vehicle Call Memory	-	YELLOW	-	-	-	YELLOW
Dual Entry	-	-	-	-	-	-
Simultaneous Gap	ON	ON	ON	ON	ON	ON

\* These values may be field adjusted. Do not adjust Min Green and Extension times for phases 2 and 6 lower than what is shown. Min Green for all other phases should not be lower than 4 seconds.

Signal Upgrade

REVISION SEAL

DocuSigned by: Pamela L. Alexander 7/20/15

Prepared in the Offices of:

750 N. Greenfield Pkwy, Garner, NC 27529

US 421 (Carolina Beach Road) at SR 1187 (Sanders Road) / ABA Ministorage

Division 3 New Hanover County Wilmington

PLAN DATE: February 2010 REVIEWED BY: J Cross

PREPARED BY: J Cross REVIEWED BY: S Phillips

REVISIONS: 1. Revise SB right turn to a yield movement. 2. Revise clearance times. 3. Install new loops (JRS).

INITIALS: [ ] DATE: 4/5/12

SCALE: 1" = 40'

SEAL

Not a certified document as to the Original Document but Only as to the Revisions - This document originally Issued and sealed by Stacie L. Phillips, 32607 on 4/1/2010

This document is only certified as to the revisions.

SIGNATURE: [ ] DATE: 7/20/15

SIG. INVENTORY NO. 03-0733

27-Jul-2015 14:51  
 R:\Projects\03-0733\Signal\03-0733-Sig-05n-2015rmd-dgn  
 palexander