

REVISIONS

PROJECT REFERENCE NO. W-5103A	SHEET NO. 22
RW SHEET NO.	
ROADWAY DESIGN ENGINEER NORTH CAROLINA PROFESSIONAL SEAL 037439 DAVID G. DONARD	HYDRAULICS ENGINEER NORTH CAROLINA PROFESSIONAL SEAL 039745 JOHN LYLE MOORE
8/12/2015 2:55 PM PT	8/13/2015 9:00 AM ET

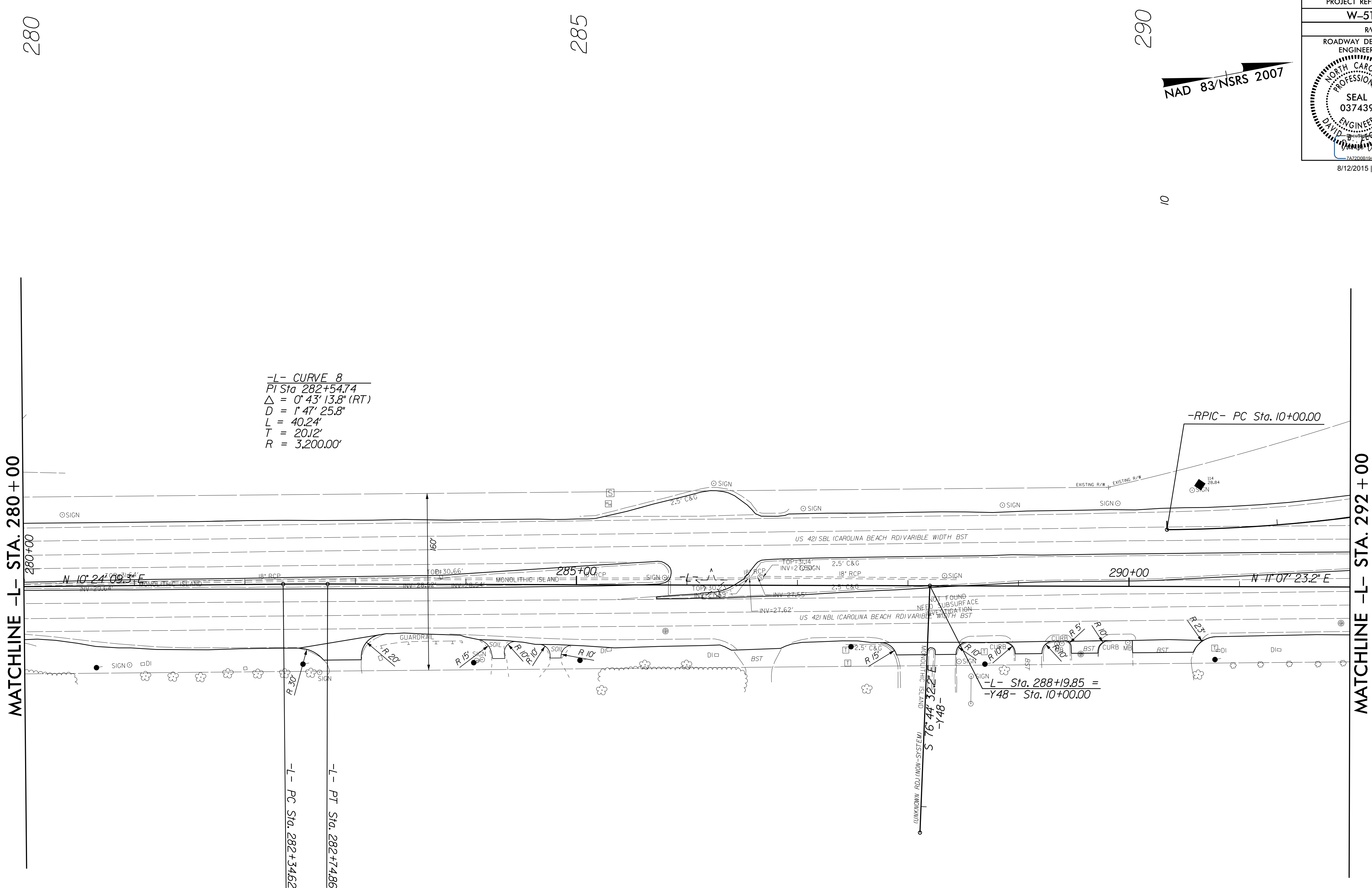
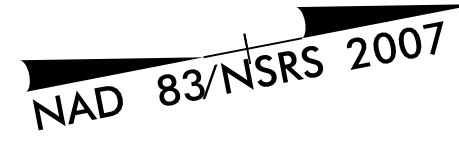

-L- CURVE 8
 PI Sta. 282+54.74
 $\Delta = 0^\circ 43' 13.8''$ (RT)
 $D = 1^\circ 47' 25.8''$
 $L = 40.24'$
 $T = 20.12'$
 $R = 3,200.00'$

-RPIC- PC Sta. 10+00.00

-L- Sta. 288+19.85 =
 -Y48- Sta. 10+00.00

MATCHLINE -L- STA. 280 + 00

MATCHLINE -L- STA. 292 + 00

10