

PROJECT REFERENCE NO. W-5103A	SHEET NO. 15
RW SHEET NO.	
ROADWAY DESIGN ENGINEER DAVID B. BOWMAN SEAL 037439 ENGINEER	HYDRAULICS ENGINEER DAVID B. BOWMAN SEAL 039745 ENGINEER
8/12/2015 2:55 PM PT	8/13/2015 9:00 AM ET

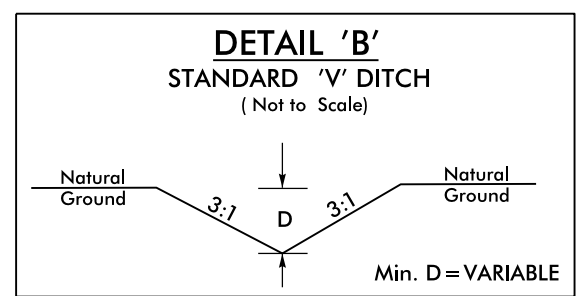

FROM STA. 193+50 CL TO STA. 195+50 CL -L-
FROM STA. 199+00 CL TO STA. 203+00 CL -L-

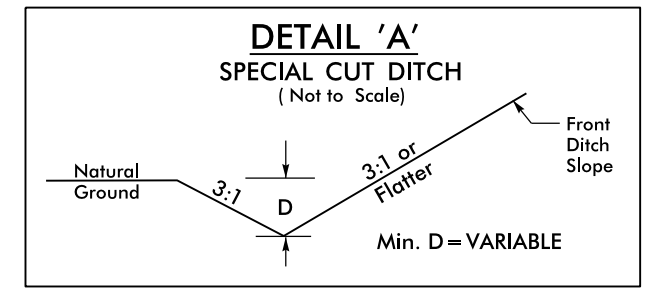
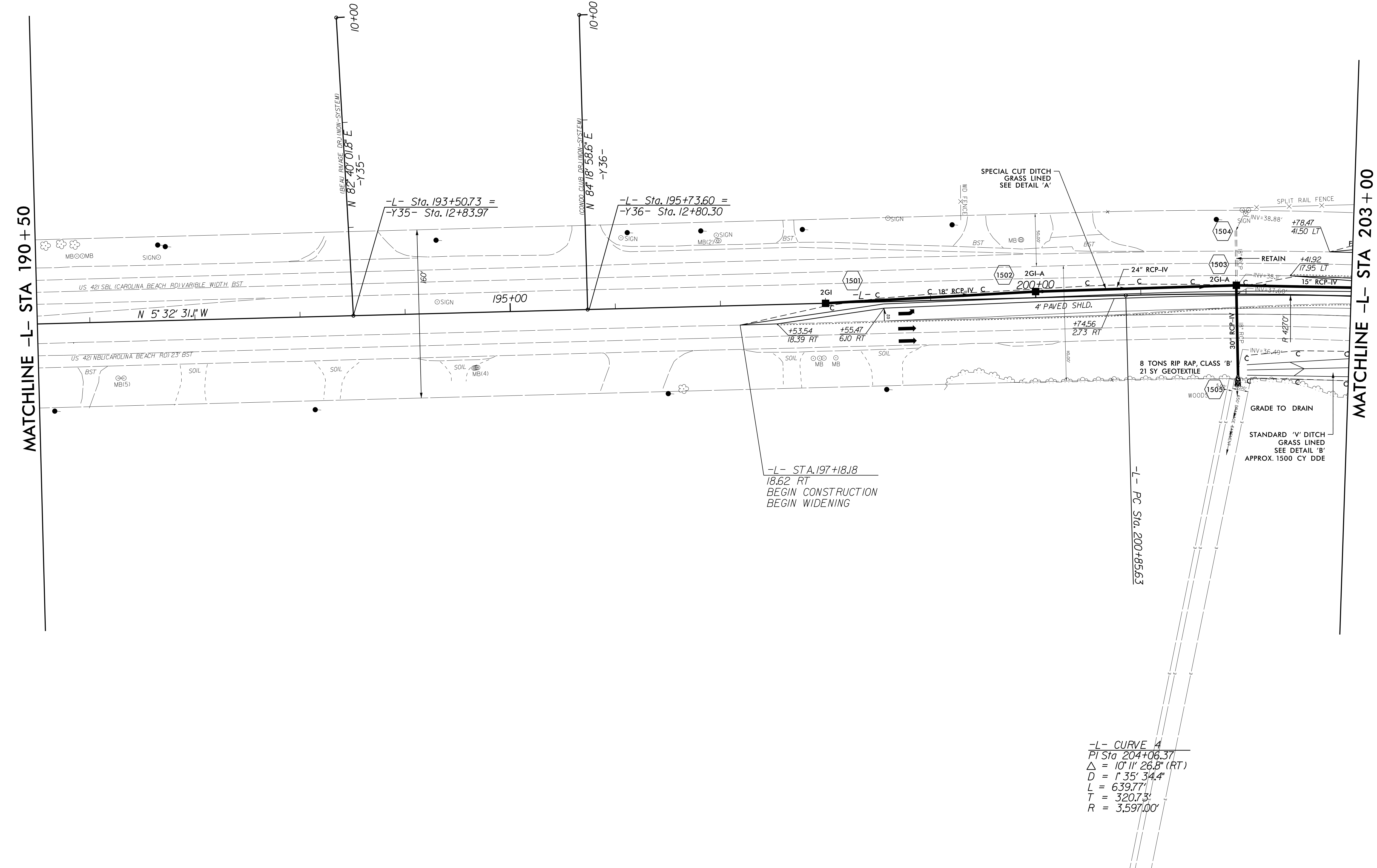

-L- CURVE 4
PI Sta 204+06.37
Δ = 10' 11" 26.8" (RT)
D = 1' 35' 34.4"
L = 639.77'
T = 320.73'
R = 3,597.00'

-L- STA. 197+18.18
18.62 RT
BEGIN CONSTRUCTION
BEGIN WIDENING

-L- Sta. 193+50.73 =
-Y35- Sta. 12+83.97

-L- Sta. 195+73.60 =
-Y36- Sta. 12+80.30

10+00
N 82° 40' 01.8" E
-Y35-

10+00
N 84° 18' 58.6" E
-Y36-

MATCHLINE -L- STA 190+50

MATCHLINE -L- STA 203+00