

UNNAMED TRIBUTARY TO GAP CREEK

60" RCP CONSTRUCTION SEQUENCE STA. 99+62 -L-

| | |
|-------------------------|---------------------|
| PROJECT REFERENCE NO. | SHEET NO. |
| R-2915A | EC-10A/CONST.10 |
| RW SHEET NO. | |
| ROADWAY DESIGN ENGINEER | HYDRAULICS ENGINEER |

PHASE I

1. INSTALL TEMPORARY 18" PIPE FROM NORTH BARREL OF EXISTING 2@42" RCP TO JUST UPSTREAM OF PROPOSED HW-1010.
2. INSTALL IMPERVIOUS DIKE #1 AND DIVERT FLOW INTO TEMPORARY 18" PIPE.
3. REMOVE EXISTING 36" CMP.
4. CONSTRUCT HW-1010, JB-1011, JB-1007, 60" RCP-III AND SHORT STUB OUT OF JB-1007.
5. REMOVE IMPERVIOUS DIKE AND TEMPORARY 18" PIPE AND DIVERT WATER INTO PROPOSED 60" RCP-III.
6. CONSTRUCT NORTH BOUND LANES AND DIVERT TRAFFIC.

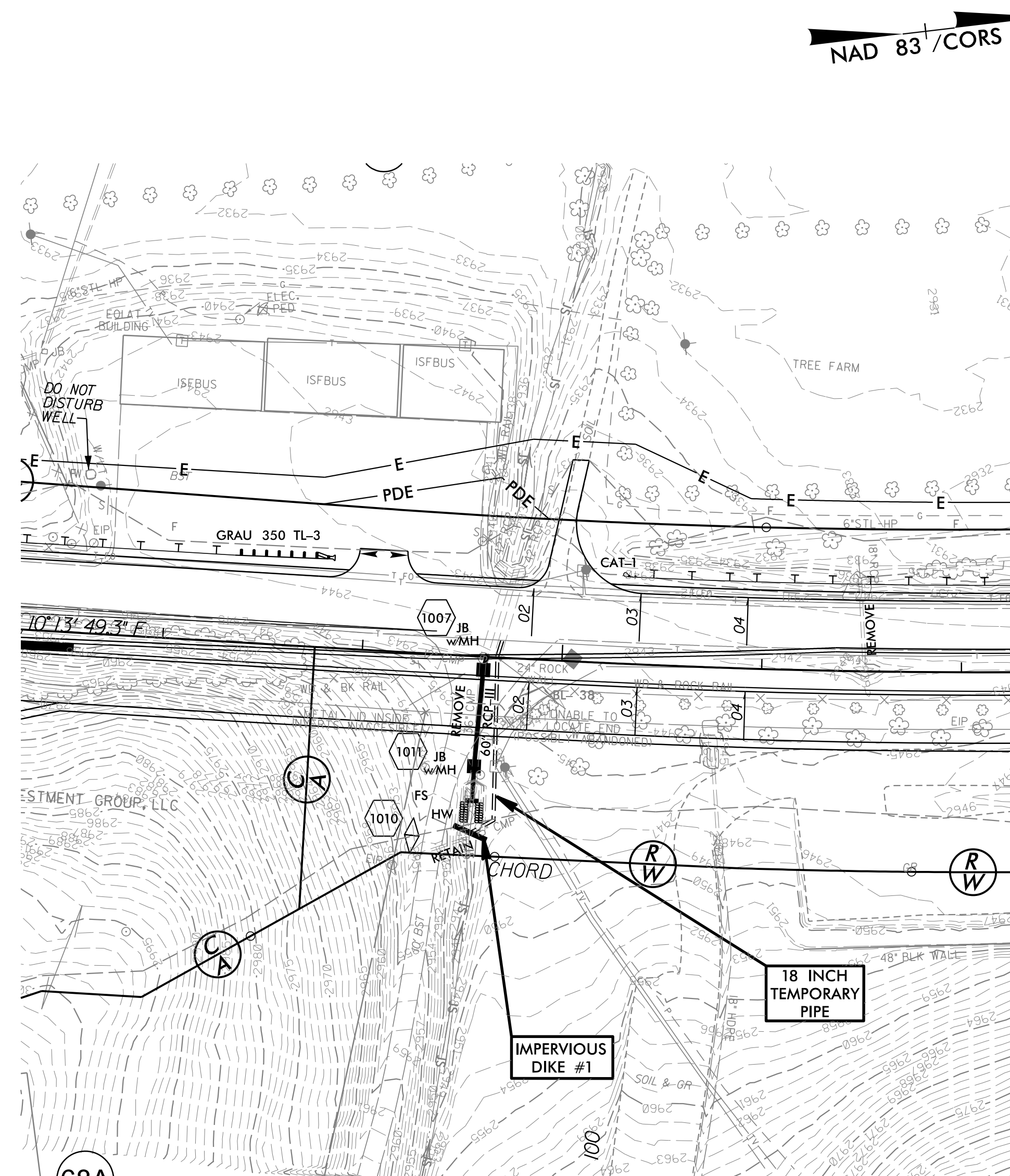

PHASE II

1. REMOVE NORTH BARREL OF EXISTING 2@42" RCP AND INSTALL TEMPORARY 18" PIPE FROM 60" RCP-III STUB OUT TO JUST DOWNSTREAM OF PROPOSED HW-1006.
2. INSTALL IMPERVIOUS DIKE #2, IMPERVIOUS DIKE #3 AND DIVERT FLOW TO TEMPORARY 18" PIPE.
3. REMOVE SOUTH BARREL OF EXISTING 2@42" RCP.
4. CONSTRUCT HW-1006, 60" RCP-III FROM HW-1006 UP TO IMPERVIOUS DIKE #2.
5. REMOVE IMPERVIOUS DIKE #2 AND TEMPORARY 18" PIPE, UTILIZING PUMP AROUND AS NECESSARY.
6. INSTALL REMAINING SECTION OF 60" RCP-III AND CONSTRUCT SOUTH BOUND LANES.

