

PROJECT REFERENCE NO. R-2915A		SHEET NO. 6	
RW SHEET NO.		HYDRAULICS ENGINEER	
ROADWAY DESIGN ENGINEER		WILLIAM WEATHERS SEAL 036188 NORTH CAROLINA PROFESSIONAL ENGINEER 7/23/2015	

RS&H
IMPROVING YOUR WORLD
© 2012 RICHMOND, SOUTH AND HILLS, INC.
RS&H Architects-Engineers-Planners, Inc.
1520 South Boulevard, Suite 200
Charlotte, NC 28203
Phone: 704-752-0610
NC License No. F-0493 www.rsandh.com

V&M
Vaughan & Melton
Consulting Engineers
Asheville, NC
North Carolina
828-253-2796
Copyright © 2006 Vaughan & Melton, Inc. All Rights Reserved.

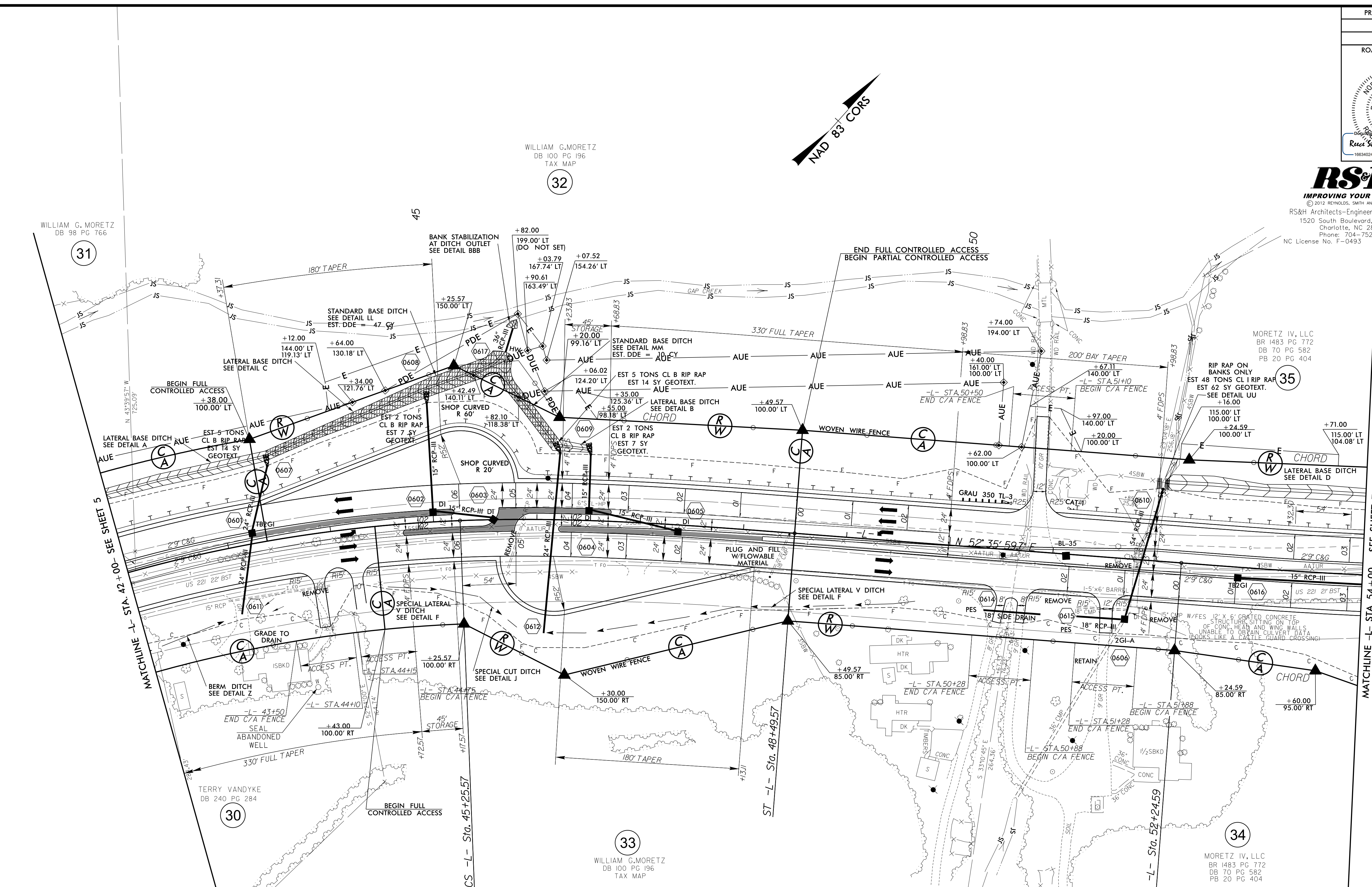
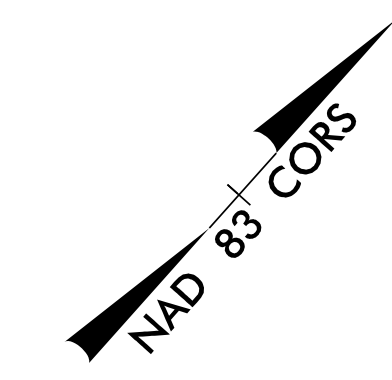

WILLIAM G. MORETZ
DB 100 PG 196
TAX MAP
32

WILLIAM G. MORETZ
DB 98 PG 766
31

MORETZ IV, LLC
BR 1483 PG 772
DB 70 PG 582
PB 20 PG 404
35

WILLIAM G. MORETZ
DB 100 PG 196
TAX MAP
33

MORETZ IV, LLC
BR 1483 PG 772
DB 70 PG 582
PB 20 PG 404
34

-L- HORIZONTAL CURVE DATA

Pls Sta 34+77.26	Pls Sta 40+73.85	Pls Sta 46+33.70
$\theta_s = 6' 37' 47.8''$	$\Delta = 38' 29' 20.0''$ (RT)	$\theta_s = 6' 37' 47.8''$
$L_s = 324.00'$	$D = 4' 05' 33.2''$	$L_s = 324.00'$
$LT = 216.15'$	$L = 940.46'$	$LT = 216.15'$
$ST = 108.14'$	$T = 488.75'$	$ST = 108.14'$
	$R = 1,400.00'$	
	$SE = 06$	
	$RO = 324$	

Pls Sta 54+40.72	Pls Sta 56+67.67	Pls Sta 58+94.38
$\theta_s = 6' 11' 16.6''$	$\Delta = 9' 04' 42.1''$ (LT)	$\theta_s = 6' 11' 16.6''$
$L_s = 324.00'$	$D = 3' 49' 11.0''$	$L_s = 324.00'$
$LT = 216.13'$	$L = 237.67'$	$LT = 216.13'$
$ST = 108.12'$	$T = 119.08'$	$ST = 108.12'$
	$R = 1,500.00'$	
	$SE = 06$	
	$RO = 237.67$	

SEE SHEET 22 FOR -L- PROFILE
SEE SHEET 2B-1 FOR MEDIAN CROSSOVER DETAIL

REVISIONS

DATE \$ FILE \$