

See Sheet 1-A For Index of Sheets
See Sheet 1-B For Conventional Symbols

STATE OF NORTH CAROLINA
DIVISION OF HIGHWAYS
ASHE COUNTY

| STATE | STATE PROJECT REFERENCE NO. | SHEET NO. | TOTAL SHEETS |
|-----------------|-----------------------------|-------------|--------------|
| N.C. | R-2915B | 1 | |
| STATE PROJ. NO. | F.A. PROJ. NO. | DESCRIPTION | |
| 34518.1.3 | STP-0221(40) | P.E. | |
| 34518.2.FR2 | STP-0221(40) | R /W | |
| 34518.2.FR2 | STP-0221(40) | UTILITIES | |
| 34518.3.7 | | CONST. | |

TIP PROJECT: R-2915B

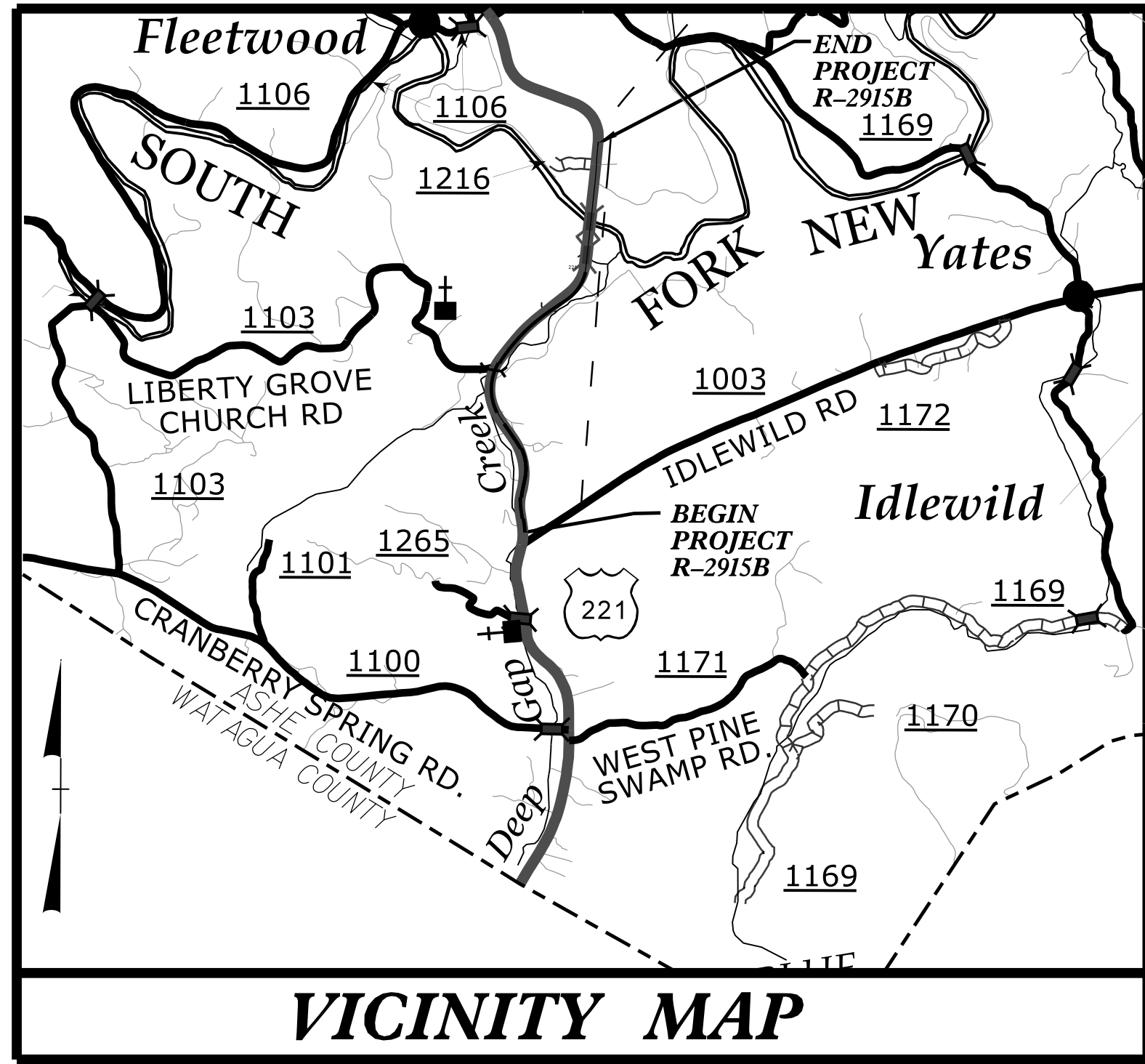

**LOCATION: US 221 FROM SR 1003 (IDLEWILD ROAD)
TO NORTH OF SOUTH FORK NEW RIVER**
**TYPE OF WORK: GRADING, DRAINAGE, PAVING, CULVERT
AND STRUCTURES**

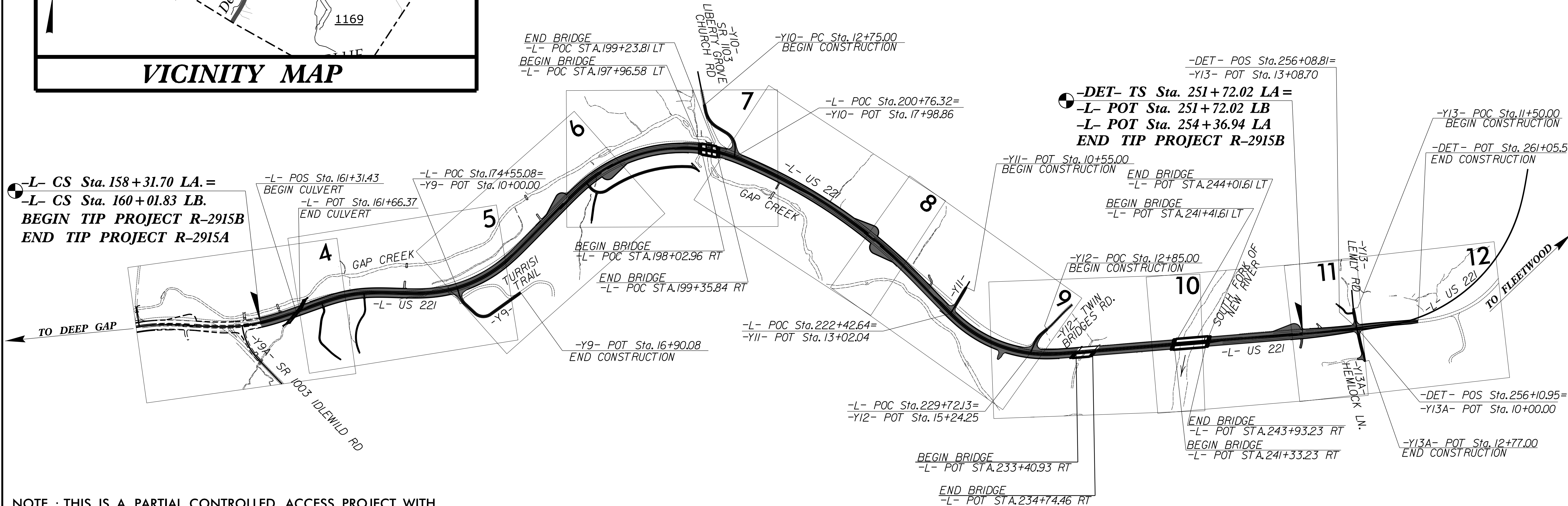

NOTE : THIS IS A PARTIAL CONTROLLED ACCESS PROJECT WITH ACCESS BEING LIMITED TO ONE DRIVEWAY PER PARCEL.

CONTRACT: C203594

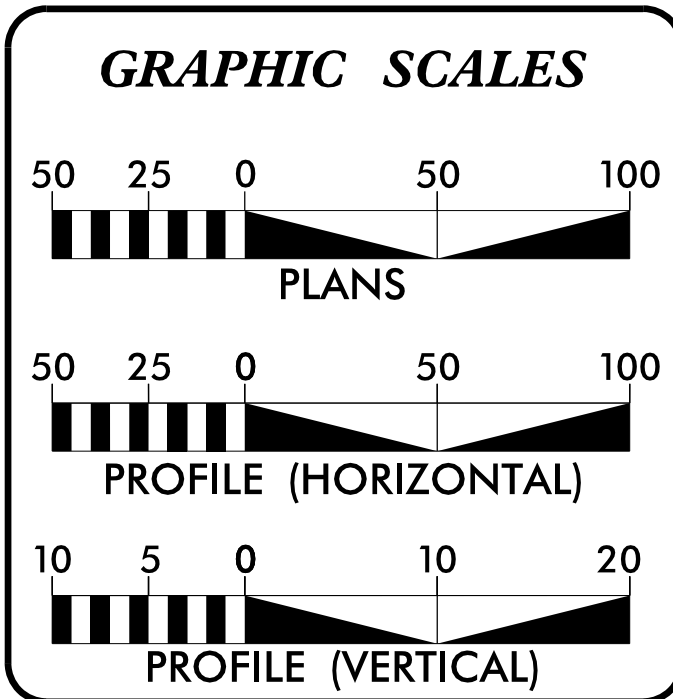

DESIGN DATA

| | |
|------------|---------------------------|
| ADT 2015 = | 12,089 |
| ADT 2035 = | 20,204 |
| K = | 10 % |
| D = | 65 % |
| T = | 9 % * |
| V = | 50 MPH |
| * TTST | 2% DUAL 7% |
| FUNC CLASS | = ARTERIAL STATEWIDE TIER |

PROJECT LENGTH

| | | |
|--------------------------------------|---|-------------|
| LENGTH ROADWAY TIP PROJECT R-2915B | = | 1.663 MILES |
| LENGTH STRUCTURE TIP PROJECT R-2915B | = | 0.106 MILES |
| TOTAL LENGTH TIP PROJECT R-2915B | = | 1.769 MILES |

Prepared in the Office of:
CDM Smith
5400 Glenwood Avenue, Suite 400, Raleigh, NC 27612
FOR THE NCDOT DIVISION OF HIGHWAYS

2012 STANDARD SPECIFICATIONS

RIGHT OF WAY DATE:
SEPTEMBER 30, 2013

LETTING DATE:
SEPTEMBER 15, 2015

DOUGLAS B. SAUNDERS, P.E.
PROJECT ENGINEER

DAVID J. CLODGO, P.E.
PROJECT DESIGN ENGINEER

REKHA V. PATEL, P.E.
NCDOT CONTACT

HYDRAULICS ENGINEER

7/17/2015

DocuSigned by:
W. Henry Wells Jr.
SIGNATURE

ROADWAY DESIGN ENGINEER

7/17/2015

DocuSigned by:
Douglas B. Saunders, PE
SIGNATURE

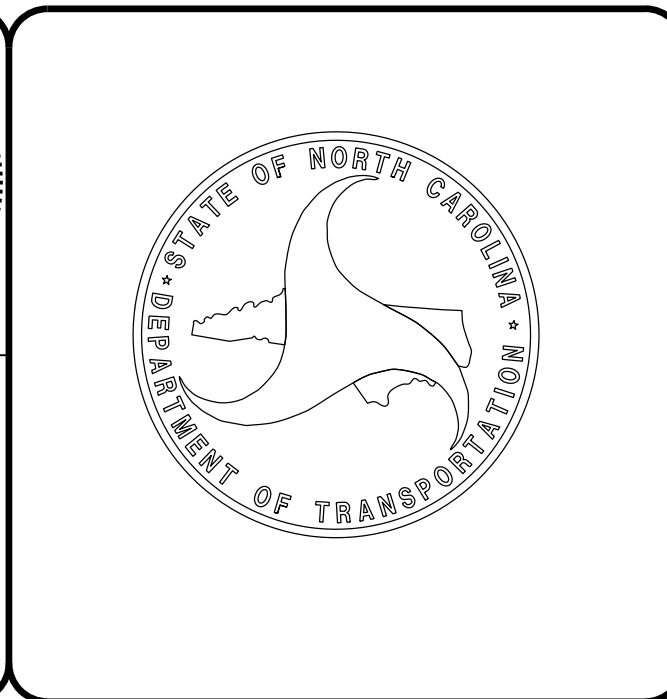

7/10/2015 10:24:25 AM N:\Proj\2915B\RDY_TSH_01.dgn T:\SERV\CLD\G00J