

**NOTES:**  
 FOR GENERAL NOTES, SEE SHEET 4 OF 4.  
 MVC = MINIMUM VERTICAL CLEARANCE  
 MHC = MINIMUM HORIZONTAL CLEARANCE  
 MINIMUM VERTICAL CLEARANCE SHOWN ACCOUNTS FOR A 1.5" ASPHALT OVERLAY OF TOP OF PAVEMENT ELEVATIONS PROVIDED BELOW.

TOP OF PAVEMENT ELEVATIONS UNION CHAPEL RD. (EXISTING)	
STATION -Y1-	EL.
21+50.00	167.12
21+55.00	167.10
21+60.00	167.09
21+65.00	167.07
21+70.00	167.06
21+75.00	167.04
21+80.00	167.03
21+85.00	167.01
21+90.00	166.98
21+95.00	166.95
22+00.00	166.92
22+05.00	166.89
22+10.00	166.86
22+15.00	166.83
22+20.00	166.79
22+25.00	166.76
22+30.00	166.73
22+35.00	166.70
22+40.00	166.67
22+45.00	166.64
22+50.00	166.61
22+55.00	166.57
22+60.00	166.54

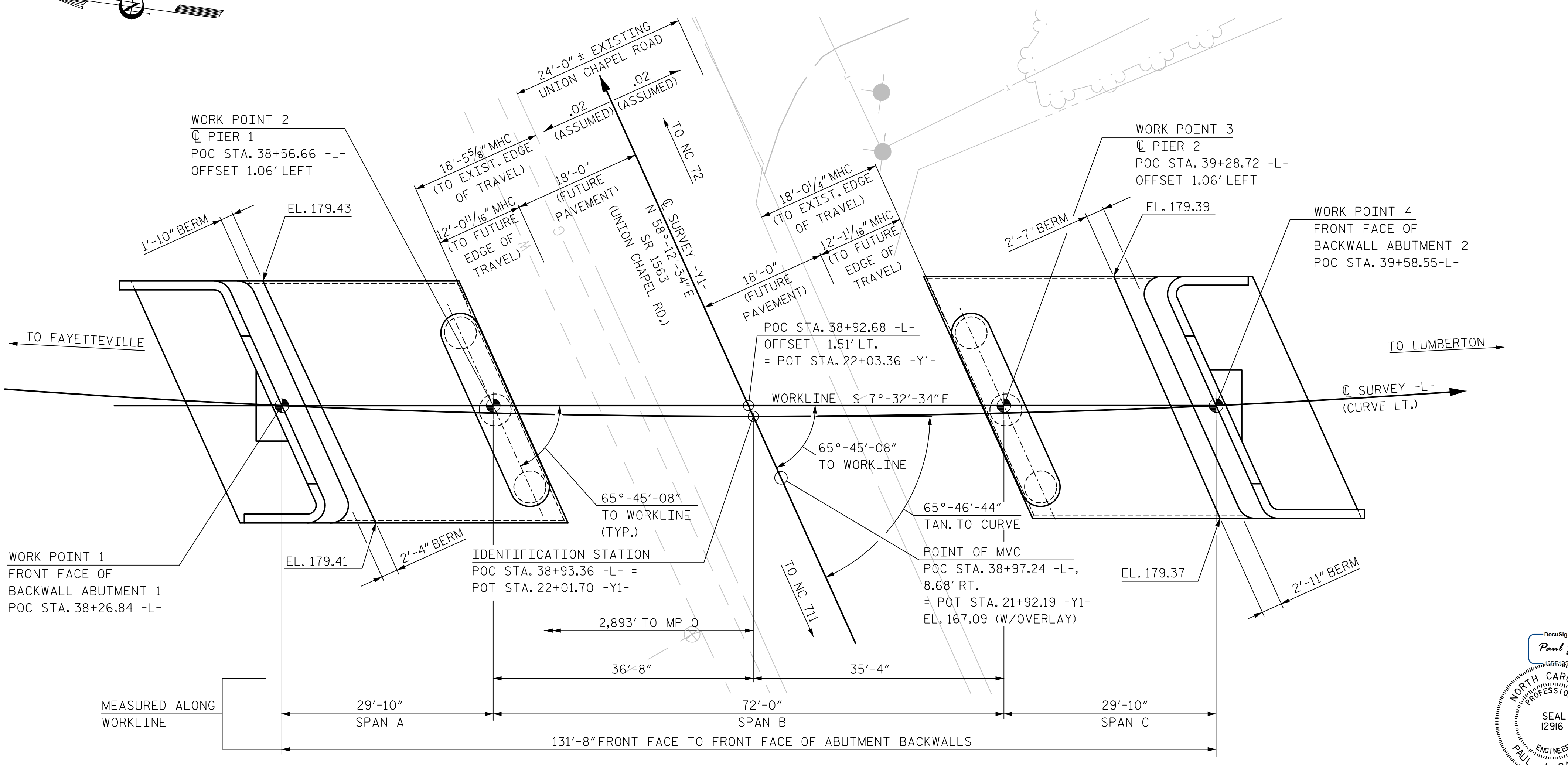

**CURVE DATA -L-**  
 PI STA. = 38+89.52 -L-  
 $\Delta = 71^\circ 34' 26.8''$  (LT)  
 $D = 4^\circ 00' 00.0''$   
 $L = 1,789.35'$   
 $T = 1,032.79'$   
 $R = 1,432.69'$   
 $SE = 4.25''$

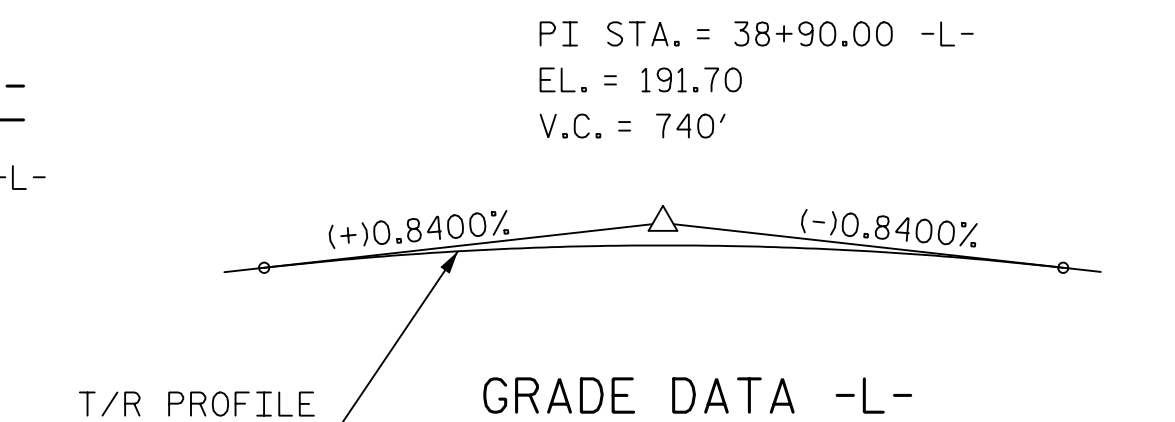

**PLAN**  
 NOTE: PILES NOT SHOWN FOR CLARITY.  
 WORKLINE SHALL BE THE -L- LINE LONG CHORD BETWEEN ABUTMENT WORK POINTS.

PROJECT NO. P-4900A  
ROBESON COUNTY  
 STATION: POC 38+93.36 -L- =  
POT 22+01.70 -Y1-  
 MILE POST: 0.55  
 SHEET 1 OF 4 BRIDGE NO. \_\_\_\_\_

DocuSigned by:  
**Paul J. Barber**

PAUL J. BARBER  
ENGINEER  
2/27/2015

DocuSigned by:  
**David W. Hawkins**

DAVID W. HAWKINS  
ENGINEER  
2/27/2015

STATE OF NORTH CAROLINA  
 DEPARTMENT OF TRANSPORTATION  
 RALEIGH

**GENERAL DRAWING**  
 BRIDGE ON PROPOSED  
 CONNECTING TRACK  
 OVER UNION CHAPEL ROAD  
 BETWEEN NC 72 AND NC 711

<b>HNTB</b> HNTB NORTH CAROLINA, P.C. License No. C-1554 343 E. Six Forks Rd., Suite 200, Raleigh, N.C. 27609		REVISIONS		SHEET NO.
DRAWN BY: J. BAYNE	DATE: 9/14	NO. 3	BY: DATE:	S-20
CHECKED BY: P. BARBER	DATE: 9/14	NO. 4	BY: DATE:	
DWG. NO. 1				TOTAL SHEETS: 54