

PHASING DIAGRAM

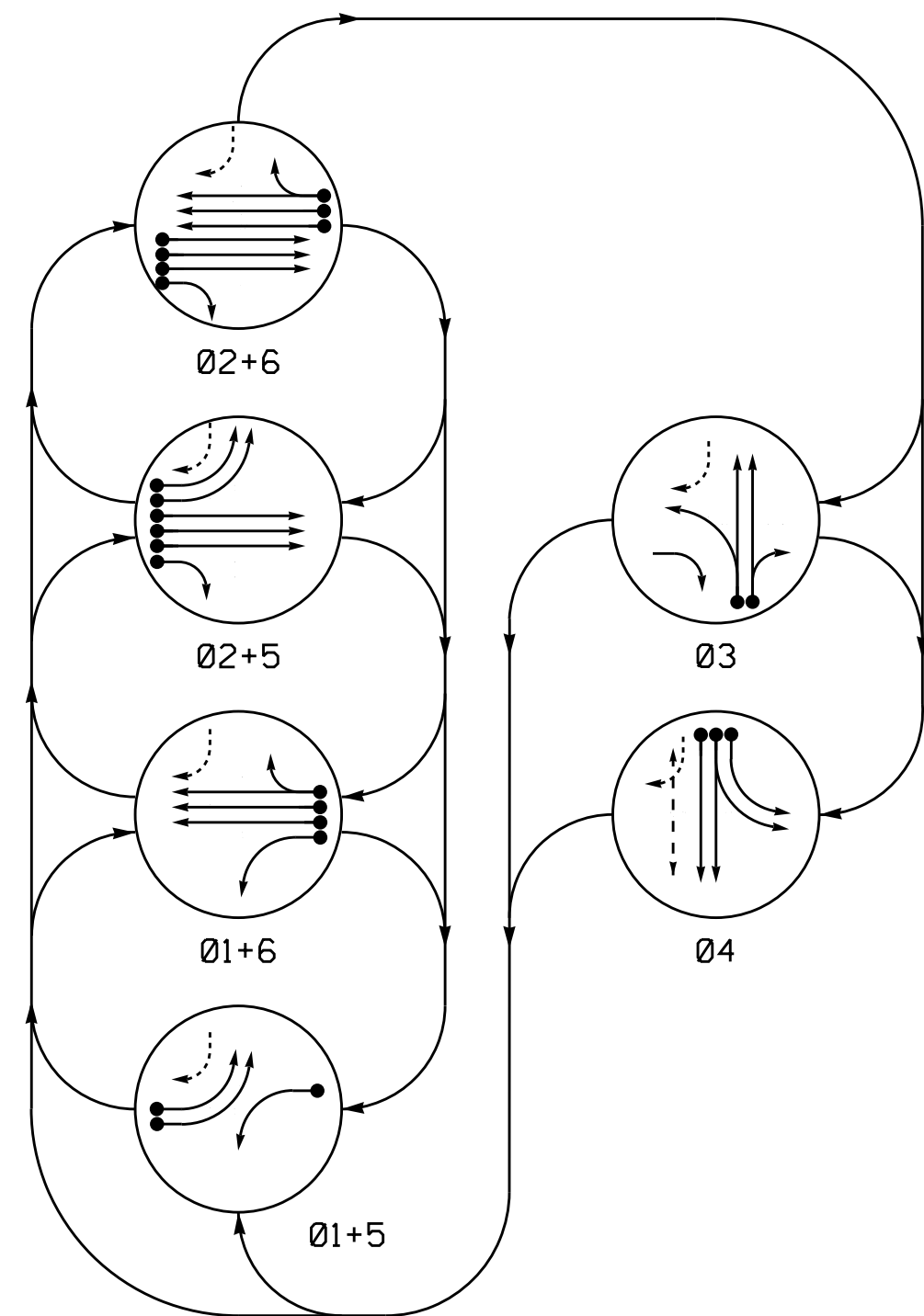

PHASING DIAGRAM DETECTION LEGEND

- ← ● DETECTED MOVEMENT
- ← ○ UNDETECTED MOVEMENT (OVERLAP)
- ← ▬ UNSIGNALIZED MOVEMENT
- ← - - - PEDESTRIAN MOVEMENT

TABLE OF OPERATION

SIGNAL FACE	PHASE					
	01+5	01+6	02+5	02+6	03	04
11	←	←	←	←	←	←
21, 22, 23	R	R	G	G	R	Y
24	R	R	G	G	R	Y
31	R	R	R	R	G	R
32, 33	R	R	R	R	G	R
41	←	←	←	←	←	←
42	R	R	R	R	G	R
43, 44	R	R	R	R	G	R
51, 52	←	←	←	←	←	←
61, 62, 63, 64	R	G	R	G	R	Y
P41, P42	DW	DW	DW	DW	W	DRK

SIGNAL FACE I.D.

All Heads L.E.D.

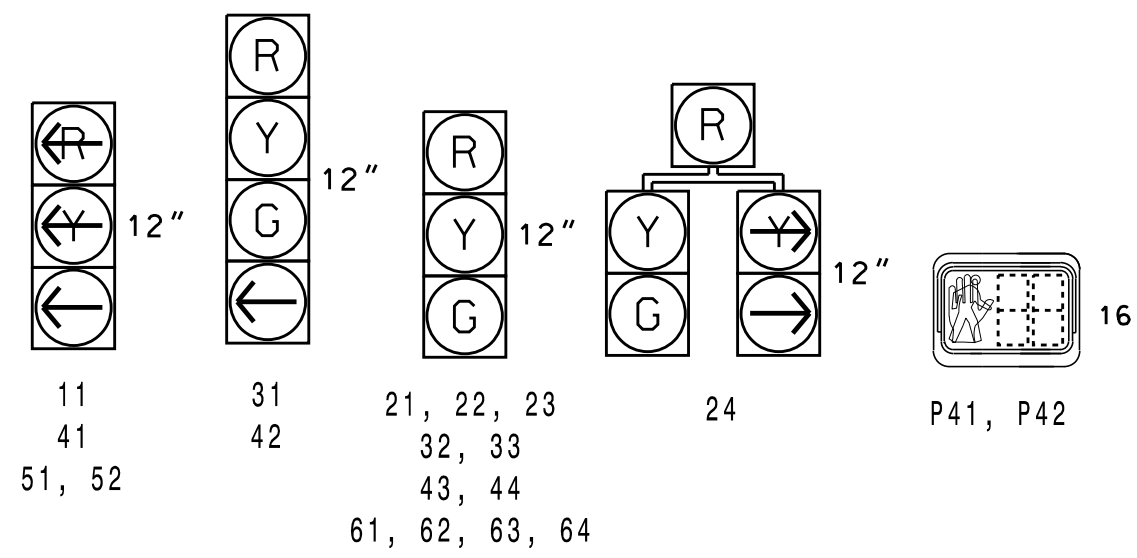

NEMA LOOP & DETECTOR INSTALLATION CHART with TS-2 CABINET

LOOP NO.	SIZE (ft)	DIST. FROM STOPBAR (ft)	TURNS	INDUCTIVE LOOPS		DETECTOR UNITS		TIMING FEATURE	TIMING TIME	INHIBIT DELAY DURING GREEN?
				NEW	EXISTING	NEW	EXISTING			
1A	6X40	+5	2-4-2	X	-	1	-	-	-	NO
2A	6X6	300	4	X	-	2	-	-	-	NO
2B	6X6	300	4	X	-	2	-	-	-	NO
2C	6X6	300	4	X	-	2	-	-	-	NO
3A	6X40	+5	2-4-2	X	-	3	-	-	-	NO
3B	6X40	+5	2-4-2	X	-	3	-	DELAY	10	YES
4A	6X40	+5	2-4-2	X	-	4	-	DELAY	3	YES
4B	6X40	+5	2-4-2	X	-	4	-	-	-	NO
4C	6X40	+5	2-4-2	X	-	4	-	-	-	NO
5A	6X40	+5	2-4-2	X	-	5	-	-	-	NO
5B	6X40	+5	2-4-2	X	-	5	-	-	-	NO
6A	6X6	300	6	X	-	6	-	-	-	NO
6B	6X6	300	6	X	-	6	-	-	-	NO
6C	6X6	300	6	X	-	6	-	-	-	NO

6 PHASE FULLY ACTUATED (GREENVILLE CITY SYSTEM)

NOTES

- Refer to "Roadway Standard Drawings NCDOT" dated January 2012 and "Standard Specifications for Roads and Structures" dated January 2012.
- Do not program signal for late night flashing operation unless otherwise directed by the Engineer.
- Phase 1 and/or phase 5 may be lagged.
- The order of phase 3 and phase 4 may be reversed.
- Set all detector units to presence mode.
- Omit "WALK" and flashing "DON'T WALK" with no pedestrian calls.
- Program pedestrian heads to countdown the flashing "Don't Walk" time only.
- Intersection Zone Number: 11 System Address Number: 53
- Contractor shall re-cut loops 1A, 6A, 6B and 6C as construction progresses from construction phase 1 to construction phase 2. Contractor to maintain
- Install black powder coated poles and pedestrian signal pedestals.
- Pedestrian pedestals are conceptual and shown for reference only. See sheets P1-P3 for pushbutton location details.

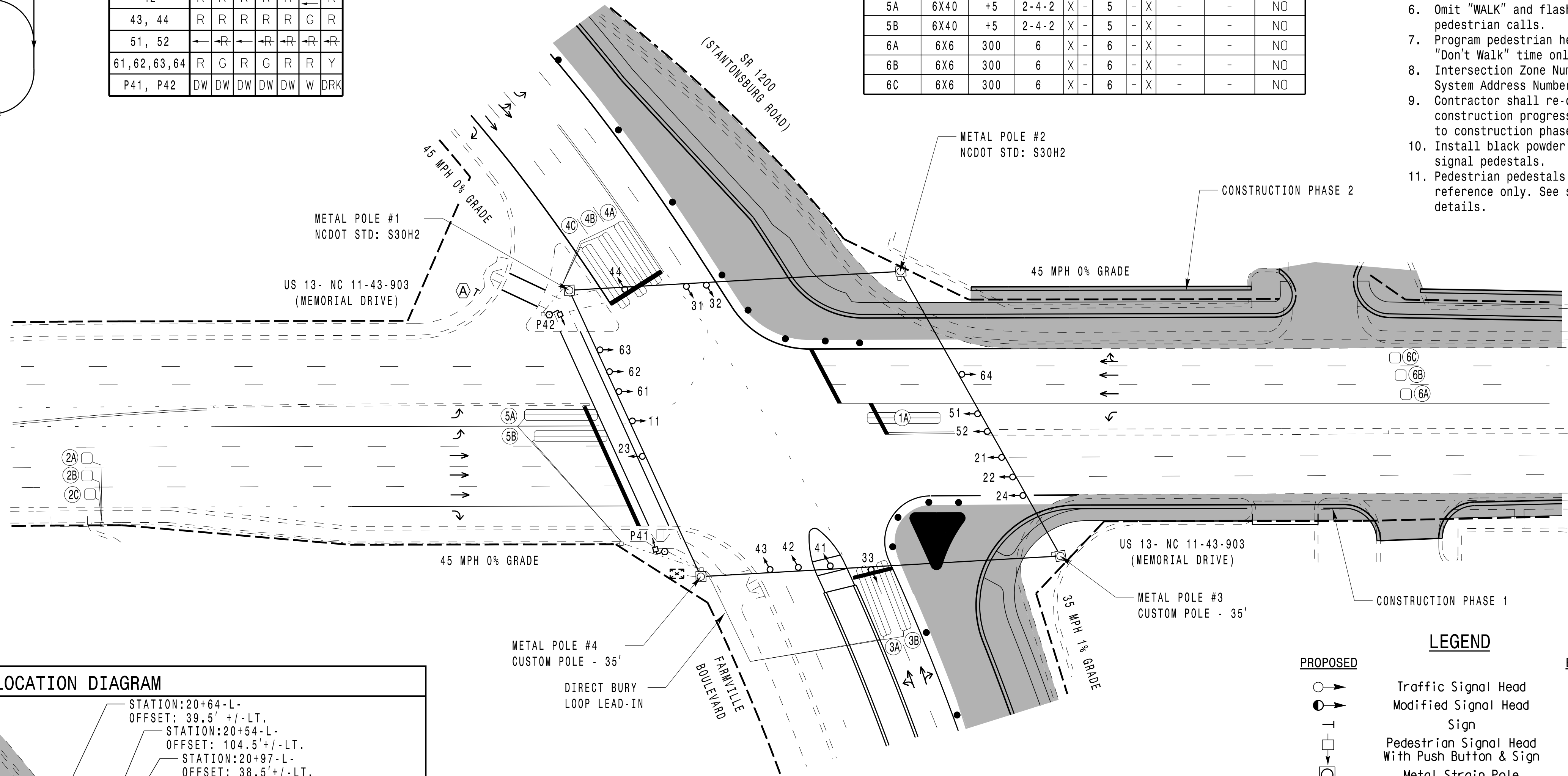

STOP LINE AND POLE LOCATION DIAGRAM

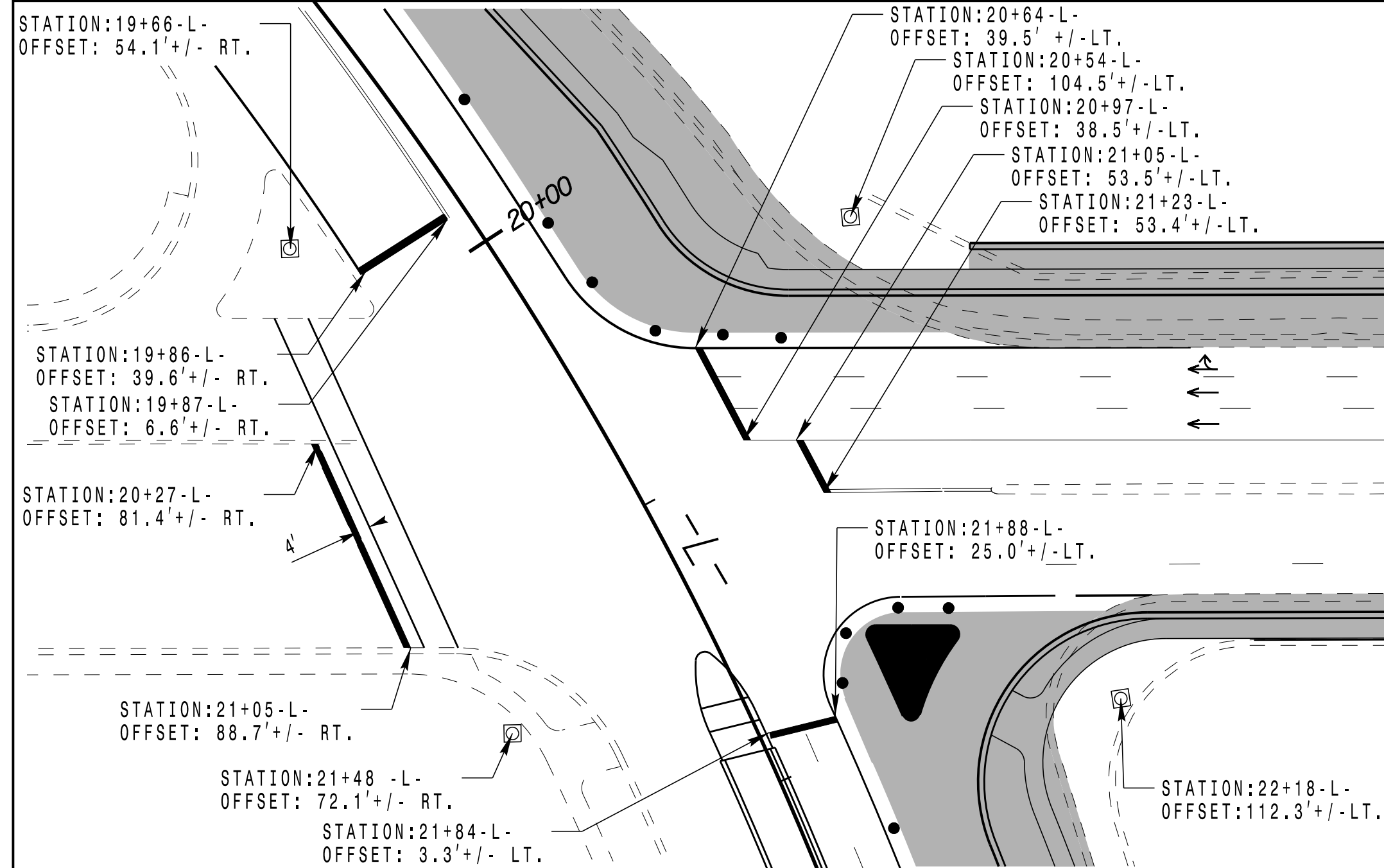

ASC3 NEMA TIMING CHART

FEATURE	PHASE					
	01	02	03	04	05	06
MINIMUM GREEN *	7 SEC.	12 SEC.	7 SEC.	7 SEC.	7 SEC.	12 SEC.
PASSAGE GAP *	2.0 SEC.	6.0 SEC.	2.0 SEC.	2.0 SEC.	2.0 SEC.	6.0 SEC.
YELLOW CHANGE INT.	3.0 SEC.	4.5 SEC.	3.8 SEC.	4.5 SEC.	3.0 SEC.	4.5 SEC.
RED CLEARANCE	2.9 SEC.	1.7 SEC.	3.8 SEC.	2.4 SEC.	3.1 SEC.	1.9 SEC.
MAXIMUM 1 *	30 SEC.	90 SEC.	45 SEC.	30 SEC.	30 SEC.	90 SEC.
RECALL POSITION	NONE	MIN. RECALL	NONE	NONE	NONE	MIN. RECALL
VEHICLE CALL MEMORY	NONLOCK	LOCK	NONLOCK	NONLOCK	NONLOCK	LOCK
WALK *	- SEC.	- SEC.	7 SEC.	- SEC.	- SEC.	- SEC.
FLASHING DON'T WALK	- SEC.	- SEC.	30 SEC.	- SEC.	- SEC.	- SEC.
VOLUME DENSITY	OFF	ON	OFF	OFF	OFF	ON
ACTUATION B4 ADD *	- VEH.	0 VEH.	- VEH.	- VEH.	- VEH.	0 VEH.
SEC. PER ACTUATION *	- SEC.	1.0 SEC.	- SEC.	- SEC.	- SEC.	1.0 SEC.
MAX. INITIAL *	- SEC.	3.4 SEC.	- SEC.	- SEC.	- SEC.	3.4 SEC.
TIME B4 REDUCTION *	- SEC.	1.5 SEC.	- SEC.	- SEC.	- SEC.	1.5 SEC.
TIME TO REDUCE *	- SEC.	4.5 SEC.	- SEC.	- SEC.	- SEC.	4.5 SEC.
MINIMUM GAP	- SEC.	3.0 SEC.	- SEC.	- SEC.	- SEC.	3.0 SEC.

* These values may be field adjusted. Do not adjust Min Green and Extension times for phases 2 and 6 lower than what is shown. Min Green for all other phases should not be lower than 4 seconds.

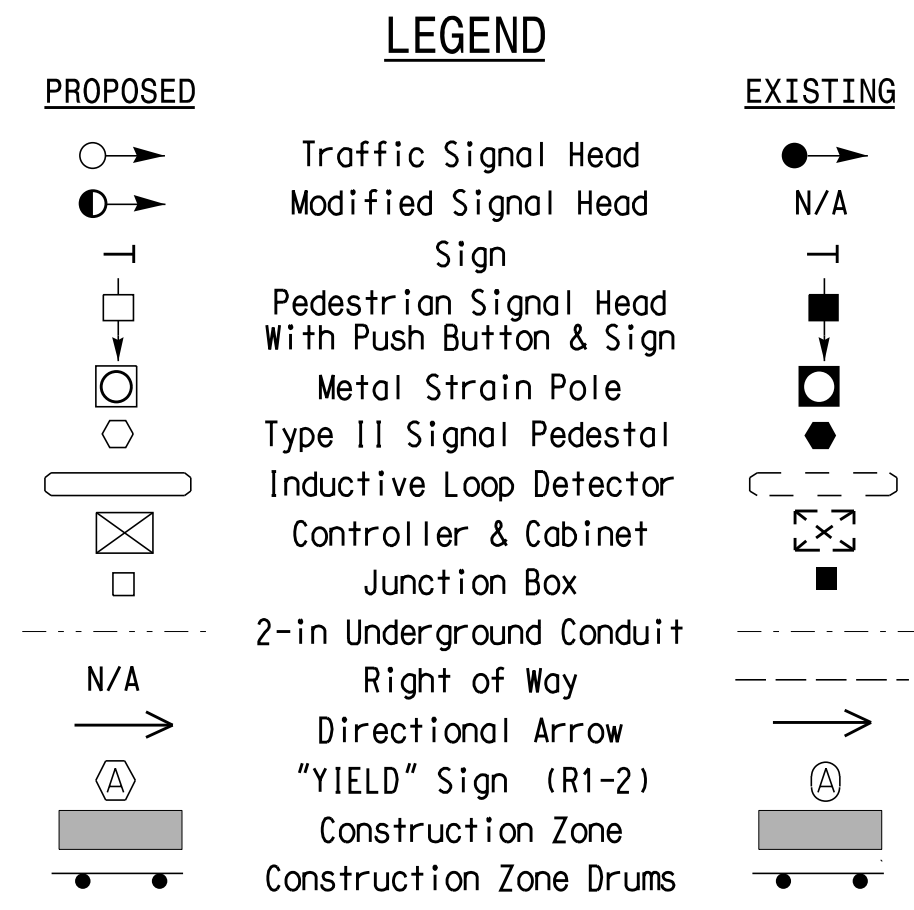

TEMPORARY DESIGN 2 - TMP PHASE 2

US 13- NC 11-43-903 (MEMORIAL DRIVE)
AT
SR 1200 (STANTONSBURG ROAD) /
FARMVILLE BOULEVARD

DIVISION 2 PITT COUNTY GREENVILLE

PLAN DATE: JUNE 2014 REVIEWED BY: SL PHILLIPS

PREPARED BY: SP PENNINGTON REVIEWED BY:

SEAL
NORTH CAROLINA
PROFESSIONAL
ENGINEER
STACIE L. PHILLIPS

9/2/2014

Scale: 1" = 40'

8/29/2014 10:56:10 AM susan.pennington k:\RAL_Roadway\011036175 (U-3315)\Traffic\Sigals\64 - Signal Design\02-063_Memorials\SIG 1.3 02063_14082912.dgn