

**PLANT SCHEDULE L7**

TREES	QTY	BOTANICAL NAME	COMMON NAME	CONT	CAL	SIZE	REMARKS	
LN	16	Lagerstroemia x 'Natchez'	Natchez Crape Myrtle	B&B		10' HT.	Three Canes	
SHRUBS	QTY	BOTANICAL NAME	COMMON NAME	SIZE	WIDTH	HEIGHT	SPACING	REMARKS
GL	9	Gaura lindheimeri 'Whirling Butterflies'	Whirling Butterflies Gaura	Cont.	18"	18"	24" o.c.	
IB	27	Ilex vomitoria 'Nana'	Dwarf Yaupon Holly	Cont.	18"	18"	36" o.c.	
ORNAMENTAL GRASSES	QTY	BOTANICAL NAME	COMMON NAME	SIZE	WIDTH	HEIGHT	SPACING	REMARKS
PV	8	Panicum virgatum 'Dallas Blues' TM	Dallas Blues Switch Grass	Cont.	24"	24"	42" o.c.	
GROUND COVERS	QTY	BOTANICAL NAME	COMMON NAME	CONT	WIDTH	HEIGHT	SPACING	REMARKS
AO	273	Aster oblongifolius 'October Skies'	Aromatic Aster	Cont.	12"	12"	18" o.c.	
SOD/SEED	QTY	BOTANICAL NAME	COMMON NAME	CONT	WIDTH	HEIGHT	SPACING	REMARKS
EO	577 sf	Eremochloa ophiuroides 'Tif Blair' TM	Centipede Grass	sod				
ET	89,193 sf	Eremochloa ophiuroides 'Tif Blair' TM	Centipede Grass	Seed				
MULCH	2,500 SF	Double Shredded Hardwood						

PLAN LEGEND	
☒	NEIGHBORHOOD MARKER DETAIL SHEET LD 2
✳	PEDESTRIAN POST TOP LIGHT
⬆	STREET LIGHT
▨	SODDED LAWN ALL OTHER DISTURBED AREAS TO BE SEEDED AS PART OF ROADWAY WORK
⬇	SEEDED LAWN

**LANDSCAPE NOTES:**

- ALL PLANT MATERIAL SHALL COMPLY WITH 'AMERICAN STANDARDS FOR NURSERY STOCK' (ANSI Z60.1).
- ANY PLANT SUBSTITUTIONS OR FIELD ADJUSTMENTS SHALL BE APPROVED BY THE CITY OF GREENVILLE OR OWNER'S REPRESENTATIVE.
- ALL PLANTED BEDS TO BE AMENDED WITH THE SPECIFIED AMOUNT OF COMPOST AND TOPSOIL PER PROJECT SPECIAL PROVISIONS.
- ANY TREES NOT INCORPORATED INTO PLANT BEDS SHALL HAVE A 4' DIAMETER MULCH RING.
- ALL SINGLE STEM TREES SHALL BE LIMBED UP MINIMUM 6' FOR SITE DISTANCE.
- ALL PLANT BEDS TO HAVE MULCH LAYER PER DETAILS.
- ALL SODDED AND SEEDED AREAS TO BE IMPROVED VARIETY CENTIPEDE PER SPECIAL PROVISIONS.

**GENERAL NOTES:**

- DESIGN SPEED : 45MPH

**Kimley»Horn**

Kimley-Horn  
and Associates, Inc.

P.O. BOX 33068  
RALEIGH, N.C. 27636

RIGHT-OF-WAY REV.  
CONST. REV.

PROJECT REFERENCE NO.	SHEET NO.
U-3315	L 7
R/W SHEET NO.	
DocuSigned by: <i>Brandon P. White</i>	LANDSCAPE ARCHITECT
9931B1C7B2D44DE...	1625
5/8/2015	



REVISIONS

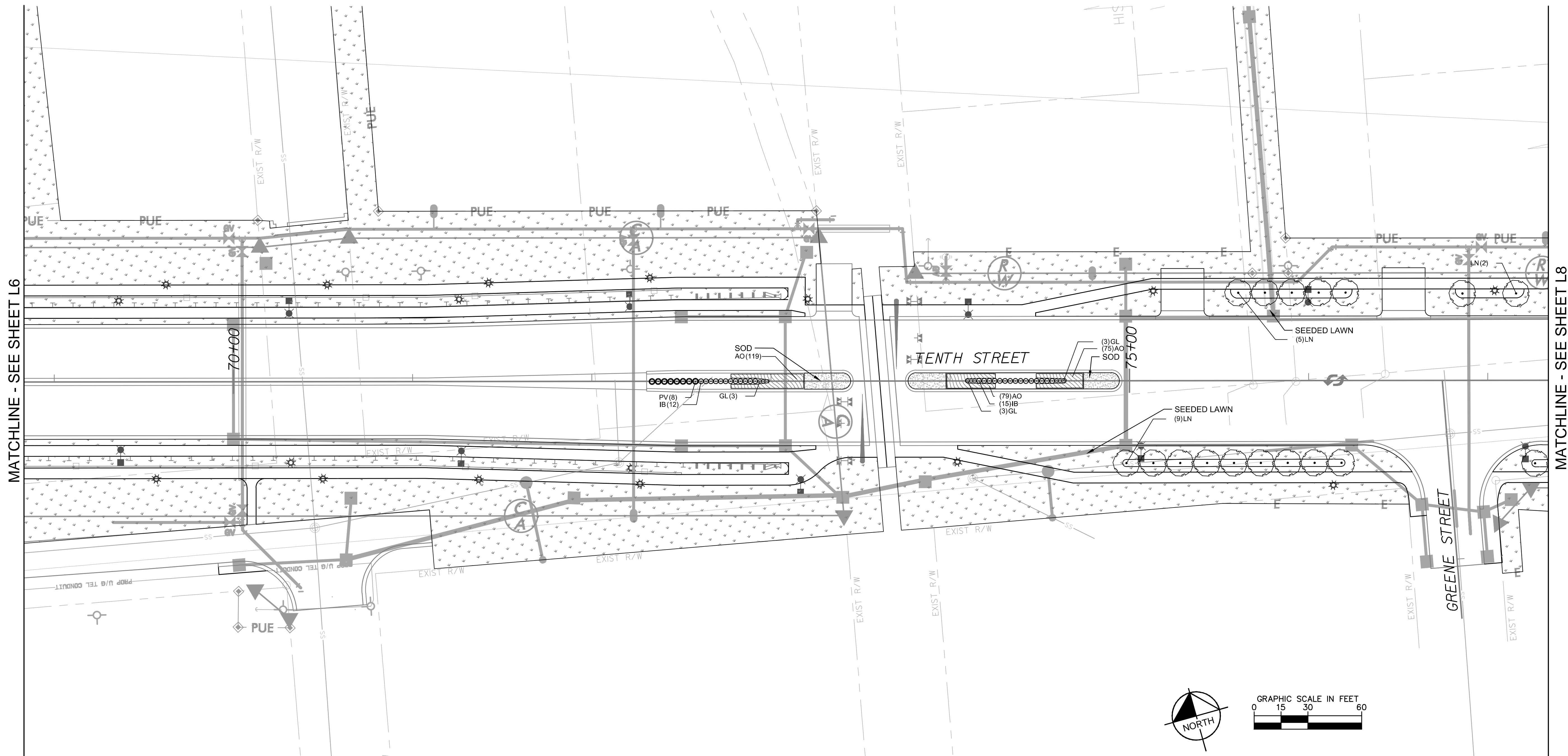

05-08-2015