

**PLANT SCHEDULE L6**

| TREES  | QTY | BOTANICAL NAME                                 | COMMON NAME                  | CONT  | CAL   | SIZE         | REMARKS                   |         |
|--------|-----|--|------------------------------|-------|-------|--------------|---------------------------|---------|
| AB     | 9   | Acer buergerianum                              | Trident Maple                | B&B   | 2"Cal | 14' HT       |                           |         |
| AP     | 9   | Acer palmatum 'Bloodgood'                      | Bloodgood Japanese Maple     | B&B   | 2"Cal | 10' HT.      | Matched specimens         |         |
| IA     | 11  | Ilex x attenuata 'Foster No. 2'                | Foster No. 2 Holly           | B&B   |       | 8' HT.       |                           |         |
| IG     | 3   | Ilex opaca 'Greenleaf'                         | Greenleaf Holly              | B&B   |       | 8' HT.       | Single stem, limbed up 3' |         |
| LA     | 6   | Lagerstroemia x 'Miami'                        | Crape Myrtle                 | B&B   |       | 10' HT.      | Three Canes               |         |
| LI     | 14  | Lagerstroemia indica 'Victor'                  | Victor Crape Myrtle (Dwarf)  | B&B   |       | 36" HT. MIN. |                           |         |
| LX     | 14  | Lagerstroemia x 'Muskogee'                     | Muskogee Crape Myrtle        | B&B   |       | 10' HT.      | Multi-stem                |         |
| TD     | 3   | Taxodium distichum 'Autumn Gold'               | Autumn Gold Bald Cypress     | B&B   | 2"Cal | 14' HT       |                           |         |
| UP     | 9   | Ulmus parvifolia 'Athena'                      | Athena Elm                   | B&B   | 2"Cal | 14' HT       |                           |         |
| SHRUBS | QTY | BOTANICAL NAME                                 | COMMON NAME                  | SIZE  | WIDTH | HEIGHT       | SPACING                   | REMARKS |
| AA     | 44  | Azalea Encore 'Autumn Angel' TM                | Autmn Angel Azalea           | Cont. | 24"   | 24"          | 36" o.c.                  |         |
| BD     | 20  | Buddleja davidii nanhoensis 'Petite Indigo' TM | Petite Indigo Butterfly Bush | Cont. | 24"   | 12"-15"      | 36" o.c.                  |         |
| DG     | 23  | Cephalotaxus harringtonia 'Duke's Garden'      | Duke's Garden Plum Yew       | Cont. | 24"   | 18"          | 54" o.c.                  |         |
| FI     | 27  | Forsythia x intermedia 'Mindor' PP# 19,321     | Show Off Forsythia           | Cont. | 30"   | 30"          | 54" o.c.                  |         |
| IB     | 127 | Ilex vomitoria 'Nana'                          | Dwarf Yaupon Holly           | Cont. | 18"   | 18"          | 36" o.c.                  |         |
| IV     | 18  | Itea virginica                                 | Virginia Willow              | Cont. | 24"   | 24"          | 48" o.c.                  |         |

**PLAN LEGEND**

|  |  |
|--|--|
|  | NEIGHBORHOOD MARKER<br>DETAIL SHEET LD 2   |
|  | PEDESTRIAN POST<br>TOP LIGHT   |
|  | STREET LIGHT   |
|  | SODDED LAWN<br>ALL OTHER DISTURBED AREAS TO BE<br>SEEDED AS PART OF ROADWAY WORK |
|  | SEEDED LAWN  |

- LANDSCAPE NOTES:**
- ALL PLANT MATERIAL SHALL COMPLY WITH 'AMERICAN STANDARDS FOR NURSERY STOCK' (ANSI Z60.1).
  - ANY PLANT SUBSTITUTIONS OR FIELD ADJUSTMENTS SHALL BE APPROVED BY THE CITY OF GREENVILLE OR OWNER'S REPRESENTATIVE.
  - ALL PLANTED BEDS TO BE AMENDED WITH THE SPECIFIED AMOUNT OF COMPOST AND TOPSOIL PER PROJECT SPECIAL PROVISIONS.
  - ANY TREES NOT INCORPORATED INTO PLANT BEDS SHALL HAVE A 4' DIAMETER MULCH RING.
  - ALL SINGLE STEM TREES SHALL BE LIMBED UP MINIMUM 6' FOR SITE DISTANCE.
  - ALL PLANT BEDS TO HAVE MULCH LAYER PER DETAILS.
  - ALL SODDED AND SEEDED AREAS TO BE IMPROVED VARIETY CENTIPEDE PER SPECIAL PROVISIONS.

- GENERAL NOTES:**
- DESIGN SPEED : 45MPH

| GROUND COVERS      | QTY       | BOTANICAL NAME                        | COMMON NAME                   | CONT  | WIDTH | HEIGHT | SPACING  | REMARKS                            |
|--------------------|-----------|---------------------------------------|-------------------------------|-------|-------|--------|----------|------------------------------------|
| HH                 | 437       | Hemerocallis x 'Stella de Oro'        | Stella de Oro Daylily         | Cont. | 18"   | 18"    | 24" o.c. |                                    |
| ORNAMENTAL GRASSES | QTY       | BOTANICAL NAME                        | COMMON NAME                   | CONT  | WIDTH | HEIGHT | SPACING  | REMARKS                            |
| CL                 | 147       | Chasmanthium latifolium 'River Mist'  | Variiegated Northern Sea Oats | Cont. | 24"   | 24"    | 30" o.c. |                                    |
| SOD/SEED           | QTY       | BOTANICAL NAME                        | COMMON NAME                   | CONT  | WIDTH | HEIGHT | SPACING  | REMARKS                            |
| EO                 | 39,935 sf | Eremochloa ophiuroides 'Tif Blair' TM | Centipede Grass               | Cont. |       |        |          | sod                                |
| ET                 | 77,773 sf | Eremochloa ophiuroides 'Tif Blair' TM | Centipede Grass               | Seed  |       |        |          |                                    |
| MULCH              |           |                                       |                               |       |       |        |          | 11,100 SF Double Shredded Hardwood |

**Kimley»Horn**  
Kimley-Horn and Associates, Inc.  
P.O. BOX 33068  
RALEIGH, N.C. 27636

PROJECT REFERENCE NO. U-3315  
SHEET NO. L 6

DocuSigned by:  
Brandon P. White  
9931B1C7B2D44DE...  
5/8/2015

RIGHT-OF-WAY REV.  
CONST. REV.

LANDSCAPE ARCHITECT  
NORTH CAROLINA  
REGISTERED LANDSCAPE ARCHITECT  
1625  
BRANDON PHILLIP WHITE

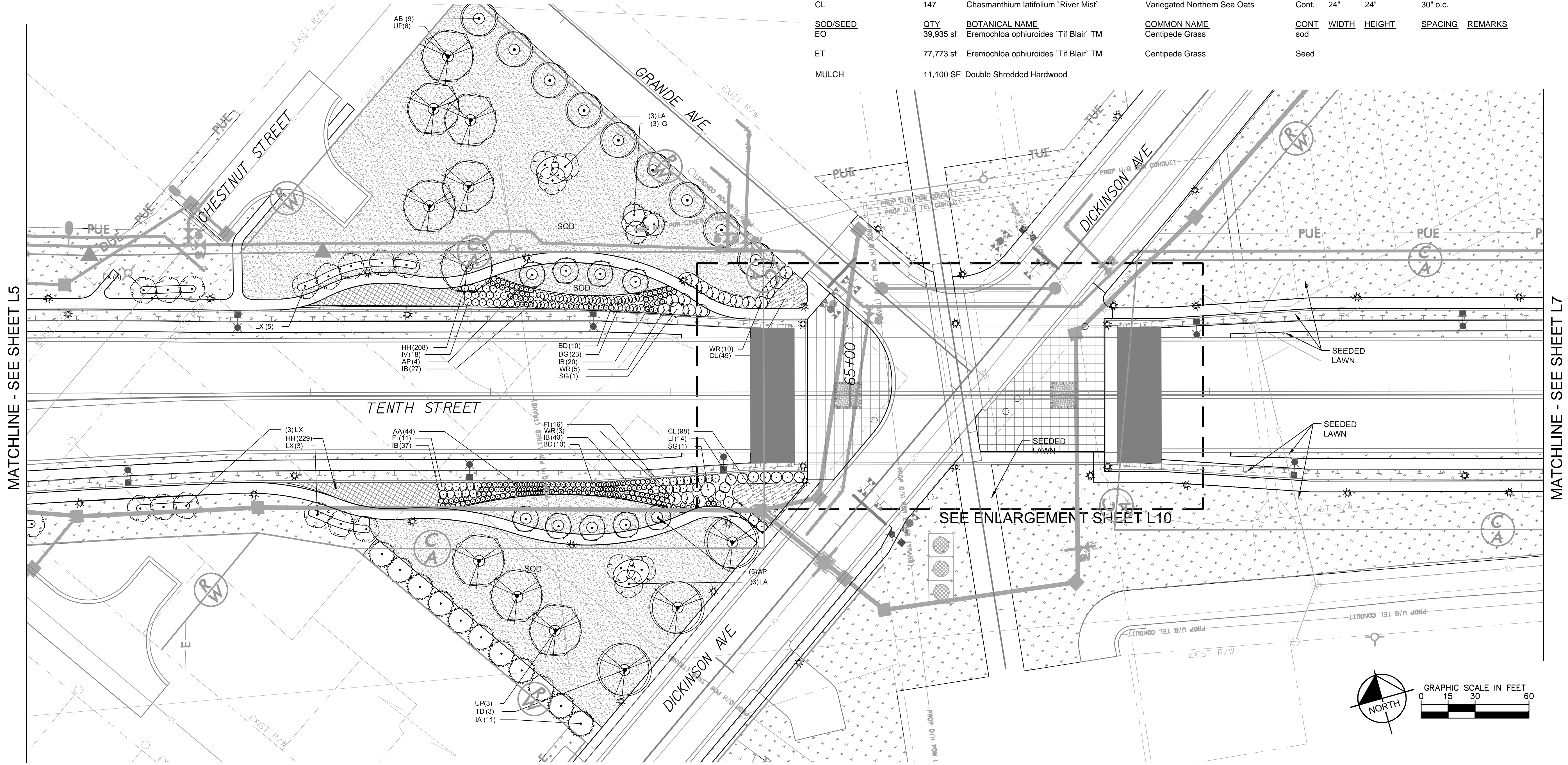

REVISIONS

MATCHLINE - SEE SHEET L5

MATCHLINE - SEE SHEET L7

05-08-2015