

PLANT SCHEDULE L5

TREES	QTY	BOTANICAL NAME	COMMON NAME	CONT	CAL	SIZE	REMARKS	
LX	24	Lagerstroemia x 'Muskogee'	Muskogee Crape Myrtle	B&B		10' HT.	Multi-stem	
QN	5	Quercus nuttallii	Nuttall Oak	B&B	2"Cal	14' HT		
TD	13	Taxodium distichum 'Autumn Gold'	Autumn Gold Bald Cypress	B&B	2"Cal	14' HT		
UP	7	Ulmus parvifolia 'Athena'	Athena Elm	B&B	2"Cal	14' HT		
SHRUBS	QTY	BOTANICAL NAME	COMMON NAME	SIZE	WIDTH	HEIGHT	SPACING	REMARKS
FI	8	Forsythia x intermedia 'Mindor' PP# 19,321	Show Off Forsythia	Cont.	30"	30"	54" o.c.	
IB	104	Ilex vomitoria 'Nana'	Dwarf Yaupon Holly	Cont.	18"	18"	36" o.c.	
IH	195	Raphiolepis indica 'Conor' PP#9398	Eleanor Taber Indian Hawthorn	Cont.	24"	24"	36" o.c.	
IS	7	Ilex crenata 'Steeds'	Steeds Japanese Holly	Cont.	36"	36"	60" o.c.	
ORNAMENTAL GRASSES	QTY	BOTANICAL NAME	COMMON NAME	SIZE	WIDTH	HEIGHT	SPACING	REMARKS
PV	10	Panicum virgatum 'Dallas Blues' TM	Dallas Blues Switch Grass	Cont.	24"	24"	42" o.c.	
GROUND COVERS	QTY	BOTANICAL NAME	COMMON NAME	CONT	WIDTH	HEIGHT	SPACING	REMARKS
HH	248	Hemerocallis x 'Stella de Oro'	Stella de Oro Daylily	Cont.	18"	18"	24" o.c.	
SOD/SEED	QTY	BOTANICAL NAME	COMMON NAME	CONT	WIDTH	HEIGHT	SPACING	REMARKS
EO	18,748 sf	Eremochloa ophiuroides 'Tif Blair' TM	Centipede Grass	sod				
ET	54,737 sf	Eremochloa ophiuroides 'Tif Blair' TM	Centipede Grass	Seed				
MULCH	10,100 SF	Double Shredded Hardwood						

PLAN LEGEND	
	NEIGHBORHOOD MARKER DETAIL SHEET LD 2
	PEDESTRIAN POST TOP LIGHT
	STREET LIGHT
	SODDED LAWN ALL OTHER DISTURBED AREAS TO BE SEEDED AS PART OF ROADWAY WORK
	SEEDED LAWN

LANDSCAPE NOTES:

- ALL PLANT MATERIAL SHALL COMPLY WITH 'AMERICAN STANDARDS FOR NURSERY STOCK' (ANSI Z60.1).
- ANY PLANT SUBSTITUTIONS OR FIELD ADJUSTMENTS SHALL BE APPROVED BY THE CITY OF GREENVILLE OR OWNER'S REPRESENTATIVE.
- ALL PLANTED BEDS TO BE AMENDED WITH THE SPECIFIED AMOUNT OF COMPOST AND TOPSOIL PER PROJECT SPECIAL PROVISIONS.
- ANY TREES NOT INCORPORATED INTO PLANT BEDS SHALL HAVE A 4' DIAMETER MULCH RING.
- ALL SINGLE STEM TREES SHALL BE LIMBED UP MINIMUM 6' FOR SITE DISTANCE.
- ALL PLANT BEDS TO HAVE MULCH LAYER PER DETAILS.
- ALL SODDED AND SEEDED AREAS TO BE IMPROVED VARIETY CENTIPEDE PER SPECIAL PROVISIONS.

GENERAL NOTES:

- DESIGN SPEED : 45MPH

Kimley»Horn

Kimley-Horn
and Associates, Inc.

P.O. BOX 33068
RALEIGH, N.C. 27636

RIGHT-OF-WAY REV.
CONST. REV.

PROJECT REFERENCE NO.	SHEET NO.
U-3315	L 5
RW SHEET NO.	
DocuSigned by: <i>Brandon P. White</i>	LANDSCAPE ARCHITECT
9931B1C7B2D44DE...	1625
5/8/2015	



REVISIONS

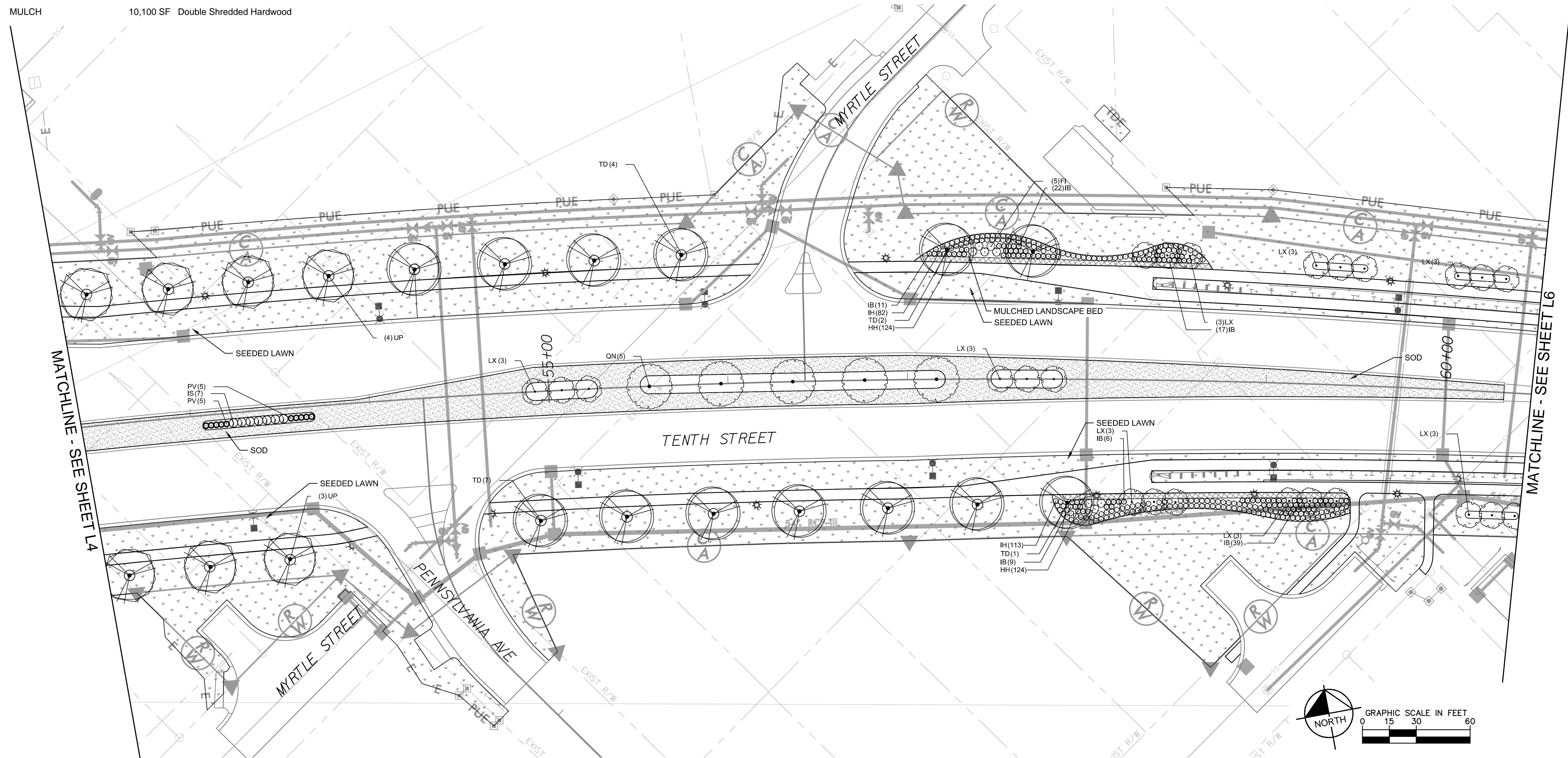

MATCHLINE - SEE SHEET L4

MATCHLINE - SEE SHEET L6

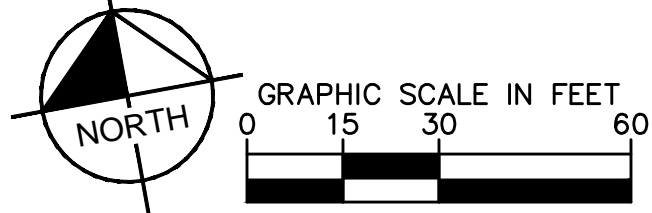

05-08-2015