

- 40 WILLIAM L. SANDERS & WF. DEBORAH E. SANDERS
- 41 BOYD, BOBBY E.
- 43 CARL FODUS CHERRY, & MAMIE CHERRY
- 45 TURNAGE, LULA J.
- 51 WILLIE LEE MOORE & WF. ALICE P. MOORE
- 52 BOBBY R. BOWEN & BLANCHE H. WILSON
- 53 BOBBY R. BOWEN, SR MARSHALL L. BOWEN
- 54 BOBBY R. BOWEN & BLANCHE H. WILSON
- 171 JONATHAN SUTTON & TODD SUTTON

# Kimley»Horn

P.O. BOX 33068 • RALEIGH, N.C. 27636-3068

RIGHT-OF-WAY REV.  
CONST. REV.

PROJECT REFERENCE NO. U-3315	SHEET NO. EC-7/CONST. 7
R/W SHEET NO.	HYDRAULICS ENGINEER
ROADWAY ENGINEER	ENGINEER

REVISIONS

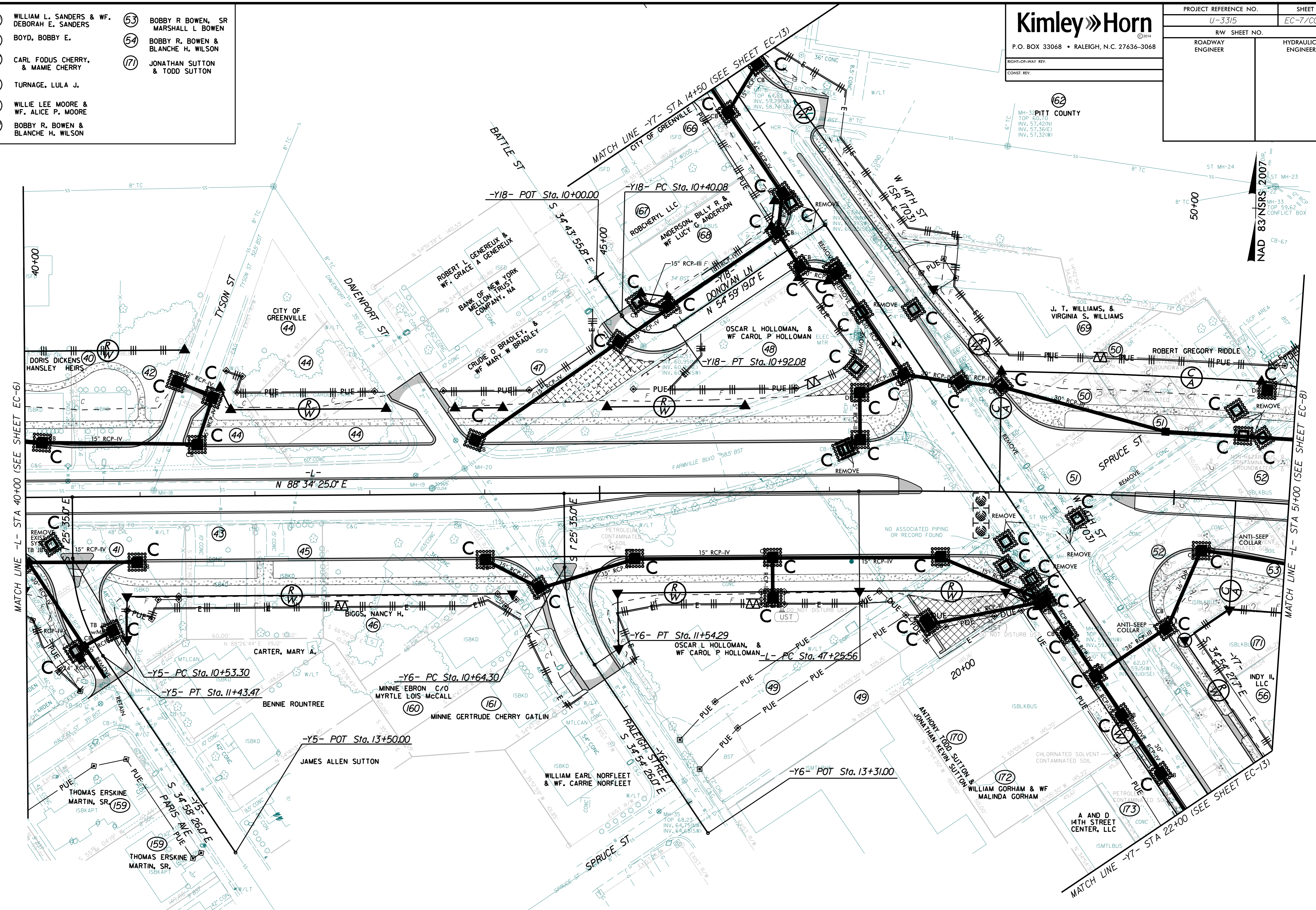

NOTE:  
PRIOR TO FINAL PAVING, CONTRACTOR SHALL PROTECT ALL OPENINGS IN DRAINAGE STRUCTURES FROM SEDIMENT.