

PROJECT REFERENCE NO.	SHEET NO.
U-3315	20
ROADWAY DESIGN ENGINEER	HYDRAULICS ENGINEER

REVISIONS

BM \*1  
LAG BOLT IN UTILITY POLE  
-YI- STA 10+63.37 (50.71' RT)  
ELEV = 71.26'

BEGIN GRADE  
-YI- STA 10+95.00  
ELEV = 71.08'  
TIE TO EXIST PAVEMENT

PI = 14+71.00  
EL = 70.38'  
VC = 150'  
K = 338  
DS > 80 MPH

PI = 18+61.00  
EL = 71.40'  
VC = 150'  
K = 321  
DS > 80 MPH

-L- STA 20+87.60 =  
-YI- STA 18+61.30  
ELEV = 71.31'

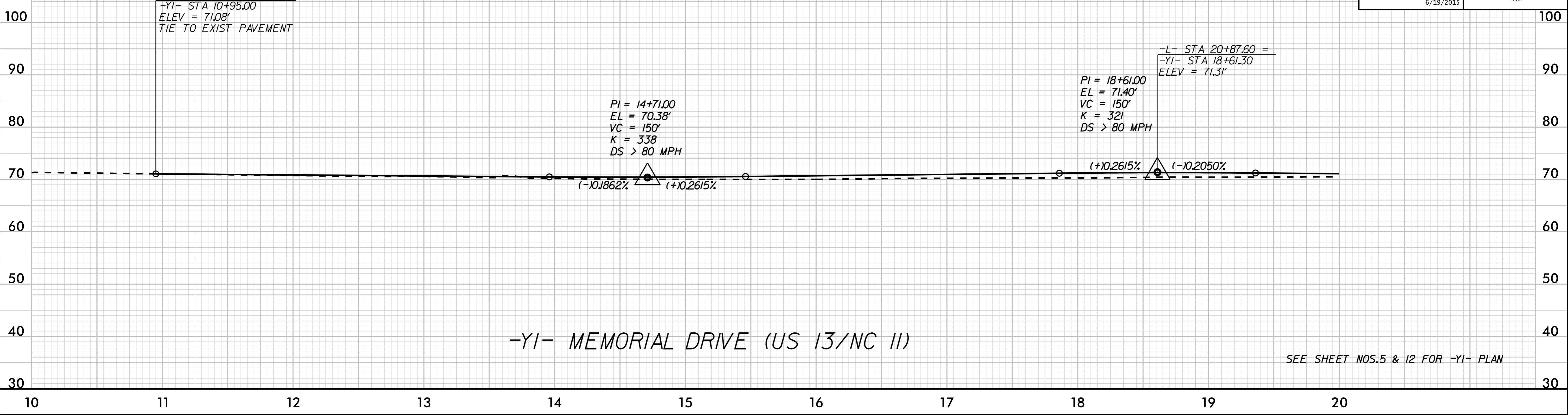

SEE SHEET NOS.5 & 12 FOR -YI- PLAN

BM \*3  
LAG BOLT IN UTILITY POLE  
-YI- STA 29+55.66 (54.38' RT)  
ELEV = 73.79'

PI = 21+39.00  
EL = 70.83'  
VC = 150'  
K = 418  
DS > 80 MPH

END GRADE  
-YI- STA 26+26.00  
ELEV = 71.58'  
TIE TO EXIST PAVEMENT

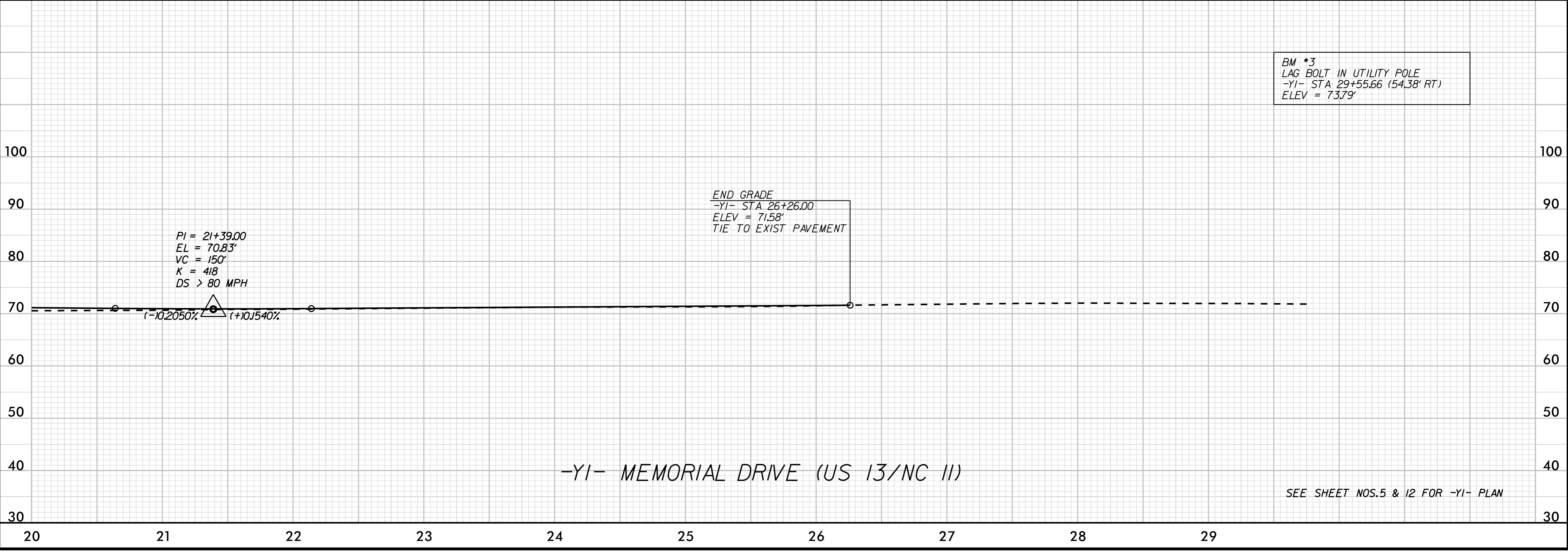

SEE SHEET NOS.5 & 12 FOR -YI- PLAN

K:\RAL\_Roadway\01036175 (U-3315)\Roadway\Proj\U-3315\_rdy\_pl.dgn  
5/12/2015