

PROJECT REFERENCE NO. U-3315	SHEET NO. 10
RW SHEET NO.	HYDRAULICS ENGINEER
ROADWAY ENGINEER	DAVID L. SMITH 7/15/2015

Kimley Horn
P.O. BOX 33068 • RALEIGH, N.C. 27636-3068
RIGHT-OF-WAY REV.
CONST. REV.

-L-	-Y13-
PI Sta 80+28.31	PI Sta 14+05.89
$\Delta = 4^{\circ} 37' 02.6''$ (LT)	$\Delta = 0^{\circ} 25' 57.2''$ (LT)
D = 1'08" 45.3"	D = 0' 34" 22.6"
L = 402.94'	L = 75.50'
T = 201.58'	T = 37.75'
R = 5,000.00'	R = 10,000.00'
DS > 40 MPH	DS > 40 MPH
SE = NC	SE = NC
RO = NONE	RO = NONE

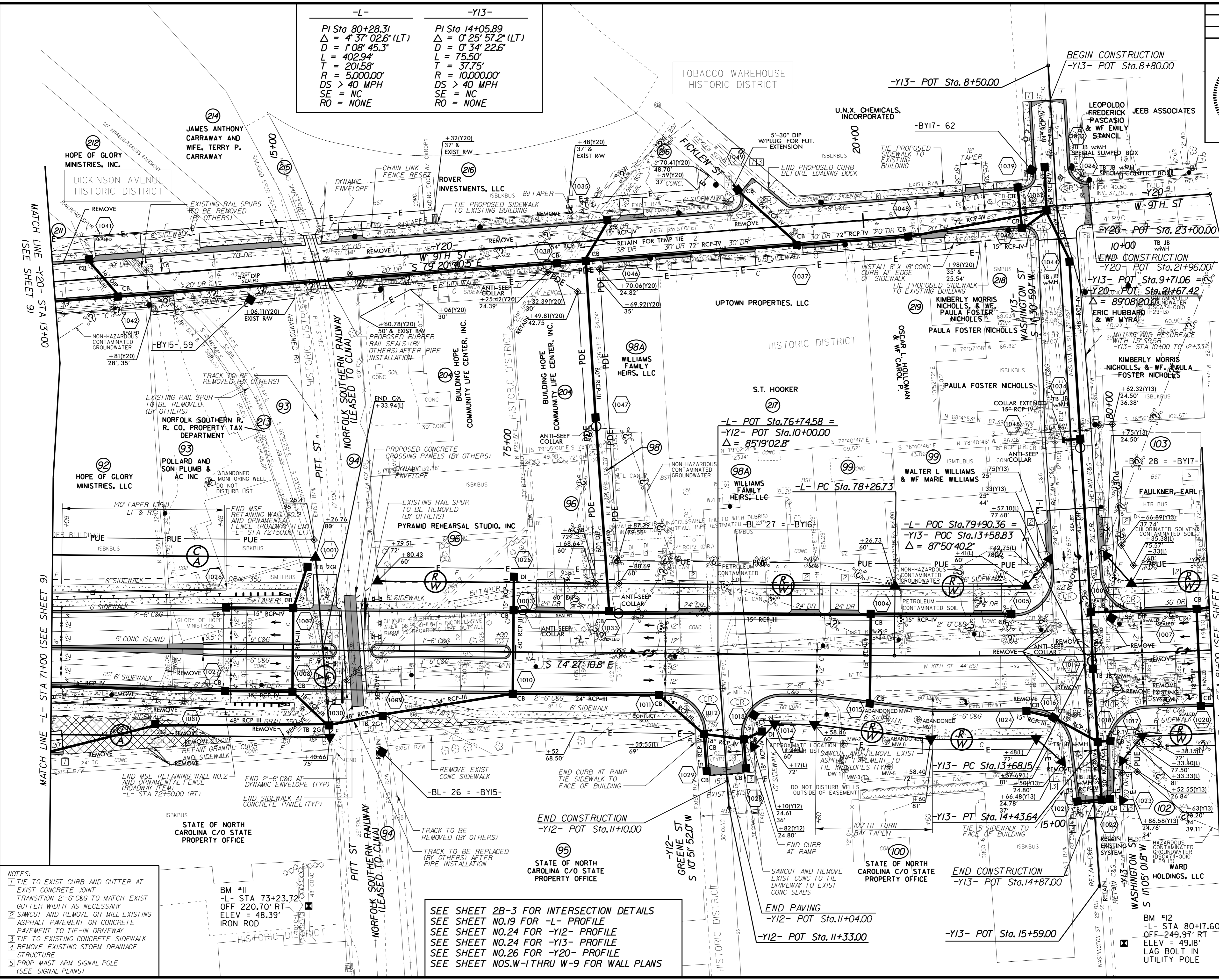

- NOTES:
- TIE TO EXIST CURB AND GUTTER AT EXIST CONCRETE JOINT TRANSITION 2'-6" C&G TO MATCH EXIST GUTTER WIDTH AS NECESSARY
 - SAWCUT AND REMOVE OR MILL EXISTING ASPHALT PAVEMENT OR CONCRETE PAVEMENT TO TIE-IN DRIVEWAY
 - TIE TO EXISTING CONCRETE SIDEWALK
 - REMOVE EXISTING STORM DRAINAGE STRUCTURE
 - PROP MAST ARM SIGNAL POLE (SEE SIGNAL PLANS)

SEE SHEET 2B-3 FOR INTERSECTION DETAILS
SEE SHEET NO.19 FOR -L- PROFILE
SEE SHEET NO.24 FOR -Y12- PROFILE
SEE SHEET NO.24 FOR -Y13- PROFILE
SEE SHEET NO.26 FOR -Y20- PROFILE
SEE SHEET NOS.W-I THRU W-9 FOR WALL PLANS

REMOVAL OF EXISTING ASPHALT PAVEMENT

REVISIONS

MATCH LINE -Y20- STA 13+00 (SEE SHEET 9)

MATCH LINE -L- STA 71+00 (SEE SHEET 9)

MATCH LINE -L- STA 81+00 (SEE SHEET 11)

100' SRS 200' NAD 83

K:\RAL_Roadway\01036175 U-3315\Roadway\Pro\U-3315-rad_psh0.dgn
7/9/2015