

PROJECT REFERENCE NO. U-3315	SHEET NO. 8
Roadway Engineer TERRY W. WOOD	Hydraulics Engineer DAVID SMITH
7/2/2015	7/2/2015

-L-	-Y8-	-Y9-
PI Sta 54+71.63	PI Sta 11+10.18	PI Sta 11+69.99
$\Delta = 16^\circ 58' 24.2" (RT)$	$\Delta = 47^\circ 32' 44.1" (LT)$	$\Delta = 45^\circ 50' 51.9" (RT)$
$D = 1'08' 45.3"$	$D = 37' 12' 18.2"$	$D = 37' 12' 18.2"$
$L = 1,481.2'$	$L = 111.67'$	$L = 123.23'$
$T = 746.07'$	$T = 58.42'$	$T = 65.13'$
$R = 5,000.00'$	$R = 154.00'$	$R = 154.00'$
$DS > 40 MPH$	$DS = 25 MPH$	$DS = 25 MPH$
$SE = NC$	$SE = NC$	$SE = NC$
$RO = NONE$	$RO = NONE$	$RO = NONE$

REVISIONS

NAD 83 NSRS 2007

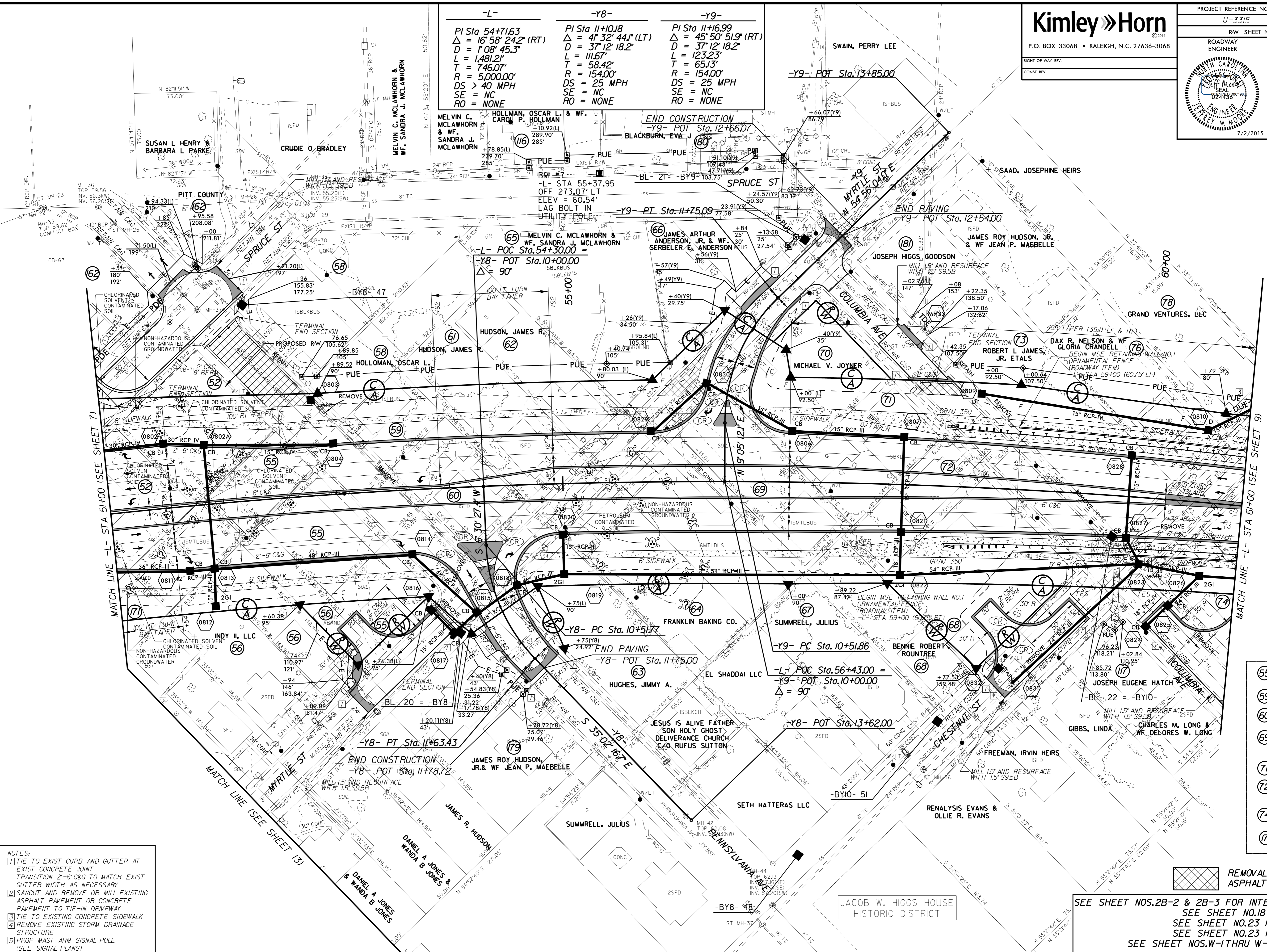

- NOTES:
- TIE TO EXIST CURB AND GUTTER AT EXIST CONCRETE JOINT TRANSITION 2'-6" C&G TO MATCH EXIST GUTTER WIDTH AS NECESSARY
  - SAWCUT AND REMOVE OR MILL EXISTING ASPHALT PAVEMENT OR CONCRETE PAVEMENT TO TIE-IN DRIVEWAY
  - TIE TO EXISTING CONCRETE SIDEWALK
  - REMOVE EXISTING STORM DRAINAGE STRUCTURE
  - PROP MAST ARM SIGNAL POLE (SEE SIGNAL PLANS)

- (55) JONATHAN SUTTON & TODD SUTTON
- (59) HOUSE OF PRAYER-OF HEART TO GIVE
- (60) FLONE C DAVIS
- (69) JAMES ROY HUDSON, JR. & Wf. JEAN P. MAEBELLE
- (71) HATTIE FRANCES VILLANUEVA
- (72) ESSIE PETERSON TRUSTEE ESSIE PETERSON REV. LIV. TRUST
- (74) WACHOVIA BANK, N.A.
- (171) JONATHAN SUTTON & TODD SUTTON

REMOVAL OF EXISTING ASPHALT PAVEMENT

SEE SHEET NOS. 2B-2 & 2B-3 FOR INTERSECTION DETAILS  
 SEE SHEET NO. 18 FOR -L- PROFILE  
 SEE SHEET NO. 23 FOR -Y8- PROFILE  
 SEE SHEET NO. 23 FOR -Y9- PROFILE  
 SEE SHEET NOS. W-1 THRU W-9 FOR WALL PLANS

K:\RAL\_Roadway\01036175 U-3315\Roadway\Pro\U-3315.rdw\_psd08.dgn  
6/26/2015