

STATE	STATE PROJECT REFERENCE NO.	SHEET
N.C.	35781.1.2 (U-3315)	2G-3

GEOTECHNICAL ENGINEER

DocuSigned by:
Matt Alexander
10/6/2014

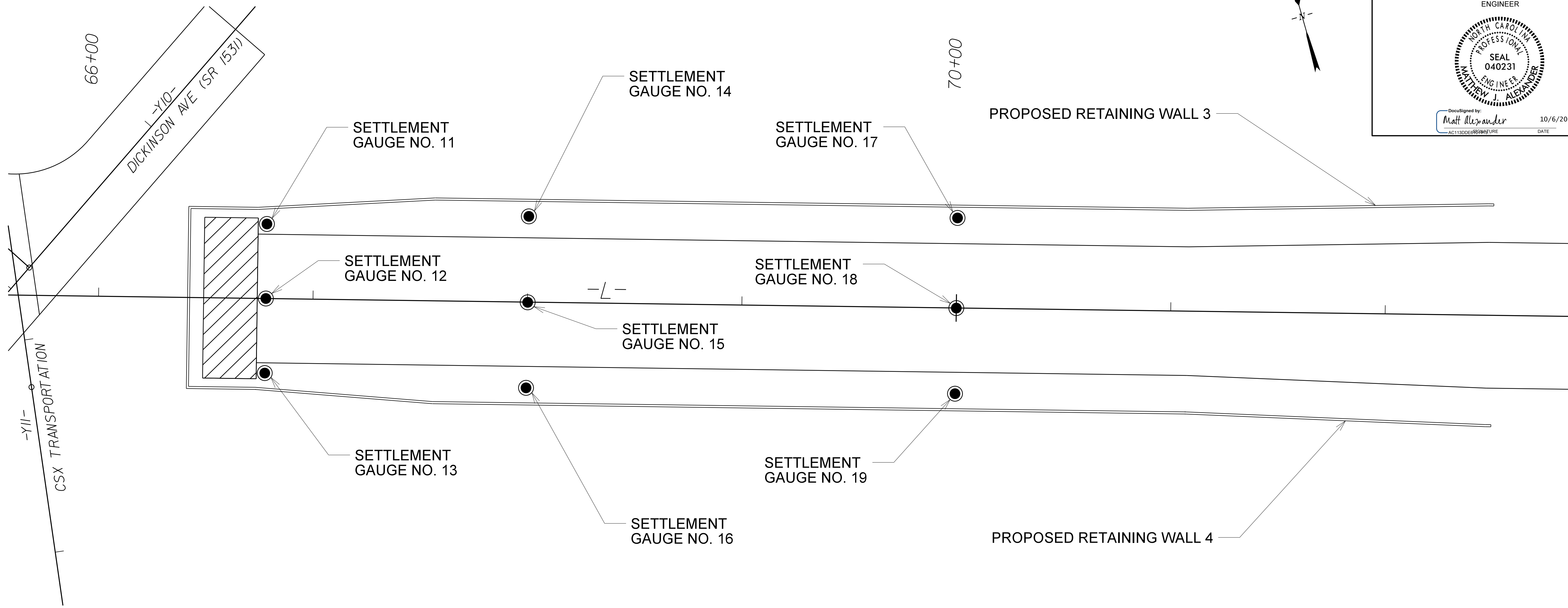

SETTLEMENT GAUGE LOCATIONS		
GAUGE NO.	STATION -L-	OFFSET FROM -L-
11	66+78	34.5 LT
12	66+78	CL
13	66+78	34.5 RT
14	68+00	40 LT
15	68+00	CL
16	68+00	40 RT
17	70+00	42 LT
18	70+00	CL
19	70+00	42 RT

SETTLEMENT GAUGE QUANTITIES	
EMBANKMENT SETTLEMENT GAUGES (MSE RETAINING WALL NO. 2)	9

NOTE:
REFER TO SHEET 2G-4 FOR SETTLEMENT GAUGE DETAILS AND CONSTRUCTION SEQUENCE

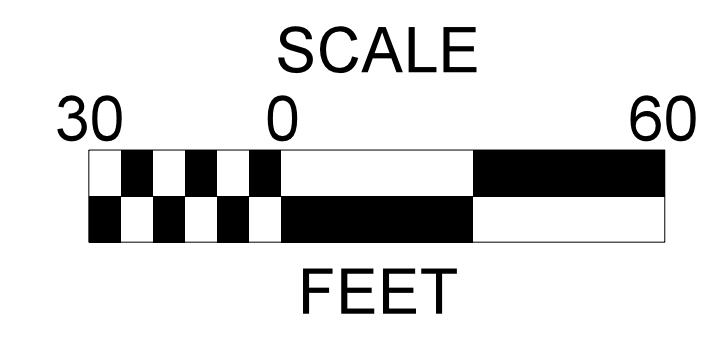

Kimley»Horn 333 Fayetteville Street, Suite 600 Raleigh, NC 27601-1772 Phone (919) 835-1494 <small>NC LICENSE # F-0102</small> <small>This document, together with the concepts and designs presented herein, as an instrument of services, is intended only for the specific purpose and client for which it was prepared. Reuse of and improper reliance of this document without written authorization and approval by Kimley-Horn and Associates, Inc. shall be without liability to Kimley-Horn and Associates, Inc.</small> <small>Copyright Kimley-Horn and Associates, Inc., 2014</small>	 2401 BRENTWOOD ROAD PH. (919) 873-2211	RALEIGH, NC 27604 FAX. (919) 873-9555	EMBANKMENT MONITORING DETAIL MSE RETAINING WALL NO. 2				
			REVISIONS				
NO.	BY	DATE	NO.	BY	DATE		
1			3				
2			4				