

SURVEY CONTROL SHEET U-3315

PITT COUNTY

**LOCATION: STANTONSBURG ROAD - TENTH STREET CONNECTOR
FROM US 13/NC 11 (MEMORIAL DRIVE) TO SR 1702 (EVANS STREET)**

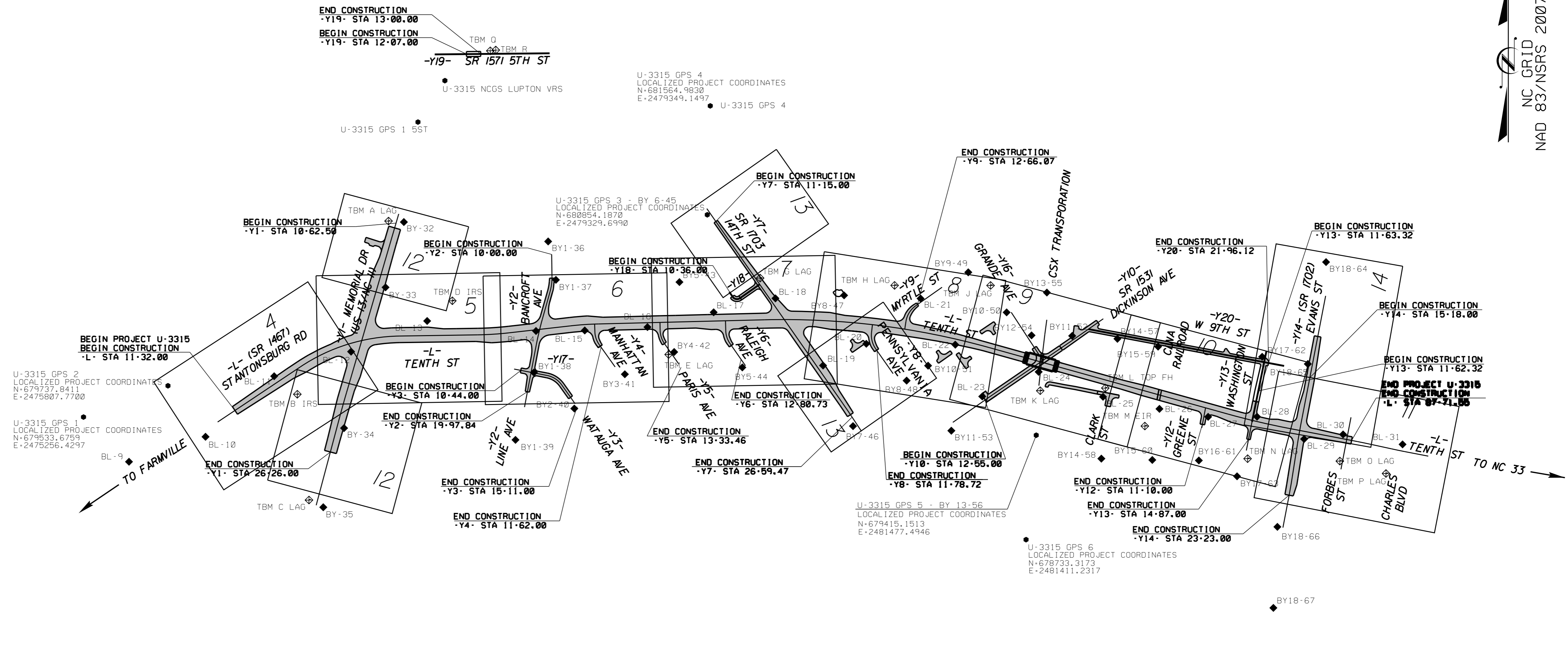

1. PATRICK W. HARTMAN, PLS. CERTIFY THAT THE NORTH CAROLINA STATE PLANE GRID COORDINATES AND ELEVATIONS LISTED WERE DERIVED FROM AN ACTUAL GPS SURVEY AND DIFFERENTIAL LEVELING MADE UNDER MY SUPERVISION AND THE FOLLOWING INFORMATION WAS USED DURING THE PERFORMANCE OF THE WORK:

1) CLASS OF SURVEY:	CLASS A (HORIZONTAL), CLASS A (VERTICAL)
2) POSITIONAL ACCURACY:	2 CM
3) TYPE OF GPS FIELD PROCEDURE:	NORTH CAROLINA RTK VRS
4) DATE OF SURVEY WORK:	12/3/10, 12/6/10, 12/10/10
5) DATUM/EPOCH:	NAD83/NSRS2007
6) PUBLISHED CONTROL/FIXED CONTROL:	AS LISTED BELOW AND NORTH CAROLINA RTK VRS
7) GEOD MODEL:	GE01009
8) COMBINED GRID FACTOR:	0.99989453
9) UNITS:	US SURVEY FEET

PUBLISHED VERTICAL CONTROL MONUMENTS
 NC85 LUPTON
 NGVD 29 ELEVATION = 62.10 FEET (18.928 METERS)
 NAVD 88 ELEVATION = 60.95 FEET (NGVD 29 + (-) 1.15 FEET)

NC85 STADIUM
 NGVD 29 ELEVATION = 55.51 FEET (16.919 METERS)
 NAVD 88 ELEVATION = 54.36 FEET (NGVD 29 + (-) 1.15 FEET)

NOTES:
 VERTICAL DATUM IS NAVD88 ESTABLISHED FROM NC85 LUPTON AND NC85 STADIUM. (NAVD88 - NGVD29 (-) 1.15 FEET).
 PROJECT GPS CONTROL ESTABLISHED USING NORTH CAROLINA REAL TIME KINEMATIC VIRTUAL REFERENCE SOLUTION AND BASELINE POINTS WERE ESTABLISHED VIA CONVENTIONAL TRAVERSE METHODS.

U-3315 GPS 7
 LOCALIZED PROJECT COORDINATES
 N: 677427.6519
 E: 2482778.2385

U-3315 GPS 8
 LOCALIZED PROJECT COORDINATES
 N: 676982.2303
 E: 2482767.2522

DATUM DESCRIPTION

THE LOCALIZED COORDINATE SYSTEM DEVELOPED FOR THIS PROJECT IS BASED ON THE STATE PLANE COORDINATES ESTABLISHED BY RIVERS AND ASSOCIATES, INC. FOR MONUMENT "GPS U-3315-4" WITH NAD 1983/2007 STATE PLANE COORDINATES OF NORTHING: 681,564.9830 (FT) EASTING: 2,479,349.1497 (FT) THE AVERAGE COMBINED GRID FACTOR USED ON THIS PROJECT (GROUND TO GRID) IS: 0.99989453
 THE N.C. LAMBERT GRID BEARING AND LOCALIZED HORIZONTAL GROUND DISTANCE FROM "GPS U-3315-4" TO L STATION 11+36.00 IS
 S 57°21'38.8" W 3686.12'
 ALL LINEAR DIMENSIONS ARE LOCALIZED HORIZONTAL DISTANCES
 VERTICAL DATUM USED IS NAVD 88

NOTE: DRAWING NOT TO SCALE

K:\RAL_Roadway\01036175 (U-3315)\Roadway\Proj\U-3315_LS_LC.dgn 5/12/2015