

5/28/99

PROJECT REFERENCE NO. U-3338B	SHEET NO. 47
ROADWAY DESIGN ENGINEER TATIA L. WHITE 2/28/2015 SEAL 024641	HYDRAULICS ENGINEER RAY D. LOVINGOOD 2/28/2015 SEAL 019775

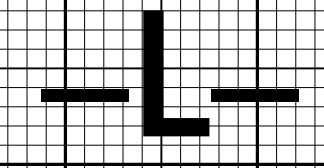

BL20 ELEVATION = 36.85  
 N 182248 E 2335454  
 -L- STA 67+08 31' LT.  
 CM / REBAR (KERR AVE.)

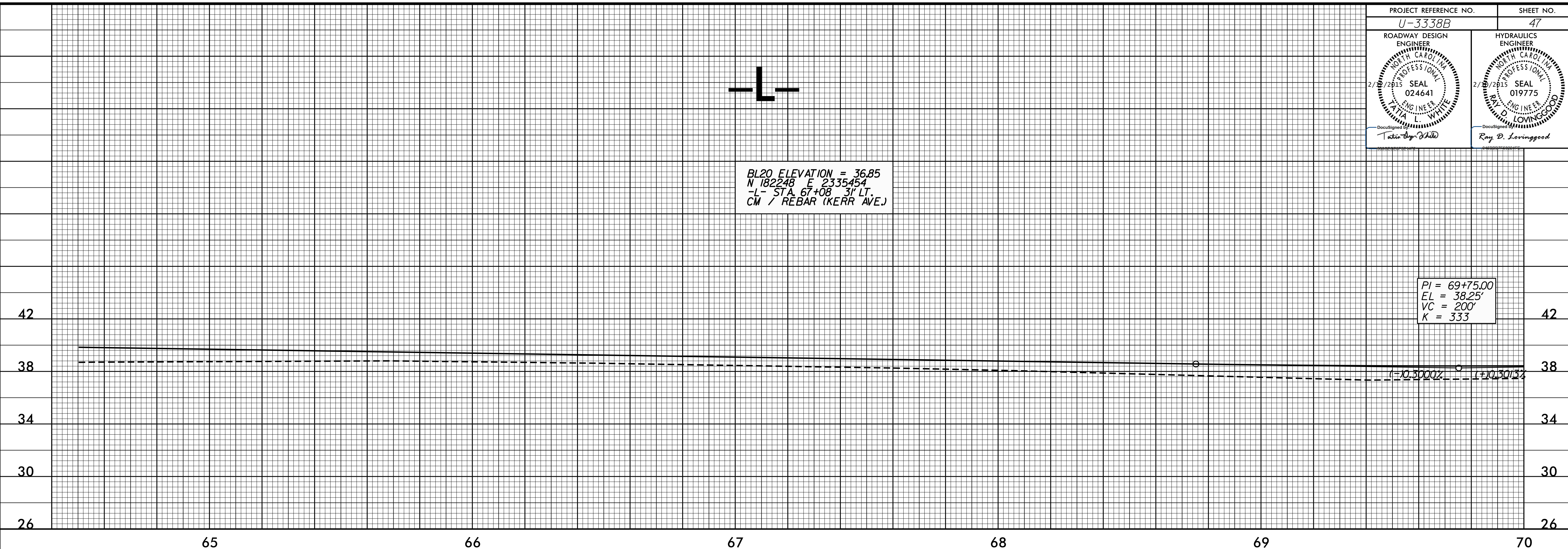

PI = 69+75.00  
 EL = 38.25'  
 VC = 200'  
 K = 333

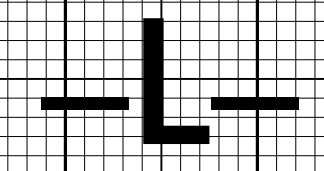

PI = 73+50.00  
 EL = 39.38'  
 VC = 400'  
 K = 666

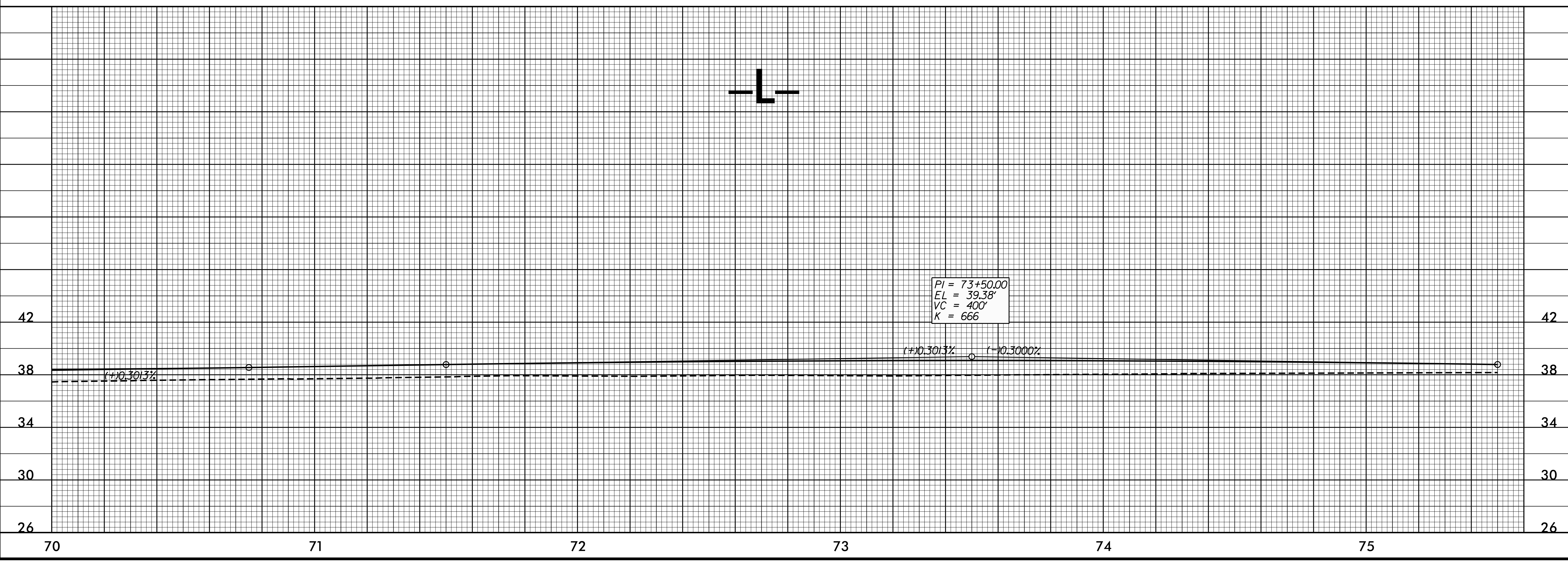

13-JAN-2015 14:16 \\s3338b\_rdy-pf1.dgn