

5/28/99

### DITCH LEGEND

LEFT DITCH - - - - -

RIGHT DITCH - - - - -

BM\*1 ELEV=564.98'  
-BL- STA 18+76 (30' LEFT)  
R/R SPIKE IN BASE OF 8" PINE

BM\*2 ELEV=562.07'  
-BL- STA 24+45 (22' LEFT)  
R/R SPIKE IN POWER POLE

BM\*3 ELEV=558.64'  
-BL- STA 28+53 (1' LEFT)  
NCGS MONUMENT EBG 43

BM\*4 ELEV=558.64'  
-BL- STA 28+53 (37' RIGHT)  
CITY OF CHARLOTTE MONUMENT  
L-SUGAR 1

### BRIDGE HYDRAULIC DATA

DESIGN DISCHARGE	= 12261	CFS
DESIGN FREQUENCY	= 50	YRS
DESIGN HW ELEVATION	= 552.3	FT
BASE DISCHARGE	= 13909	CFS
BASE FREQUENCY	= 100	YRS
BASE HW ELEVATION	= 553.42	FT
OVERTOPPING DISCHARGE	= 25132	CFS
OVERTOPPING FREQUENCY	= 500	YRS
OVERTOPPING ELEVATION	= 559.3	FT

DATE OF SURVEY = 3-14-2013  
 W.S. ELEVATION AT DATE OF SURVEY = 532.3 FT

PROJECT REFERENCE NO. B-5105 SHEET NO. 6

ROADWAY DESIGN ENGINEER

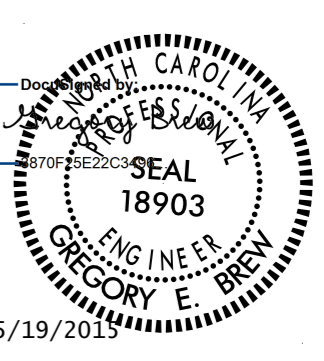

HYDRAULICS ENGINEER

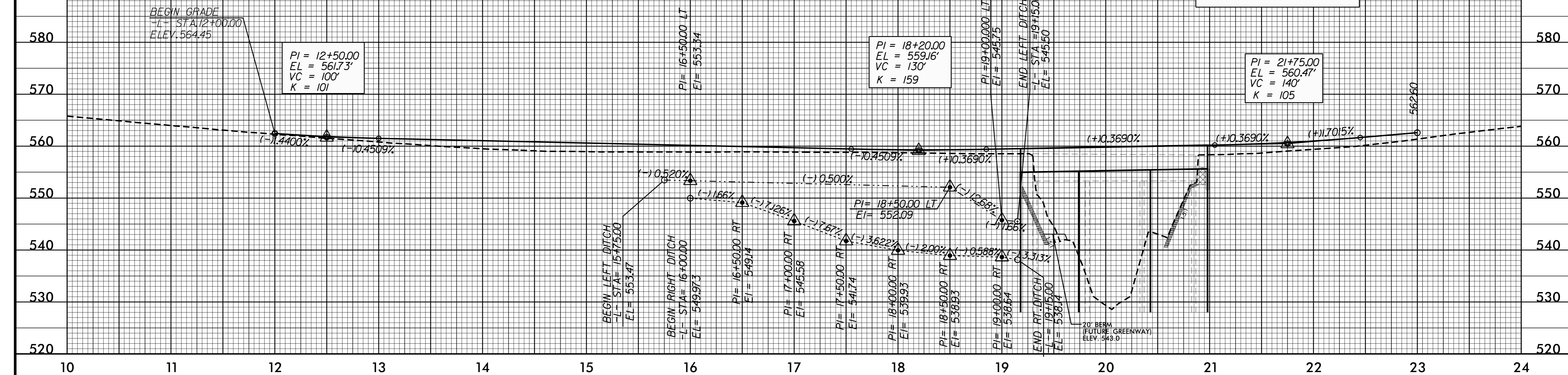
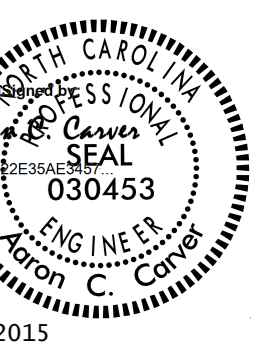

BM\*5 ELEV=567.94'  
-BL- STA 35+70 (17' RIGHT)  
R/R SPIKE IN BASE OF 28" PINE

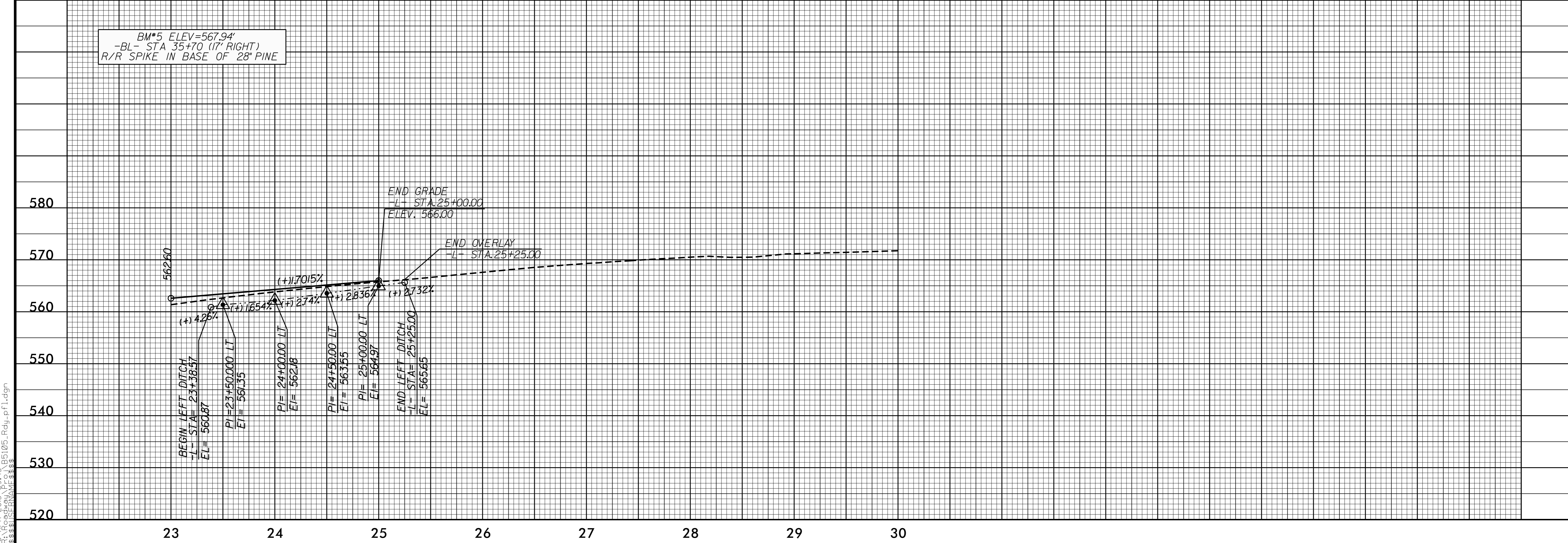

10-APR-2015 09:45 05105\_Rdy.plt.dgn