

REINFORCING BAR SCHEDULE FOR STAGE III

BAR TYPES

SPAN A										SPAN B										SPAN C															
BAR NO.	SIZE	TYPE	LENGTH	WEIGHT	BAR NO.	SIZE	TYPE	LENGTH	WEIGHT	BAR NO.	SIZE	TYPE	LENGTH	WEIGHT	BAR NO.	SIZE	TYPE	LENGTH	WEIGHT	BAR NO.	SIZE	TYPE	LENGTH	WEIGHT	BAR NO.	SIZE	TYPE	LENGTH	WEIGHT						
*A4	152	#5	STR	4'-8"	740	A232	6	#5	STR	30'-7"	191	*A4	287	#5	STR	4'-8"	1397	A232	6	#5	STR	30'-7"	191	*A4	146	#5	STR	4'-8"	711	A232	6	#5	STR	30'-7"	191
*A5	109	#5	STR	37'-4"	4244	A233	6	#5	STR	28'-4"	177	*A5	244	#5	STR	37'-4"	9501	A233	6	#5	STR	28'-4"	177	*A5	103	#5	STR	37'-4"	4011	A233	6	#5	STR	28'-4"	177
A9	153	#5	STR	4'-8"	745	A234	6	#5	STR	26'-1"	163	A9	288	#5	STR	4'-8"	1402	A234	6	#5	STR	26'-1"	163	A9	147	#5	STR	4'-8"	716	A234	6	#5	STR	26'-1"	163
A10	110	#5	STR	37'-4"	4283	A235	6	#5	STR	23'-10"	149	A10	245	#5	STR	37'-4"	9540	A235	6	#5	STR	23'-10"	149	A10	104	#5	STR	37'-4"	4050	A235	6	#5	STR	23'-10"	149
						A236	6	#5	STR	21'-7"	135							A236	6	#5	STR	21'-7"	135							A236	6	#5	STR	21'-7"	135
*A147	4	#5	STR	3'-3"	14	A237	6	#5	STR	19'-4"	121	*A147	4	#5	STR	3'-3"	14	A237	6	#5	STR	19'-4"	121	*A147	4	#5	STR	3'-3"	14	A237	6	#5	STR	19'-4"	121
*A148	3	#5	STR	34'-5"	108	A238	6	#5	STR	17'-1"	107	*A148	3	#5	STR	34'-5"	108	A238	6	#5	STR	17'-1"	107	*A148	3	#5	STR	34'-5"	108	A238	6	#5	STR	17'-1"	107
*A149	3	#5	STR	32'-2"	101	A239	6	#5	STR	14'-10"	93	*A149	3	#5	STR	32'-2"	101	A239	6	#5	STR	14'-10"	93	*A149	3	#5	STR	32'-2"	101	A239	6	#5	STR	14'-10"	93
*A150	3	#5	STR	29'-11"	94	A240	6	#5	STR	12'-7"	79	*A150	3	#5	STR	29'-11"	94	A240	6	#5	STR	12'-7"	79	*A150	3	#5	STR	29'-11"	94	A240	6	#5	STR	12'-7"	79
*A151	3	#5	STR	27'-8"	87	A241	6	#5	STR	10'-4"	65	*A151	3	#5	STR	27'-8"	87	A241	6	#5	STR	10'-4"	65	*A151	3	#5	STR	27'-8"	87	A241	6	#5	STR	10'-4"	65
*A152	3	#5	STR	25'-4"	79	A242	6	#5	STR	8'-1"	51	*A152	3	#5	STR	25'-4"	79	A242	6	#5	STR	8'-1"	51	*A152	3	#5	STR	25'-4"	79	A242	6	#5	STR	8'-1"	51
*A153	3	#5	STR	23'-1"	72	A243	6	#5	STR	5'-10"	37	*A153	3	#5	STR	23'-1"	72	A243	6	#5	STR	5'-10"	37	*A153	3	#5	STR	23'-1"	72	A243	6	#5	STR	5'-10"	37
*A154	3	#5	STR	20'-10"	65	A244	6	#5	STR	3'-7"	22	*A154	3	#5	STR	20'-10"	65	A244	6	#5	STR	3'-7"	22	*A154	3	#5	STR	20'-10"	65	A244	6	#5	STR	3'-7"	22
*A155	3	#5	STR	18'-7"	58							*A155	3	#5	STR	18'-7"	58							*A155	3	#5	STR	18'-7"	58						
*A156	3	#5	STR	16'-4"	51	*B1	93	#4	STR	23'-3"	1444	*A156	3	#5	STR	16'-4"	51	*B5	155	#4	STR	26'-1"	2701	*A156	3	#5	STR	16'-4"	51	*B2	93	#4	STR	22'-6"	1398
*A157	3	#5	STR	14'-1"	44	B3	126	#5	STR	34'-2"	4490	*A157	3	#5	STR	14'-1"	44	B6	189	#5	STR	42'-4"	8345	*A157	3	#5	STR	14'-1"	44	B4	126	#5	STR	33'-2"	4359
*A158	3	#5	STR	11'-10"	37	*B7	15	#4	STR	23'-1"	231	*A158	3	#5	STR	11'-10"	37	*B8	25	#4	STR	25'-11"	433	*A158	3	#5	STR	11'-10"	37	*B9	15	#4	STR	22'-3"	223
*A159	3	#5	STR	9'-7"	30							*A159	3	#5	STR	9'-7"	30							*A159	3	#5	STR	9'-7"	30						
*A160	3	#5	STR	7'-4"	23	*D1	150	#6	STR	5'-4"	1202	*A160	3	#5	STR	7'-4"	23	*D1	284	#6	STR	5'-4"	2275	*A160	3	#5	STR	7'-4"	23	*D1	145	#6	STR	5'-4"	1161
*A161	3	#5	STR	5'-1"	16	D2	150	#6	STR	4'-8"	1051	*A161	3	#5	STR	5'-1"	16	D2	286	#6	STR	4'-8"	2005	*A161	3	#5	STR	5'-1"	16	D2	145	#6	STR	4'-8"	1016
*A162	3	#5	STR	2'-10"	9							*A162	3	#5	STR	2'-10"	9							*A162	3	#5	STR	2'-10"	9						
*A163	3	#5	STR	35'-2"	110	*G4	2	#5	STR	5'-4"	11	*A163	3	#5	STR	35'-2"	110	*G4	2	#5	STR	5'-4"	11	*A163	3	#5	STR	35'-2"	110	*G4	2	#5	STR	5'-4"	11
*A164	3	#5	STR	32'-11"	103	*G5	2	#5	STR	42'-8"	89	*A164	3	#5	STR	32'-11"	103	*G5	2	#5	STR	42'-8"	89	*A164	3	#5	STR	32'-11"	103	*G5	2	#5	STR	42'-8"	89
*A165	3	#5	STR	30'-8"	96	*G6	66	#4	STR	5'-8"	250	*A165	3	#5	STR	30'-8"	96	*G6	122	#4	STR	5'-8"	462	*A165	3	#5	STR	30'-8"	96	*G6	63	#4	STR	5'-8"	238
*A166	3	#5	STR	28'-5"	89							*A166	3	#5	STR	28'-5"	89							*A166	3	#5	STR	28'-5"	89						
*A167	3	#5	STR	26'-2"	82	*J1	84	#4	5	1'-5"	79	*A167	3	#5	STR	26'-2"	82	*J1	84	#4	5	1'-5"	79	*A167	3	#5	STR	26'-2"	82	*J1	84	#4	5	1'-5"	79
*A168	3	#5	STR	23'-10"	75							*A168	3	#5	STR	23'-10"	75							*A168	3	#5	STR	23'-10"	75						
*A169	3	#5	STR	21'-7"	68	*K1	4	#8	1	15'-4"	164	*A169	3	#5	STR	21'-7"	68	*K8	4	#5	1	8'-2"	34	*A169	3	#5	STR	21'-7"	68	*K1	4	#8	1	15'-4"	164
*A170	3	#5	STR	19'-4"	60	*K2	8	#8	2	22'-9"	486	*A170	3	#5	STR	19'-4"	60	*K9	4	#5	1	5'-2"	22	*A170	3	#5	STR	19'-4"	60	*K2	8	#8	2	22'-9"	486
*A171	3	#5	STR	17'-1"	53	*K3	4	#8	1	11'-3"	120	*A171	3	#5	STR	17'-1"	53	*K10	8	#5	2	8'-6"	71	*A171	3	#5	STR	17'-1"	53	*K3	4	#8	1	11'-3"	120
*A172	3	#5	STR	14'-10"	46	*K6	18	#6	STR	10'-8"	288	*A172	3	#5	STR	14'-10"	46	*K12	12	#5	STR	12'-1"	151	*A172	3	#5	STR	14'-10"	46	*K6	18	#6	STR	10'-8"	288
*A173	3	#5	STR	12'-7"	39	*K16	4	#8	STR	5'-4"	57	*A173	3	#5	STR	12'-7"	39	*K14	4	#5	STR	7'-6"	31	*A173	3	#5	STR	12'-7"	39	*K16	4	#8	STR	5'-4"	57
*A174	3	#5	STR	10'-4"	32	*K18	6	#6	STR	5'-4"	48	*A174	3	#5	STR	10'-4"	32							*A174	3	#5	STR	10'-4"	32	*K18	6	#6	STR	5'-4"	48
*A175	3	#5	STR	8'-1"	25							*A175	3	#5	STR	8'-1"	25	*S3	70	#5	6	3'-6"	256	*A175	3	#5	STR	8'-1"	25						
*A176	3	#5	STR	5'-10"	18	*S1	70	#5	3	4'-10"	353	*A176	3	#5	STR	5'-10"	18							*A176	3	#5	STR	5'-10"	18	*S1	70	#5	3	4'-10"	353
*A177	3	#5	STR	3'-7"	11	*S2	35	#4	4	4'-4"	101	*A177	3	#5	STR	3'-7"	11	*U1	36	#4	7	3'-4"	80	*A177	3	#5	STR	3'-7"	11	*S2	35	#4	4	4'-4"	101
						*S4	35	#4	4	3'-2"	74																			*S4	35	#4	4	3'-2"	74
A229	4	#5	STR	3'-2"	13							A229	4	#5	STR	3'-2"	13							A229	4	#5	STR	3'-2"	13						
A230	6	#5	STR	35'-1"	220	*U1	20	#4	7	3'-4"	45	A230	6	#5	STR	35'-1"	220							A230	6	#5	STR	35'-1"	220	*U1	18	#4	7	3'-4"	40
A231	6	#5	STR	32'-10"	205							A231	6	#5	STR	32'-10"	205							A231	6	#5	STR	32'-10"	205						

REINFORCING STEEL	LBS.	12,397
* EPOXY COATED REINFORCING STEEL	LBS.	11,821

REINFORCING STEEL	LBS.	23,120
* EPOXY COATED REINFORCING STEEL	LBS.	19,388

REINFORCING STEEL	LBS.	11,968
* EPOXY COATED REINFORCING STEEL	LBS.	11,447

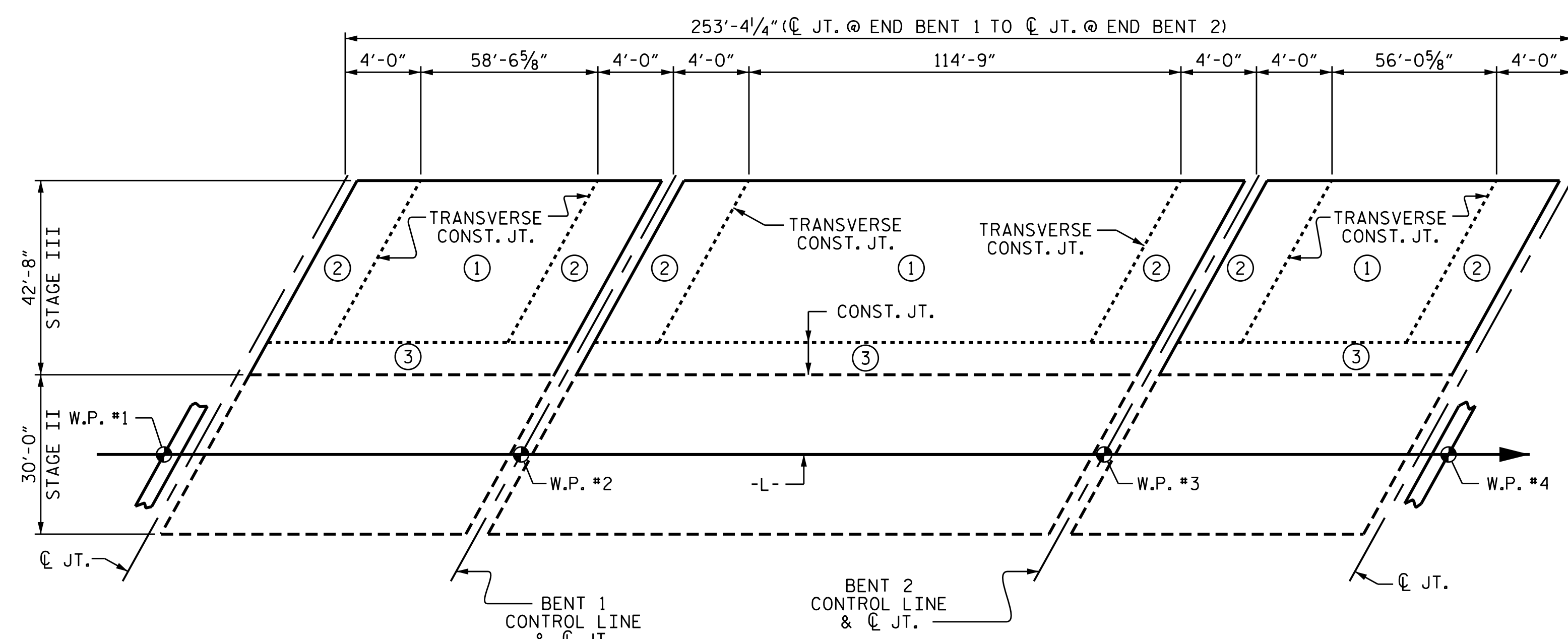
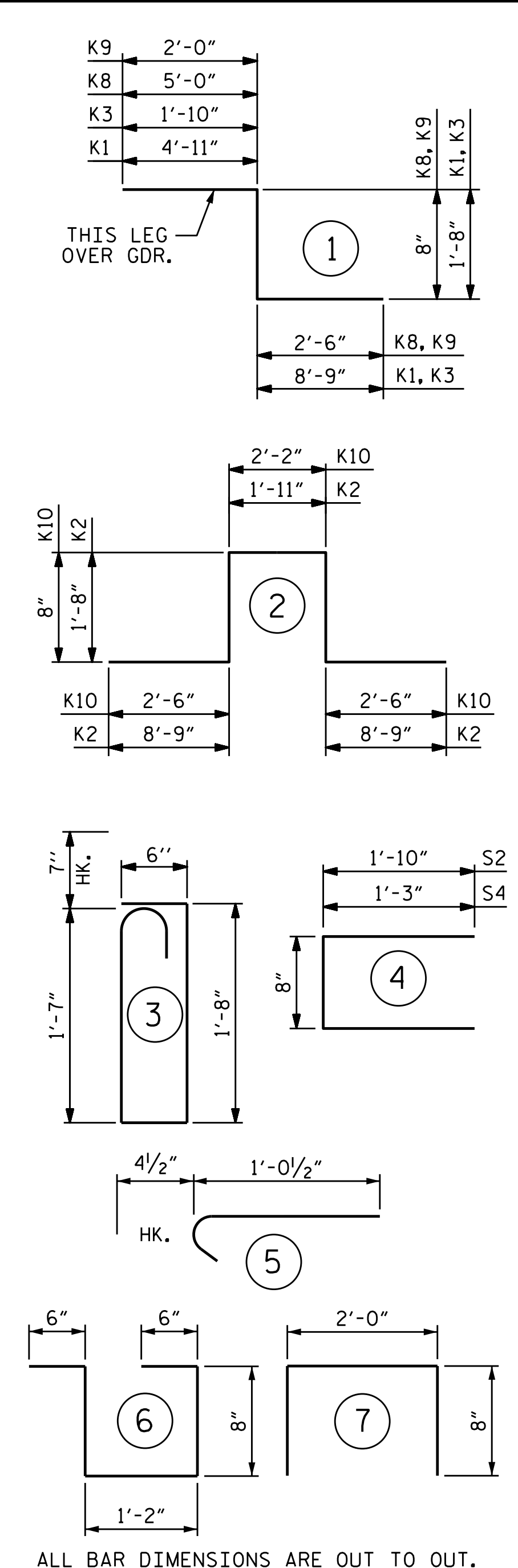

POURING SEQUENCE

SUPERSTRUCTURE BILL OF MATERIAL STAGE III						
	CLASS AA CONCRETE (CU. YDS.)				REINFORCING STEEL (LBS.)	EPOXY COATED REINFORCING STEEL (LBS.)
	POUR #1	POUR #2	POUR #3	SIDEWALK		
SPAN A	73.0	13.6	10.7	8.2	12,397	11,821
SPAN B	143.4	11.2	18.9	15.2	23,120	19,388
SPAN C	69.9	13.6	10.3	7.9	11,968	11,447
TOTALS **	286.3	38.4	39.9	31.3	47,485	42,656

** QUANTITIES FOR CLASSIC RAIL ARE NOT INCLUDED

GROOVING BRIDGE FLOORS STAGE III	
	SO.FT.
APPROACH SLABS	1,702
BRIDGE DECK	
SPAN A	2,351
SPAN B	4,371
SPAN C	2,260
TOTAL	10,684

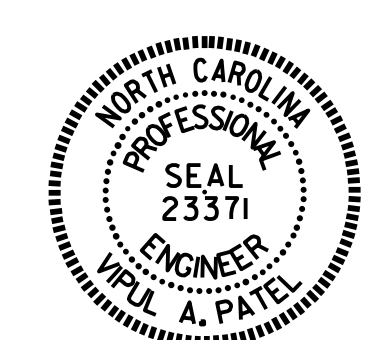

PROJECT NO. B-5136
 CABARRUS COUNTY
 STATION: 21+74.92 -L-
 SHEET 3 OF 4

STATE OF NORTH CAROLINA DEPARTMENT OF TRANSPORTATION RALEIGH					
SUPERSTRUCTURE BILL OF MATERIAL STAGE III					
REVISIONS					SHEET NO.
NO.	BY:	DATE:	NO.	BY:	DATE:
1			3		
2			4		
					TOTAL SHEETS