

PLAN OF SPAN A

(FOR EXACT PLACEMENT OF S1 BARS IN DECK & RAIL, SEE SHEET 2 OF 5)

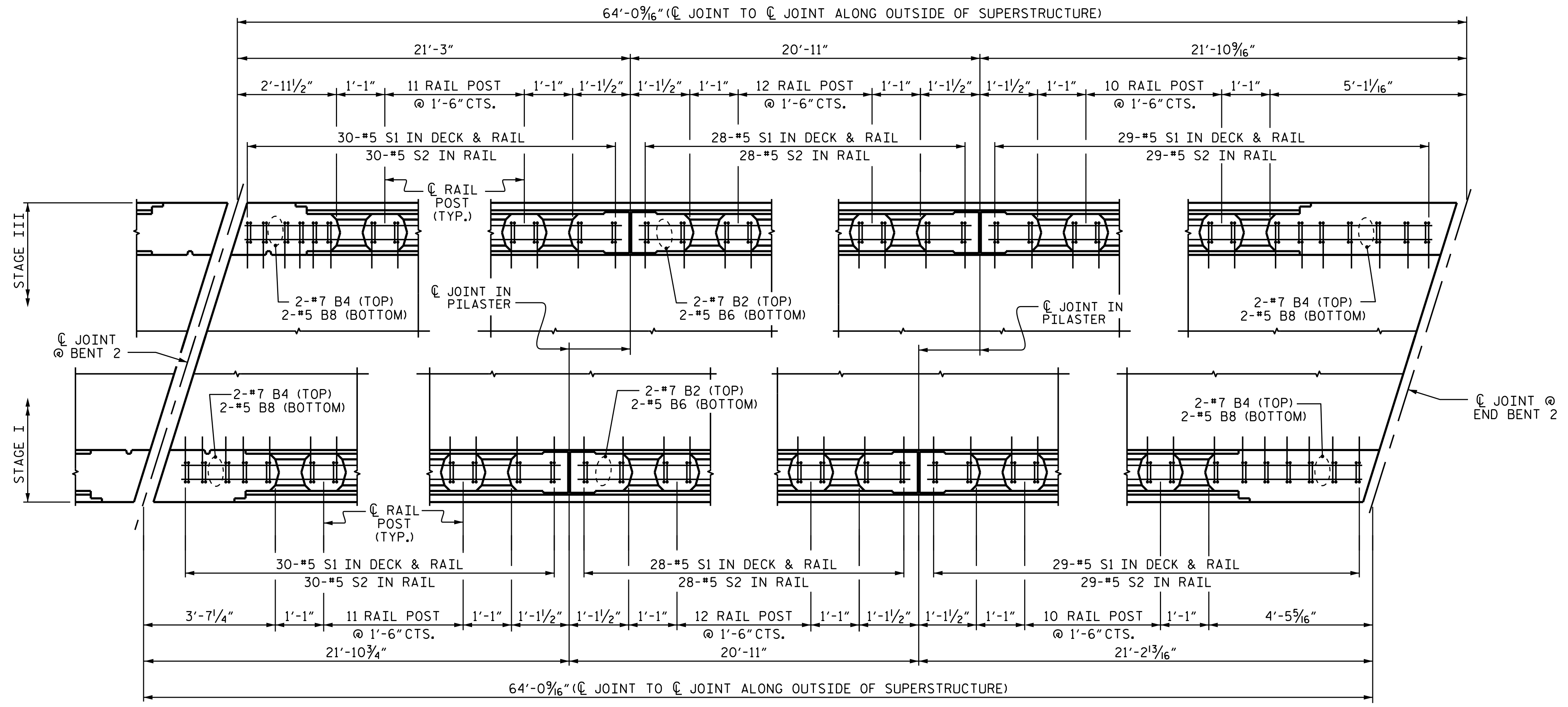

PLAN OF SPAN C

(FOR EXACT PLACEMENT OF S1 BARS IN DECK & RAIL, SEE SHEET 2 OF 5)

BAR TYPES

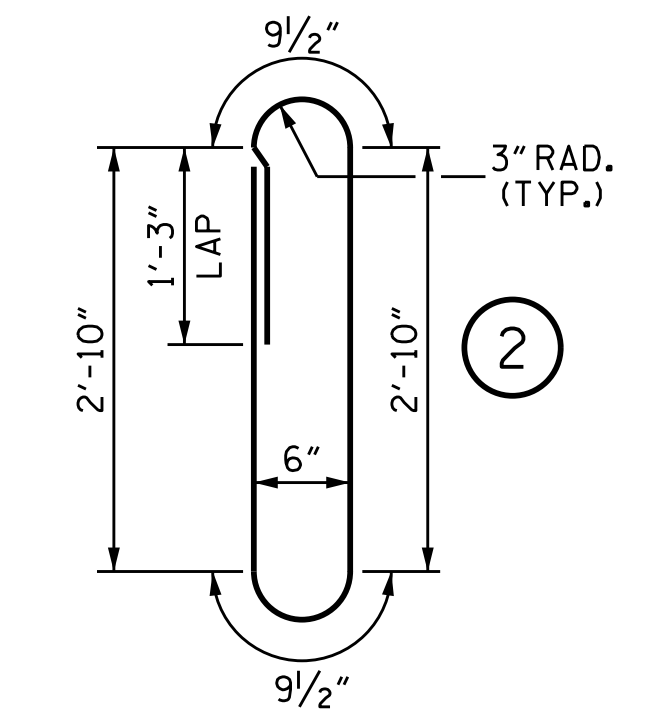
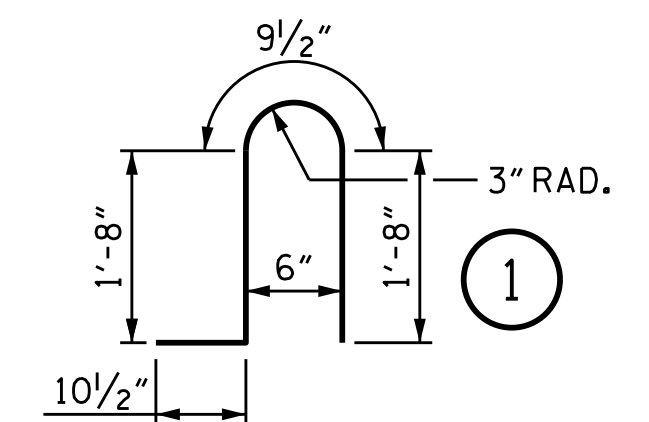

ALL BAR DIMENSIONS ARE OUT TO OUT.

TOTAL BILL OF MATERIAL CLASSIC RAIL

* EPOXY COATED REINFORCING STEEL	LBS.	12,678
CLASS AA CONCRETE	C.Y.	70.2
CLASSIC CONCRETE BRIDGE RAIL	LIN. FT.	506.70

BILL OF MATERIAL CLASSIC RAIL (STAGE I)

BAR NO.	SIZE	TYPE	LENGTH	WEIGHT
* B1	#7	STR	22'-1"	181
* B2	#7	STR	20'-6"	503
* B3	#7	STR	18'-10"	154
* B4	#7	STR	20'-10"	170
* B5	#5	STR	22'-1"	92
* B6	#5	STR	20'-6"	257
* B7	#5	STR	18'-10"	79
* B8	#5	STR	20'-10"	87

* S1	342	#5	1	5'-0"	1784
* S2	342	#5	2	8'-6"	3032
* EPOXY COATED REINFORCING STEEL	LBS.				6,339
CLASS AA CONCRETE	C.Y.				35.1
CLASSIC CONCRETE BRIDGE RAIL	LIN. FT.				253.35

BILL OF MATERIAL CLASSIC RAIL (STAGE III)

BAR NO.	SIZE	TYPE	LENGTH	WEIGHT
* B1	#7	STR	22'-1"	181
* B2	#7	STR	20'-6"	503
* B3	#7	STR	18'-10"	154
* B4	#7	STR	20'-10"	170
* B5	#5	STR	22'-1"	92
* B6	#5	STR	20'-6"	257
* B7	#5	STR	18'-10"	79
* B8	#5	STR	20'-10"	87

* S1	342	#5	1	5'-0"	1784
* S2	342	#5	2	8'-6"	3032

* EPOXY COATED REINFORCING STEEL	LBS.	6,339
CLASS AA CONCRETE	C.Y.	35.1
CLASSIC CONCRETE BRIDGE RAIL	LIN. FT.	253.35

NOTES

- CLASSIC CONCRETE BRIDGE RAIL IN EACH SPAN SHALL NOT BE CAST UNTIL ALL SLAB CONCRETE IN THE SPAN HAS BEEN CAST AND HAS REACHED A MINIMUM COMPRESSIVE STRENGTH OF 3,000 PSI.
- ALL REINFORCING STEEL IN THE CLASSIC CONCRETE BRIDGE RAILS SHALL BE EPOXY COATED.
- SIDEWALK QUANTITIES ARE INCLUDED IN THE SUPERSTRUCTURE BILL OF MATERIAL.
- FOR CLASSIC CONCRETE BRIDGE RAIL, SEE SPECIAL PROVISIONS.

PROJECT NO. B-5136
CABARRUS COUNTY
 STATION: 21+74.92 -L-

SHEET 4 OF 5

STATE OF NORTH CAROLINA
 DEPARTMENT OF TRANSPORTATION
 RALEIGH
 SUPERSTRUCTURE
 CLASSIC CONCRETE
 BRIDGE RAIL WITH
 SIDEWALK

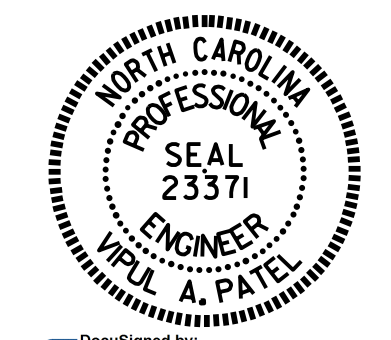

REVISIONS						SHEET NO. S-38
NO.	BY:	DATE:	NO.	BY:	DATE:	
1			3			TOTAL SHEETS 75
2			4			

DRAWN BY : T. H. CARROLL DATE : 7/31/14
 CHECKED BY : P. S. ADKINS DATE : 8/12/14
 DESIGN ENGINEER OF RECORD : V. A. PATEL DATE : 1/5/15