

**NOTES**

FOR PILES, SEE SECTION 450 OF THE STANDARD SPECIFICATIONS.

PILES END BENTS 1 AND 2 ARE DESIGNED FOR A FACTORED RESISTANCE OF 105 TONS PER PILE.

DRIVE PILES AT END BENTS 1 AND 2 TO A REQUIRED DRIVING RESISTANCE OF 175 TONS PER PILE.

PILES AT BENTS 1 AND 2 ARE DESIGNED FOR A FACTORED RESISTANCE OF 160 TONS PER PILE.

DRIVE PILES AT BENTS 1 AND 2 TO A REQUIRED DRIVING RESISTANCE OF 267 TONS PER PILE.

IT HAS BEEN ESTIMATED THAT A HAMMER WITH AN EQUIVALENT RATED ENERGY IN THE RANGE OF 55 TO 75 FT-KIPS PER BLOW WILL BE REQUIRED TO DRIVE PILES AT BENTS 1 AND 2. THIS ESTIMATED ENERGY RANGE DOES NOT RELEASE THE CONTRACTOR FROM PROVIDING DRIVING EQUIPMENT IN ACCORDANCE WITH SUBARTICLE 450-3(D)(2) OF THE STANDARD SPECIFICATIONS.

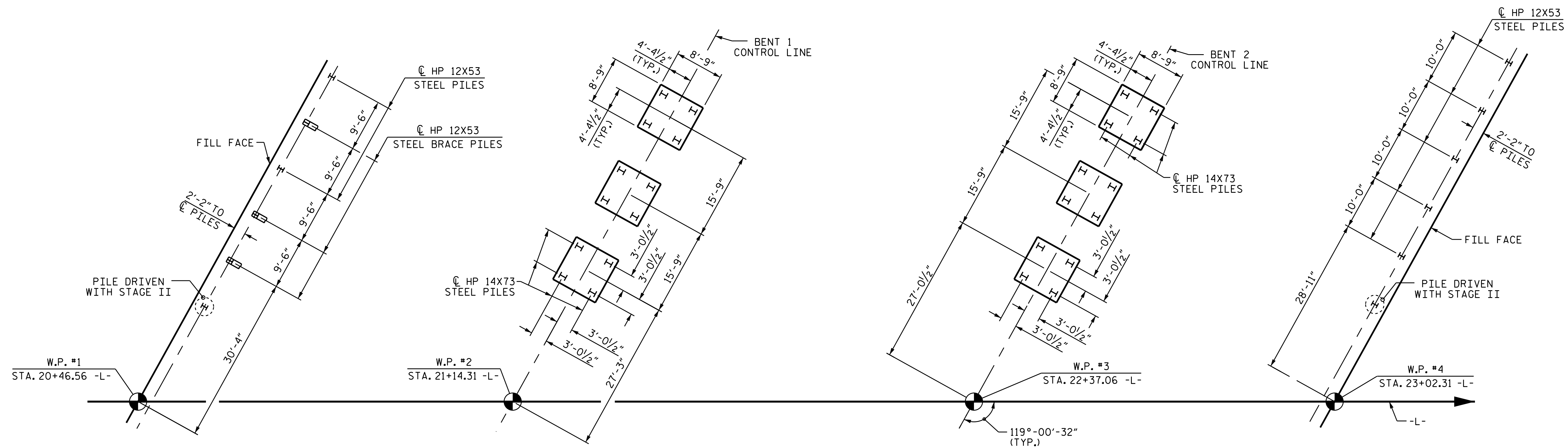

**FOUNDATION LAYOUT-STAGE III**

DIMENSIONS LOCATING PILES ARE SHOWN TO CENTERLINE OF PILES. DIMENSIONS LOCATING COLUMNS AND FOOTINGS ARE SHOWN TO CENTERLINE OF COLUMNS AND FOOTINGS. DIMENSIONS FOR FOOTINGS ARE TYPICAL FOR EACH FOOTING. BRACE PILES AT END BENT 1 ARE BATTERED AT 3:12.

PROJECT NO. B-5136  
CABARRUS COUNTY  
 STATION: 21+74.92 -L-

SHEET 4 OF 5



STATE OF NORTH CAROLINA  
 DEPARTMENT OF TRANSPORTATION  
 RALEIGH  
**GENERAL DRAWING**  
 FOR BRIDGE OVER  
 NORFOLK SOUTHERN RR ON  
 US 29/601 (CONCORD PARKWAY)  
 BETWEEN ELLA ST. AND NC 73

REVISIONS						SHEET NO.
NO.	BY:	DATE:	NO.	BY:	DATE:	TOTAL SHEETS
1			3			75
2			4			

DRAWN BY : P.S. ADKINS DATE : 7/9/14  
 CHECKED BY : H. A. LOCKLEAR DATE : 12/31/14  
 DESIGN ENGINEER OF RECORD: V. A. PATEL DATE : 1/5/15