

See Sheet 1-A For Index of Sheets
See Sheet 1-B For Conventional Symbols

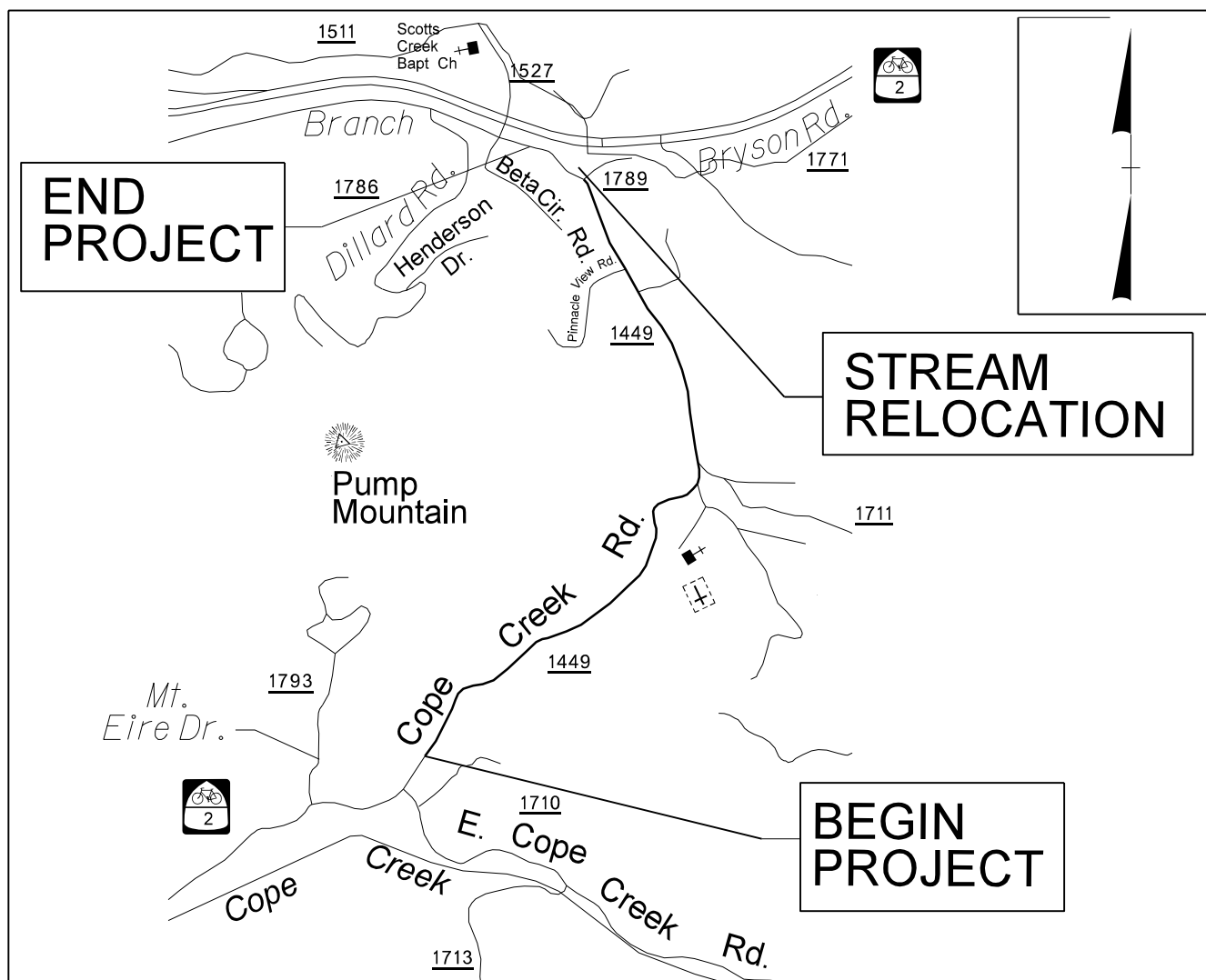

VICINITY MAP

STATE OF NORTH CAROLINA
DIVISION OF HIGHWAYS

JACKSON COUNTY

LOCATION: UT TO BLANTON BRANCH NEAR COPE CREEK ROAD AND US 2974

TYPE OF WORK: STREAM RELOCATION, GRADING, DRAINAGE, AND EROSION CONTROL

STATE	STATE PROJECT REFERENCE NO.	SHEET NO.	TOTAL SHEETS
N.C.	R-5206	OSM-1	
STATE PROJ. NO.	F.A. PROJ. NO.	DESCRIPTION	

PROJECT: R-5206

CONTRACT: C202105

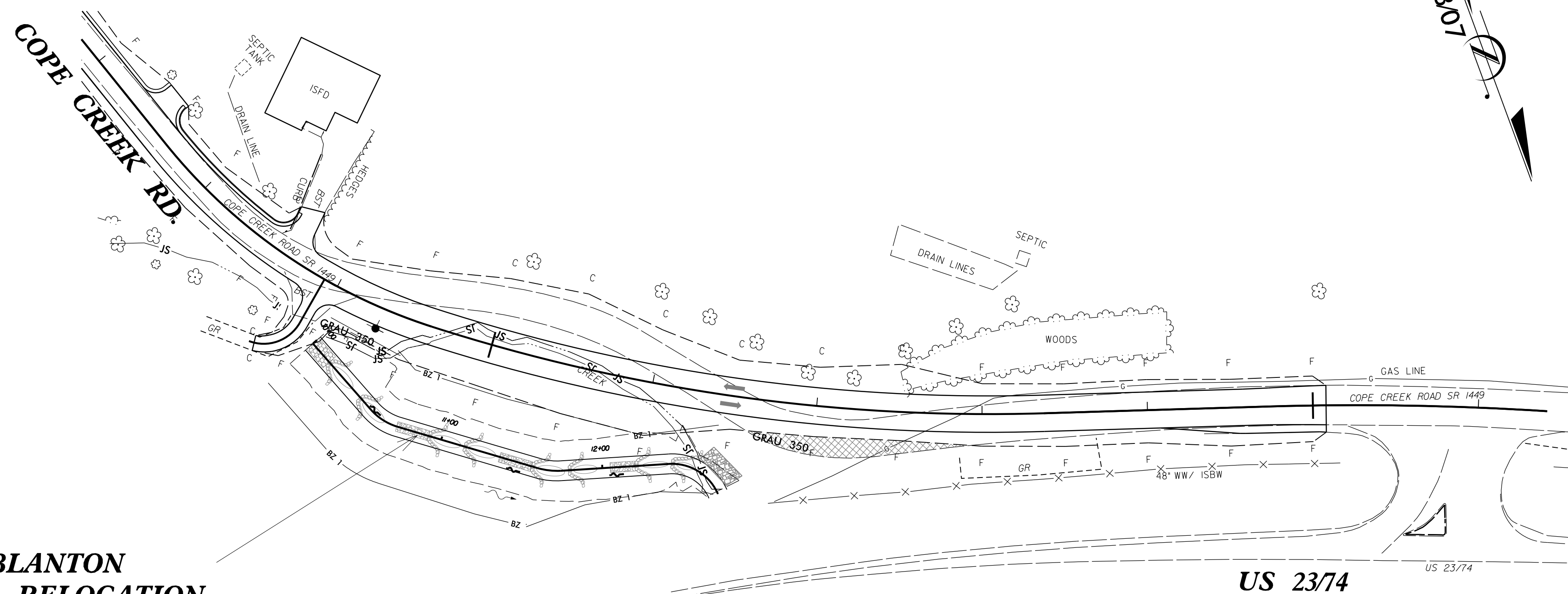

UT TO BLANTON BRANCH RELOCATION

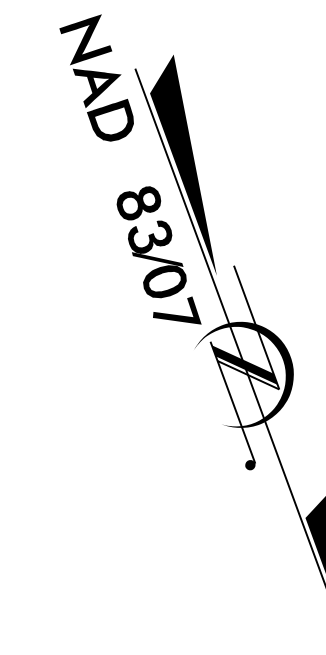

THIS PROJECT IS NOT LOCATED WITHIN ANY MUNICIPAL BOUNDARIES
CLEARING ON THIS PROJECT SHALL BE PERFORMED TO THE LIMITS ESTABLISHED BY METHOD II

GRAPHIC SCALES

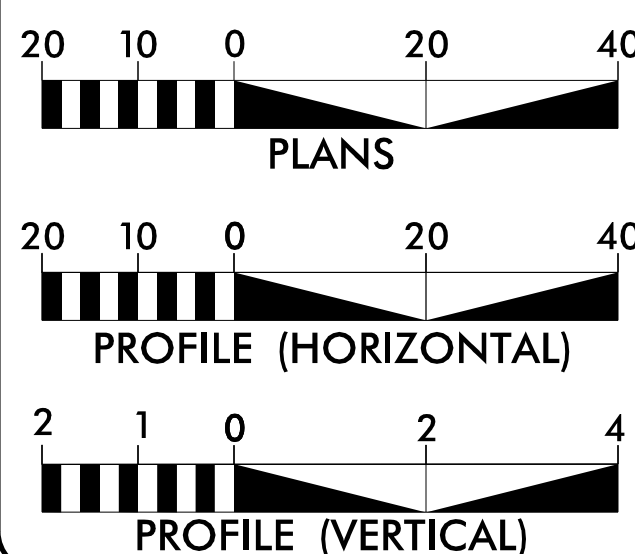

DESIGN DATA

PROJECT LENGTH

EXISTING STREAM LENGTH = 282.10 L.F.
PROPOSED STREAM LENGTH = 277.37 L.F.



Sepl Engineering & Construction
1025 Wade Avenue
Raleigh, NC 27605
Phone: (919)-789-9977
Fax: (919)-789-9591
License: C-2197

2012 STANDARD SPECIFICATIONS

RIGHT OF WAY DATE:

LETTING DATE:

NCDOT CONTACT

STEVE SCOTT, PE
PROJECT ENGINEER

STEPHEN WILLIAMS
DIVISION PROJECT MANAGER-NCDOT

PROJECT ENGINEER

6/15/2015

DocuSigned by:
Steve Scott

SIGNATURE:

ROADWAY DESIGN ENGINEER

SIGNATURE:

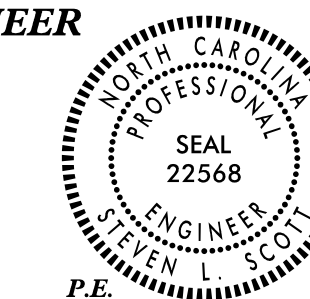

P.E.

**DIVISION OF HIGHWAYS
STATE OF NORTH CAROLINA**

