

**This electronic collection of documents is provided  
for the convenience of the user  
and is Not a Certified Document –**

**The documents contained herein were originally issued  
and sealed by the individuals whose names and license  
numbers appear on each page, on the dates appearing  
with their signature on that page.**

**This file or an individual page  
shall not be considered a certified document.**

CONTRACT: WBS 44102.1.FSI T.I.P.: W-5514

STATE OF NORTH CAROLINA  
DEPARTMENT OF TRANSPORTATION

**PAVEMENT MARKING PLAN  
CUMBERLAND COUNTY**

LOCATION: SR 1007 (OWEN DRIVE) FROM WALTER REED ROAD  
TO US 301 /I-95 BUSINESS

PROJECT REFERENCE NO. W-5514	SHEET NO. PMP-1
APPROVED: _____	
DATE: _____	
SEAL	
	

**INDEX**

SHEET NO.	DESCRIPTION
PMP-1	PAVEMENT MARKING PLAN TITLE AND SCHEDULE SHEET
PMP-2	CROSSWALK PAVEMENT MARKING GUIDANCE DETAIL
PMP-3	REVISED PAVEMENT MARKING ROADWAY STANDARD DRAWING
PMP-4-15	PAVEMENT MARKING DETAIL

**ROADWAY STANDARD DRAWING**

THE FOLLOWING ROADWAY STANDARDS AS APPEAR IN "ROADWAY STANDARD DRAWINGS" - PROJECT SERVICES UNIT - N.C. DEPARTMENT OF TRANSPORTATION - RALEIGH, N.C., DATED JANUARY 2012 ARE APPLICABLE TO THIS PROJECT AND BY REFERENCE HEREBY ARE CONSIDERED A PART OF THESE PLANS:

STD. NO.	TITLE
1205.01	PAVEMENT MARKINGS - LINE TYPES AND OFFSETS
1205.02	PAVEMENT MARKINGS - TWO-LANE AND MULTILANE ROADWAYS
1205.04	PAVEMENT MARKINGS - INTERSECTIONS
1205.05	PAVEMENT MARKINGS - TURN LANES
1205.06	PAVEMENT MARKINGS - LANE DROPS
1205.08	PAVEMENT MARKINGS - SYMBOLS AND WORD MESSAGES
1205.09	PAVEMENT MARKINGS - PAINTED ISLANDS
1250.01	RAISED PAVEMENT MARKERS - INSTALLATION SPACING
1251.01	RAISED PAVEMENT MARKERS - PERMANENT AND TEMPORARY

**PAVEMENT  
MARKING SCHEDULE**

SYMBOL	DESCRIPTION	TOTAL QUANTITY	
T2	THERMOPLASTIC (24", 120 MILS) WHITE STOPBAR	TOTAL 1918 LF	
TA	THERMOPLASTIC (4", 90 MILS) WHITE EDGELINE	TOTAL 21538 LF	
TB	YELLOW EDGELINE		
T8	THERMOPLASTIC (4", 120 MILS) 2 FT. - 6 FT./SP WHITE MINISKIP	TOTAL 28861 LF	
T9	2 FT. - 6 FT./SP YELLOW MINISKIP		
TC	10 FT. WHITE SKIP		
TD	3 FT. - 9 FT./SP WHITE MINISKIP		
TE	WHITE SOLID LANE LINE		
TF	10 FT. YELLOW SKIP		
TH	YELLOW SINGLE CENTER		
TI	YELLOW DOUBLE CENTER		
TN	THERMOPLASTIC (8", 90 MILS) WHITE GORELINE		TOTAL 3531 LF
TO	WHITE DIAGONAL		
TP	YELLOW DIAGONAL		
T13	THERMOPLASTIC (8", 120 MILS) 3 FT. - 9 FT./SP WHITE MINISKIP	TOTAL 6882 LF	
TR	WHITE SOLID LANE LINE		
TQ	WHITE CROSSWALK LINE		
TU	THERMOPLASTIC (12", 90 MILS) WHITE DIAGONAL	TOTAL 102 LF	
TV	YELLOW DIAGONAL		
UA	THERMOPLASTIC PAVEMENT MARKING SYMBOLS (90 MILS) LEFT TURN ARROW	TOTAL 252 EA	
UB	RIGHT TURN ARROW		
UC	STRAIGHT ARROW		
UE	COMBO. STRAIGHT/RIGHT		
UN	24" YIELD LINE TRIANGLE		
UI	THERMOPLASTIC PAVEMENT MARKING CHARACTER (120 MILS) ALPHANUMERIC CHARACTER		TOTAL 16 EA
VB	POLYUREA LINES (4") YELLOW EDGELINE		
VC	10 FT. WHITE SKIP		
MA	PERMANENT RAISED PAVEMENT MARKERS YELLOW & YELLOW	TOTAL 1702 EA	
MB	CRYSTAL & RED		

**GENERAL NOTES**

THE FOLLOWING GENERAL NOTES APPLY AT ALL TIMES FOR THE DURATION OF THE CONSTRUCTION PROJECT, EXCEPT WHEN OTHERWISE NOTED IN THE PLAN, OR DIRECTED BY THE ENGINEER.

- A) INSTALL PAVEMENT MARKINGS AND PAVEMENT MARKERS ON THE FINAL SURFACE AS FOLLOWS:

ROAD NAME	MARKING	MARKER
-L- LINE, -Y- LINES	THERMOPLASTIC	PERMANENT RAISED
PRIVATE DRIVEWAY	PAINT	NONE
- B) TIE PROPOSED PAVEMENT MARKING LINES TO EXISTING PAVEMENT MARKING LINES.
- C) REMOVE/REPLACE ANY CONFLICTING/DAMAGED PAVEMENT MARKINGS AND MARKERS.
- D) STOP BAR LOCATION AT NON-SIGNALIZED INTERSECTIONS MAY BE ADJUSTED AS DIRECTED BY THE ENGINEER.
- E) UNLESS OTHERWISE SPECIFIED, HEATED-IN-PLACE THERMOPLASTIC MAY BE USED IN LIEU OF EXTRUDED THERMOPLASTIC FOR STOP BARS, SYMBOLS, CHARACTERS AND DIAGONALS. IF HEATED-IN-PLACE IS USED, IT SHALL BE PAID FOR USING THE EXTRUDED THERMOPLASTIC PAY ITEM.
- F) REFER TO APPROVED TRAFFIC SIGNAL PLANS FOR STOP BAR PLACEMENT AT SIGNALIZED INTERSECTIONS.

PLAN PREPARED BY: VHB Engineering NC, P.C.

A. MATTHEW THIGPEN, PE



4000 WestChase Boulevard Suite 530  
Raleigh, NC 27607  
NC License No. C-3705

PROJECT REFERENCE NO.	SHEET NO.
W-5514	PMP-2
APPROVED: _____	
DATE: _____	
SEAL	
REVISIONS	

UNLESS OTHERWISE SPECIFIED,  
HI-VISIBILITY CROSSWALK  
MARKINGS SHALL BE USED AT  
MID-BLOCK CROSSINGS

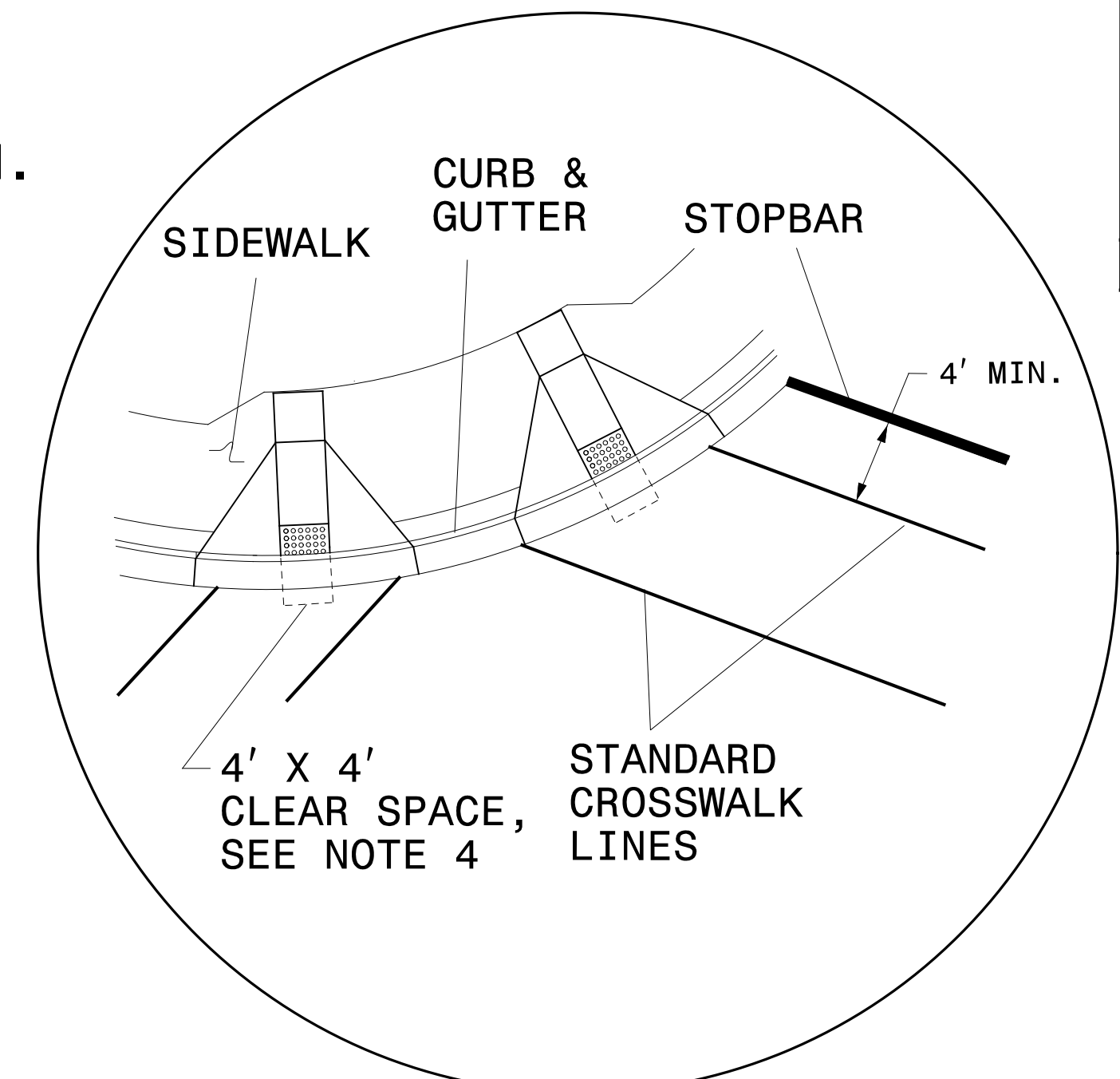
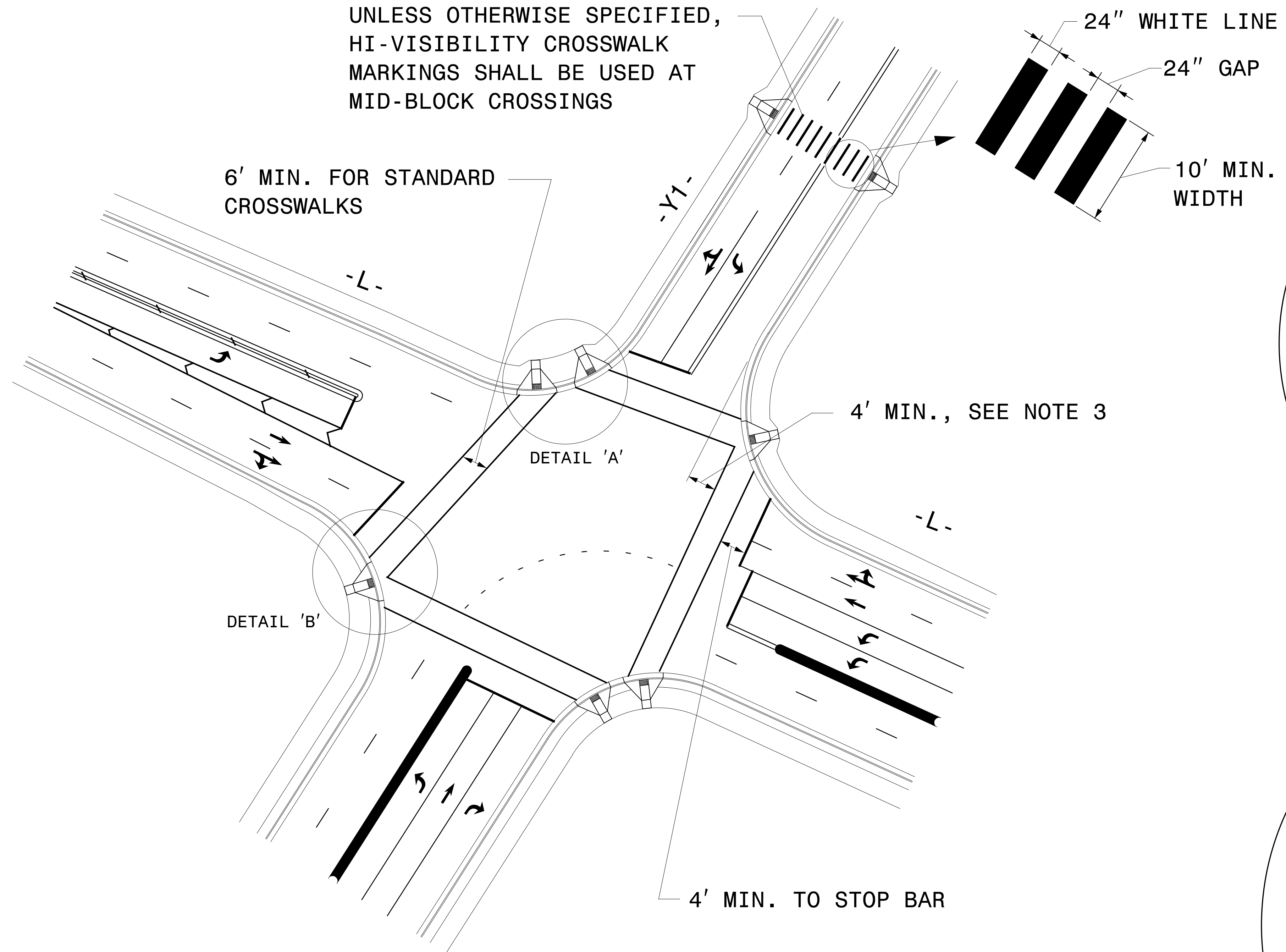

DETAIL 'A'- DUAL CURB RAMPS

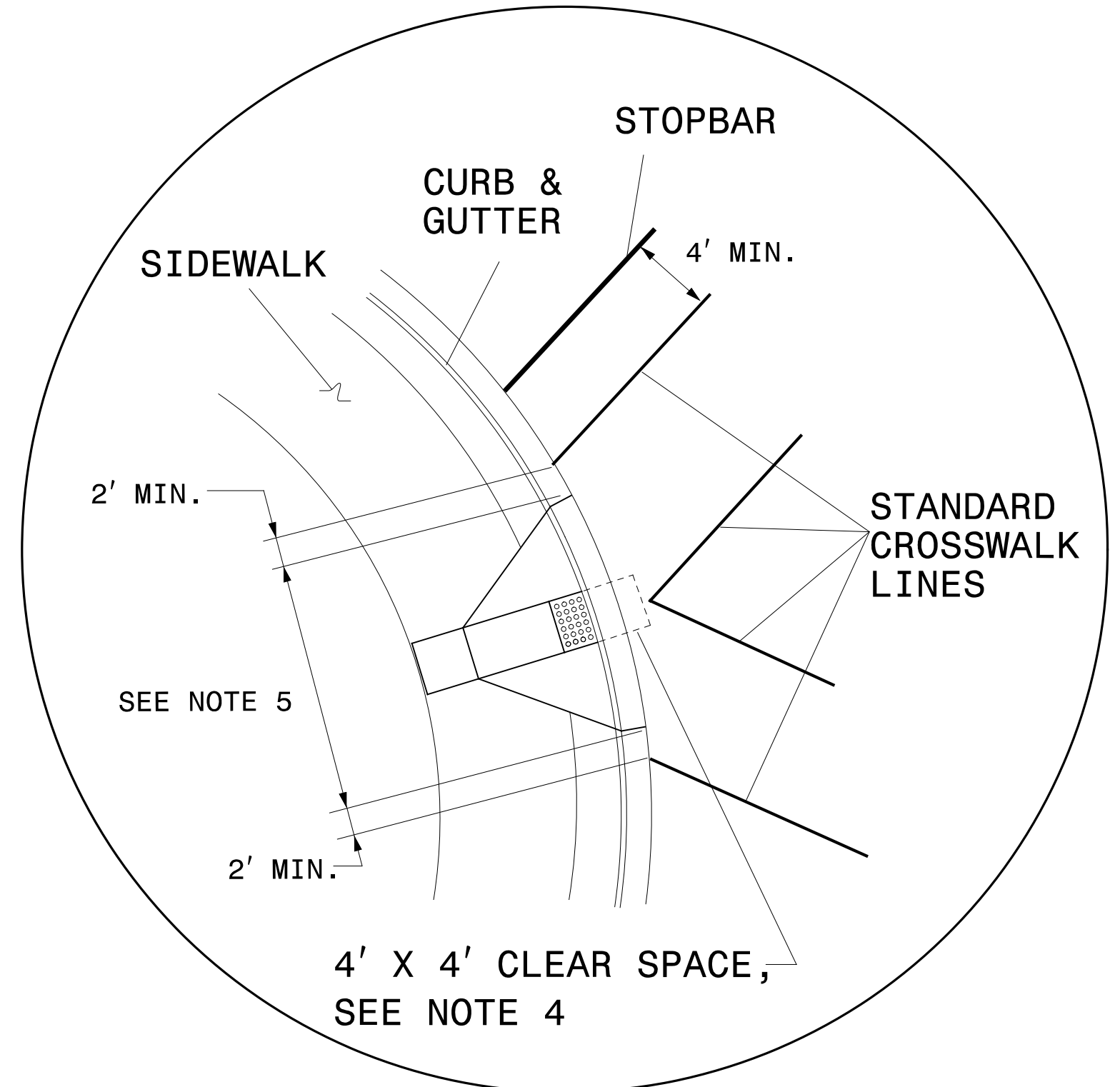

DETAIL 'B'- SINGLE DIAGONAL CURB RAMP

**GUIDANCE DETAIL FOR CROSSWALK MARKINGS**

**NOTES:**

1. USE THE DETAILS ABOVE AND THE FOLLOWING NOTES FOR GUIDANCE IN PLACING CROSSWALK MARKINGS NOT STATIONED ON THE DETAIL SHEETS OR WHEN FIELD ADJUSTMENTS REQUIRED MOVING STATIONED MARKINGS AS DIRECTED BY THE ENGINEER. REFER TO NCDOT ROADWAY STANDARD DRAWINGS, MUTCD AND ADA STANDARDS FOR ADDITIONAL GUIDANCE.
2. THE CROSSWALK MARKINGS SHOWN ON THE ABOVE DETAILS ARE FOR REFERENCE ONLY. ONLY INSTALL CROSSWALK MARKINGS WHERE SHOWN ON THE DETAIL SHEETS OR AS DIRECTED BY THE ENGINEER. THE CROSSWALK MARKING TYPE, STANDARD OR HI-VISIBILITY, SHALL BE INSTALL AS SPECIFIED ON THE DETAIL SHEETS OR AS DIRECTED BY THE ENGINEER.
3. SET BACK DISTANCE FROM INSIDE CROSSWALK MARKING TO NEAREST EDGE OF TRAVEL IS 4' MIN.
4. BEYOND THE BOTTOM GRADE BRAKE, A CLEAR SPACE OF 4' X 4' MINIMUM SHALL BE PROVIDED WITHIN THE MARKINGS.
5. SINGLE DIAGONAL CURB RAMPS WITH FLARED SIDES SHALL HAVE A SEGMENT OF CURB 2 FEET LONG MINIMUM LOCATED ON EACH SIDE OF THE CURB RAMP AND WITHIN THE MARKED CROSSING, SEE DETAIL 'B'.
6. CURB RAMPS SHALL BE CONSTRUCTED IN ACCORDANCE TO THE LATEST NCDOT ROADWAY STANDARD DRAWINGS.

**CROSSWALK PAVEMENT MARKING  
GUIDANCE DETAIL**

STATE OF NORTH CAROLINA  
DEPT. OF TRANSPORTATION  
DIVISION OF HIGHWAYS  
RALEIGH, N.C.

1-12

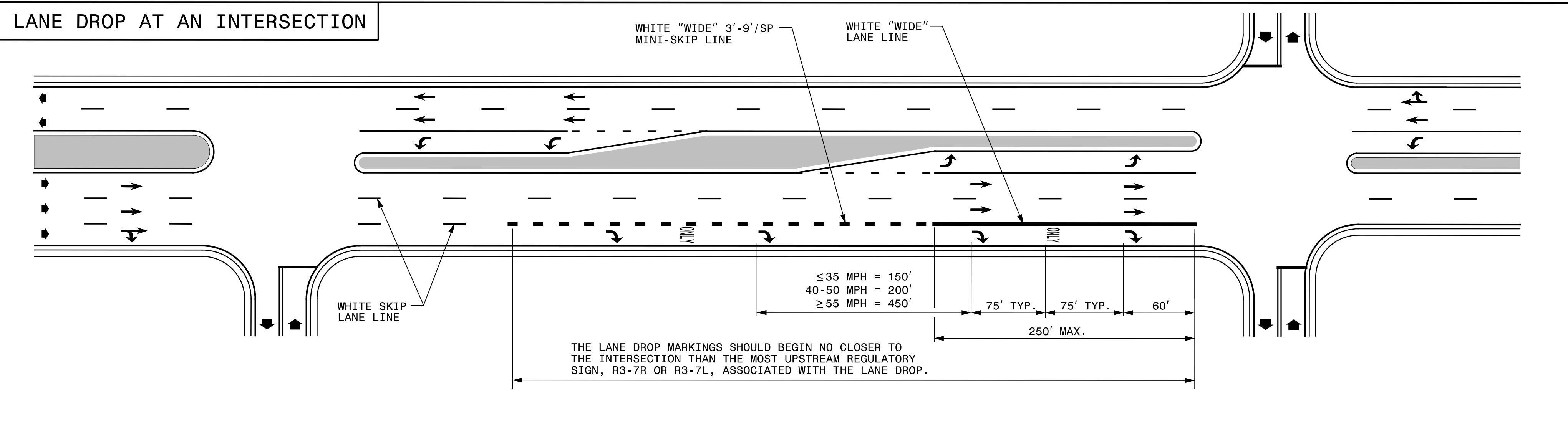

1-12

STATE OF NORTH CAROLINA  
DEPT. OF TRANSPORTATION  
DIVISION OF HIGHWAYS  
RALEIGH, N.C.

ENGLISH DETAIL DRAWING FOR  
PAVEMENT MARKINGS  
LANE DROPS

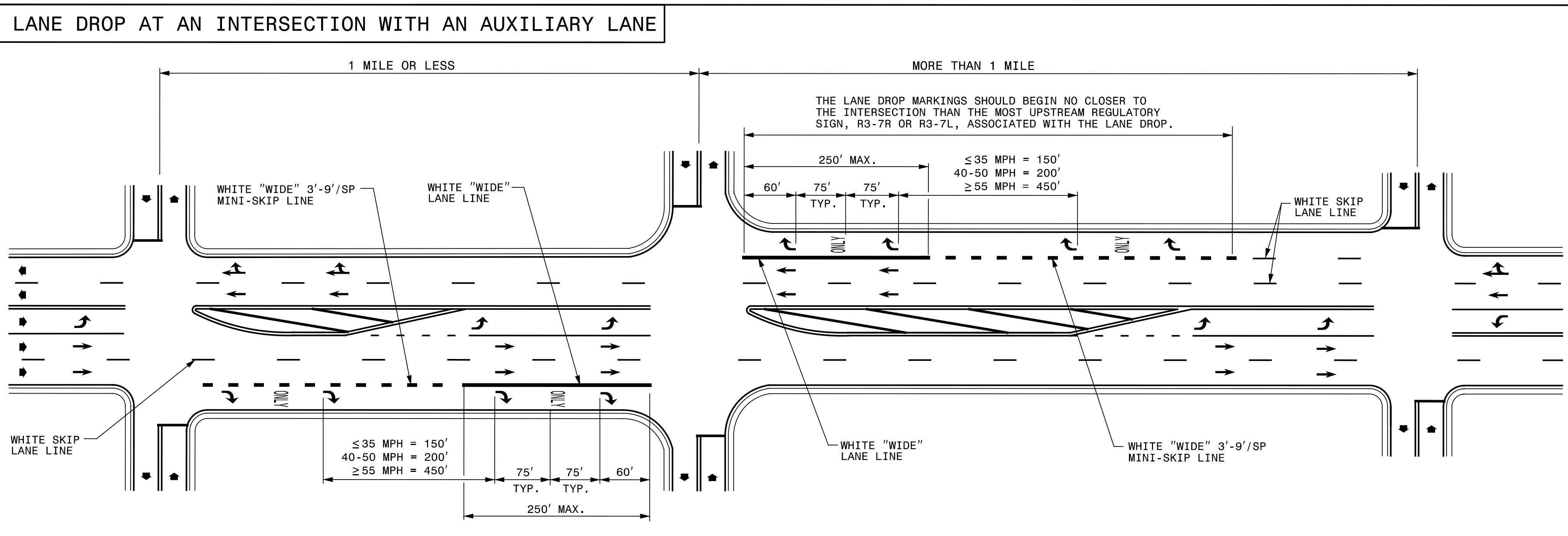

GENERAL NOTES:

- 1- USE THE GUIDANCE SHOWN ON THE ABOVE DETAILS IN CONJUNCTION WITH INTERSECTION GUIDANCE SHOWN ON ROADWAY STANDARD DRAWING 1205.04.
- 2- LANE LINES INDICATED AS "WIDE" SHALL BE AT LEAST TWICE THE WIDTH OF THE NORMAL LINE.

LEGEND	
W = WIDTH OF TRAVEL LANE	ONLY PAVEMENT MARKING SYMBOLS & CHARACTERS
➔ DIRECTION OF TRAFFIC FLOW	

SHEET 1 OF 3  
**1205D06**

SHEET 1 OF 3  
**1205D06**

ENGLISH DETAIL DRAWING FOR  
PAVEMENT MARKINGS  
LANE DROPS

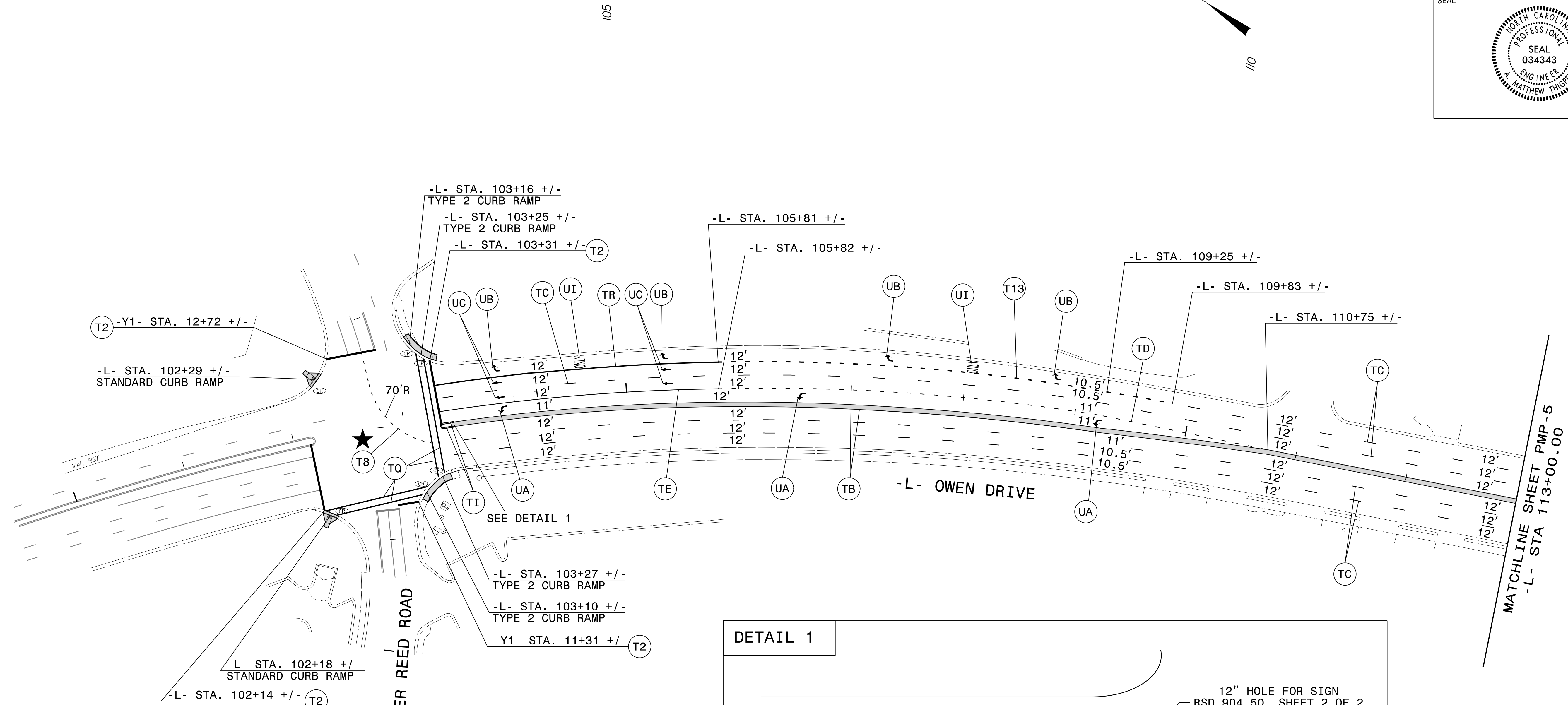

PAVEMENT MARKING SCHEDULE	
SYMBOL	DESCRIPTION
T2	WHITE STOPBAR (24", 120 MIL)
T8	2FT.- 6FT./SP WHITE MINISKIP (4", 120 MIL)
T13	3FT.- 9FT./SP WHITE MINISKIP (8", 120 MIL)
TB	YELLOW EDGELINE (4", 90 MIL)
TC	10 FT. WHITE SKIP (4", 120 MIL)
TD	3FT.- 9FT./SP WHITE MINISKIP (4", 120 MIL)
TE	WHITE SOLID LANE LINE (4", 120 MIL)
TI	YELLOW DOUBLE CENTER (4", 120 MIL)
TQ	WHITE CROSSWALK LINE (8", 120 MIL)
TR	WHITE SOLID LANE LINE (8", 120 MIL)
UA	LEFT TURN ARROW (90 MIL)
UB	RIGHT TURN ARROW (90 MIL)
UC	STRAIGHT ARROW (90 MIL)
UI	ALPHANUMERIC CHAR. (120 MIL)

★ SIGNALIZED

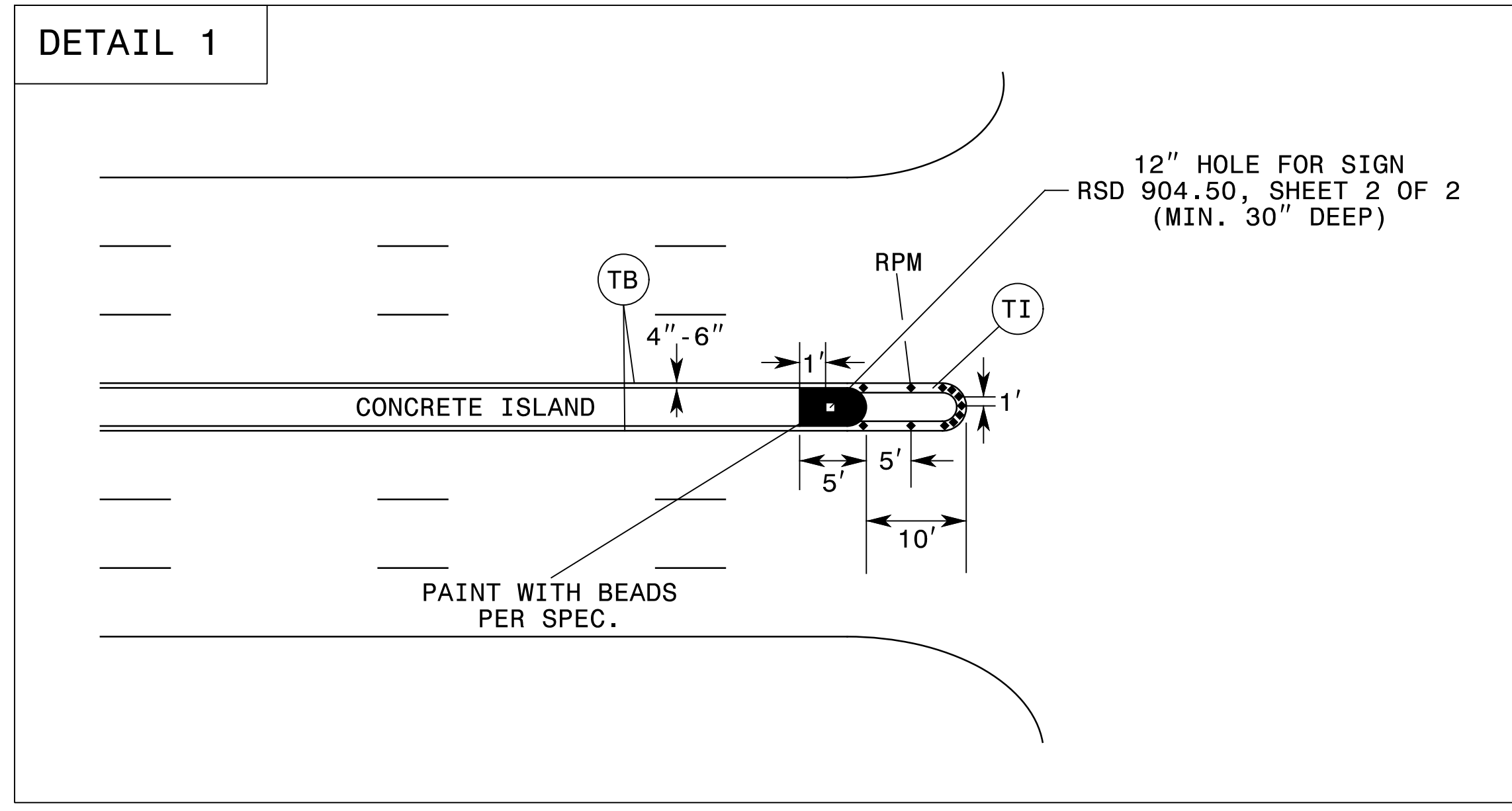

PAVEMENT MARKING DETAIL

4/29/2016 \\fs01\cra\raleigh\38286.03 NCDOT W-5514 Owen Drive NCDOT\TrafficControl\CPA\W5514\_pm\_psh\_04.dgn  
 User: mtrigen

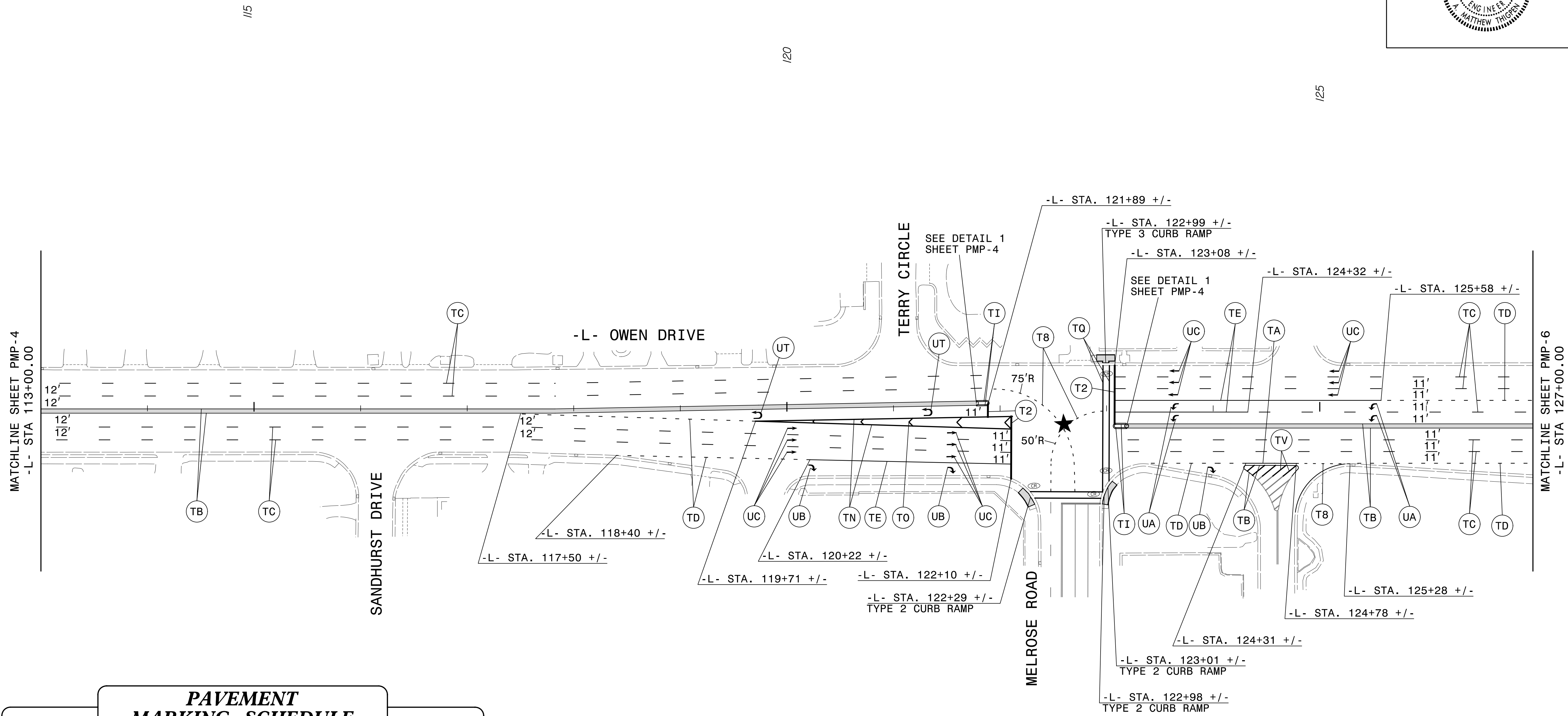
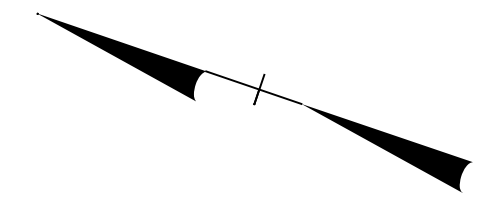
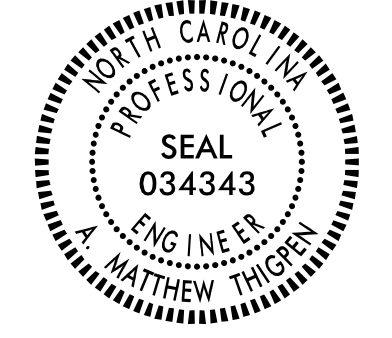

**PAVEMENT MARKING SCHEDULE**

SYMBOL	DESCRIPTION
T2	WHITE STOPBAR (24", 120 MIL)
T8	2FT.- 6FT./SP WHITE MINISKIP (4", 120 MIL)
TB	YELLOW EDGELINE (4", 90 MIL)
TC	10 FT. WHITE SKIP (4", 120 MIL)
TD	3FT.- 9FT./SP WHITE MINISKIP (4", 120 MIL)
TE	WHITE SOLID LANE LINE (4", 120 MIL)
TI	YELLOW DOUBLE CENTER (4", 120 MIL)
TN	WHITE GORELINE (8", 90 MIL)
TO	WHITE DIAGONAL (8", 90 MIL)
TQ	WHITE CROSSWALK LINE (8", 120 MIL)
TV	YELLOW DIAGONAL (12", 90 MIL)
UA	LEFT TURN ARROW (90 MIL)
UB	RIGHT TURN ARROW (90 MIL)
UC	STRAIGHT ARROW (90 MIL)
UT	U-TURN ARROW (90 MIL)

**★ SIGNALIZED**

**PAVEMENT MARKING DETAIL**

4/29/2015  
 C:\Users\mtrigen\Documents\Projects\W-5514\_Owen Drive\NCDOT\TrafficControl\CPA\W5514\_pmp\_psh\_05.dgn  
 User: mtrigen

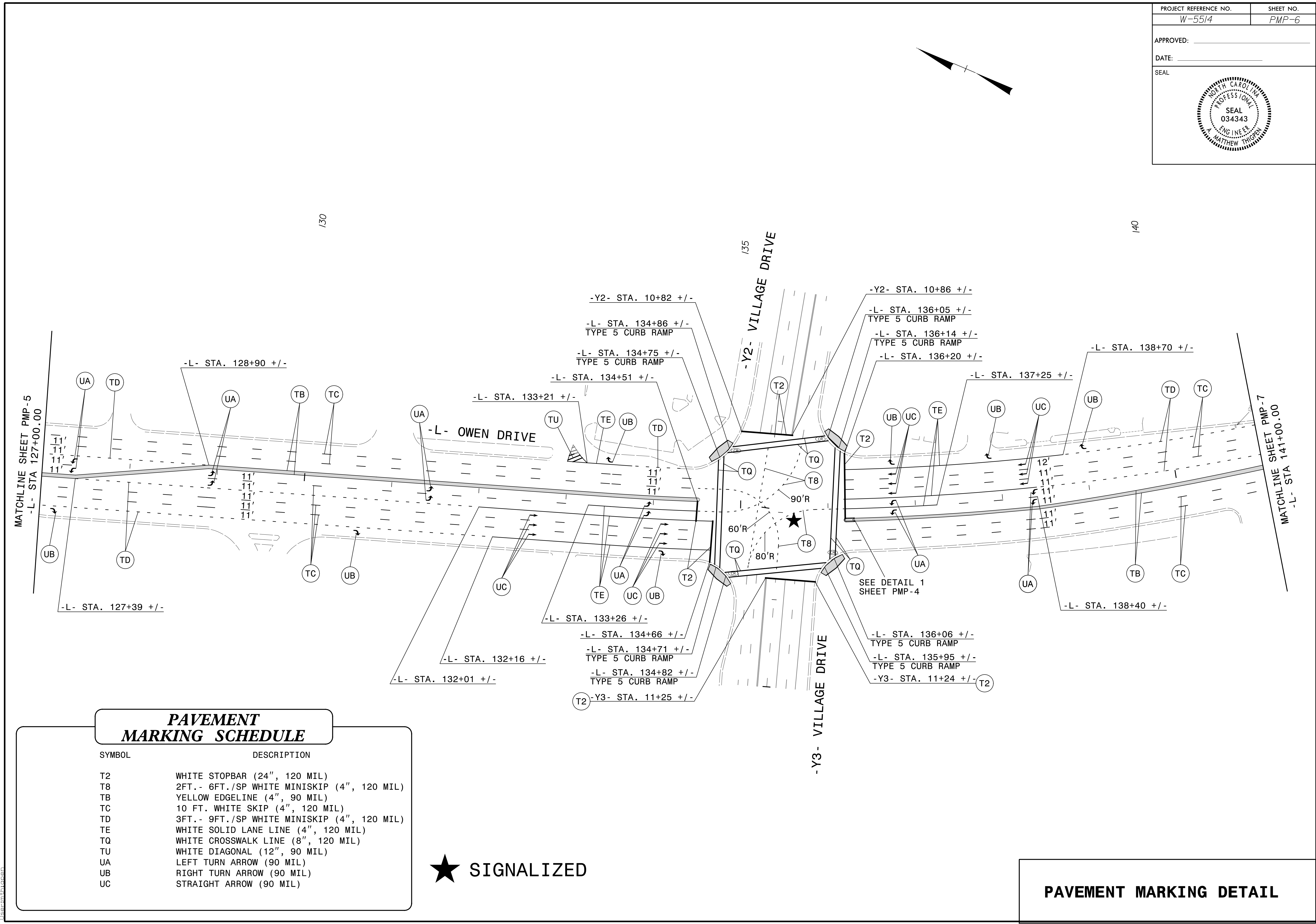
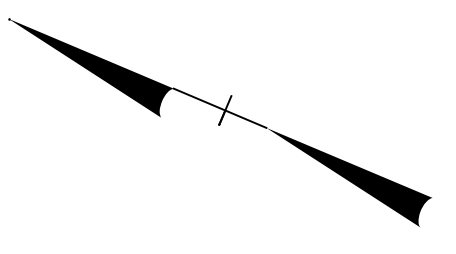

### PAVEMENT MARKING SCHEDULE

SYMBOL	DESCRIPTION
T2	WHITE STOPBAR (24", 120 MIL)
T8	2FT.- 6FT./SP WHITE MINISKIP (4", 120 MIL)
TB	YELLOW EDGELINE (4", 90 MIL)
TC	10 FT. WHITE SKIP (4", 120 MIL)
TD	3FT.- 9FT./SP WHITE MINISKIP (4", 120 MIL)
TE	WHITE SOLID LANE LINE (4", 120 MIL)
TQ	WHITE CROSSWALK LINE (8", 120 MIL)
TU	WHITE DIAGONAL (12", 90 MIL)
UA	LEFT TURN ARROW (90 MIL)
UB	RIGHT TURN ARROW (90 MIL)
UC	STRAIGHT ARROW (90 MIL)

**★ SIGNALIZED**

### PAVEMENT MARKING DETAIL

4/29/2016 C:\Users\ralesgh\38286.03 NCDOT W-5514 Owen Drive\NCDOT\TrafficControl\TCPA\W5514\_pm\_psh\_06.dgn User:ralesgh

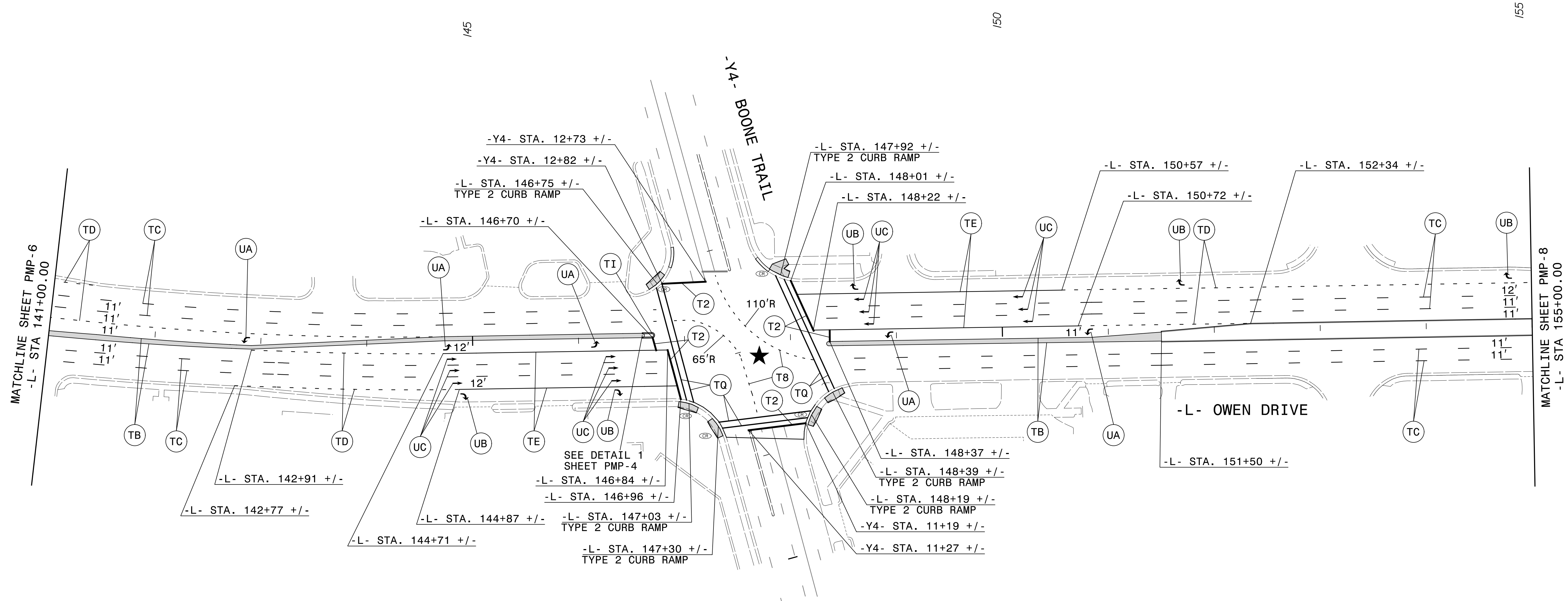

PAVEMENT MARKING SCHEDULE	
SYMBOL	DESCRIPTION
T2	WHITE STOPBAR (24", 120 MIL)
T8	2FT.- 6FT./SP WHITE MINISKIP (4", 120 MIL)
TB	YELLOW EDGELINE (4", 90 MIL)
TC	10 FT. WHITE SKIP (4", 120 MIL)
TD	3FT.- 9FT./SP WHITE MINISKIP (4", 120 MIL)
TE	WHITE SOLID LANE LINE (4", 120 MIL)
TQ	WHITE CROSSWALK LINE (8", 120 MIL)
UA	LEFT TURN ARROW (90 MIL)
UB	RIGHT TURN ARROW (90 MIL)
UC	STRAIGHT ARROW (90 MIL)

★ SIGNALIZED

PAVEMENT MARKING DETAIL

4/28/2015 \\fs01\cra\raleigh\38286.03 NCDOT W-5514 Owen Drive\NCDOT\TrafficControl\CPA\W5514\_pm\_psh\_07.dgn User:mtoban



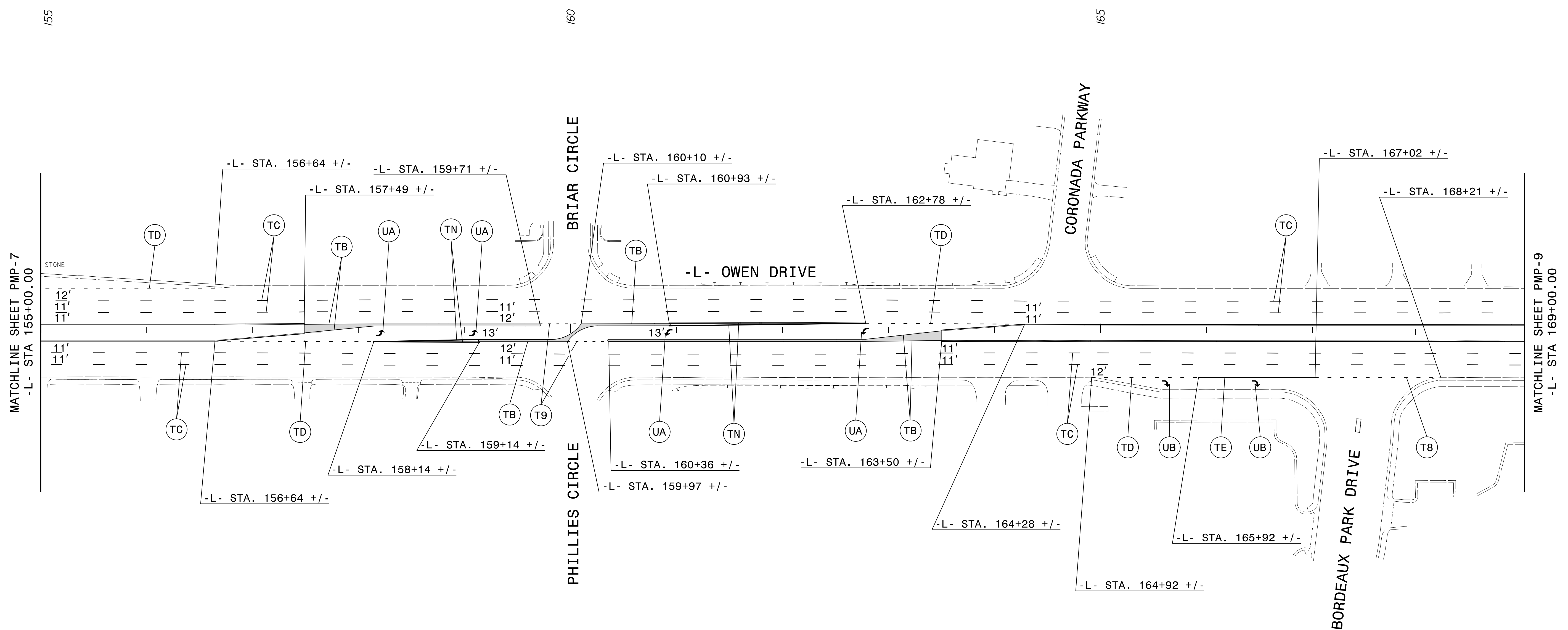
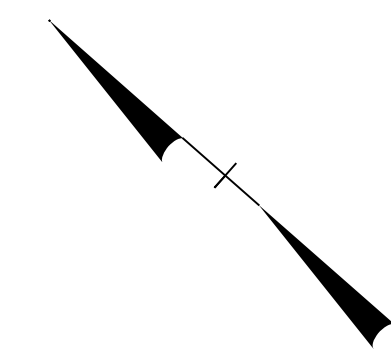
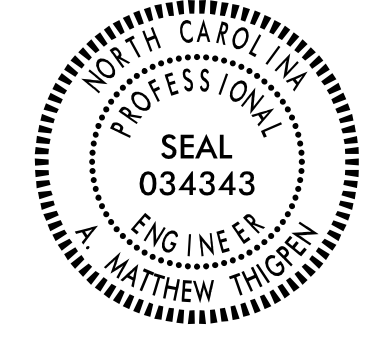

**PAVEMENT MARKING SCHEDULE**

SYMBOL	DESCRIPTION
T8	2FT.- 6FT./SP WHITE MINISKIP (4", 120 MIL)
T9	2FT.- 6FT./SP YELLOW MINISKIP (4", 120 MIL)
TB	YELLOW EDGELINE (4", 90 MIL)
TC	10 FT. WHITE SKIP (4", 120 MIL)
TD	3FT.- 9FT./SP WHITE MINISKIP (4", 120 MIL)
TE	WHITE SOLID LANE LINE (4", 120 MIL)
TN	WHITE GORELINE (8", 90 MIL)
UA	LEFT TURN ARROW (90 MIL)
UB	RIGHT TURN ARROW (90 MIL)

**PAVEMENT MARKING DETAIL**

4/29/2015  
 C:\Users\mtrigen\OneDrive\Documents\Projects\TrafficControl\CPA\W5514\_pmp\_psh\_08.dgn  
 User: mtrigen

APPROVED: \_\_\_\_\_

DATE: \_\_\_\_\_

SEAL

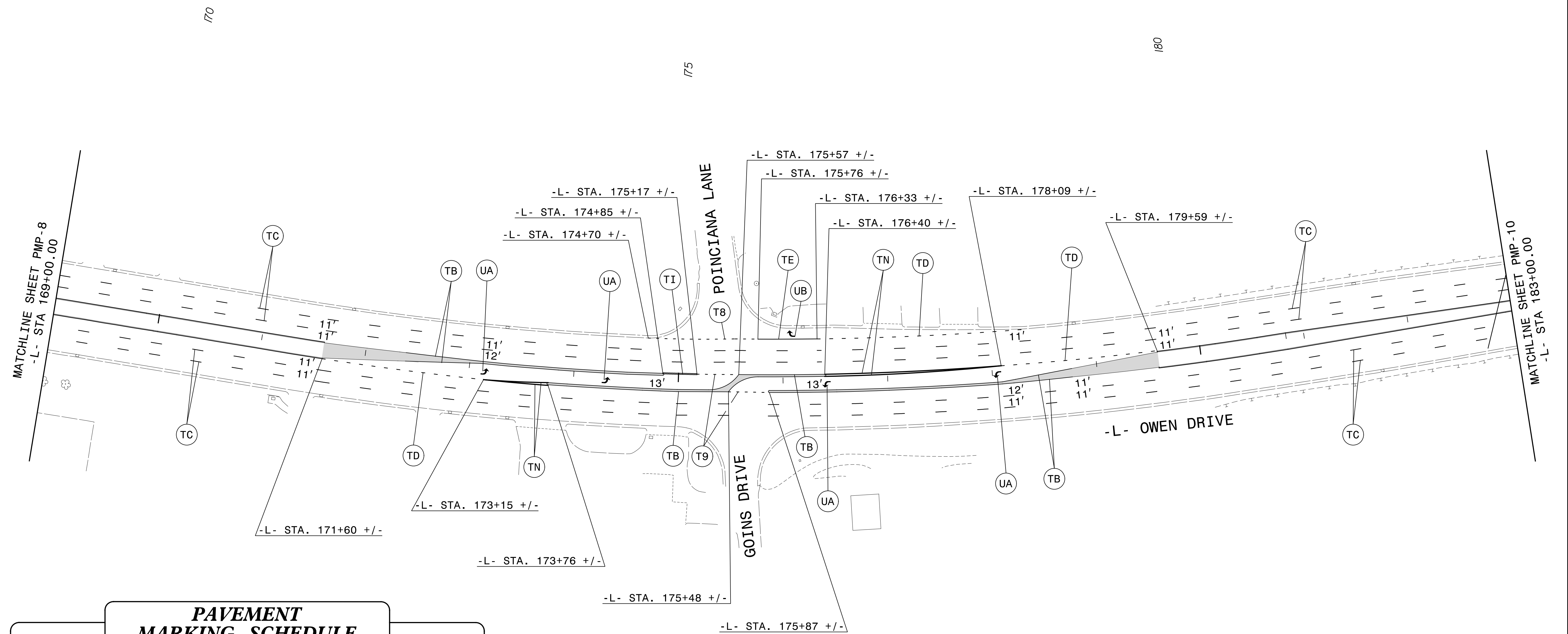
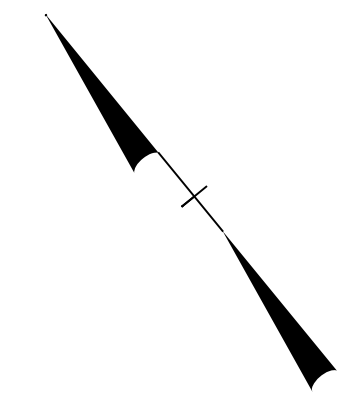
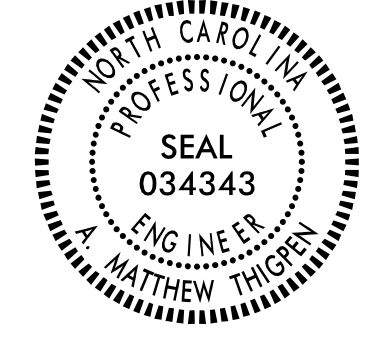

**PAVEMENT MARKING SCHEDULE**

SYMBOL	DESCRIPTION
T8	2FT.- 6FT./SP WHITE MINISKIP (4", 120 MIL)
T9	2FT.- 6FT./SP YELLOW MINISKIP (4", 120 MIL)
TA	WHITE EDGELINE (4", 90 MIL)
TB	YELLOW EDGELINE (4", 90 MIL)
TC	10 FT. WHITE SKIP (4", 120 MIL)
TD	3FT.- 9FT./SP WHITE MINISKIP (4", 120 MIL)
TE	WHITE SOLID LANE LINE (4", 120 MIL)
TN	WHITE GORELINE (8", 90 MIL)
UA	LEFT TURN ARROW (90 MIL)
UB	RIGHT TURN ARROW (90 MIL)

**PAVEMENT MARKING DETAIL**

4/29/2015  
 C:\Users\mthigpen\Documents\Projects\W-5514\_Owen\_Drive\NCDOT\TrafficControl\CPA\W5514\_pm\_psh\_09.dgn  
 User: mthigpen

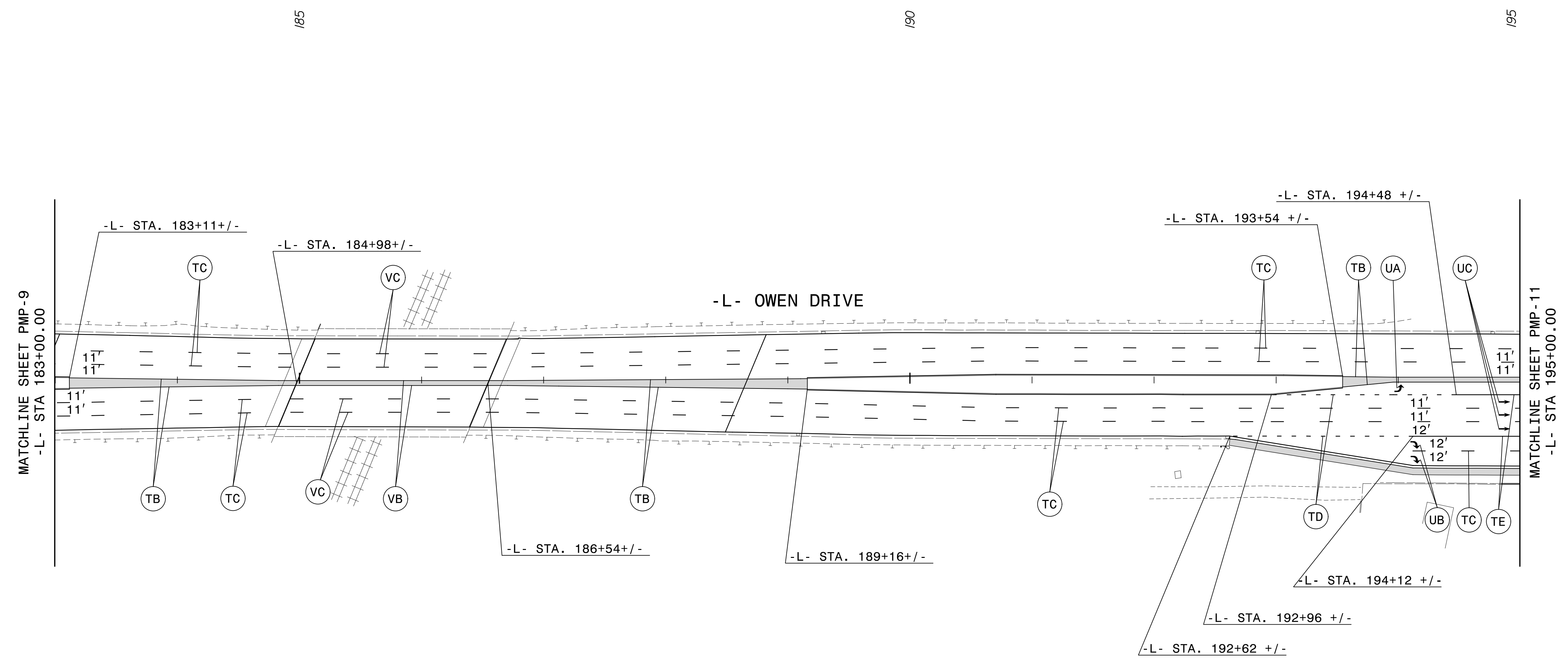
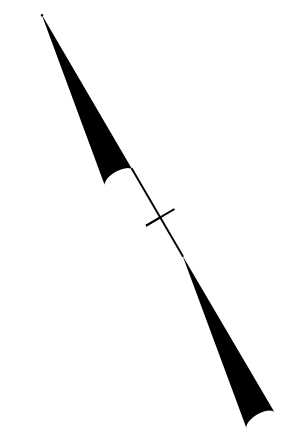
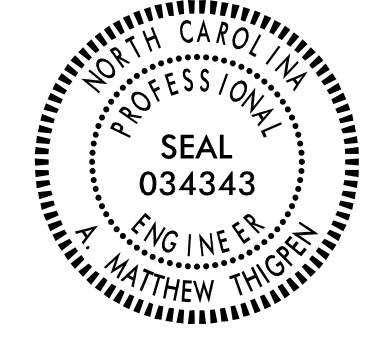

**PAVEMENT MARKING SCHEDULE**

SYMBOL	DESCRIPTION
TB	YELLOW EDGELINE (4", 90 MIL)
TC	10 FT. WHITE SKIP (4", 120 MIL)
TD	3FT.- 9FT./SP WHITE MINISKIP (4", 120 MIL)
TE	WHITE SOLID LANE LINE (4", 120 MIL)
UA	LEFT TURN ARROW (90 MIL)
UB	RIGHT TURN ARROW (90 MIL)
UC	STRAIGHT ARROW (90 MIL)
VB	YELLOW EDGELINE (4")
VC	10 FT. WHITE SKIP (4")

**PAVEMENT MARKING DETAIL**

4/28/2015  
 C:\Users\mthigen\Documents\Projects\Owen Drive\TrafficControl\CPA\W5514\_pmp\_psh\_10.dgn  
 User: mthigen

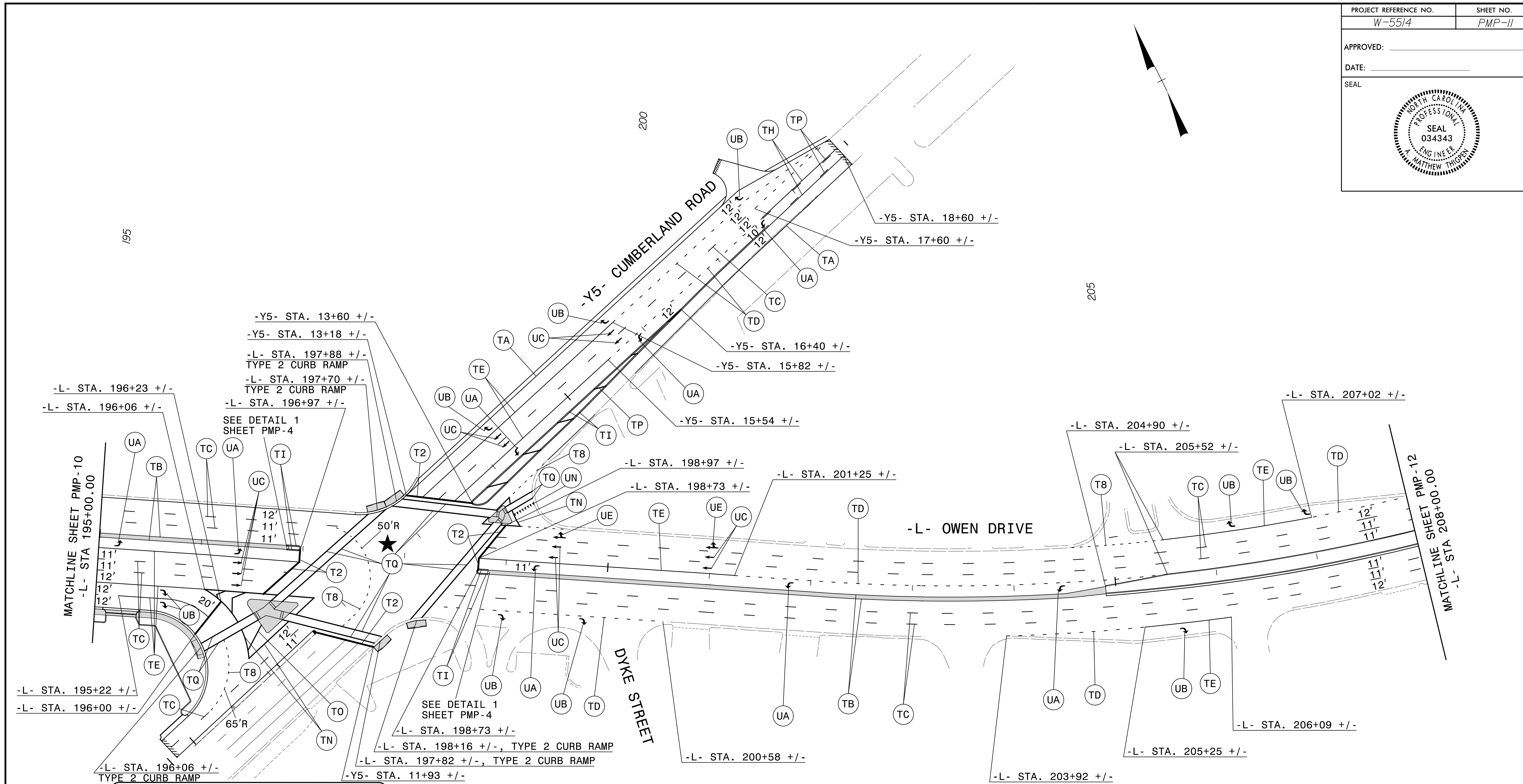

**PAVEMENT MARKING SCHEDULE**

SYMBOL	DESCRIPTION
T2	WHITE STOPBAR (24", 120 MIL)
T8	2FT.- 6FT./SP WHITE MINISKIP (4", 120 MIL)
TA	WHITE EDGELINE (4", 90 MIL)
TB	YELLOW EDGELINE (4", 90 MIL)
TC	10 FT. WHITE SKIP (4", 120 MIL)
TD	3FT.- 9FT./SP WHITE MINISKIP (4", 120 MIL)
TE	WHITE SOLID LANE LINE (4", 120 MIL)
TF	10 FT. YELLOW SKIP (4", 120 MIL)
TH	YELLOW SINGLE CENTER (4", 120 MIL)
TI	YELLOW DOUBLE CENTER (4", 120 MIL)
TN	WHITE GORELINE (8", 90 MIL)
TO	WHITE DIAGONAL (8", 90 MIL)
TP	YELLOW DIAGONAL (8", 90 MIL)
TQ	WHITE CROSSWALK LINE (8", 120 MIL)
UA	LEFT TURN ARROW (90 MIL)
UB	RIGHT TURN ARROW (90 MIL)
UC	STRAIGHT ARROW (90 MIL)
UE	COMBO. RIGHT/STRAIGHT ARROW (90 MIL)
UN	24" YIELD LINE TRIANGLE (90 MIL)

★ SIGNALIZED

**PAVEMENT MARKING DETAIL**

4/29/2015 \\fsd\cra\raleigh\38286.03\_NCDOT\_W-5514\_Owen\_Drive\NCDOT1\TrafficControl\TCF\W5514\_pmp\_psh-11.dgn  
User:mtm008

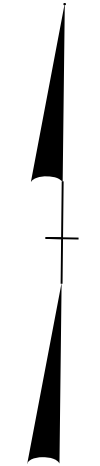
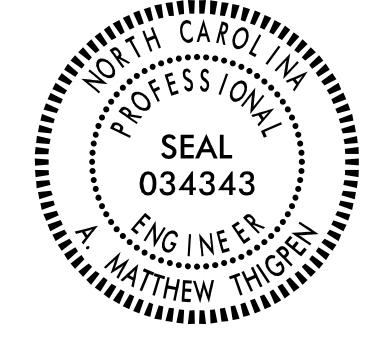

220

210

215

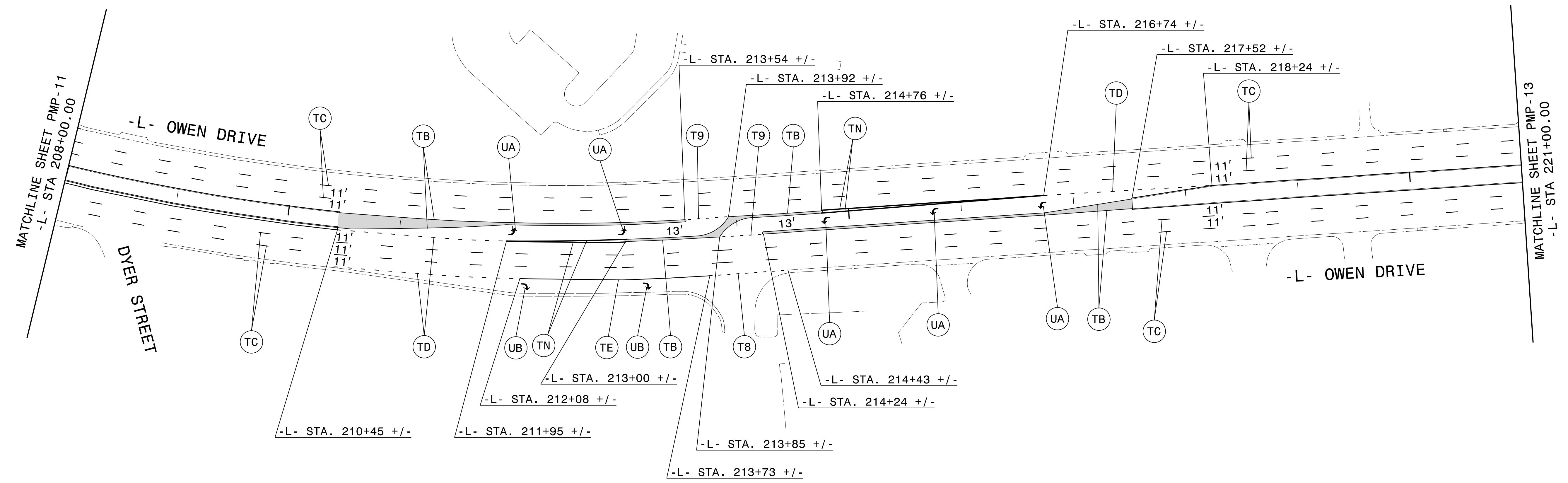

**PAVEMENT MARKING SCHEDULE**

SYMBOL	DESCRIPTION
T8	2FT.- 6FT./SP WHITE MINISKIP (4", 120 MIL)
T9	2FT.- 6FT./SP YELLOW MINISKIP (4", 120 MIL)
TA	WHITE EDGELINE (4", 90 MIL)
TB	YELLOW EDGELINE (4", 90 MIL)
TC	10 FT. WHITE SKIP (4", 120 MIL)
TD	3FT.- 9FT./SP WHITE MINISKIP (4", 120 MIL)
TE	WHITE SOLID LANE LINE (4", 120 MIL)
TN	WHITE GORELINE (8", 90 MIL)
UA	LEFT TURN ARROW (90 MIL)
UB	RIGHT TURN ARROW (90 MIL)

**PAVEMENT MARKING DETAIL**

4/28/2015  
 C:\Users\mthigpen\Documents\Projects\W-5514 Owen Drive\NCDOT\TrafficControl\CPA\W5514\_pmp\_psh\_12.dgn  
 User: mthigpen

APPROVED: \_\_\_\_\_

DATE: \_\_\_\_\_

SEAL

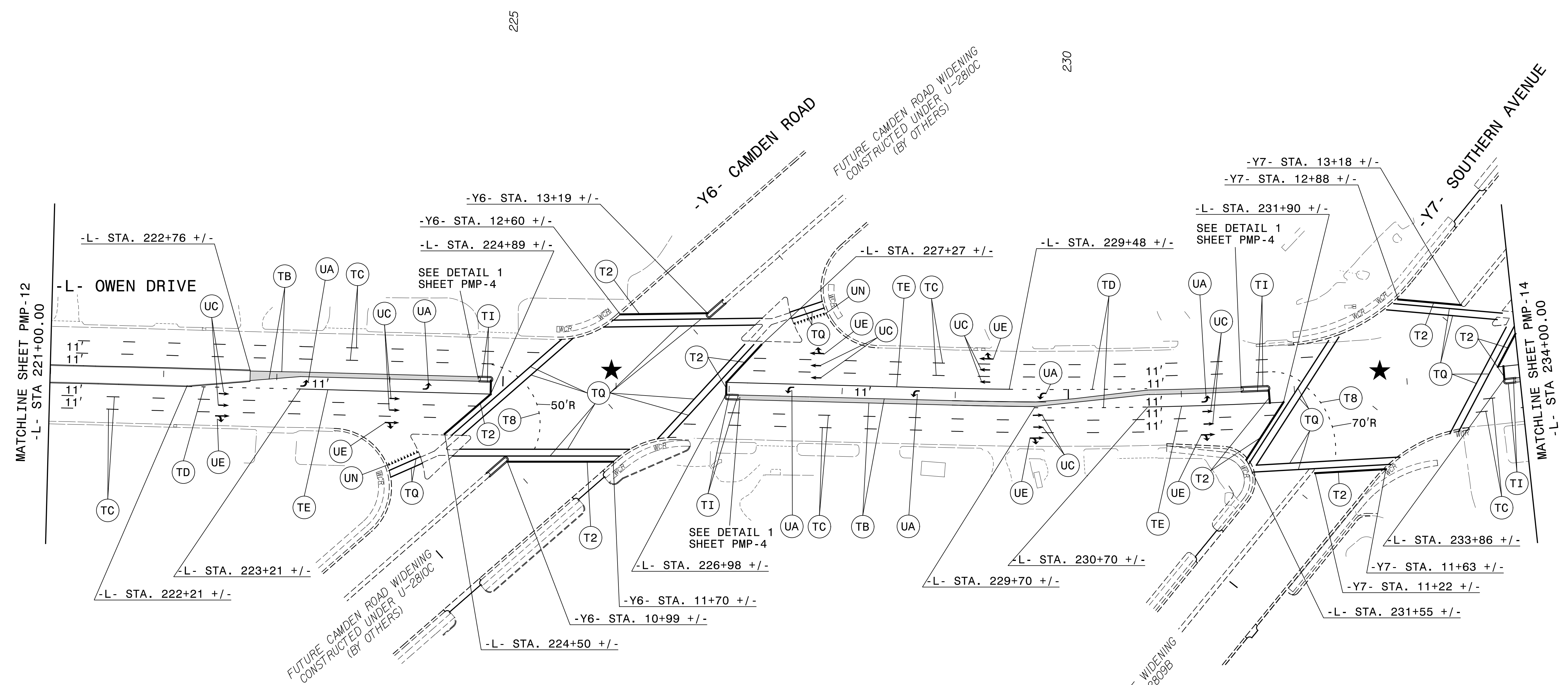
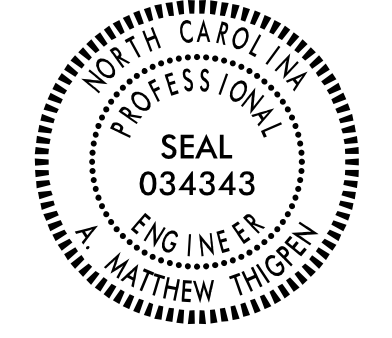

**PAVEMENT MARKING SCHEDULE**

SYMBOL	DESCRIPTION
T2	WHITE STOPBAR (24", 120 MIL)
T8	2FT.- 6FT./SP WHITE MINISKIP (4", 120 MIL)
TB	YELLOW EDGELINE (4", 90 MIL)
TC	10 FT. WHITE SKIP (4", 120 MIL)
TD	3FT.- 9FT./SP WHITE MINISKIP (4", 120 MIL)
TE	WHITE SOLID LANE LINE (4", 120 MIL)
TI	YELLOW DOUBLE CENTER (4", 120 MIL)
TQ	WHITE CROSSWALK LINE (8", 120 MIL)
UA	LEFT TURN ARROW (90 MIL)
UC	STRAIGHT ARROW (90 MIL)
UE	COMBO. RIGHT/STRAIGHT ARROW (90 MIL)
UN	24" YIELD LINE TRIANGLE (90 MIL)

★ SIGNALIZED

**PAVEMENT MARKING DETAIL**

4/29/2016 C:\Users\mtrigen\OneDrive\Documents\Projects\TrafficControl\CPA\W5514\pmp\_13.dgn  
 User: mtrigen

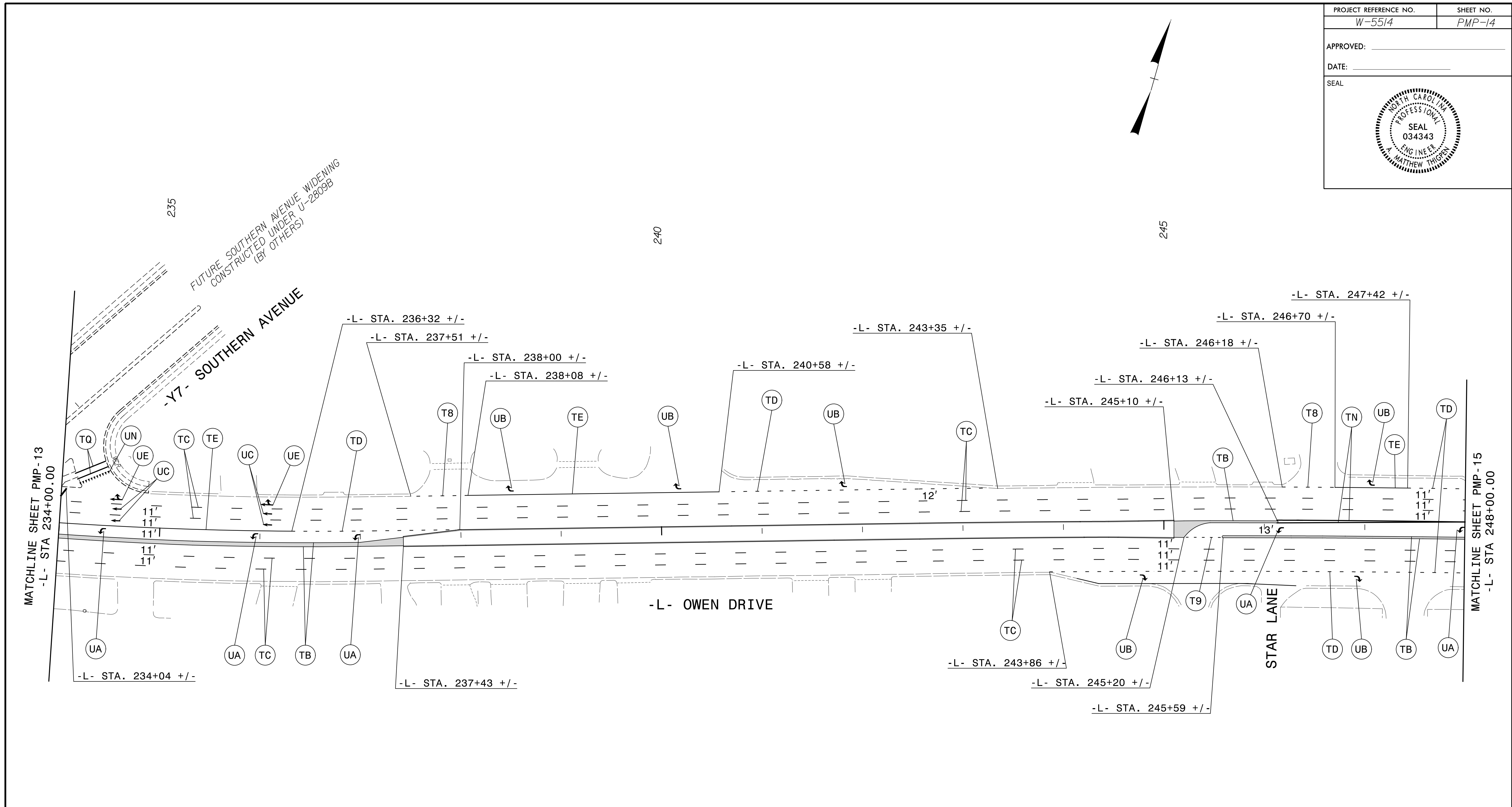
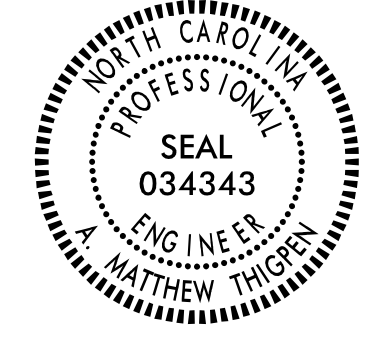

**PAVEMENT MARKING SCHEDULE**

SYMBOL	DESCRIPTION
T8	2FT.- 6FT./SP WHITE MINISKIP (4", 120 MIL)
T9	2FT.- 6FT./SP YELLOW MINISKIP (4", 120 MIL)
TA	WHITE EDGELINE (4", 90 MIL)
TB	YELLOW EDGELINE (4", 90 MIL)
TC	10 FT. WHITE SKIP (4", 120 MIL)
TD	3FT.- 9FT./SP WHITE MINISKIP (4", 120 MIL)
TE	WHITE SOLID LANE LINE (4", 120 MIL)
TI	YELLOW DOUBLE CENTER (4", 120 MIL)
TN	WHITE GORELINE (8", 90 MIL)
UA	LEFT TURN ARROW (90 MIL)
UB	RIGHT TURN ARROW (90 MIL)
UC	STRAIGHT ARROW (90 MIL)
UE	COMBO. RIGHT/STRAIGHT ARROW (90 MIL)
UN	24" YIELD LINE TRIANGLE (90 MIL)

**PAVEMENT MARKING DETAIL**

4/28/2015 C:\Users\mtrigen\OneDrive\Documents\Projects\Owen Drive\TrafficControl\CPA\W5514\_pmp\_psh\_14.dgn  
 User: mtrigen

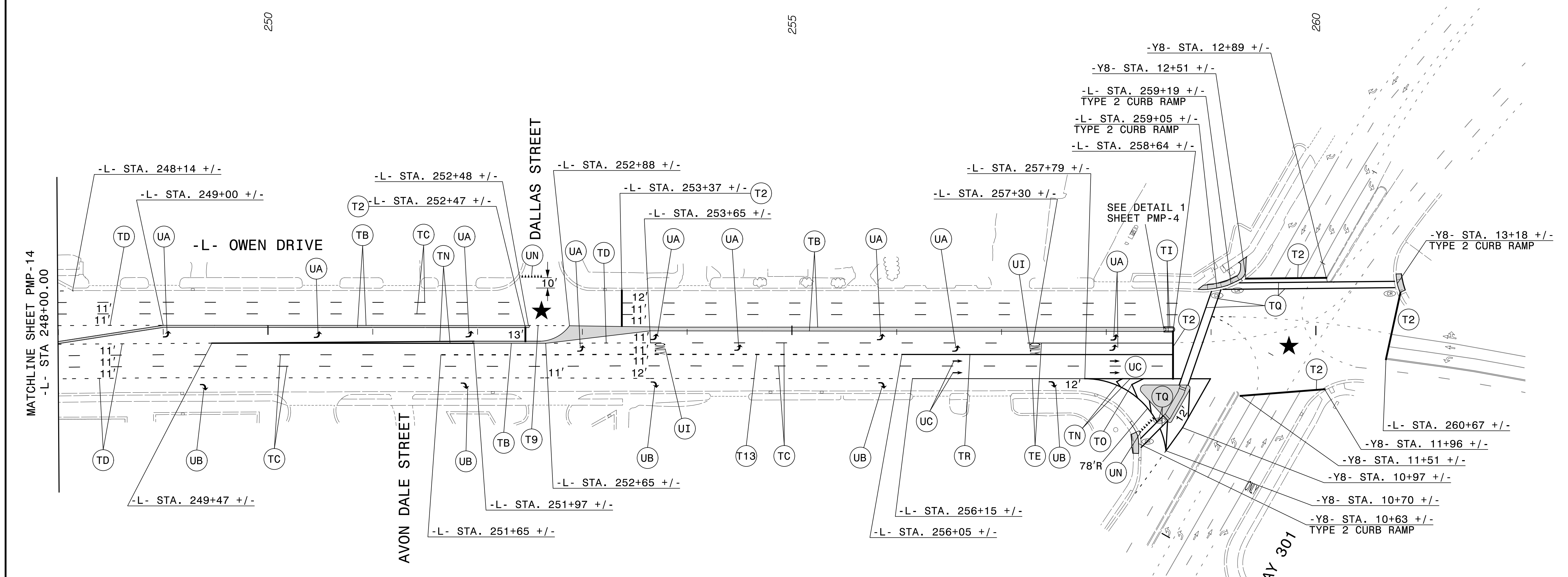
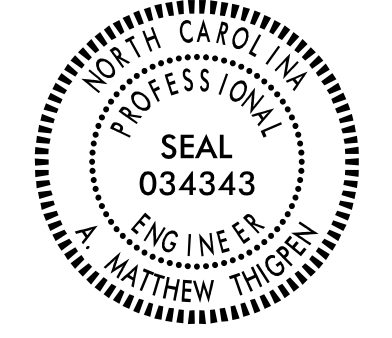

MATCHLINE SHEET PMP-14  
-L- STA. 248+00.00

**PAVEMENT MARKING SCHEDULE**

SYMBOL	DESCRIPTION
T2	WHITE STOPBAR (24", 120 MIL)
T8	2FT.- 6FT./SP WHITE MINISKIP (4", 120 MIL)
T9	2FT.- 6FT./SP YELLOW MINISKIP (4", 120 MIL)
TA	WHITE EDGELINE (4", 90 MIL)
TB	YELLOW EDGELINE (4", 90 MIL)
T13	3FT.- 9FT./SP WHITE MINISKIP (8", 120 MIL)
TC	10 FT. WHITE SKIP (4", 120 MIL)
TD	3FT.- 9FT./SP WHITE MINISKIP (4", 120 MIL)
TE	WHITE SOLID LANE LINE (4", 120 MIL)
TI	YELLOW DOUBLE CENTER (4", 120 MIL)
TN	WHITE GORELINE (8", 90 MIL)
TO	WHITE DIAGONAL (8", 90 MIL)
TQ	WHITE CROSSWALK LINE (8", 120 MIL)
TR	WHITE SOLID LANE LINE (8", 120 MIL)
UA	LEFT TURN ARROW (90 MIL)
UB	RIGHT TURN ARROW (90 MIL)
UC	STRAIGHT ARROW (90 MIL)

★ SIGNALIZED

**PAVEMENT MARKING DETAIL**

4/29/2016 C:\Users\mtrigen\OneDrive\Documents\Projects\TrafficControl\CPA\W5514\pmp\_15.dgn