

PROJECT REFERENCE NO.		SHEET NO.	
W-5514		EC-15/CONST J5	
RW SHEET NO.			
ROADWAY DESIGN ENGINEER		HYDRAULICS ENGINEER	

EROSION CONTROL FOR CONSTRUCTION SHEET 15

-L-
 PI Sta 246+02.70
 $\Delta = 1' 58' 42.7''$ (RT)
 $D = 0' 17' 11.3''$
 $L = 690.64'$
 $T = 345.35'$
 $R = 20,000.00'$
 $DS > 50$ mph

RETROFIT EXISTING CURB RAMP WITH TRADITIONAL FINISHES AS NEEDED AND AS DIRECTED BY THE ENGINEER

MATCHLINE SHEET 14
 -L- STA 248+00.00

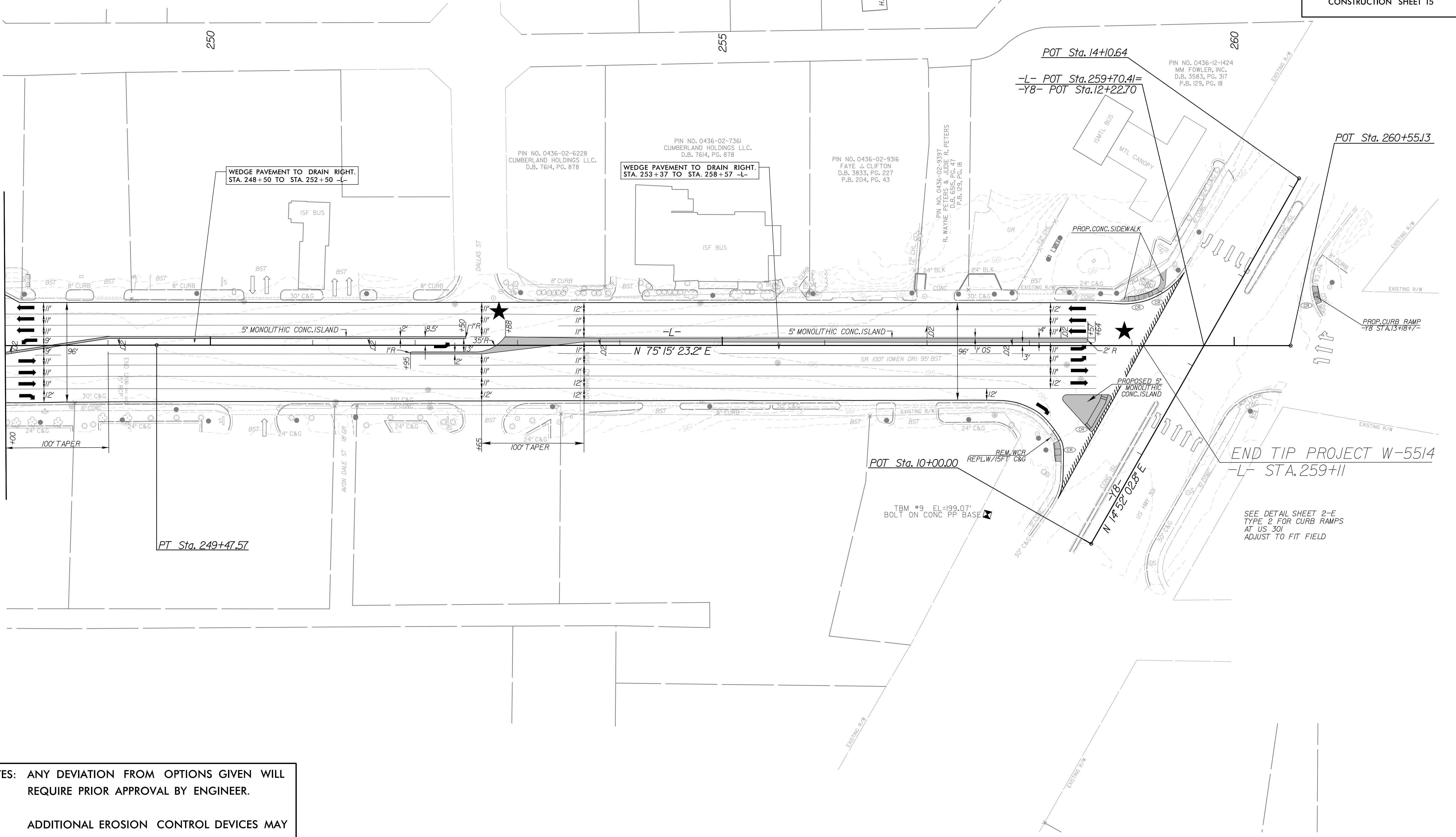

NOTES: ANY DEVIATION FROM OPTIONS GIVEN WILL REQUIRE PRIOR APPROVAL BY ENGINEER.

ADDITIONAL EROSION CONTROL DEVICES MAY NEED TO BE INSTALLED AS DIRECTED BY THE ENGINEER.

END TIP PROJECT W-5514
 -L- STA. 259+11

SEE DETAIL SHEET 2-E
 TYPE 2 FOR CURB RAMP
 AT US 301
 ADJUST TO FIT FIELD