

BENCH MARK # 25: RR SPIKE IN BASE OF 610mm OAK; 59.0m RT. OF STA 89+70.00 -LREV-, EL. 272.312

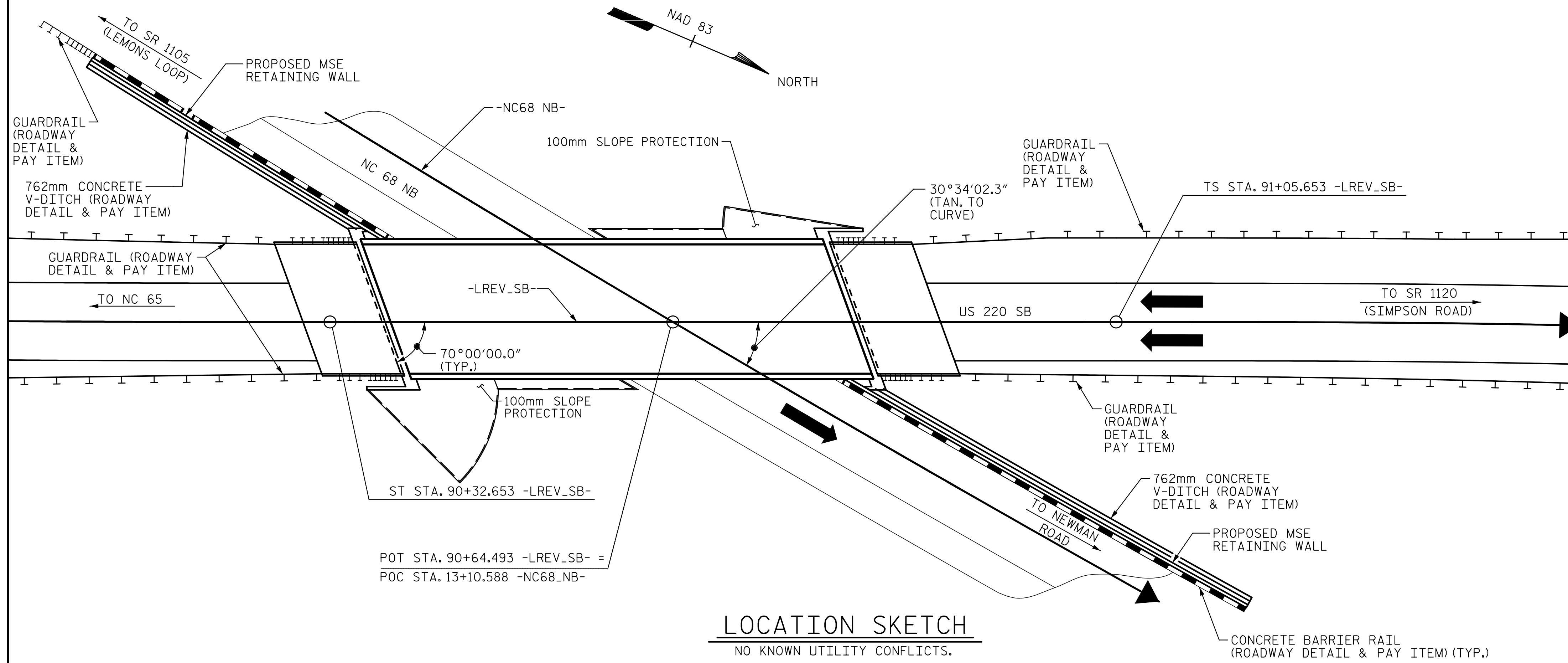

LOCATION SKETCH

NO KNOWN UTILITY CONFLICTS.

NOTES

- ASSUMED LIVE LOAD= HL-93 OR ALTERNATE LOADING.
- THIS BRIDGE HAS BEEN DESIGNED IN ACCORDANCE WITH THE REQUIREMENTS OF THE AASHTO LRFD BRIDGE DESIGN SPECIFICATIONS.
- THIS BRIDGE IS LOCATED IN SEISMIC ZONE 1.
- ALL DIMENSIONS ARE IN MILLIMETERS UNLESS OTHERWISE NOTED.
- ALL ELEVATIONS ARE IN METERS.
- FOR OTHER DESIGN DATA AND GENERAL NOTES, SEE SHEET SNSM.
- REMOVABLE FORMS MAY BE USED IN LIEU OF METAL STAY-IN-PLACE FORMS IN ACCORDANCE WITH ARTICLE 420-3 OF THE STANDARD SPECIFICATIONS UNLESS OTHERWISE NOTED ON THE PLANS.
- FOR MAINTENANCE AND PROTECTION OF TRAFFIC BENEATH PROPOSED STRUCTURE, SEE SPECIAL PROVISIONS.
- FOR SUBMITTAL OF WORKING DRAWINGS, SEE SPECIAL PROVISIONS.
- FOR FALSEWORK AND FORMWORK, SEE SPECIAL PROVISIONS.
- FOR CRANE SAFETY, SEE SPECIAL PROVISIONS.
- FOR GROUT FOR STRUCTURES, SEE SPECIAL PROVISIONS.
- FOR EROSION CONTROL MEASURES SEE EROSION CONTROL PLANS.
- FOR PLACING LOAD ON STRUCTURE MEMBERS, SEE SPECIAL PROVISIONS.
- NEEDLE BEAMS WILL NOT BE ALLOWED UNLESS OTHERWISE CALLED FOR ON THE PLANS OR APPROVED BY THE ENGINEER.
- THE CLASS AA CONCRETE IN THE BRIDGE DECK SHALL CONTAIN FLY ASH OR GROUND GRANULATED BLAST FURNACE SLAG AT THE SUBSTITUTION RATE SPECIFIED IN ARTICLE 1024-1 AND IN ACCORDANCE WITH ARTICLES 1024-5 AND 1024-6 OF THE STANDARD SPECIFICATIONS. NO PAYMENT WILL BE MADE FOR THIS SUBSTITUTION AS IT IS CONSIDERED INCIDENTAL TO THE COST OF THE REINFORCED CONCRETE DECK SLAB.

TOTAL BILL OF MATERIAL													
	REINFORCED CONCRETE DECK SLAB	GROOVING BRIDGE FLOORS	CLASS A CONCRETE	BRIDGE APPROACH SLABS	REINFORCING STEEL	MODIFIED 1880mm PRESTRESSED CONCRETE GIRDERS		HP 310 X 79 STEEL PILES		PILE REDRIVES	CONCRETE BARRIER RAIL	100mm SLOPE PROTECTION	ELASTOMERIC BEARINGS
	SQ. METERS	SQ. METERS	CU. METERS	LUMP SUM	kg	NO.	METERS	NO.	METERS	EACH	METERS	SQ. METERS	LUMP SUM
SUPERSTRUCTURE	571.1	649.3		LUMP SUM		5	218.58				87.936		LUMP SUM
END BENT 1			27.4		2106			10	246	5		252	
END BENT 2			27.1		2069			10	246	5		202	
TOTAL	571.1	649.3	54.5	LUMP SUM	4175	5	218.58	20	492	10	87.936	454	LUMP SUM

TOTAL BILL OF MATERIAL ENGLISH													
	SQ. FT.	SQ. FT.	CU. YDS.	LUMP SUM	LBS.	NO.	LIN. FT.	NO.	LIN. FT.	EACH	LIN. FT.	SQ. YDS.	LUMP SUM
TOTAL	6,147	6,989	71.3	LUMP SUM	9,204	5	717.13	20	1,614	10	288.50	543	LUMP SUM

PROJECT NO. R-2413CA
ROCKINGHAM COUNTY
 STATION: 90+64.493 -LREV_SB-

SHEET 3 OF 3

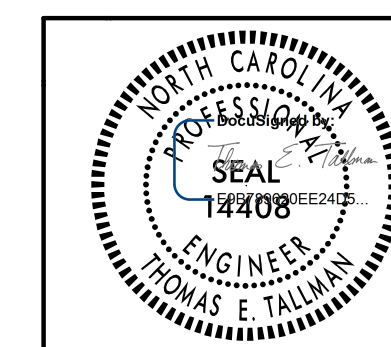
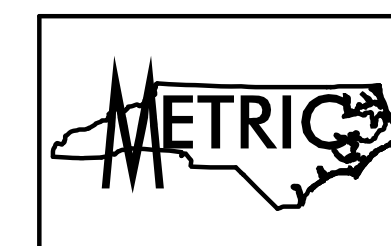

STATE OF NORTH CAROLINA
 DEPARTMENT OF TRANSPORTATION
 RALEIGH

GENERAL DRAWING
 FOR BRIDGE ON US 220 SB
 OVER NC 68 NB
 BETWEEN NC 65 AND SR 1120

REVISIONS						SHEET NO.
NO.	BY:	DATE:	NO.	BY:	DATE:	S01-3
1			3			TOTAL SHEETS
2			4			28



DRAWN BY : D. H. CARTER DATE : FEB 2015
 CHECKED BY : T. E. TALLMAN DATE : FEB 2015
 DESIGN ENGINEER OF RECORD: T. E. TALLMAN DATE : FEB 2015