

TIP NO. R-2413CA	SHEET NO. SIGN-11
APPROVED: <u>Charles A. Johnson, III</u> <small>DocuSigned by: Charles A. Johnson, III 59A1555B47F54A8</small>	
DATE: 2/11/2015	
SEAL	

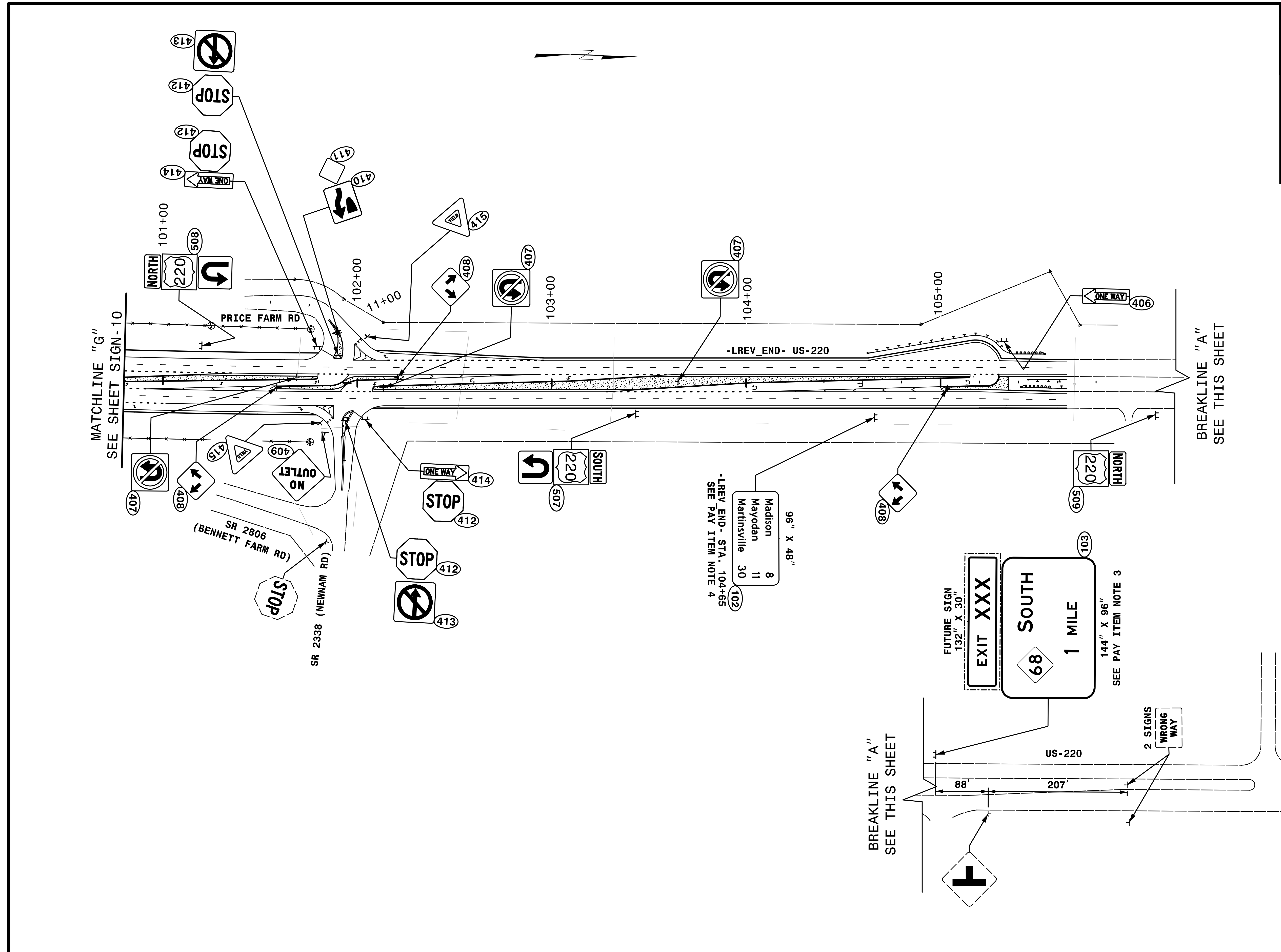

MATCHLINE "G"
SEE SHEET SIGN-10

BREAKLINE "A"
SEE THIS SHEET

BREAKLINE "A"
SEE THIS SHEET

2 SIGNS
WRONG WAY

-LREV_END- STA. 104+65
SEE PAY ITEM NOTE 4

SEE PAY ITEM NOTE 3

FUTURE SIGN
132" X 30"

EXIT XXX

SOUTH
1 MILE
68

144" X 96"

96" X 48"

Madison 8
Mayodan 11
Martinsville 30

US-220

88'

207'

SIMPSON RD



HNTB NORTH CAROLINA, P.C.
343 E. Six Forks Road, Suite 200
Raleigh, North Carolina 27609
NC License No: C-1554

**EXISTING AND PROPOSED SIGNS
STA. 100+80 TO 1 MILE
ADVANCE SIGN**