

METRIC

CONST. REV.
R/W REV.

PROJECT REFERENCE NO. R-2413CA	SHEET NO. EC-14/CONST.5
R/W SHEET NO.	
ROADWAY DESIGN ENGINEER	HYDRAULICS ENGINEER

Erosion Control devices on this sheet have been installed on R-2413C and are shown for reference only

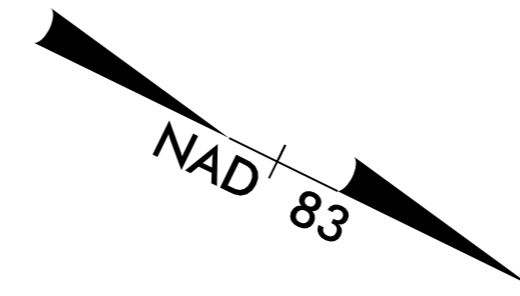

-L REV-

PI Sta 77+51.91	PI Sta 81+36.95
$\Delta = 3^{\circ}09'20.9"$ (LT)	$\Delta = 3^{\circ}09'20.9"$ (RT)
L = 385.004	L = 385.004
T = 192.550	T = 192.550
R = 6,990.000	R = 6,990.000
SE = NC	SE = NC

MATCH LINE STA. 78+00 -L REV- SHEET 4

MATCH LINE STA. 81+50 -L REV- SHEET 6

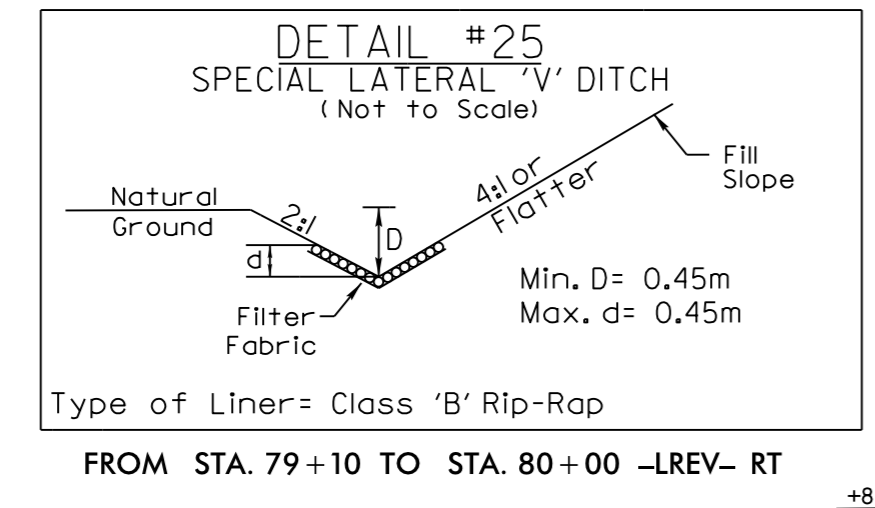
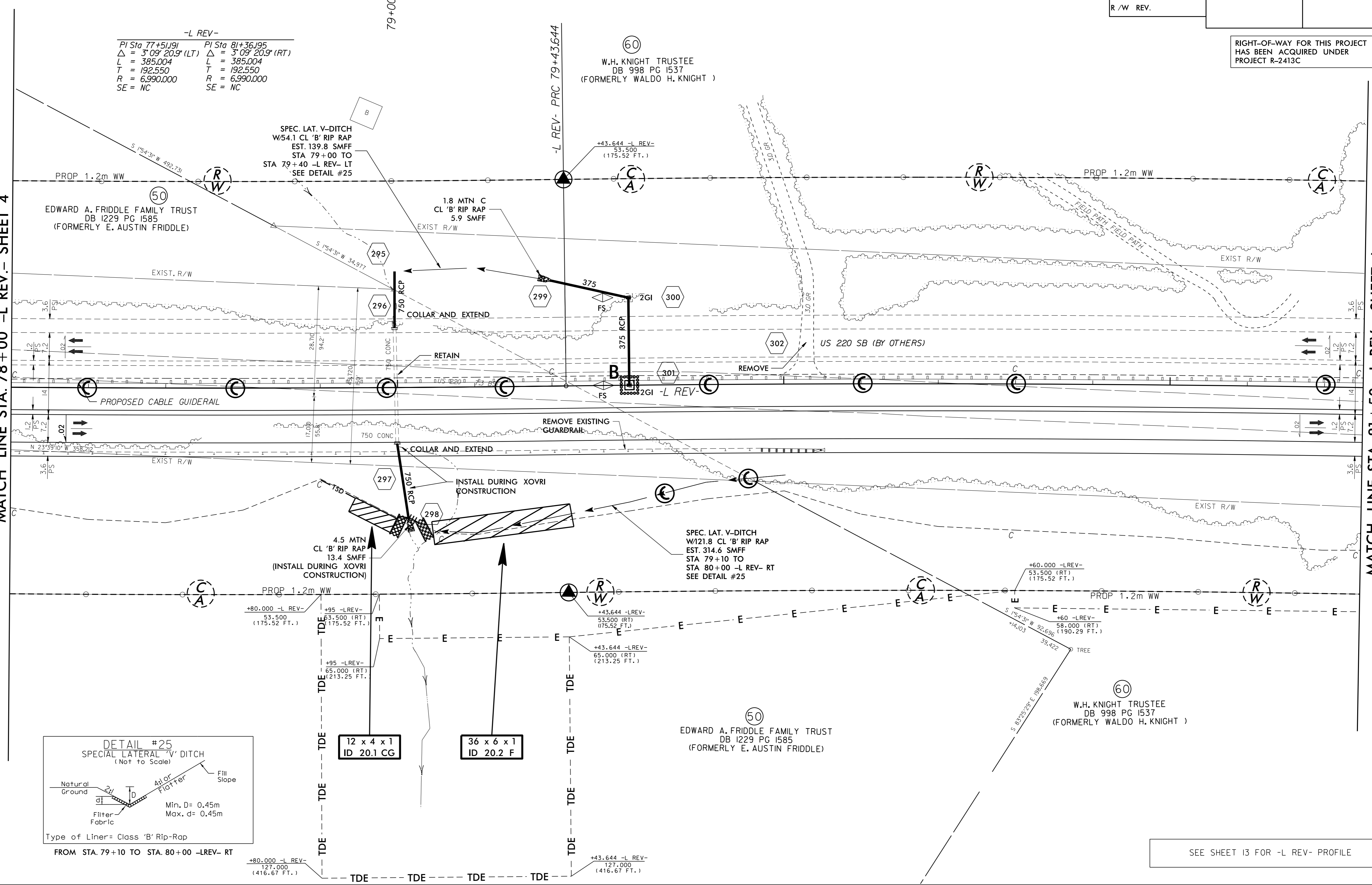

RIGHT-OF-WAY FOR THIS PROJECT HAS BEEN ACQUIRED UNDER PROJECT R-2413C

SEE SHEET 13 FOR -L REV- PROFILE

06-FEB-2015 15:42:10 \\s01\proj\2413CA-EC-01\05.dgn