

06\_FEB-2015 14:22 D:\p\04\24130A\_EC.p\04.dgn

PROJECT REFERENCE NO. R-2413CA	SHEET NO. EC-13/CONST.4
R/W SHEET NO.	
ROADWAY DESIGN ENGINEER	HYDRAULICS ENGINEER
CONST. REV.	
R/W REV.	

Erosion Control devices on this sheet have been installed on R-2413C and are shown for reference only

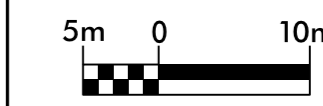

RIGHT-OF-WAY FOR THIS PROJECT HAS BEEN ACQUIRED UNDER PROJECT R-2413C

**(50)**  
 EDWARD A. FRIDDLE FAMILY TRUST  
 DB 1229 PG 1585  
 (FORMERLY E. AUSTIN FRIDDLE)  
**BEGIN CONSTRUCTION (NB LANES)**  
**POC 76+00.00 -L REV-**

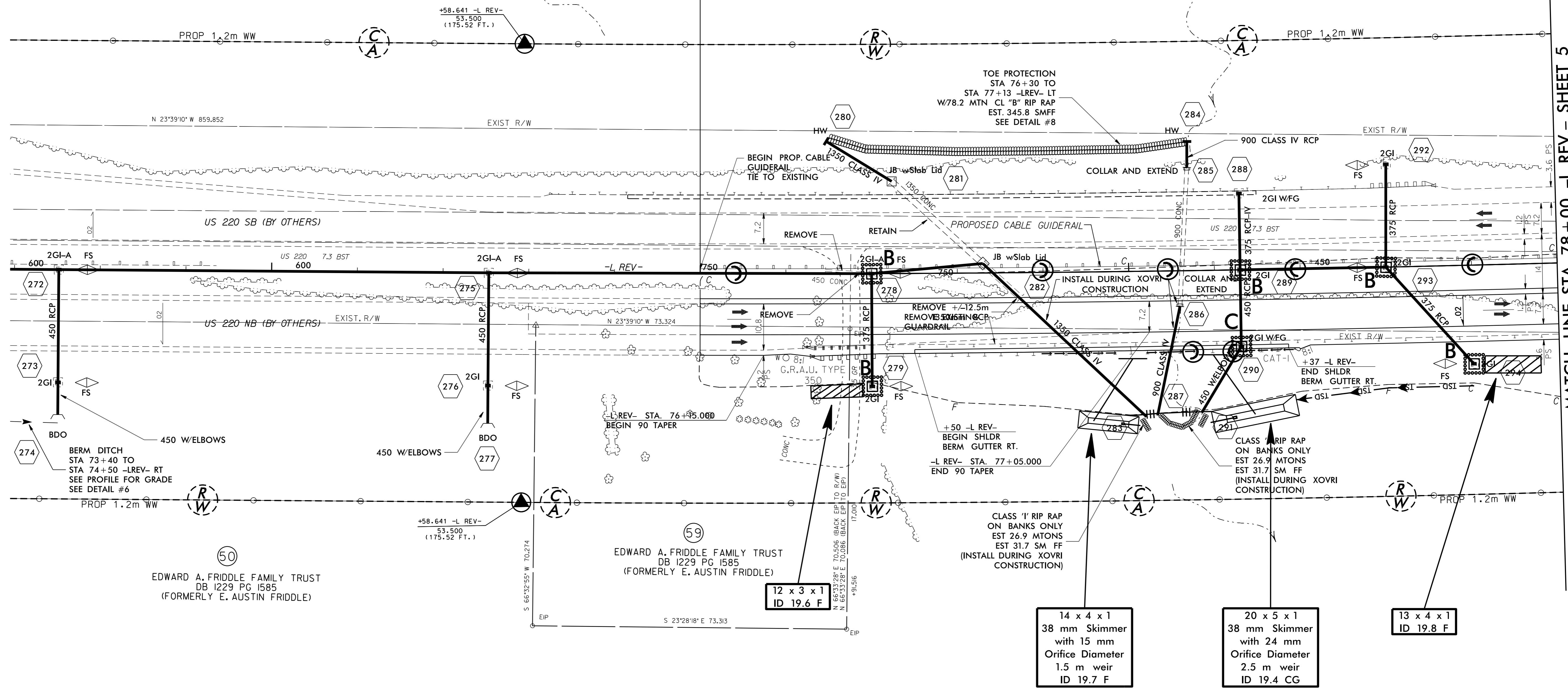

MATCH LINE STA. 78+00 -L REV.- SHEET 5

**(50)**  
 EDWARD A. FRIDDLE FAMILY TRUST  
 DB 1229 PG 1585  
 (FORMERLY E. AUSTIN FRIDDLE)

-L REV-  
 PI Sta 77+51.91  
 $\Delta = 3^{\circ} 09' 20.9" (LT)$   
 L = 385.004  
 T = 192.550  
 R = 6,990.000  
 SE = NC

SEE SHEET 13 FOR -L REV- PROFILE