

4/7/2015 10:04:00 AM R:\REVISED\PROJECTS\R-2413CA-r-dj-pph06.dgn

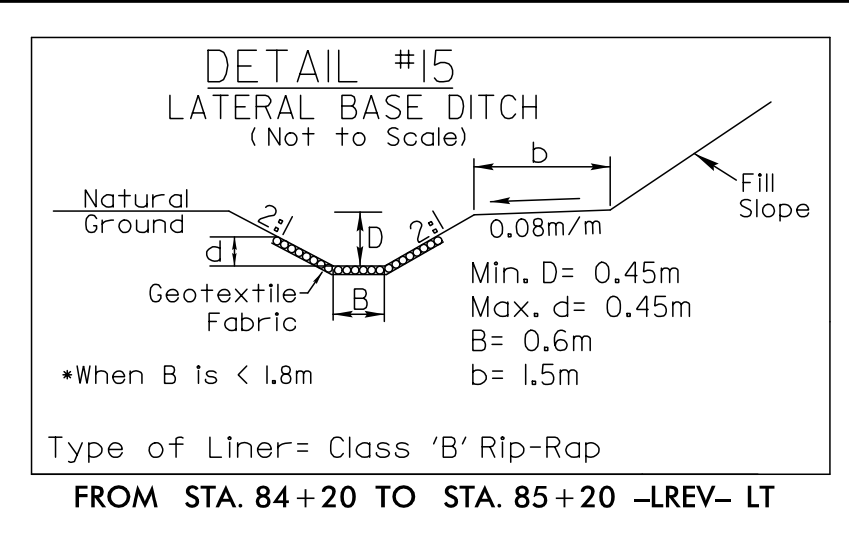
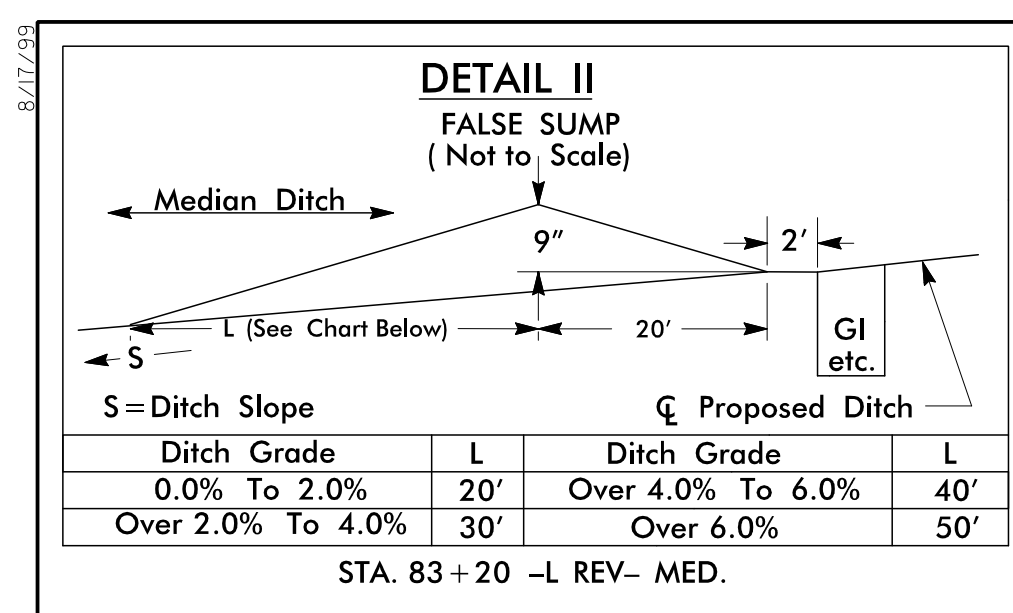

ICA Engineering

5121 Kingdom Way,
Suite 100
Raleigh, NC 27607
NC License No: P-0268

WILLIAM E. NEAL
DB 730 PG 382
6.563 Ha
DMD

METRIC

5m 0 10m

PROJECT REFERENCE NO. R-2413CA SHEET NO. 6

R/W SHEET NO.

ROADWAY DESIGN ENGINEER
SEAL 22606
DAVID C. WALKER
4/8/2015

HYDRAULICS ENGINEER
SEAL 19732
TIMOTHY M. DAVIS
4/8/2015

CONST. REV.
R/W REV.

**END T.I.P. PROJECT R-2413C
BEGIN T.I.P. PROJECT R-2413CA
POT 84 + 00.000 -LREV-
BEGIN CONSTRUCTION (SB LANES)**

MATCH LINE STA 81 + 50 -L REV- SHEET 5

MATCH LINE STA 85 + 00 -L REV- SHEET 7

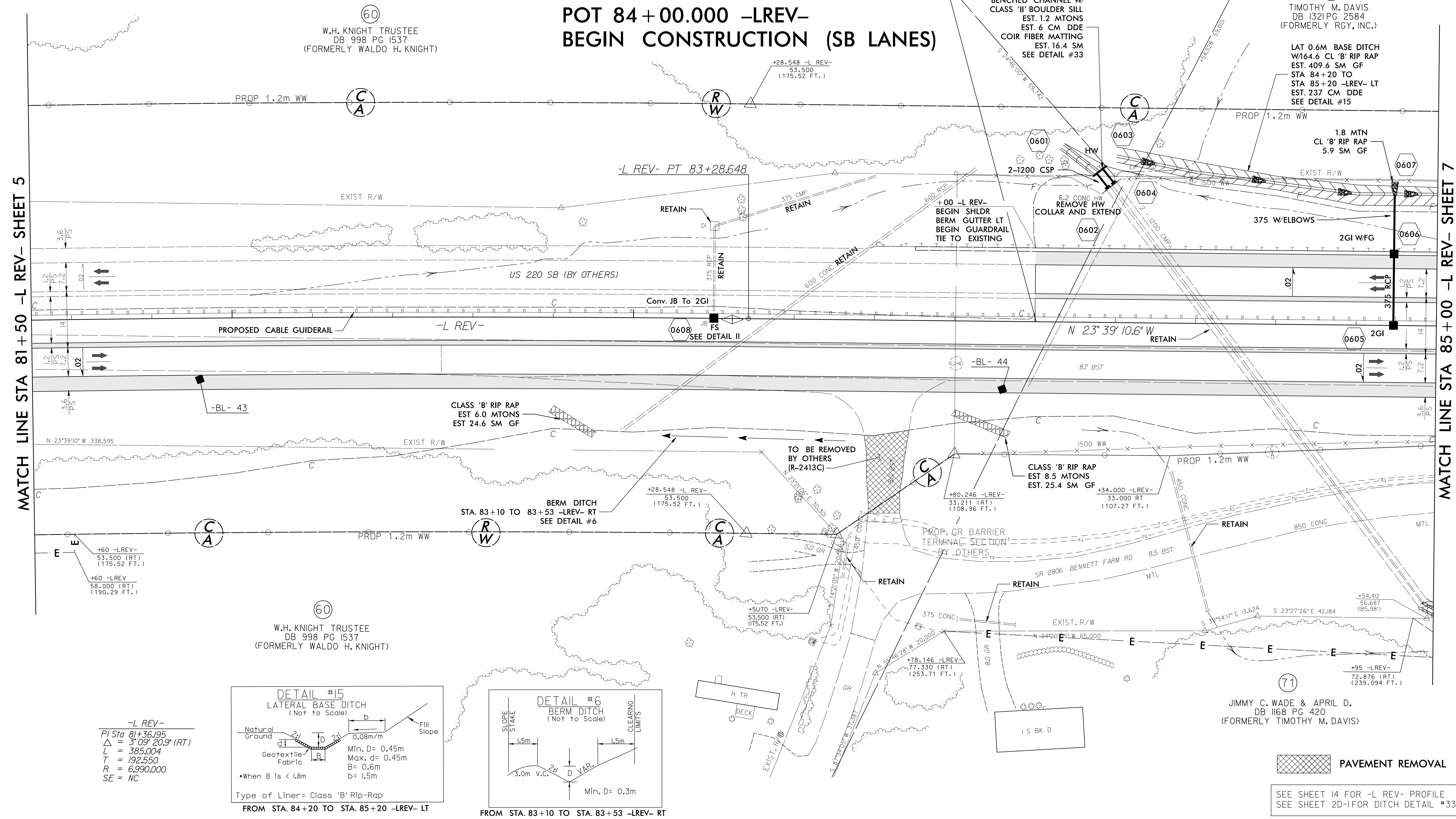

-L REV-

PI Sta 81+36.195
Δ = 3° 09' 20.9" (RT)
L = 385.004
T = 192.550
R = 6,990.000
SE = NC

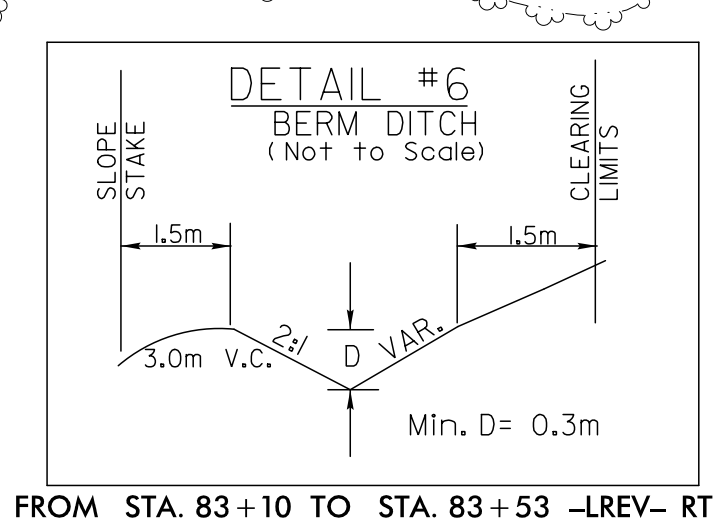
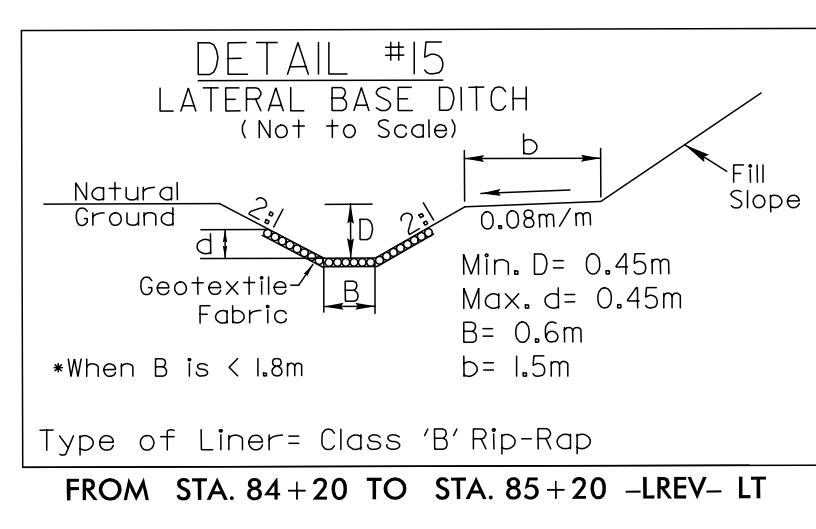

PAVEMENT REMOVAL

SEE SHEET 14 FOR -L REV- PROFILE
SEE SHEET 2D-1 FOR DITCH DETAIL #33