

PROJECT REFERENCE NO. R-2413CA	SHEET NO. 2B-2
R / W SHEET NO.	
ROADWAY DESIGN ENGINEER DAVID C. WALLS SEAL 19732 4/8/2015	HYDRAULICS ENGINEER DAVID C. WALLS SEAL 19732 4/8/2015
CONST. REV.	
R/W REV.	

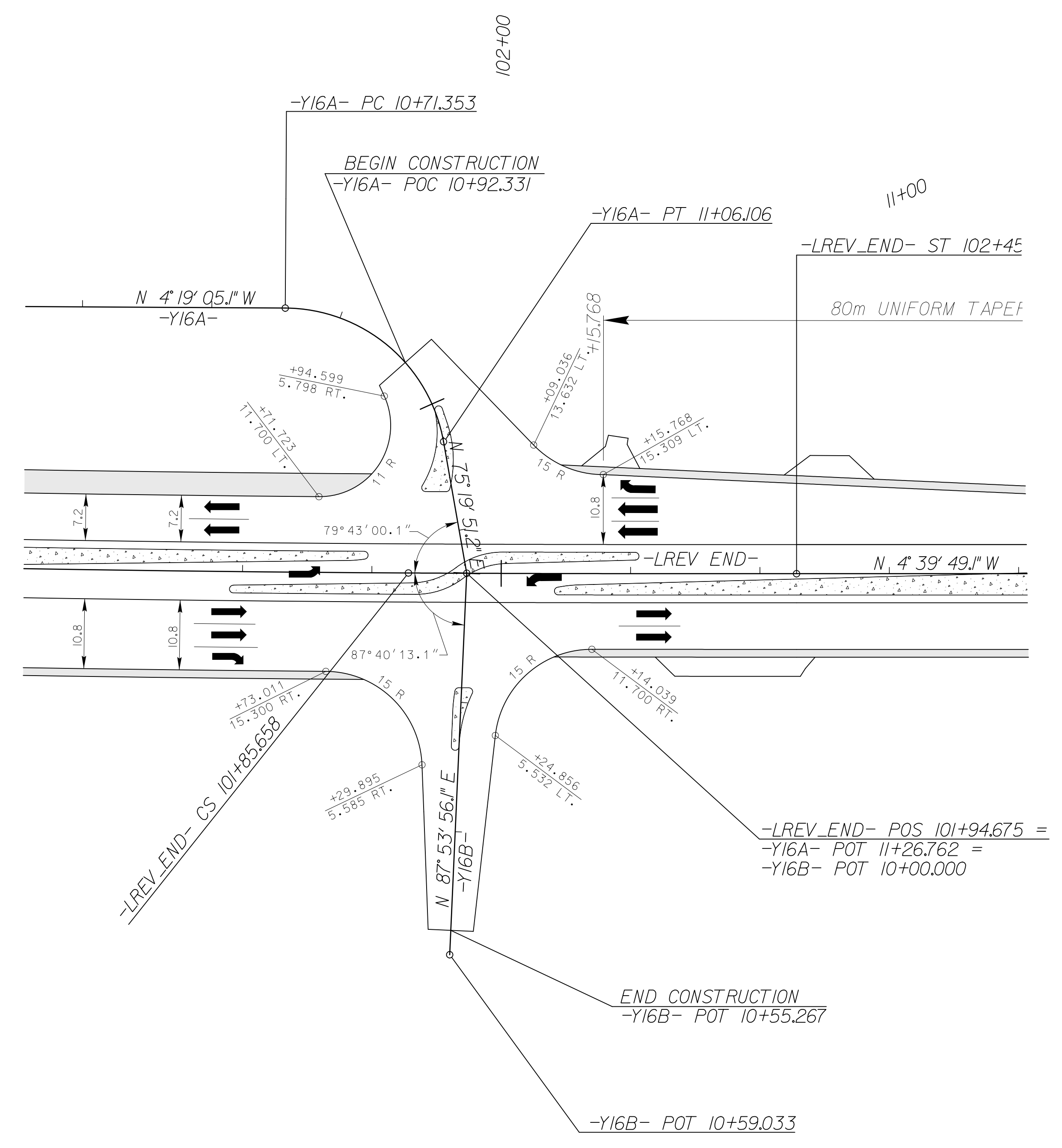
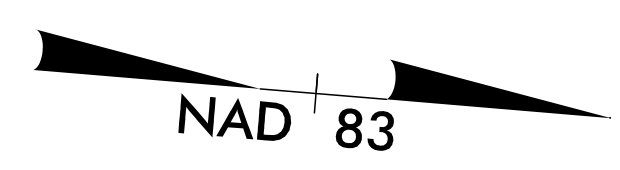

INTERSECTION DETAIL
 US 220 & Y16A/Y16B
 SCALE = 1:500

LEGEND

	125mm MONOLITHIC CONCRETE ISLAND (KEYED IN)
--	---

SEE SHEET II FOR FULL PLAN VIEW

INTERSECTION DETAIL

4/7/2015
 C:\Users\pwall\OneDrive\Documents\Projects\2413CA_rdy_det_Intersection_2B-2.dgn
 ICA ENGINEERING, INC.