

UTILITIES BY OTHERS

NOTE:
 ALL PROPOSED UTILITY WORK SHOWN ON THIS SHEET WILL BE DONE BY OTHERS. NO PAYMENT WILL BE MADE TO THE CONTRACTOR FOR PROPOSED UTILITY WORK SHOWN ON THIS SHEET.

-Y2-	
PI Sta 15+72.16 Δ = 1°24'47.7"(RT) D = 0°57'15.5" L = 148.09' T = 74.05' R = 6,004.00'	PI Sta 18+26.00 Δ = 12°43'28.9"(RT) D = 4°07'08.5" L = 308.92' T = 155.10' R = 1,391.00'

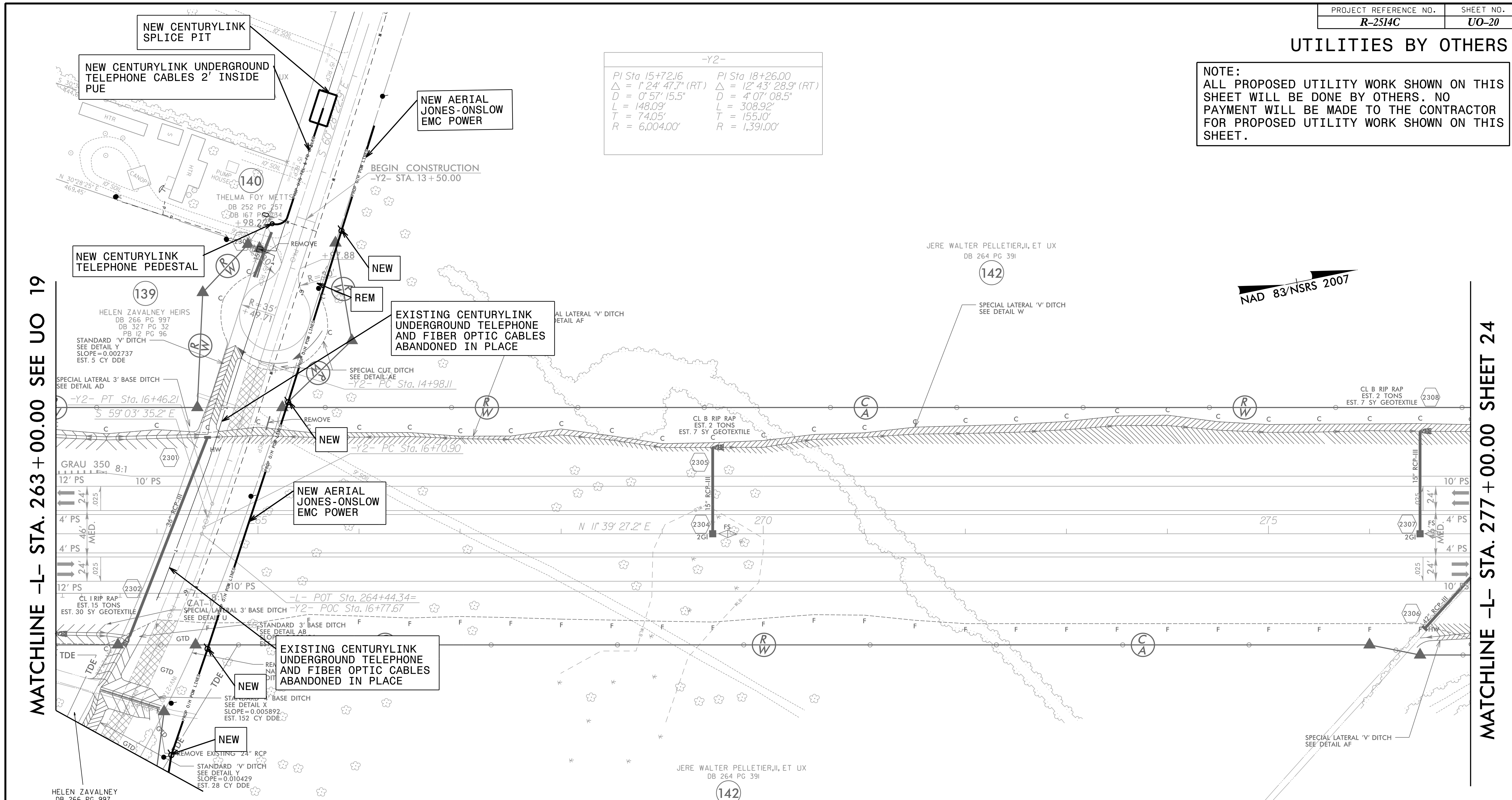

MATCHLINE -L- STA. 263 + 00.00 SEE UO 19

MATCHLINE -L- STA. 277 + 00.00 SHEET 24

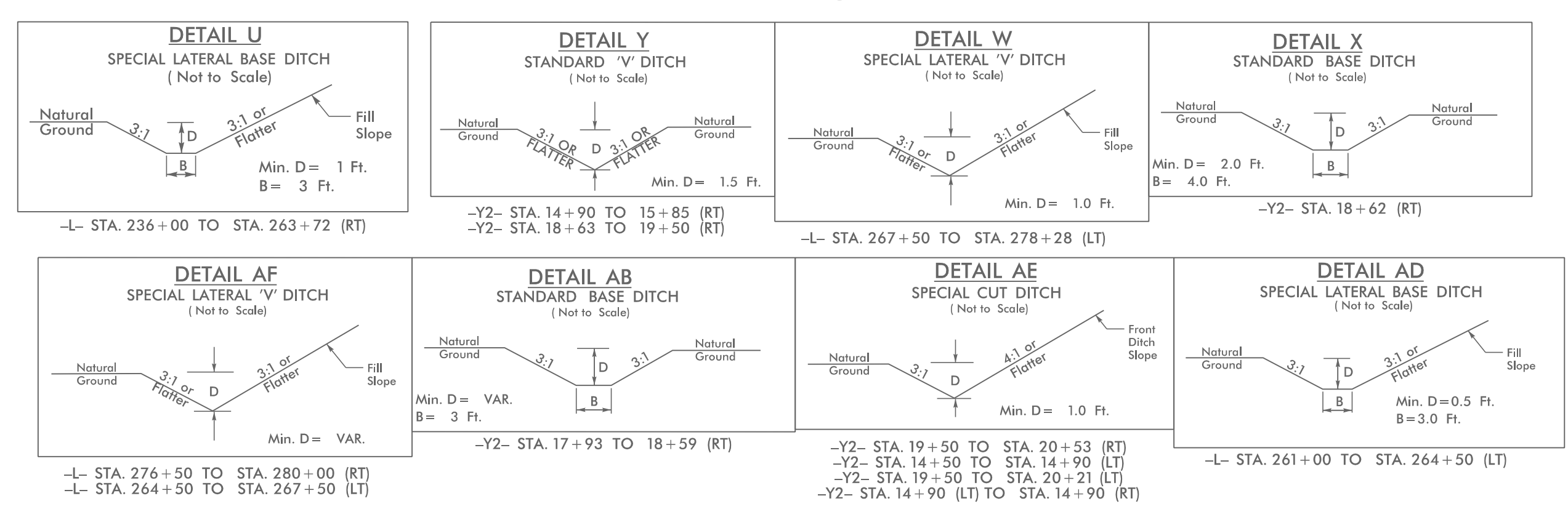

NOTES:
 1. ALL CENTURYLINK UNDERGROUND TELEPHONE AND FIBER OPTIC IS TO BE ABANDONED IN PLACE. ALL PEDESTALS AND OTHER HARDWARE TO BE REMOVED. ALL CENTURYLINK RELOCATIONS ARE 2' INSIDE RW AND/OR PUE UNLESS OTHERWISE NOTED. ALL BORES TO BE 15' UNDER WETLANDS AS WELL AS UNDER -L- LINE, AND PERPENDICULAR TO -L- LINE. BURIED CABLES AND BORES TO CLEAR UNDERCUT AREAS AND DITCH'S BY A MINIMUM OF 3'

UTILITY OWNERS ON THIS SHEET

JONES-ONSLow EMC - POWER
 CENTURYLINK - TELEPHONE/FIBER OPTIC

PLANS PREPARED BY :
RK&K
 RUMMEL, KLEPPER & KAHL, LLP
 900 RIDGEFIELD DRIVE SUITE 350
 RALEIGH, NORTH CAROLINA 27609-3960
 NC LICENSE NO. F-0112 • (919) 878-9560