

UTILITIES BY OTHERS

NOTE:
ALL PROPOSED UTILITY WORK SHOWN ON THIS SHEET WILL BE DONE BY OTHERS. NO PAYMENT WILL BE MADE TO THE CONTRACTOR FOR PROPOSED UTILITY WORK SHOWN ON THIS SHEET.

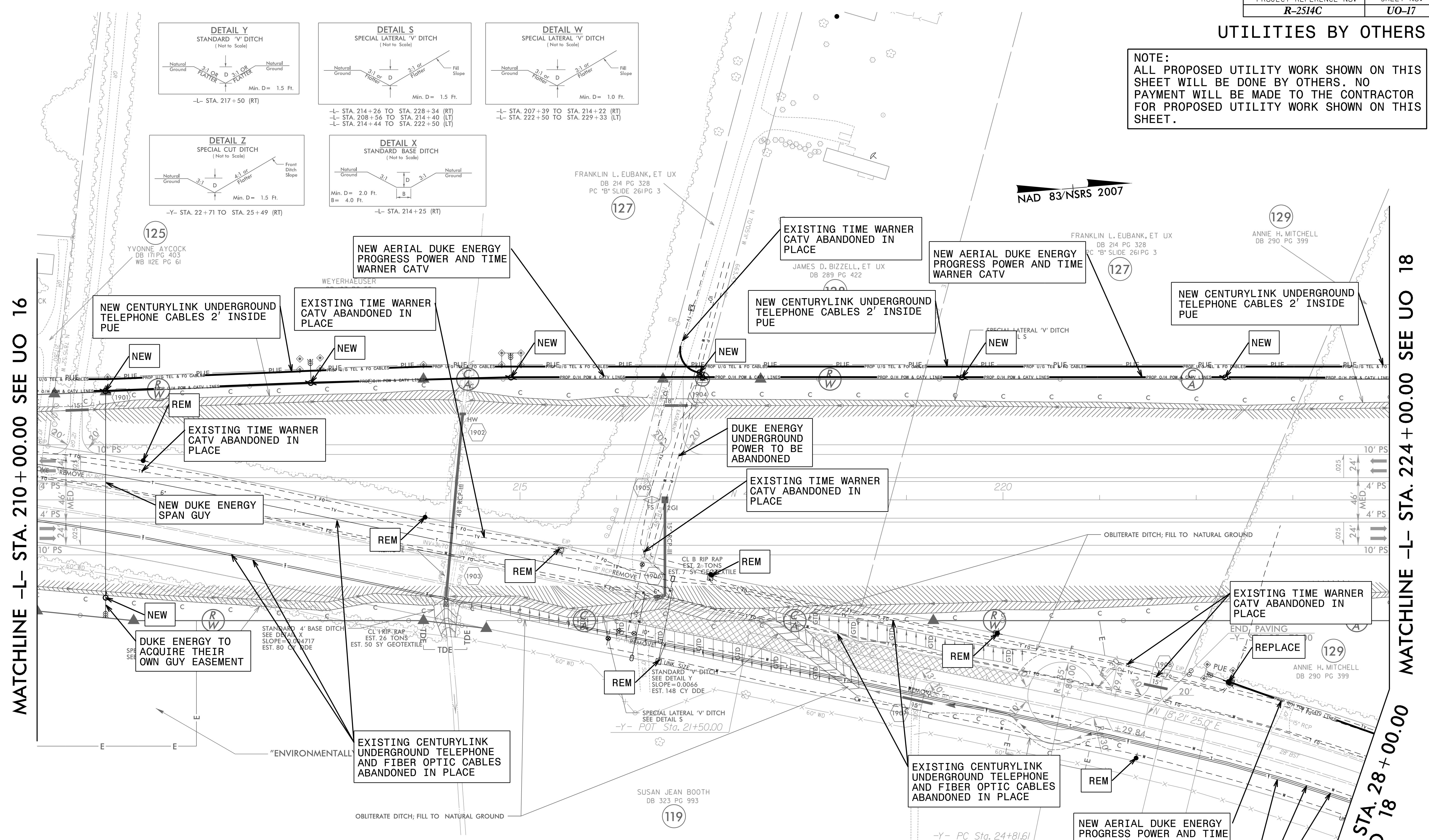

MATCHLINE -L- STA. 210 + 00.00 SEE UO 16

MATCHLINE -L- STA. 224 + 00.00 SEE UO 18

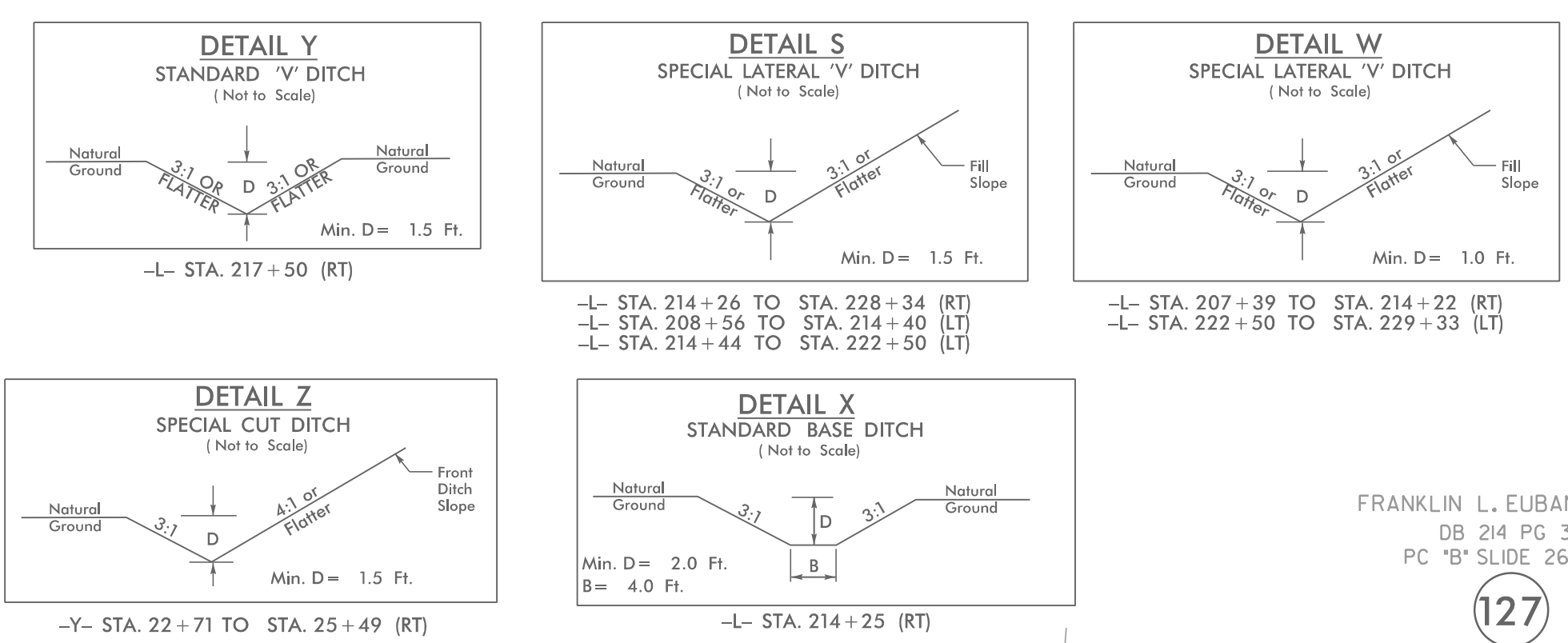

NAD 83/NSRS 2007

- NOTES:
1. ALL CENTURYLINK UNDERGROUND TELEPHONE AND FIBER OPTIC IS TO BE ABANDONED IN PLACE. ALL PEDESTALS AND OTHER HARDWARE TO BE REMOVED. ALL CENTURYLINK RELOCATIONS ARE 2' INSIDE R/W AND/OR PUE UNLESS OTHERWISE NOTED. ALL BORES TO BE 15' UNDER WETLANDS AS WELL AS UNDER -L- LINE AND PERPENDICULAR TO -L- LINE. BURIED CABLES AND BORES TO CLEAR UNDERCUT AREAS AND DITCH'S BY A MINIMUM OF 3'
 2. ALL TIME WARNER CATV IS TO BE ABANDONED IN PLACE. ALL PEDESTALS AND OTHER HARDWARE TO BE REMOVED.

PLANS PREPARED BY : **RK&K**
RUMMEL, KLEPPER & KAHL, LLP
900 RIDGEFIELD DRIVE SUITE 350
RALEIGH, NORTH CAROLINA 27609-3960
NC LICENSE NO. F-0112 • (919) 878-9560

UTILITY OWNERS ON THIS SHEET

DUKE PROGRESS ENERGY - POWER
TIME WARNER - CATV
CENTURYLINK - TELEPHONE AND FIBER OPTIC

MATCHLINE -Y- STA. 28 + 00.00 SEE UO 18