

NOTE:
 ALL PROPOSED UTILITY WORK SHOWN ON THIS SHEET WILL BE DONE BY OTHERS. NO PAYMENT WILL BE MADE TO THE CONTRACTOR FOR PROPOSED UTILITY WORK SHOWN ON THIS SHEET.

NOTES:

1. ALL CENTURYLINK UNDERGROUND TELEPHONE AND FIBER OPTIC IS TO BE ABANDONED IN PLACE. ALL PEDESTALS AND OTHER HARDWARE TO BE REMOVED. ALL CENTURYLINK RELOCATIONS ARE 2' INSIDE RW AND/OR PUE UNLESS OTHERWISE NOTED. ALL BORES TO BE 15' UNDER WETLANDS AS WELL AS UNDER -L- LINE AND PERPENDICULAR TO -L- LINE. BURIED CABLES AND BORES TO CLEAR UNDERCUT AREAS AND DITCH'S BY A MINIMUM OF 3'
2. ALL TIME WARNER CATV IS TO BE ABANDONED IN PLACE. ALL PEDESTALS AND OTHER HARDWARE TO BE REMOVED.

-L-		
Pls Sta 92+25.52	Pls Sta 95+60.26	Pls Sta 98+92.91
$\theta_s = 2' 19' 44.7"$	$\Delta = 12' 26' 19.1" (LT)$	$\theta_s = 2' 19' 44.7"$
$L_s = 200.00'$	$D = 2' 19' 44.7"$	$L_s = 200.00'$
$LT = 133.34'$	$L = 534.05'$	$LT = 133.34'$
$ST = 66.68'$	$T = 268.08'$	$ST = 66.68'$
	$R = 2,460.00'$	
	$SE = .05$	
	$RO = 200'$	

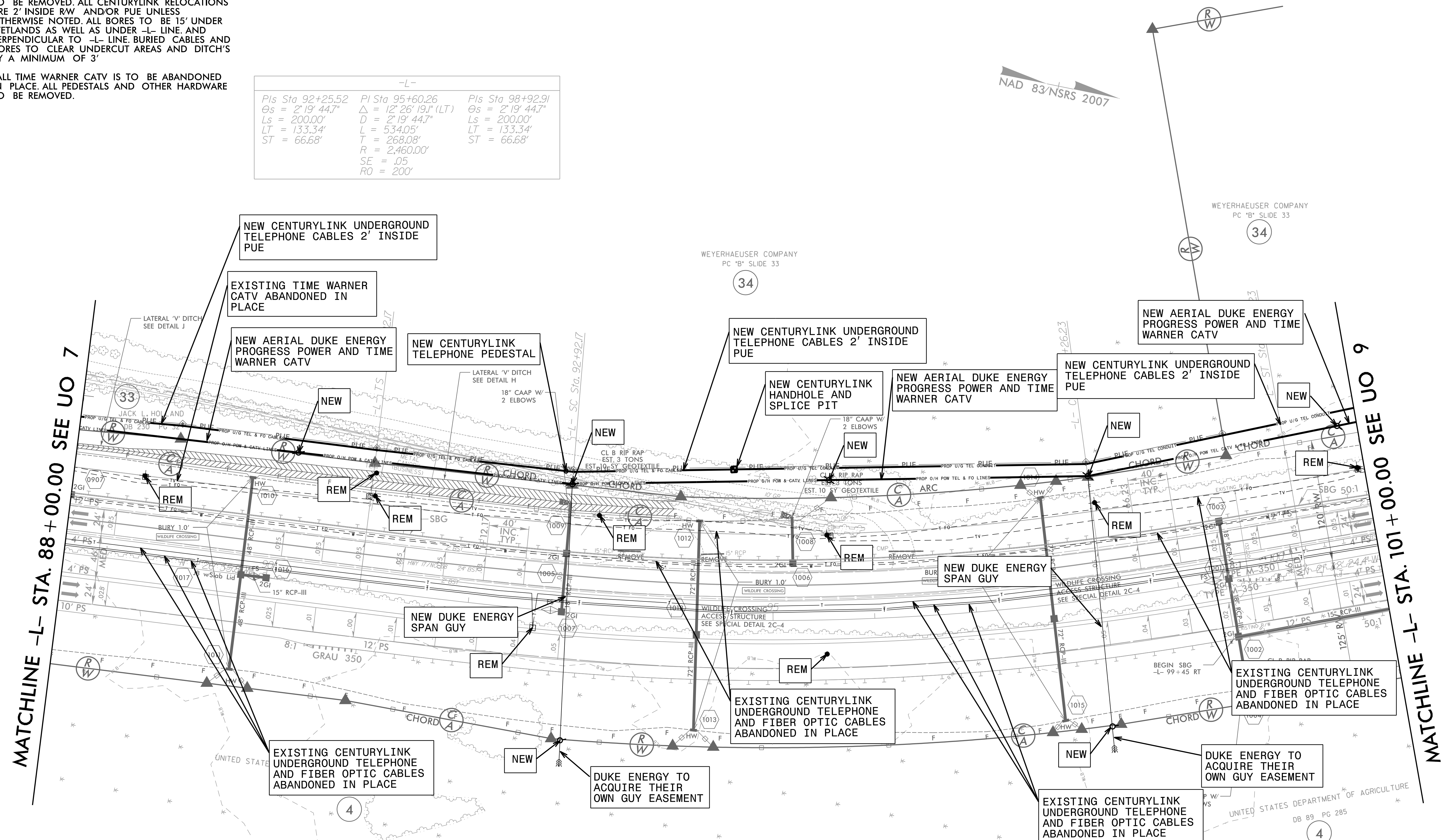

MATCHLINE -L- STA. 88 + 00.00 SEE UO 7

MATCHLINE -L- STA. 101 + 00.00 SEE UO 9

NAD 83/NSRS 2007

WEYERHAEUSER COMPANY
 PC "B" SLIDE 33

WEYERHAEUSER COMPANY
 PC "B" SLIDE 33

UNITED STATES DEPARTMENT OF AGRICULTURE
 DB 89 PG 285