

NAD 83/NSRS 2007

MATCHLINE -L- STA. 154 + 00.00 SEE SHEET 14

MATCHLINE -L- STA. 168 + 00.00 SEE SHEET 16

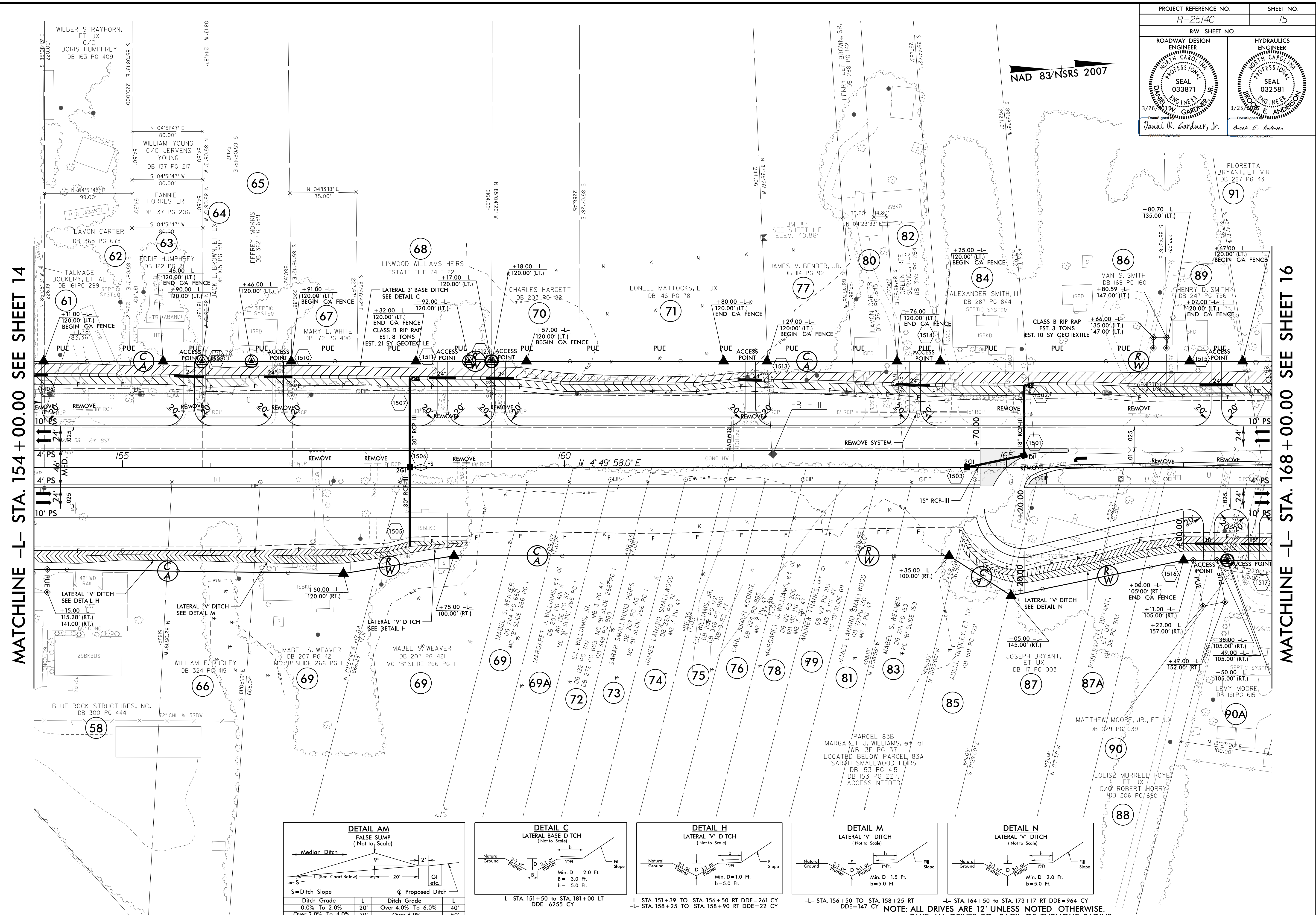

REVISIONS

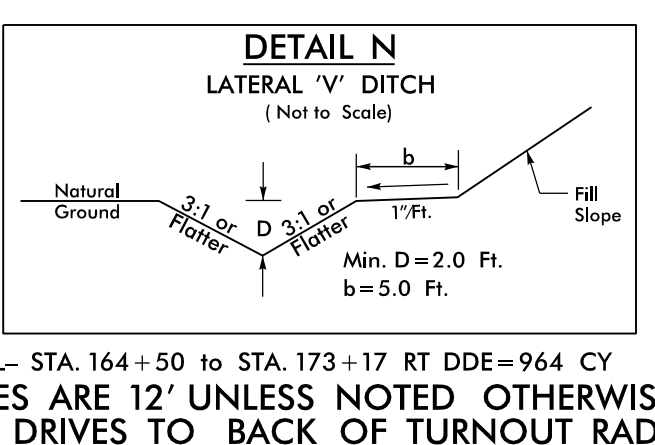
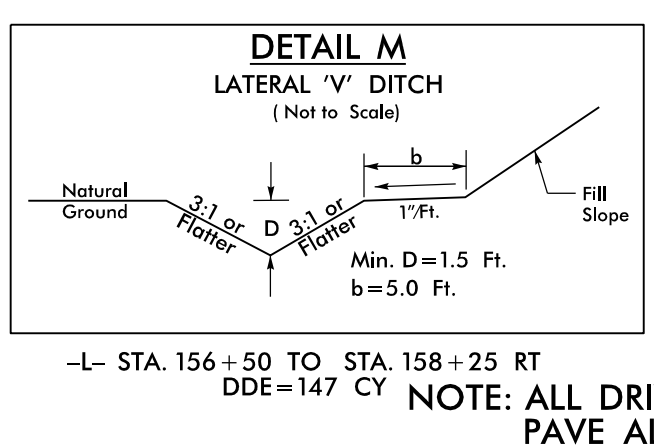
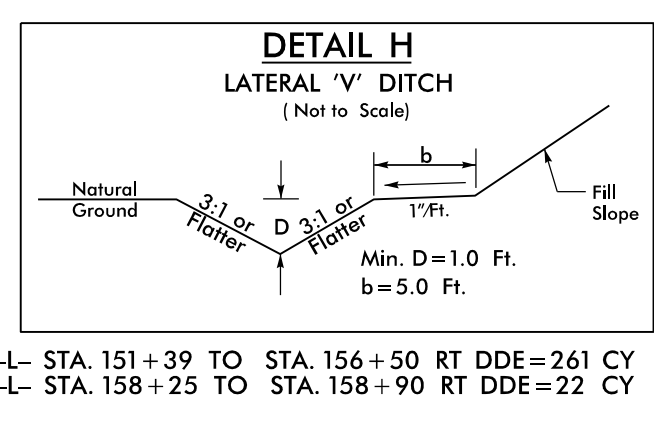
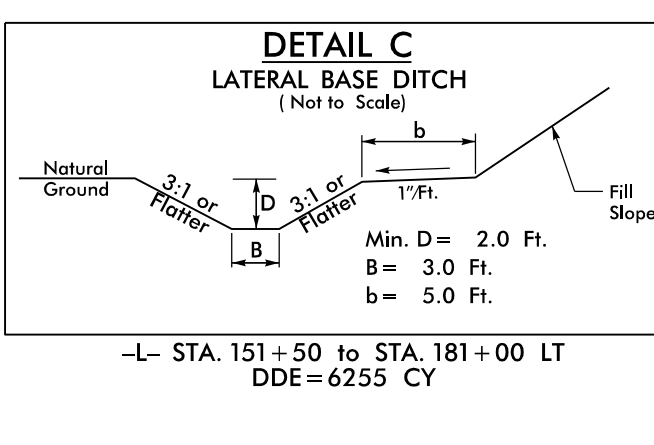
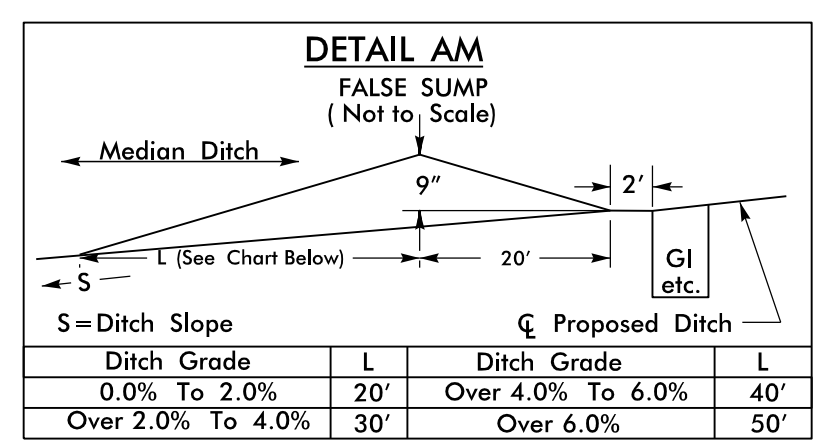

NOTE: ALL DRIVES ARE 12' UNLESS NOTED OTHERWISE.
PAVE ALL DRIVES TO BACK OF TURNOUT RADIUS.
SEE SHEET 2A-5 FOR DRIVEWAY PROFILE DETAILS.

SEE SHEET 34 FOR -L- PROFILE

8/17/09
 F:\2514C\Roadway\2514C_Roadway\Proj\NR2514C_Roadway\15.dgn
 3/23/2015 10:22:01 AM