

**This electronic collection of documents is provided  
for the convenience of the user  
and is Not a Certified Document –**

**The documents contained herein were originally issued  
and sealed by the individuals whose names and license  
numbers appear on each page, on the dates appearing  
with their signature on that page.**

**This file or an individual page  
shall not be considered a certified document.**

**TIP PROJECT: R-2514B**

STATE OF NORTH CAROLINA  
DIVISION OF HIGHWAYS

T.I.P. NO.	SHEET NO.
R-2514B	UO-1

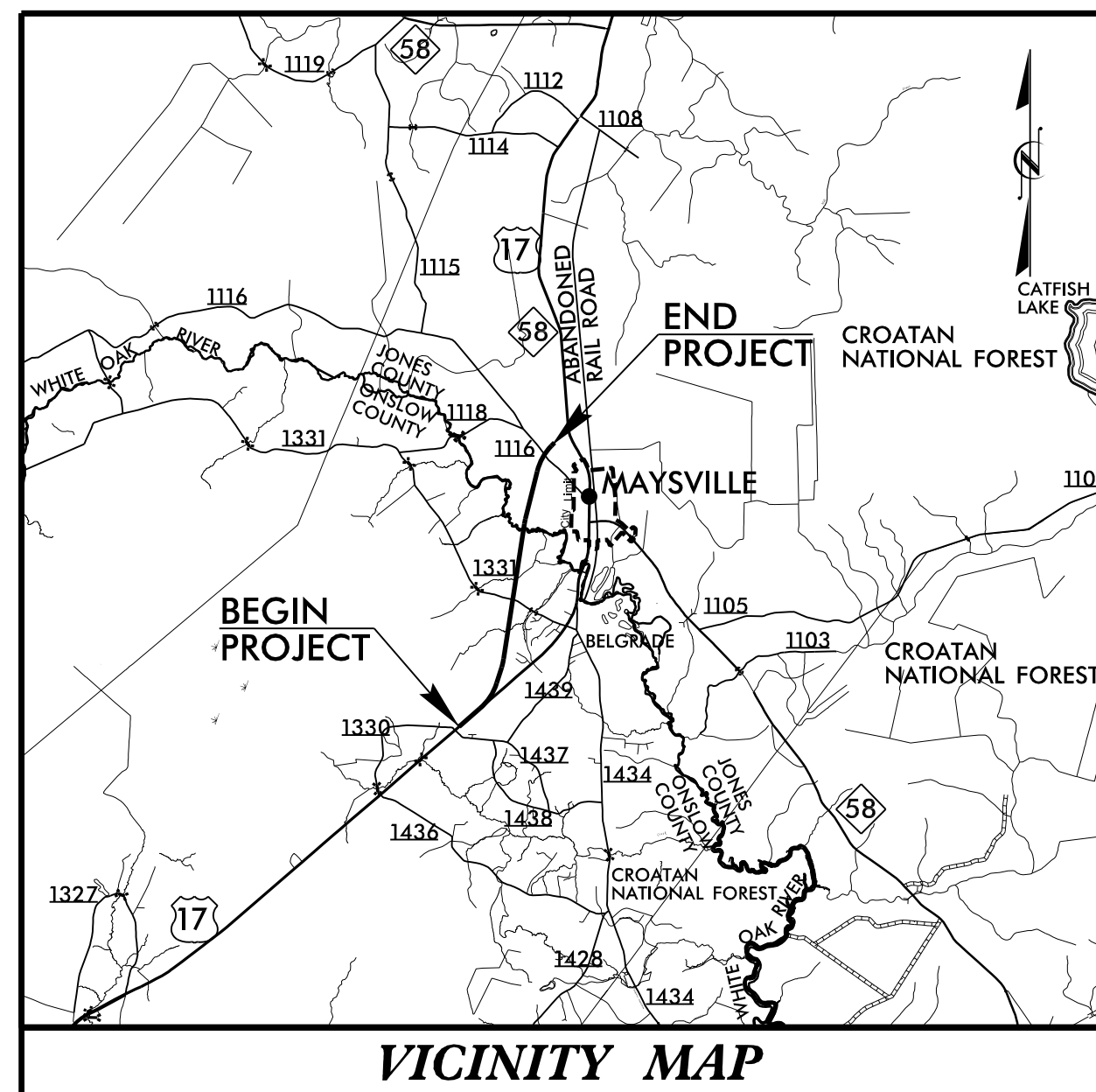
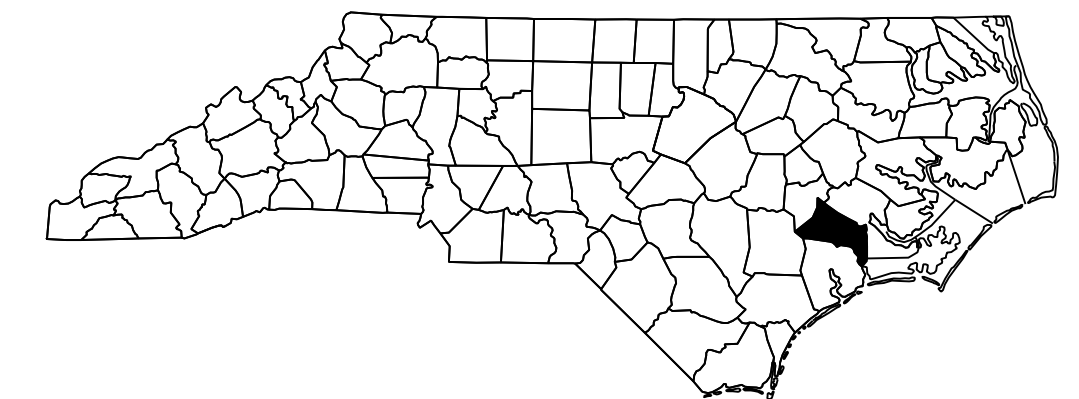

**UTILITIES BY OTHERS PLANS  
ON SLOW & JONES  
COUNTY**

**LOCATION: US 17 FROM SOUTH OF BELGRADE AT  
SR 1330/SR 1439 TO NORTH OF MAYSVILLE**

**TYPE OF WORK: AERIAL POWER, UNDERGROUND FIBER OPTIC,  
TELEPHONE, CATV**

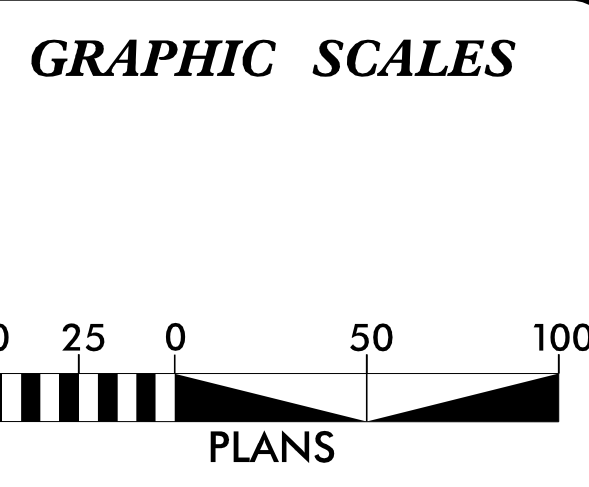
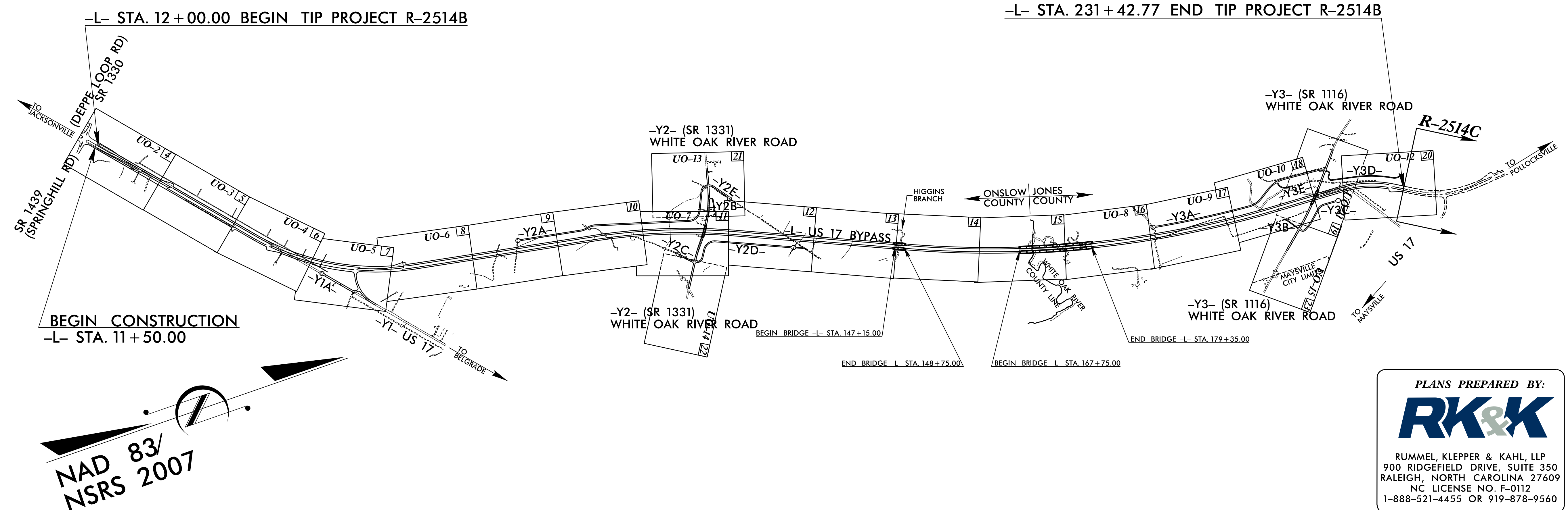

INDEX OF SHEETS

SHEET NO.	DESCRIPTION
UO-1	TITLE SHEET
UO-2 THRU UO-15	UTILITY BY OTHERS PLAN SHEETS

- UTILITY OWNERS ON PROJECT
- DUKE ENERGY PROGRESS - POWER
  - JONES - ONSLOW EMC - POWER
  - CENTURYLINK - TELEPHONE AND FIBER OPTIC
  - TIME WARNER - CATV

PREPARED IN THE OFFICE OF:  
DIVISION OF HIGHWAYS  
UTILITIES UNIT  
UTILITIES ENGINEERING

1591 MAIL SERVICES CENTER  
RALEIGH, NC 27699-1591  
PHONE (919) 707-6690  
FAX (919) 250-4151

Roger Worthington, P.E. UTILITIES SECTION ENGINEER  
Roger Worthington, P.E. UTILITIES SQUAD LEADER PROJECT ENGINEER  
Kifah Kamil UTILITIES PROJECT DESIGNER



**UTILITIES BY OTHERS**

**NOTE:**  
 ALL PROPOSED UTILITY WORK SHOWN ON THIS SHEET WILL BE DONE BY OTHERS. NO PAYMENT WILL BE MADE TO THE CONTRACTOR FOR PROPOSED UTILITY WORK SHOWN ON THIS SHEET.

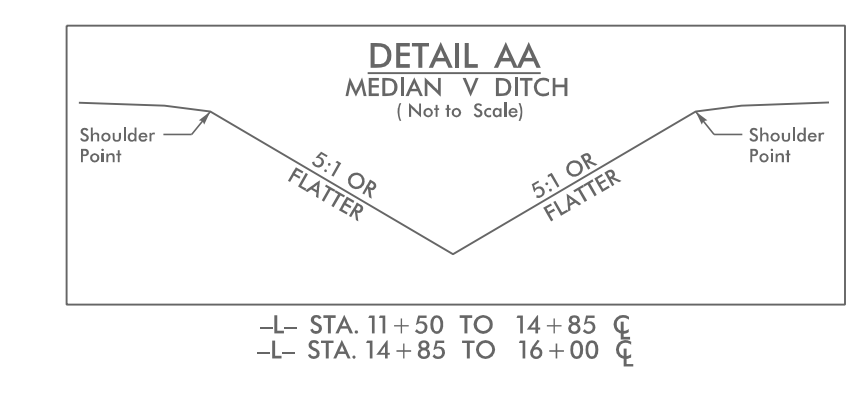
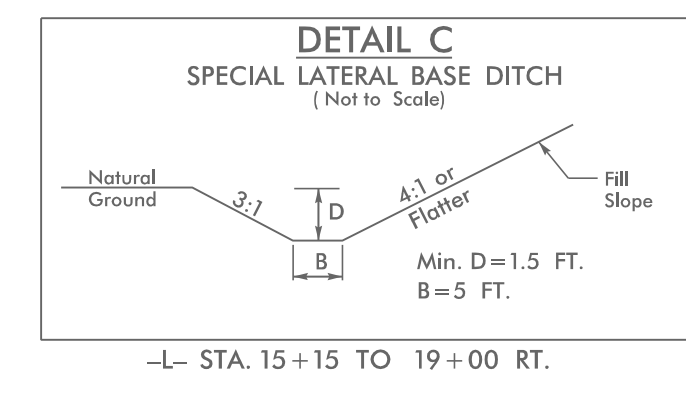
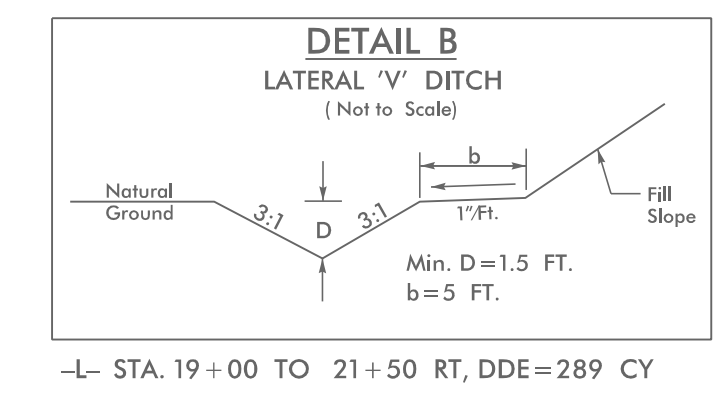
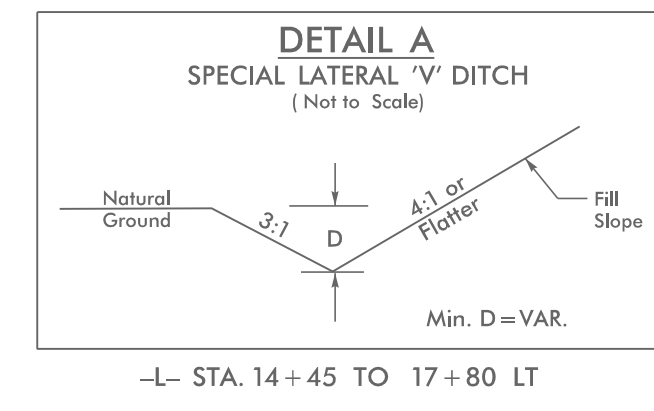

NAD 83/NRS 2007

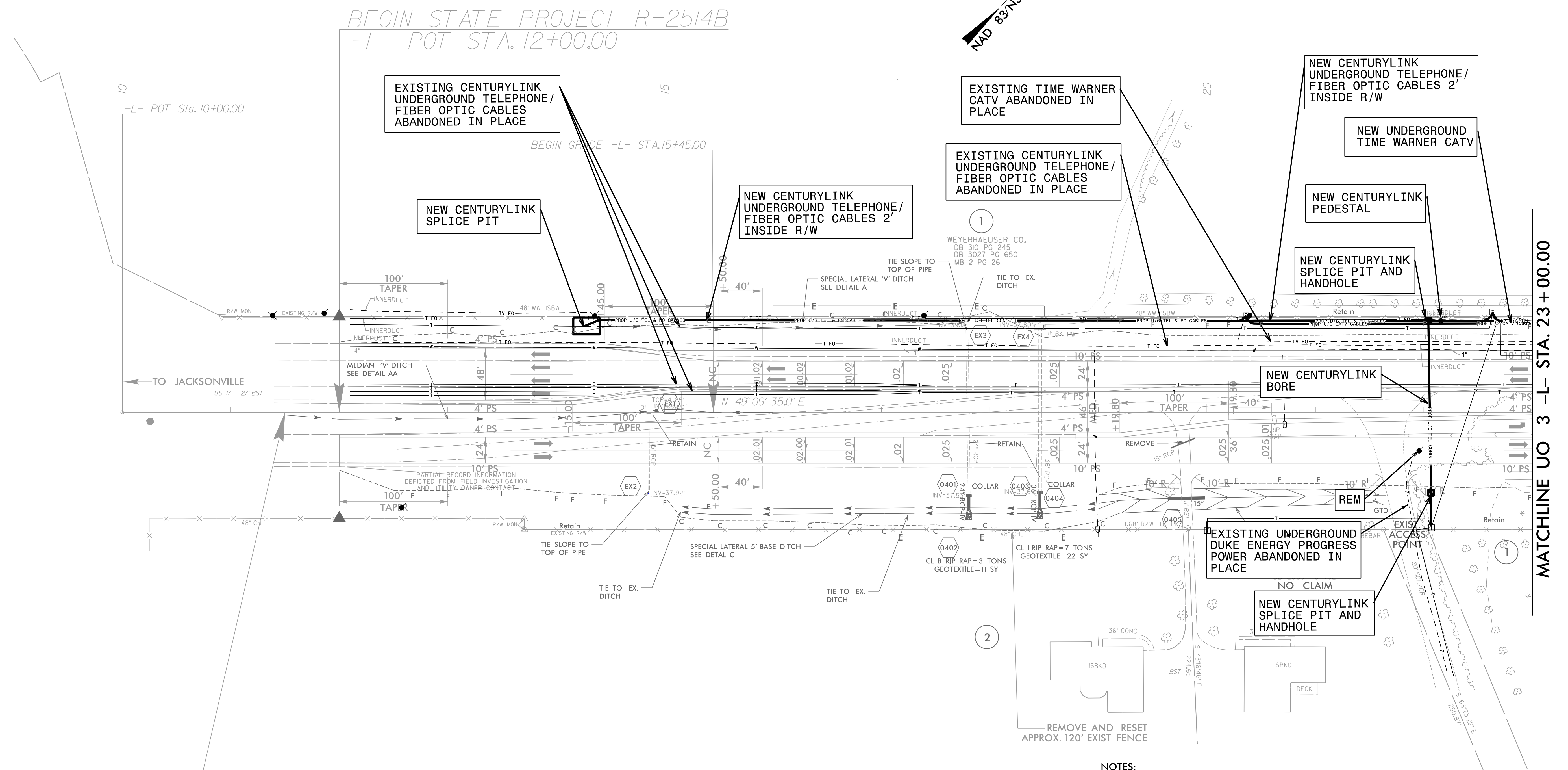

- NOTES:**
- DUKE ENERGY PROGRESS WILL STAY ON EXISTING POLE LINE
  - ALL CENTURYLINK UNDERGROUND TELEPHONE AND FIBER OPTIC IS TO BE ABANDONED IN PLACE
  - TIME WARNER CABLE ABANDONED IN PLACE UNDERGROUND FACILITIES AS NOTED

<b>UTILITY OWNERS ON THIS SHEET</b>	<b>PLANS PREPARED BY :</b>
DUKE ENERGY PROGRESS - POWER CENTURYLINK - TELEPHONE AND FIBER OPTIC TIME WARNER - CATV	 RUMMEL, KLEPPER & KAHL, LLP 900 RIDGEFIELD DRIVE SUITE 350 RALEIGH, NORTH CAROLINA 27609-3960 NC LICENSE NO. F-0112 • (919) 878-9560





UTILITIES BY OTHERS

NOTE:  
ALL PROPOSED UTILITY WORK SHOWN ON THIS SHEET WILL BE DONE BY OTHERS. NO PAYMENT WILL BE MADE TO THE CONTRACTOR FOR PROPOSED UTILITY WORK SHOWN ON THIS SHEET.

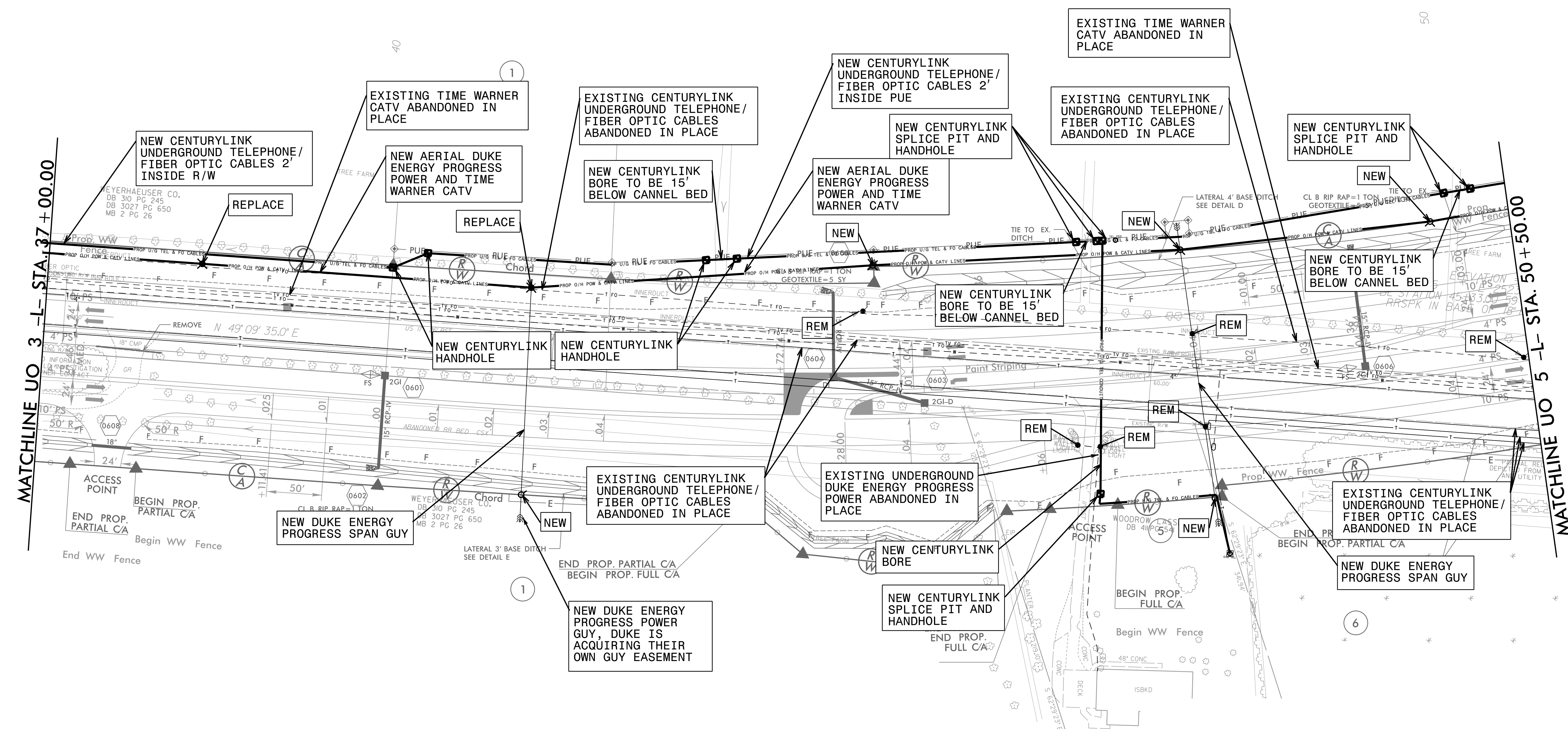
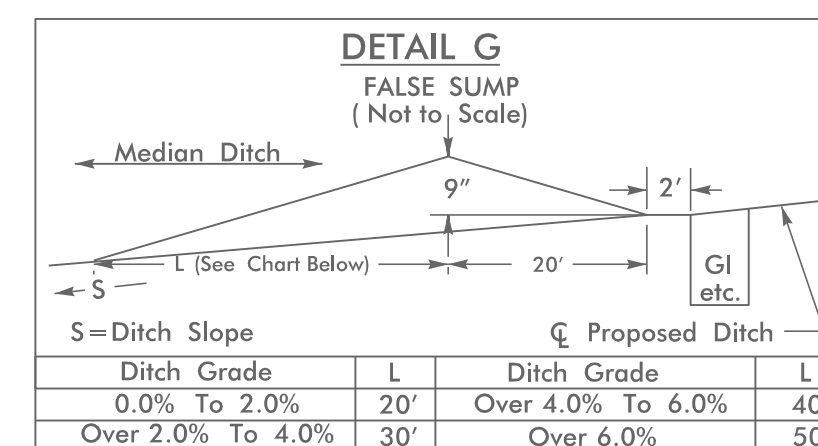
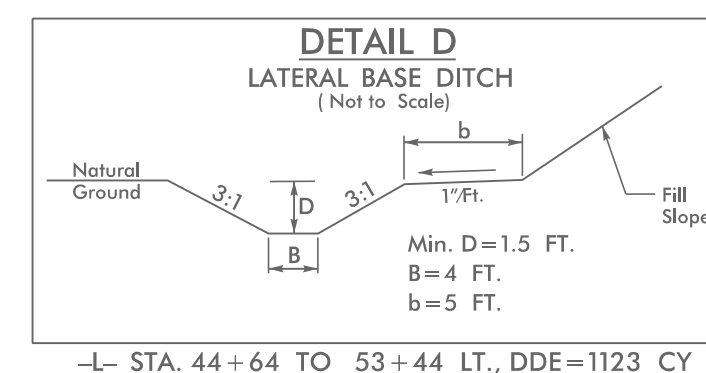
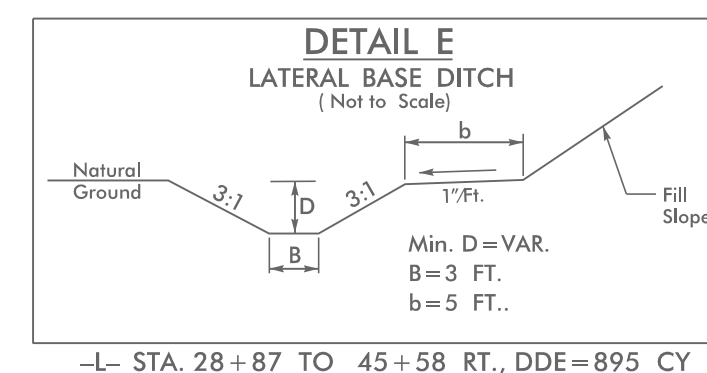

-L-  
 Pls Sta 41+44.75    PI Sta 55+14.14    Pls Sta 67+96.88  
 $\theta_s = 1' 25' 56.6"$      $\Delta = 36' 04' 44.8" (LT)$      $\theta_s = 1' 25' 56.6"$   
 $L_s = 200.00'$      $D = 1' 25' 56.6"$      $L_s = 200.00'$   
 $LT = 133.34'$      $L = 2,518.80'$      $LT = 133.34'$   
 $ST = 66.67'$      $T = 1,302.73'$      $ST = 66.67'$   
 $R = 4,000.00'$   
 $SE = 0.04$

- NOTES:
1. ALL CENTURYLINK UNDERGROUND TELEPHONE AND FIBER OPTIC IS TO BE ABANDONED IN PLACE
  2. TIME WARNER CABLE ABANDONED IN PLACE UNDERGROUND FACILITIES AS NOTED

**UTILITY OWNERS ON THIS SHEET**

DUKE ENERGY PROGRESS - POWER  
 CENTURYLINK - TELEPHONE AND FIBER OPTIC  
 TIME WARNER - CATV

**PLANS PREPARED BY :**  
  
 RUMMEL, KLEPPER & KAHL, LLP  
 900 RIDGEFIELD DRIVE SUITE 350  
 RALEIGH, NORTH CAROLINA 27609-3960  
 NC LICENSE NO. F-0112 • (919) 878-9560



UTILITIES BY OTHERS

NOTE:  
ALL PROPOSED UTILITY WORK SHOWN ON THIS SHEET WILL BE DONE BY OTHERS. NO PAYMENT WILL BE MADE TO THE CONTRACTOR FOR PROPOSED UTILITY WORK SHOWN ON THIS SHEET.

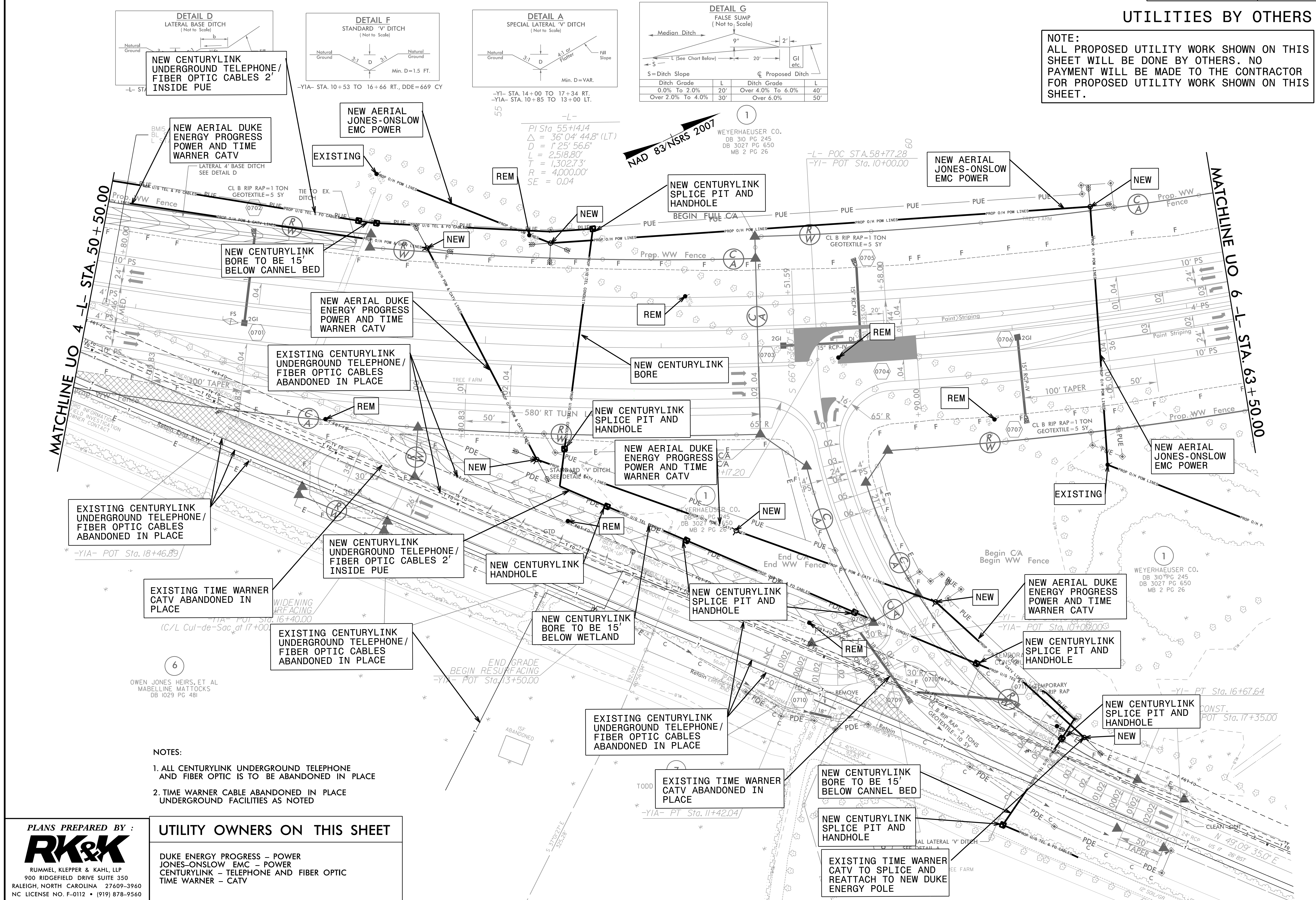

- NOTES:
- ALL CENTURYLINK UNDERGROUND TELEPHONE AND FIBER OPTIC IS TO BE ABANDONED IN PLACE
  - TIME WARNER CABLE ABANDONED IN PLACE UNDERGROUND FACILITIES AS NOTED

PLANS PREPARED BY:  
**RK&K**  
RUMMEL, KLEPPER & KAHL, LLP  
900 RIDGEFIELD DRIVE SUITE 350  
RALEIGH, NORTH CAROLINA 27609-3960  
NC LICENSE NO. F-0112 • (919) 878-9560

UTILITY OWNERS ON THIS SHEET

DUKE ENERGY PROGRESS - POWER  
JONES-ON-SLOW EMC - POWER  
CENTURYLINK - TELEPHONE AND FIBER OPTIC  
TIME WARNER - CATV



**UTILITIES BY OTHERS**

**NOTE:**  
ALL PROPOSED UTILITY WORK SHOWN ON THIS SHEET WILL BE DONE BY OTHERS. NO PAYMENT WILL BE MADE TO THE CONTRACTOR FOR PROPOSED UTILITY WORK SHOWN ON THIS SHEET.

NAD 83/NSRS 2007

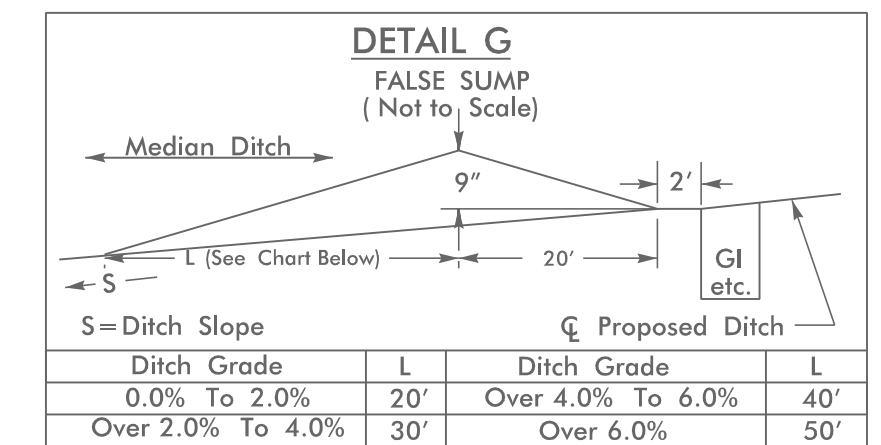

-L-  
 PI Sta 55+14.14      Pls Sta 67+96.88  
 $\Delta = 36^{\circ}04'44.8''$  (LT)       $\Theta_s = 1^{\circ}25'56.6''$   
 $D = 1^{\circ}25'56.6''$        $L_s = 200.00'$   
 $L = 2,518.80'$        $LT = 133.34'$   
 $T = 1,302.73'$        $ST = 66.67'$   
 $R = 4,000.00'$   
 $SE = 0.04$

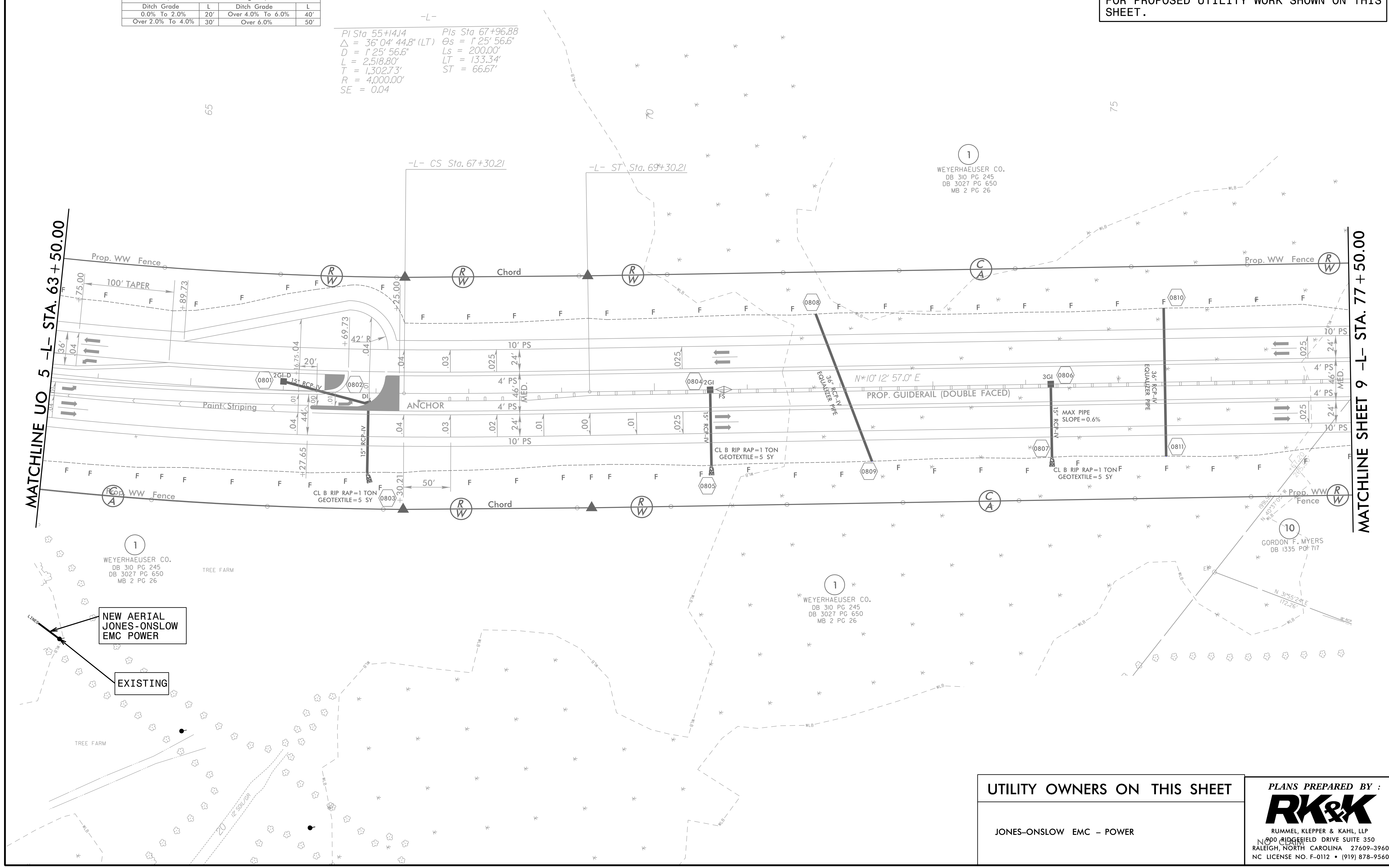

MATCHLINE UO 5 -L- STA. 63+50.00

MATCHLINE SHEET 9 -L- STA. 77+50.00

1 WEYERHAEUSER CO.  
DB 310 PG 245  
DB 3027 PG 650  
MB 2 PG 26

NEW AERIAL  
JONES-ONSLow  
EMC POWER

EXISTING

1 WEYERHAEUSER CO.  
DB 310 PG 245  
DB 3027 PG 650  
MB 2 PG 26

10 GORDON F. MYERS  
DB 1335 PG 717

UTILITY OWNERS ON THIS SHEET	PLANS PREPARED BY :
	<b>RK&amp;K</b> RUMMEL, KLEPPER & KAHL, LLP 900 RIDGEFIELD DRIVE SUITE 350 RALEIGH, NORTH CAROLINA 27609-3960 NC LICENSE NO. F-0112 • (919) 878-9560
JONES-ONSLow EMC - POWER	

**UTILITIES BY OTHERS**

**NOTE:**  
ALL PROPOSED UTILITY WORK SHOWN ON THIS SHEET WILL BE DONE BY OTHERS. NO PAYMENT WILL BE MADE TO THE CONTRACTOR FOR PROPOSED UTILITY WORK SHOWN ON THIS SHEET.

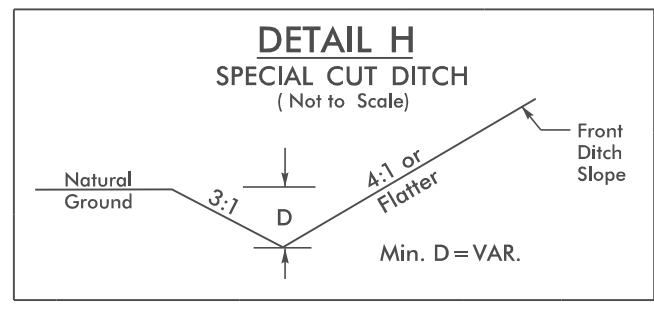
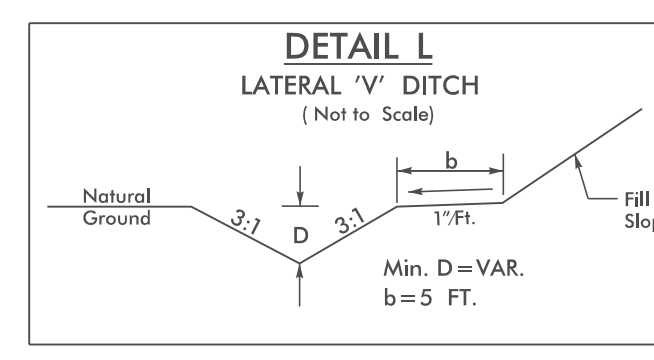
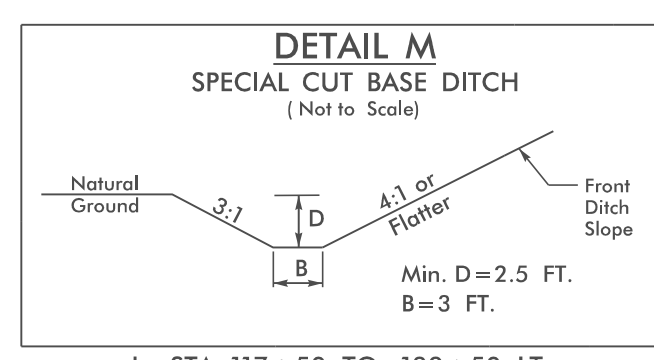
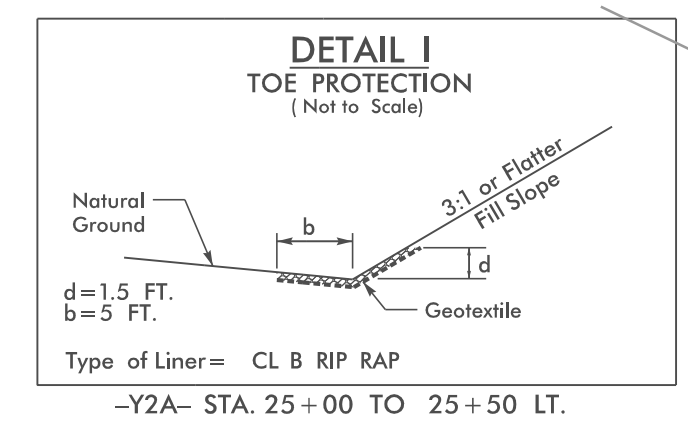
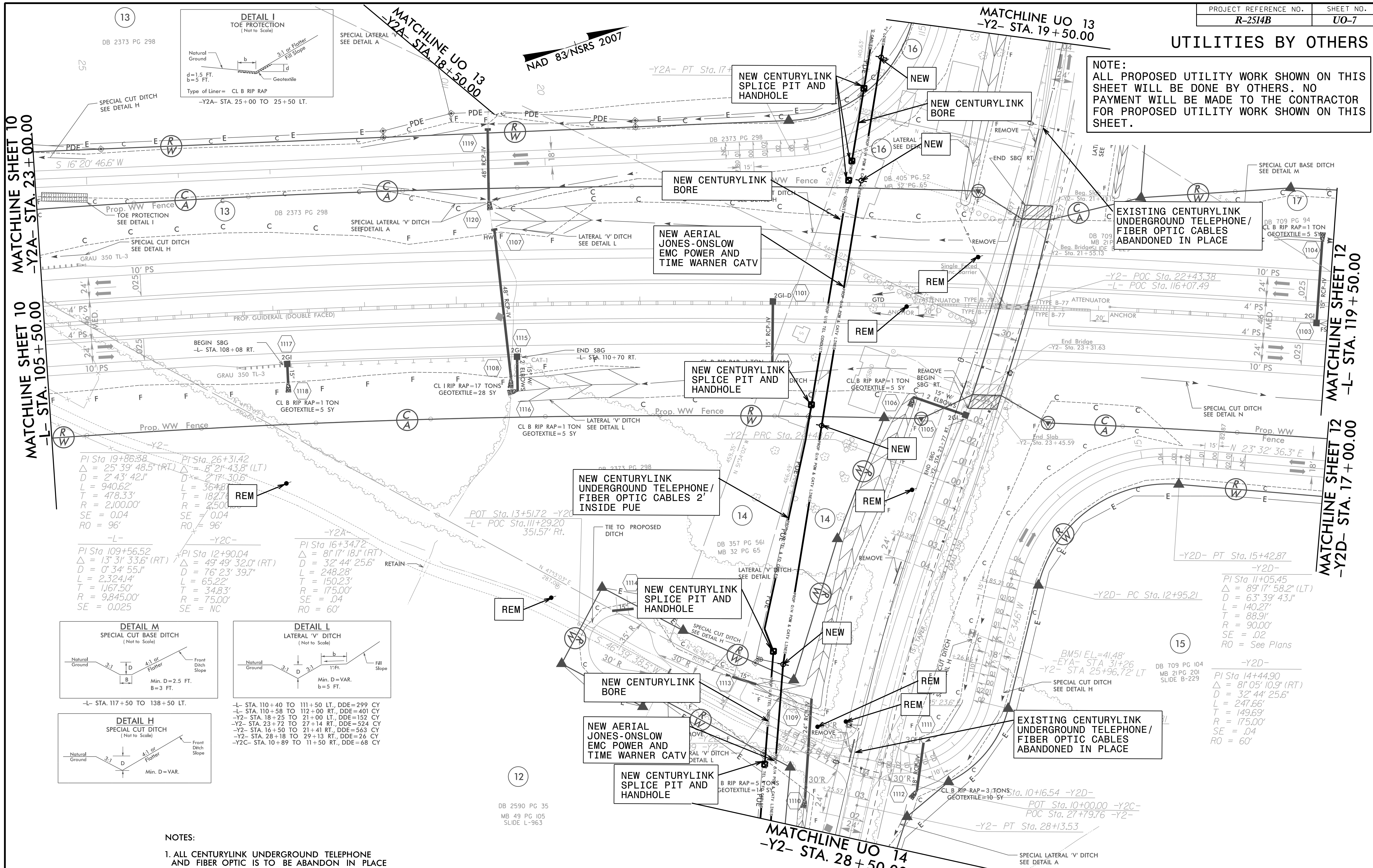

**Curved Section Data:**

Stationing	PI Sta	Delta	D	L	T	R	SE	RO
-L-	19+86.88	25° 39' 48.5" (RT)	2' 43' 42.1"	940.62'	478.33'	2,100.00'	0.04	96'
-Y2A-	26+31.42	8° 21' 43.8" (LT)	2' 17' 30.6"	364.8'	182.74'	2,500.00'	0.04	96'
-L-	109+56.52	13° 31' 33.6" (RT)	0' 34' 55.1"	2,324.14'	1,167.50'	9,845.00'	0.025	60'
-Y2C-	12+90.04	49° 49' 32.0" (RT)	76° 23' 39.7"	65.22'	34.83'	75.00'	NC	
-Y2A-	16+34.72	81° 17' 18.1" (RT)	32' 44' 25.6"	248.28'	150.23'	175.00'	.04	60'
-Y2D-	11+05.45	89° 17' 58.2" (LT)	63° 39' 43.1"	140.27'	88.91'	90.00'	.02	See Plans
-Y2D-	14+44.90	81° 05' 10.9" (RT)	32' 44' 25.6"	247.66'	149.69'	175.00'	.04	60'

**NOTES:**  
1. ALL CENTURYLINK UNDERGROUND TELEPHONE AND FIBER OPTIC IS TO BE ABANDON IN PLACE

**PLANS PREPARED BY :**  
**RK&K**  
RUMMEL, KLEPPER & KAHL, LLP  
900 RIDGEFIELD DRIVE SUITE 350  
RALEIGH, NORTH CAROLINA 27609-3960  
NC LICENSE NO. F-0112 • (919) 878-9560

**UTILITY OWNERS ON THIS SHEET**

JONES-ON-SLOW EMC - POWER  
CENTURYLINK - TELEPHONE/FIBER OPTIC  
TIME WARNER - CATV

**MATCHLINE UO 14**  
-Y2- STA. 28+50.00

**MATCHLINE SHEET 12**  
-L- STA. 119+50.00

**MATCHLINE SHEET 12**  
-Y2D- STA. 17+00.00

**MATCHLINE SHEET 10**  
-L- STA. 105+50.00

**MATCHLINE SHEET 10**  
-Y2A- STA. 23+00.00

**MATCHLINE UO 13**  
-Y2- STA. 19+50.00

NAD 83/NSRS 2007



**UTILITIES BY OTHERS**

**NOTE:**  
 ALL PROPOSED UTILITY WORK SHOWN ON THIS SHEET WILL BE DONE BY OTHERS. NO PAYMENT WILL BE MADE TO THE CONTRACTOR FOR PROPOSED UTILITY WORK SHOWN ON THIS SHEET.

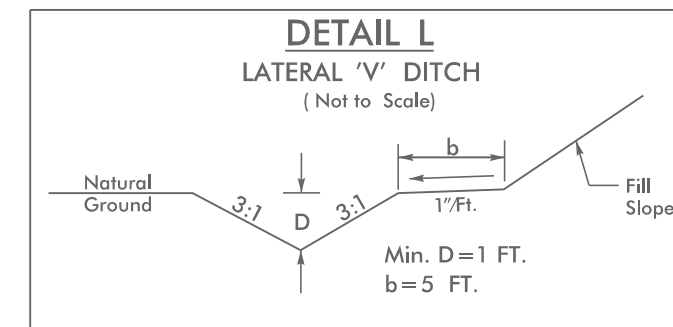

-L- STA. 182+50 TO 188+08 LT., DDE=208 CY

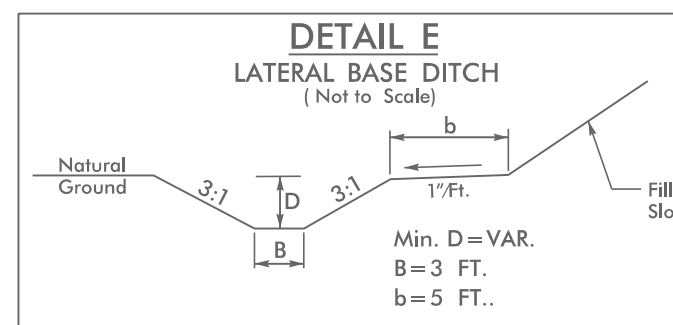

-L- STA. 188+08 TO 189+00 RT. DDE=131 CY

MATCHLINE SHEET 15 -L- STA. 174+50.00

MATCHLINE UO 9 -L- STA. 188+50.00

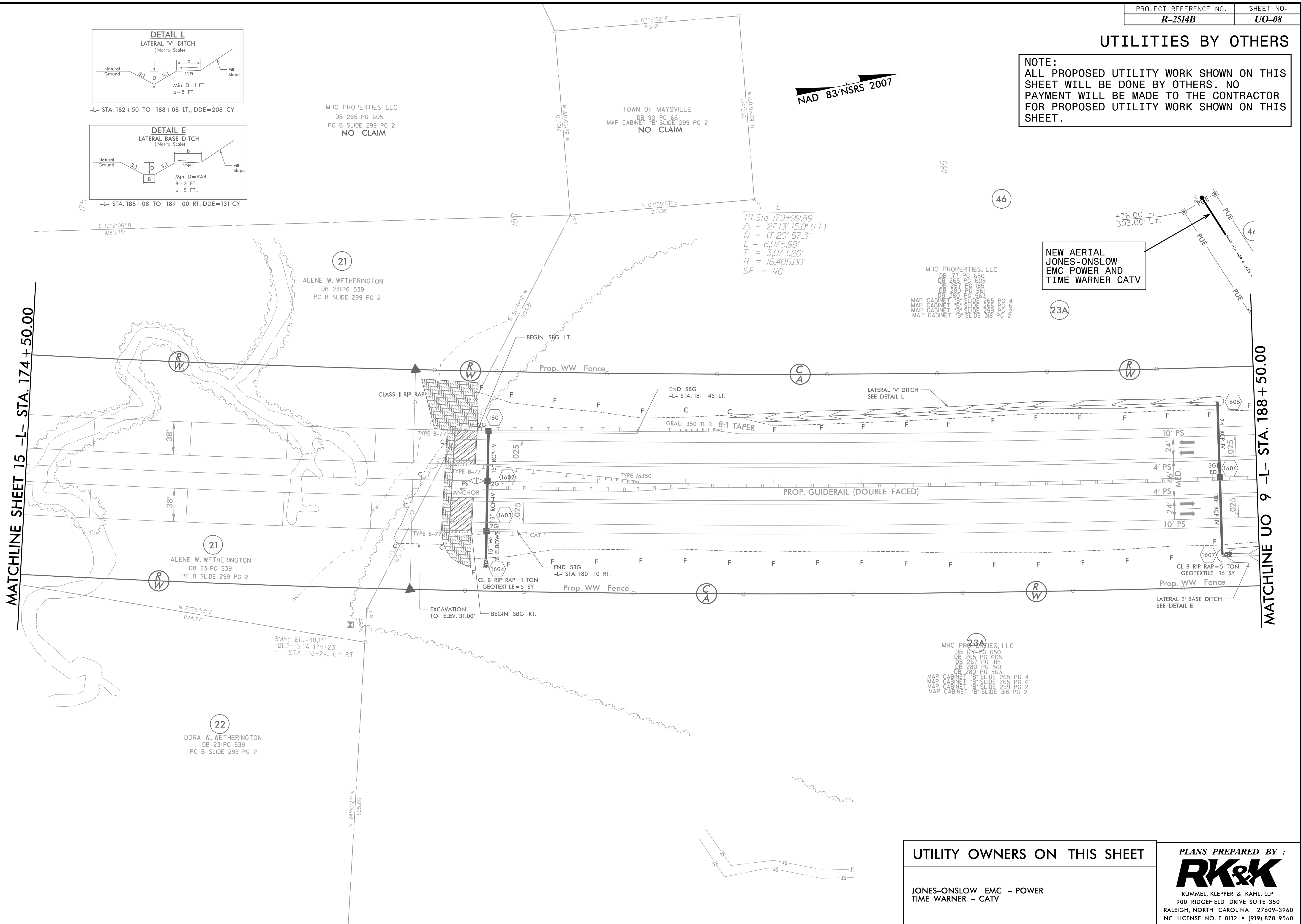

$PI\ Sta\ 179+99.89$   
 $\Delta = 21^{\circ}13'15.0\" (LT)$   
 $D = 0^{\circ}20'57.3\"$   
 $L = 6,075.98'$   
 $T = 3,073.20'$   
 $R = 16,405.00'$   
 $SE = NC$

**NEW AERIAL JONES-ONSLow EMC POWER AND TIME WARNER CATV**

MHC PROPERTIES, LLC  
 DB 177 PG 650  
 DB 265 PG 605  
 DB 267 PG 185  
 DB 280 PG 561  
 DB 280 PG 563  
 MAP CABINET 'B' SLIDE 265 PG N2ND/4  
 MAP CABINET 'B' SLIDE 266 PG N2ND/4  
 MAP CABINET 'B' SLIDE 267 PG N2ND/4  
 MAP CABINET 'B' SLIDE 318 PG N2ND/4

MHC PROPERTIES, LLC  
 DB 177 PG 650  
 DB 265 PG 605  
 DB 267 PG 185  
 DB 280 PG 561  
 DB 280 PG 563  
 MAP CABINET 'B' SLIDE 265 PG N2ND/4  
 MAP CABINET 'B' SLIDE 266 PG N2ND/4  
 MAP CABINET 'B' SLIDE 267 PG N2ND/4  
 MAP CABINET 'B' SLIDE 318 PG N2ND/4

<p><b>UTILITY OWNERS ON THIS SHEET</b></p> <p>JONES-ONSLow EMC - POWER              TIME WARNER - CATV</p>	<p><b>PLANS PREPARED BY :</b></p> <p><b>RK&amp;K</b></p> <p>RUMMEL, KLEPPER &amp; KAHL, LLP              900 RIDGEFIELD DRIVE SUITE 350              RALEIGH, NORTH CAROLINA 27609-3960              NC LICENSE NO. F-0112 • (919) 878-9560</p>
--	---



**UTILITIES BY OTHERS**

**NOTE:**  
 ALL PROPOSED UTILITY WORK SHOWN ON THIS SHEET WILL BE DONE BY OTHERS. NO PAYMENT WILL BE MADE TO THE CONTRACTOR FOR PROPOSED UTILITY WORK SHOWN ON THIS SHEET.

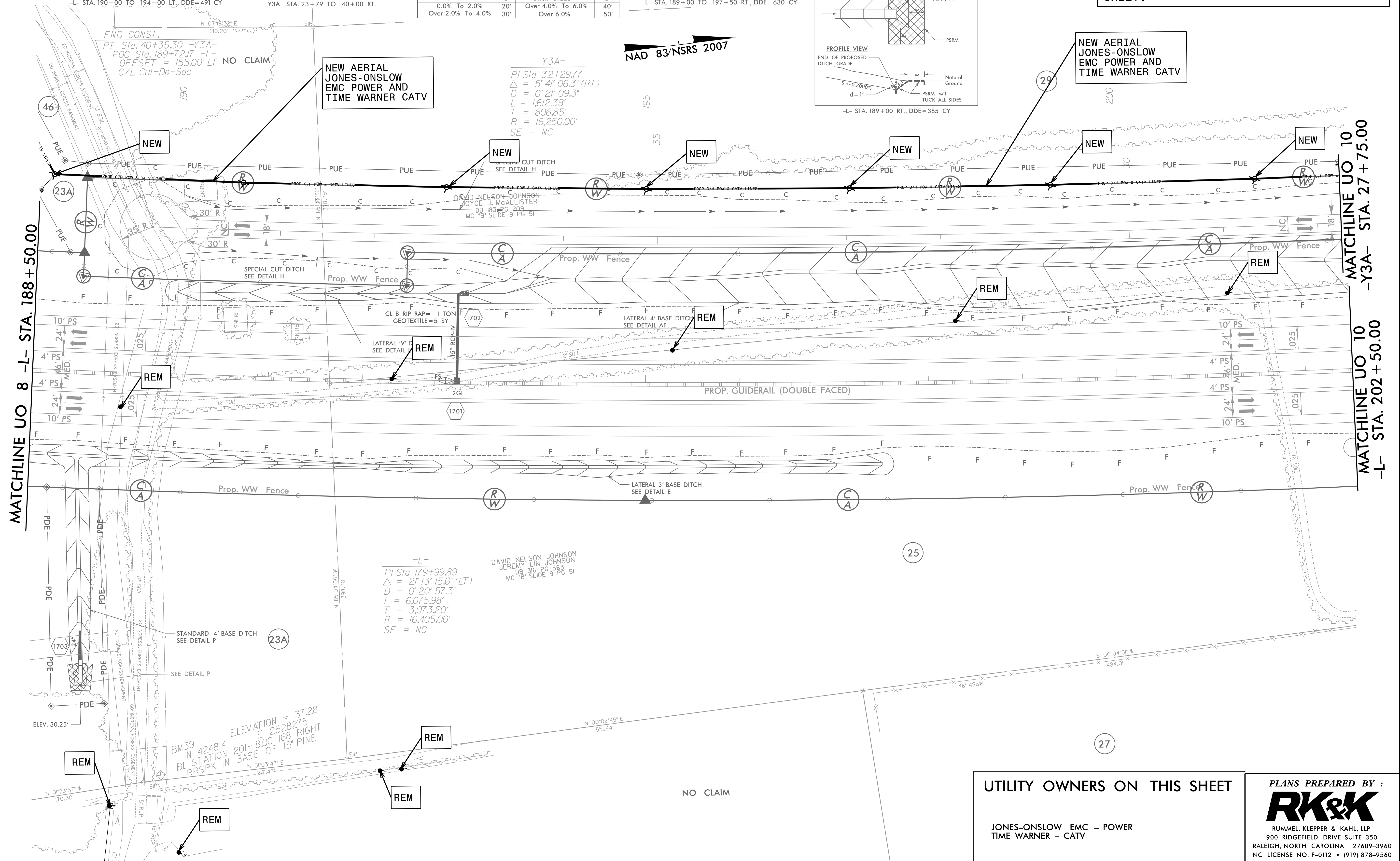
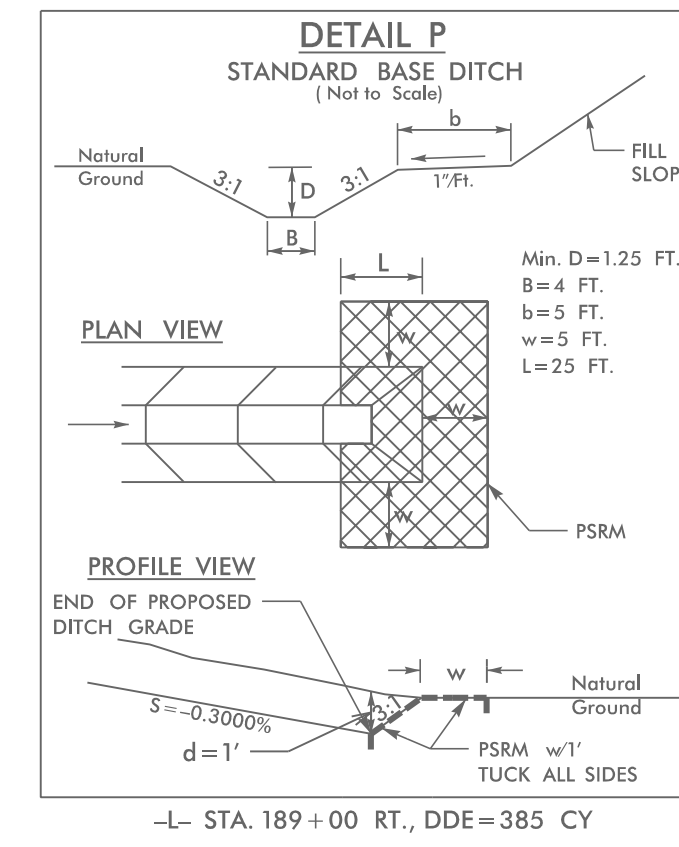
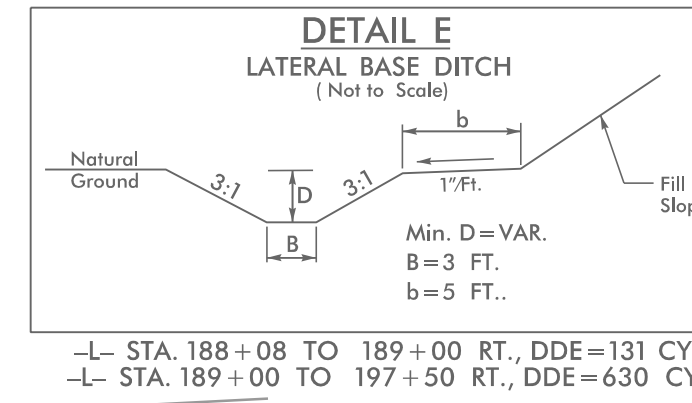
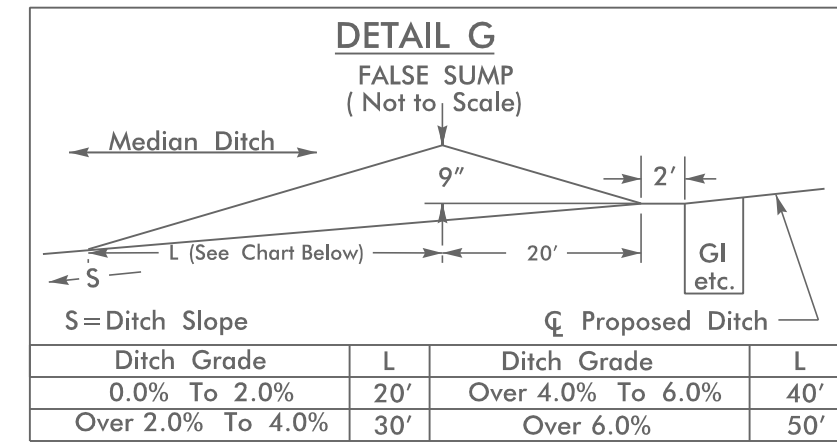
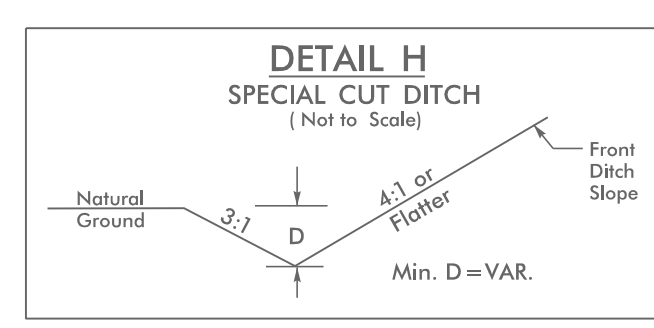
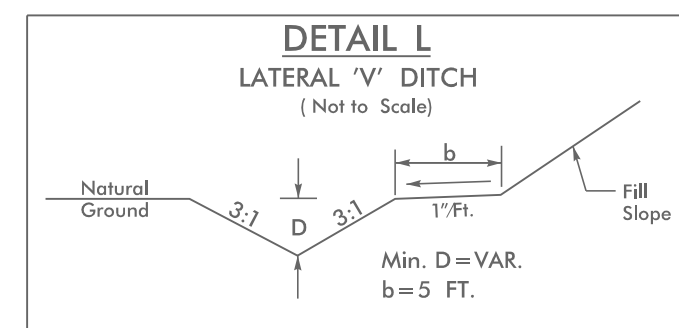

**NEW AERIAL JONES-ONSLow EMC POWER AND TIME WARNER CATV**

**NEW AERIAL JONES-ONSLow EMC POWER AND TIME WARNER CATV**

**-Y3A-**  
 PI Sta 32+29.77  
 $\Delta = 5' 41'' 06.3''$  (RT)  
 $D = 0' 21'' 09.3''$   
 $L = 1,612.38'$   
 $T = 806.85'$   
 $R = 16,250.00'$   
 SE = NC

**-L-**  
 PI Sta 179+99.89  
 $\Delta = 2' 13'' 15.0''$  (LT)  
 $D = 0' 20'' 57.3''$   
 $L = 6,075.98'$   
 $T = 3,073.20'$   
 $R = 16,405.00'$   
 SE = NC

DAVID NELSON JOHNSON  
 JEREMY LIN JOHNSON  
 DB 316 PG 5 B 2  
 MC 'B' SLIDE 9 PG 51

ELEVATION = 37.28  
 E 2528275  
 201+18.00 168 RIGHT  
 BL STATION BASE OF 15' PINE  
 N 01°03'47" E  
 217.43'

**UTILITY OWNERS ON THIS SHEET**

JONES-ONSLow EMC - POWER  
 TIME WARNER - CATV

**PLANS PREPARED BY :**  
**RK&K**  
 RUMMEL, KLEPPER & KAHL, LLP  
 900 RIDGEFIELD DRIVE SUITE 350  
 RALEIGH, NORTH CAROLINA 27609-3960  
 NC LICENSE NO. F-0112 • (919) 878-9560



**UTILITIES BY OTHERS**

**NOTE:**  
ALL PROPOSED UTILITY WORK SHOWN ON THIS SHEET WILL BE DONE BY OTHERS. NO PAYMENT WILL BE MADE TO THE CONTRACTOR FOR PROPOSED UTILITY WORK SHOWN ON THIS SHEET.

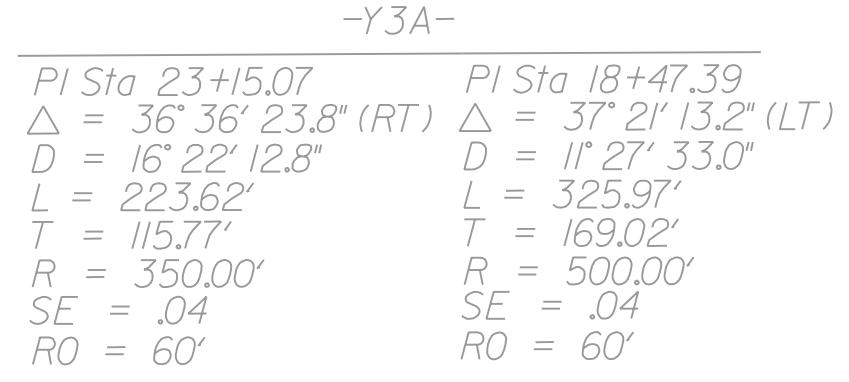
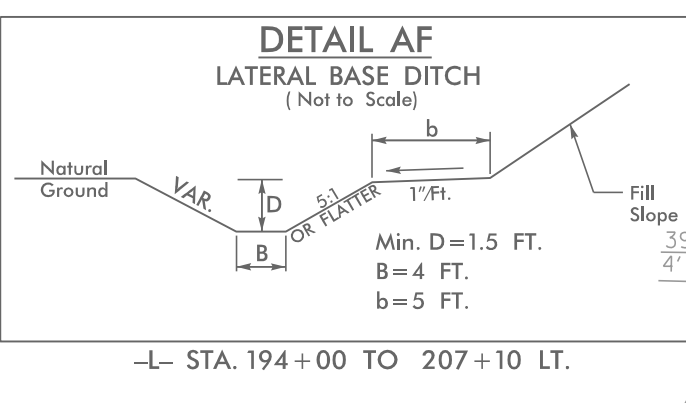
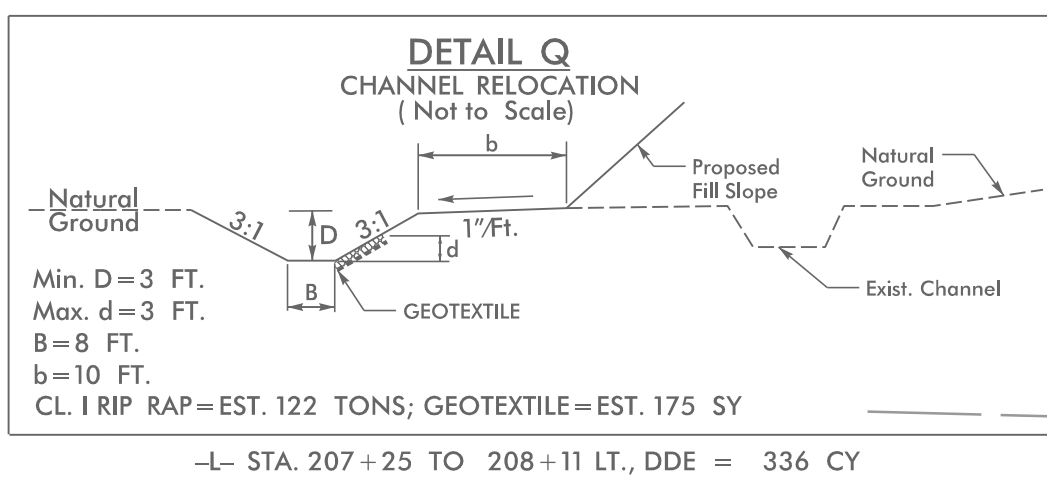
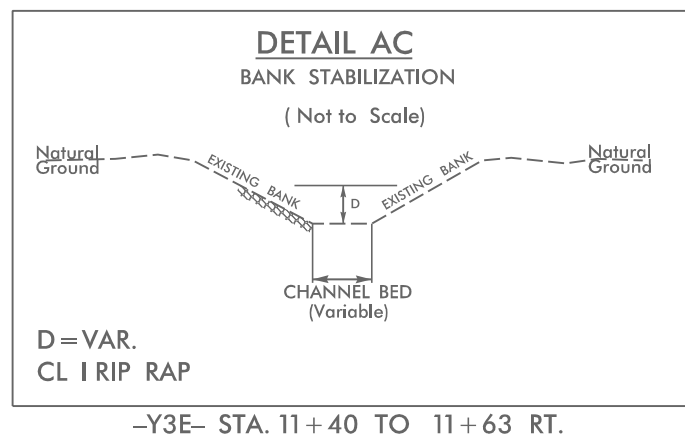
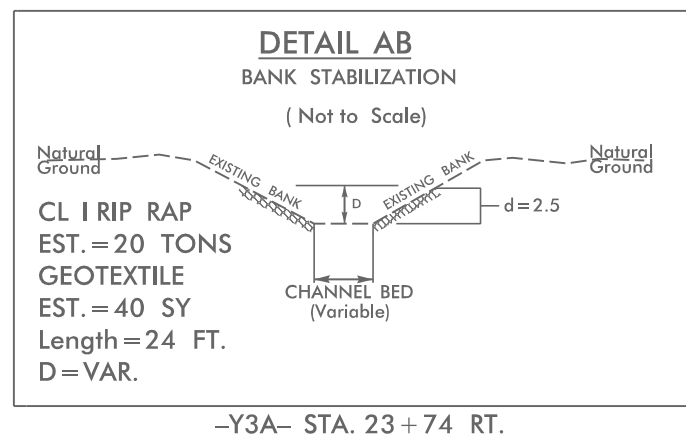
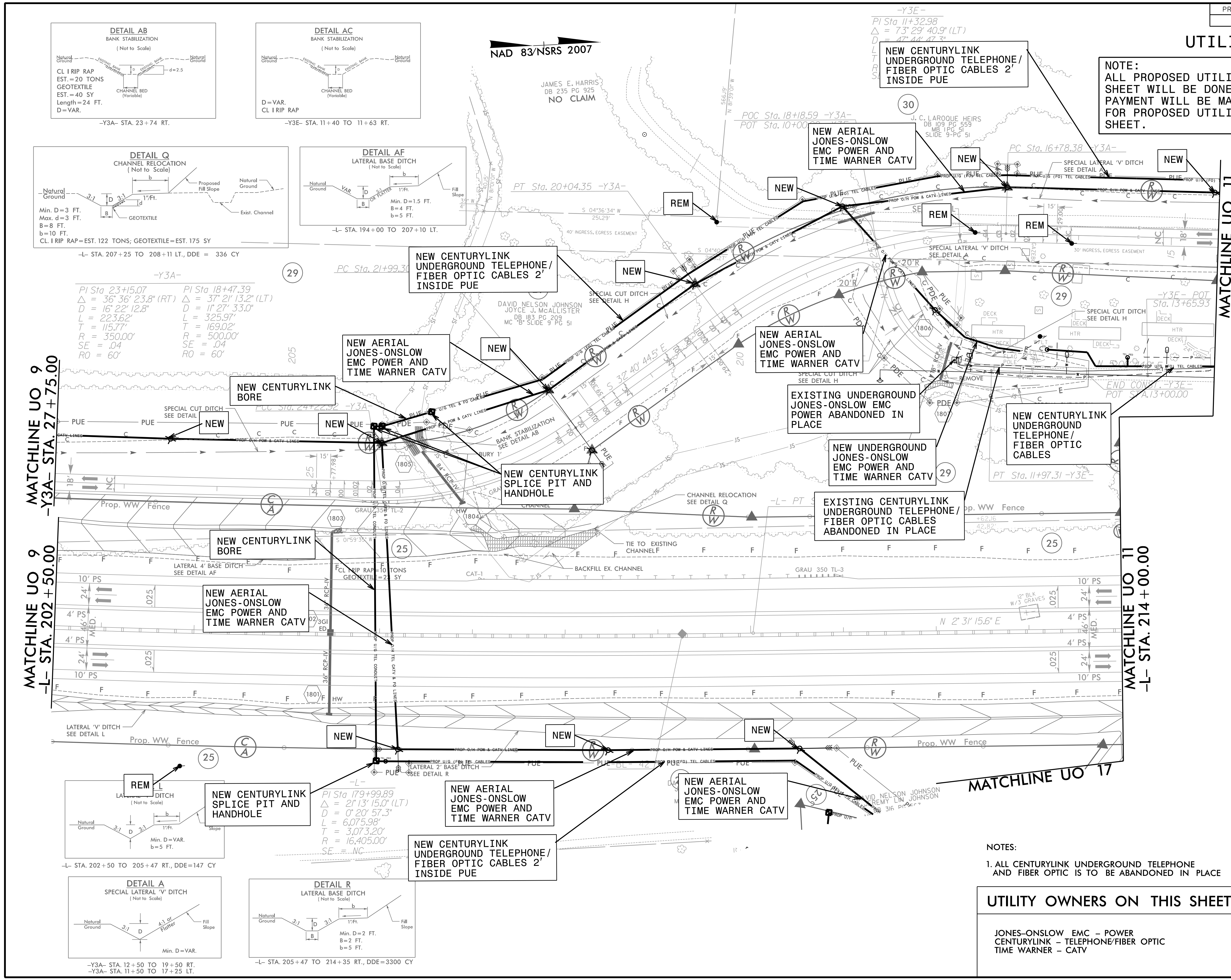

**MATCHLINE UO 9**  
-Y3A- STA. 27+75.00

**MATCHLINE UO 9**  
-L- STA. 202+50.00

**MATCHLINE UO 11**  
-L- STA. 214+00.00

**MATCHLINE UO 11**  
-Y3A- STA. 14+50.00

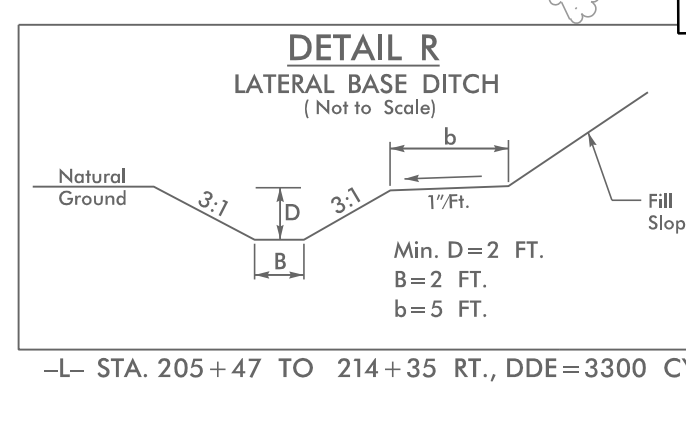
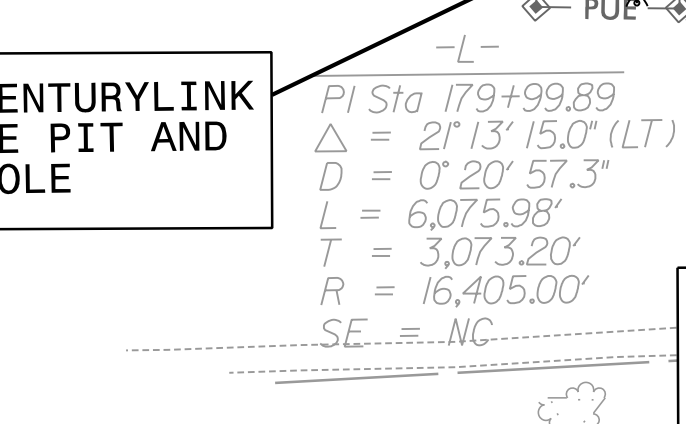
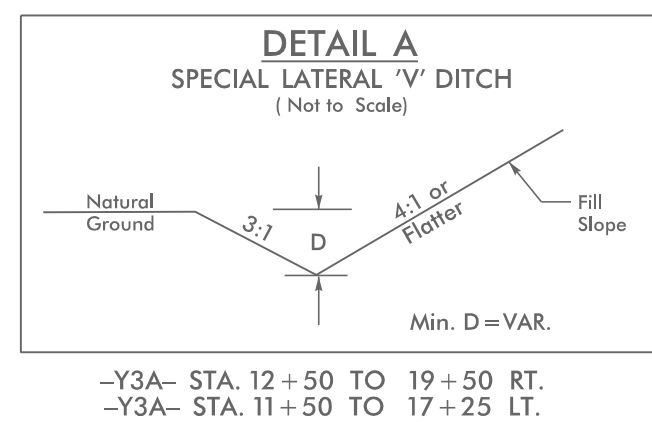
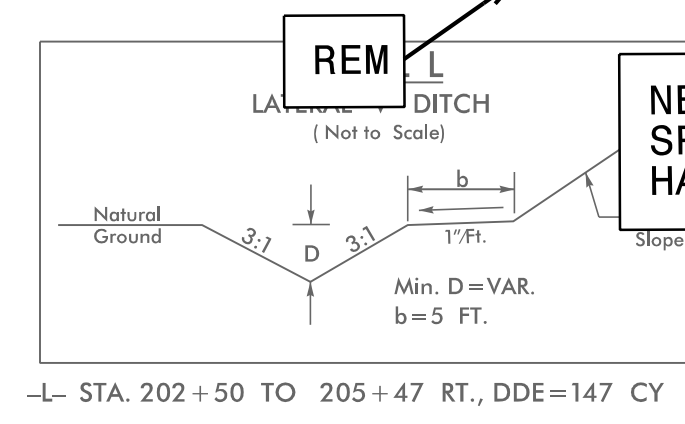

**NOTES:**  
1. ALL CENTURYLINK UNDERGROUND TELEPHONE AND FIBER OPTIC IS TO BE ABANDONED IN PLACE

**UTILITY OWNERS ON THIS SHEET**

- JONES-ONSLow EMC - POWER
- CENTURYLINK - TELEPHONE/FIBER OPTIC
- TIME WARNER - CATV

**PLANS PREPARED BY :**

**RK&K**  
RUMMEL, KLEPPER & KAHL, LLP  
900 RIDGEFIELD DRIVE SUITE 350  
RALEIGH, NORTH CAROLINA 27609-3960  
NC LICENSE NO. F-0112 • (919) 878-9560



### UTILITIES BY OTHERS

**NOTE:**  
 ALL PROPOSED UTILITY WORK SHOWN ON THIS SHEET WILL BE DONE BY OTHERS. NO PAYMENT WILL BE MADE TO THE CONTRACTOR FOR PROPOSED UTILITY WORK SHOWN ON THIS SHEET.

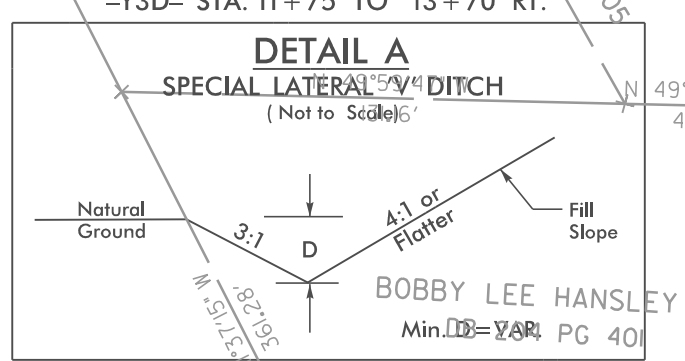
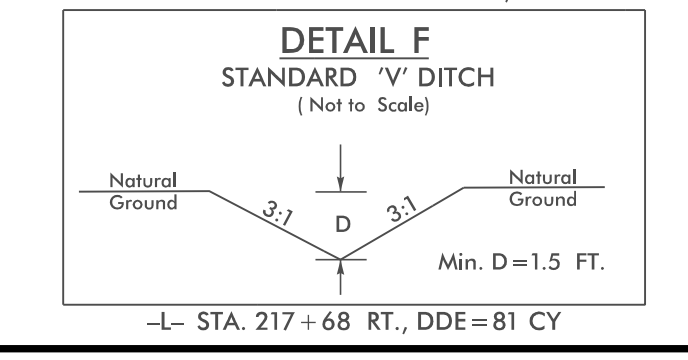
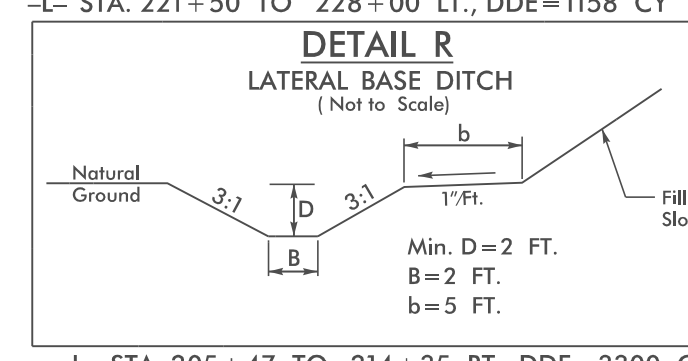
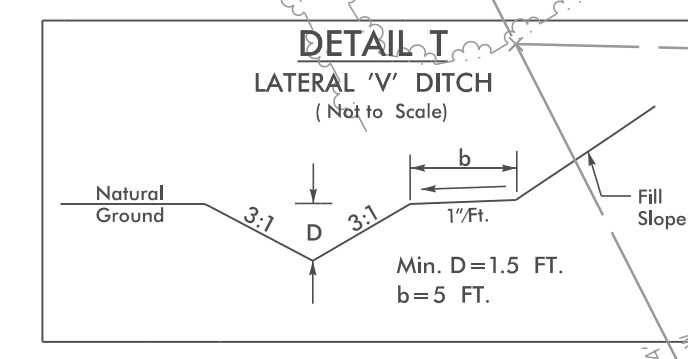
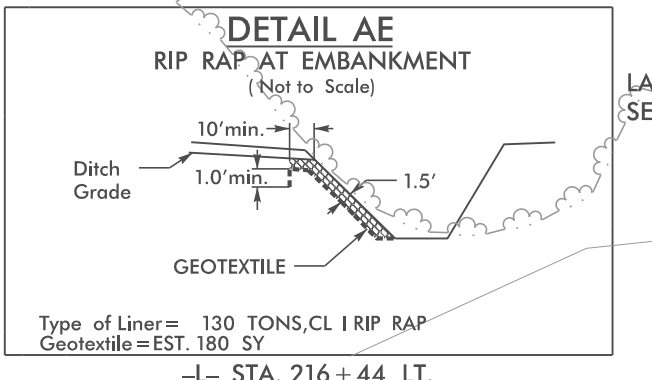
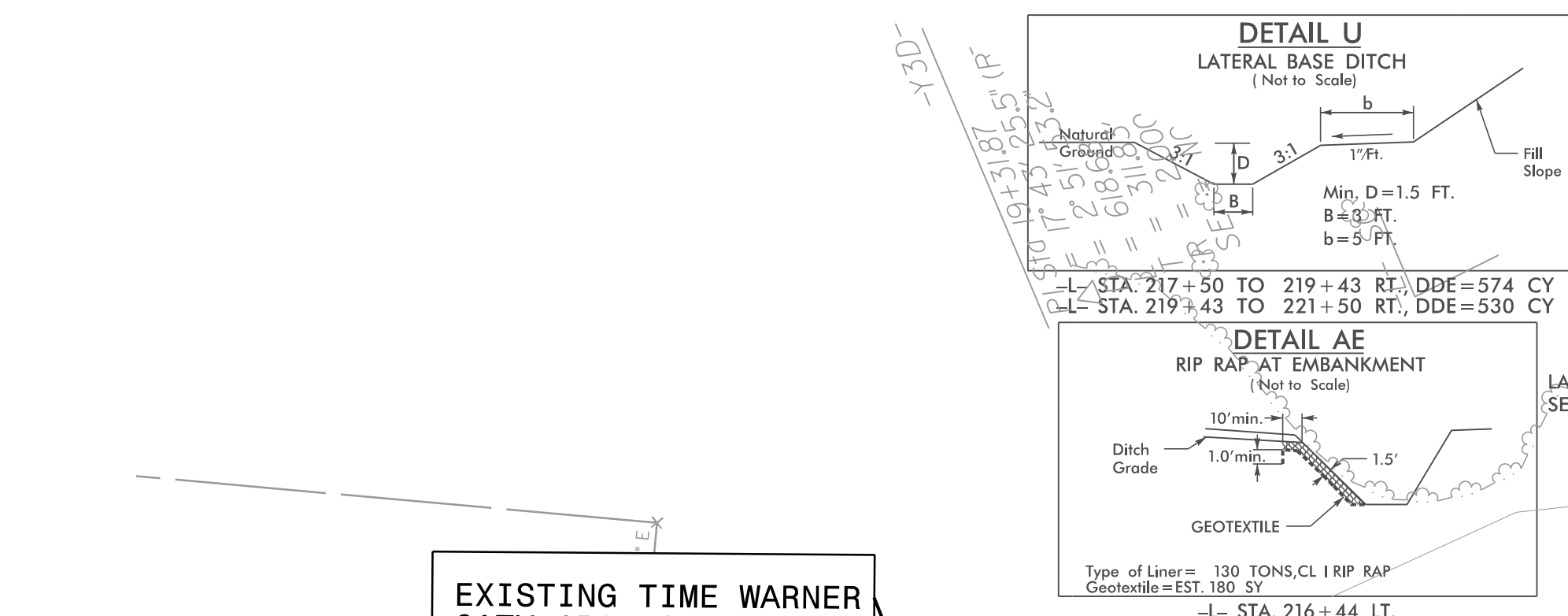
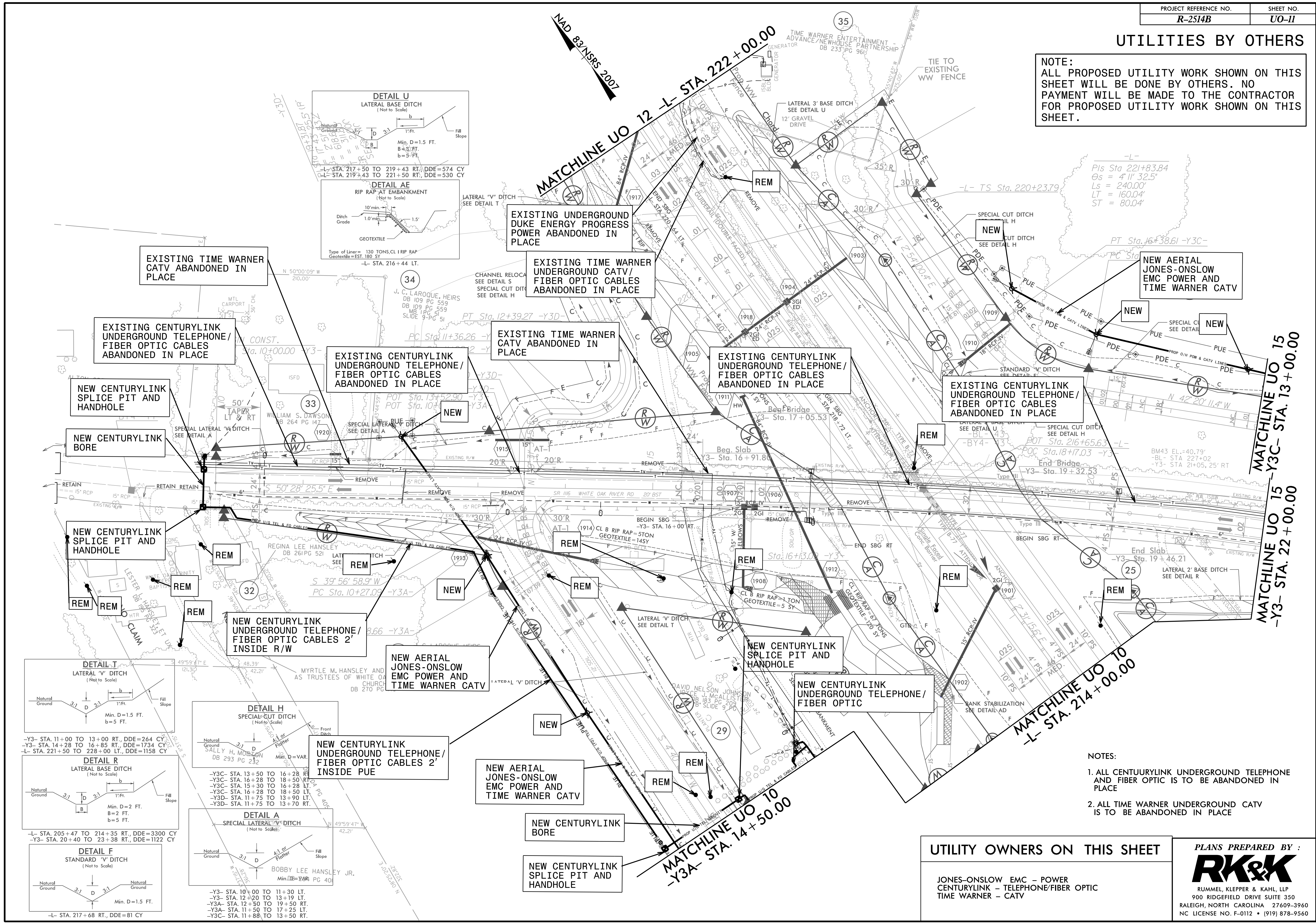

-L-  
 Pts Sta 221+83.84  
 Os = 4' 11" 32.5"  
 Ls = 240.00'  
 LT = 160.04'  
 ST = 80.04'

**NEW AERIAL JONES-ON-SLOW EMC POWER AND TIME WARNER CATV**

**EXISTING CENTURYLINK UNDERGROUND TELEPHONE/FIBER OPTIC CABLES ABANDONED IN PLACE**

**EXISTING CENTURYLINK UNDERGROUND TELEPHONE/FIBER OPTIC CABLES ABANDONED IN PLACE**

- NOTES:**
1. ALL CENTURYLINK UNDERGROUND TELEPHONE AND FIBER OPTIC IS TO BE ABANDONED IN PLACE
  2. ALL TIME WARNER UNDERGROUND CATV IS TO BE ABANDONED IN PLACE

### UTILITY OWNERS ON THIS SHEET

JONES-ON-SLOW EMC - POWER  
 CENTURYLINK - TELEPHONE/FIBER OPTIC  
 TIME WARNER - CATV

### PLANS PREPARED BY :

**RK&K**  
 RUMMEL, KLEPPER & KAHL, LLP  
 900 RIDGEFIELD DRIVE SUITE 350  
 RALEIGH, NORTH CAROLINA 27609-3960  
 NC LICENSE NO. F-0112 • (919) 878-9560



**UTILITIES BY OTHERS**

**NOTE:**  
 ALL PROPOSED UTILITY WORK SHOWN ON THIS SHEET WILL BE DONE BY OTHERS. NO PAYMENT WILL BE MADE TO THE CONTRACTOR FOR PROPOSED UTILITY WORK SHOWN ON THIS SHEET.

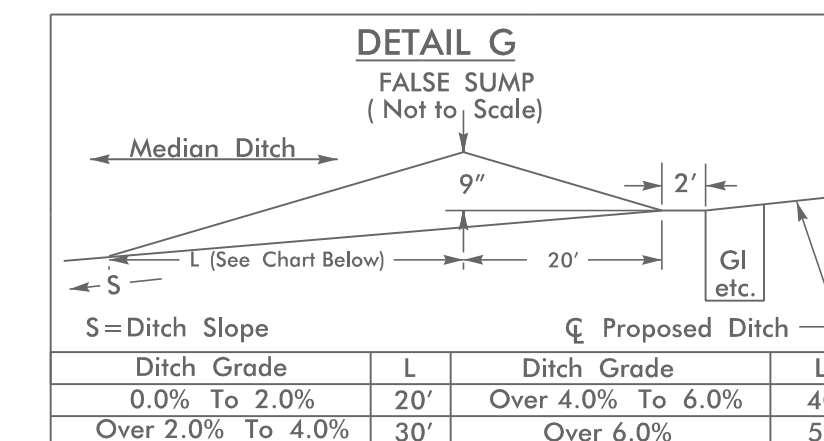
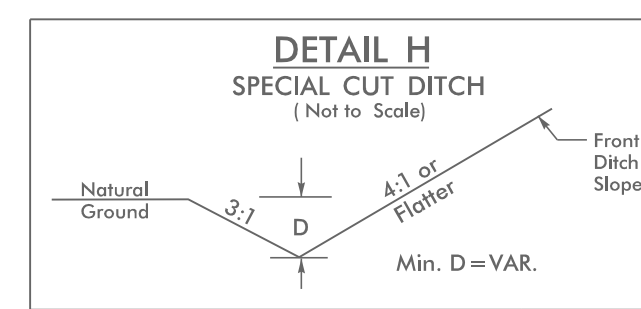
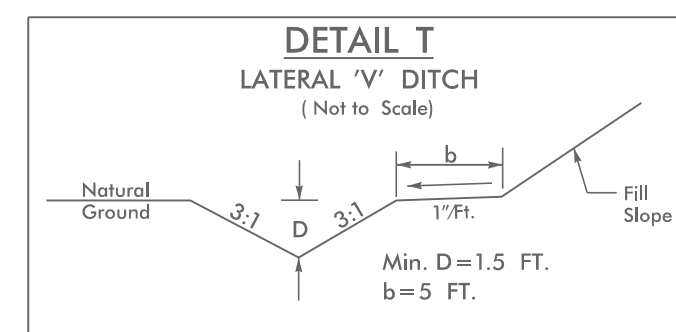

Sta 23+11.90  
 = 52° 56' 03.5" (LT)  
 = 38° 58' 36.2"  
 L = 135.81'  
 T = 73.19'  
 R = 147.00'  
 SE = NC

-L- STA. 221+50 TO 228+00 LT., DDE=1158 CY  
 -L- STA. 225+00 TO 227+40 RT., DDE=360 CY

-L- STA. 221+83.84  
 Δs = 4° 11' 32.5"  
 Ls = 240.00'  
 LT = 160.04'  
 ST = 80.04'

-L- STA. 225+57.18  
 Δ = 20° 17' 06.2" (RT)  
 D = 3° 29' 37.1"  
 L = 580.63'  
 T = 293.38'  
 R = 1,640.00'  
 SE = 0.06

-L- STA. 229+24.46  
 Δs = 4° 11' 32.5"  
 Ls = 240.00'  
 LT = 160.04'  
 ST = 80.04'

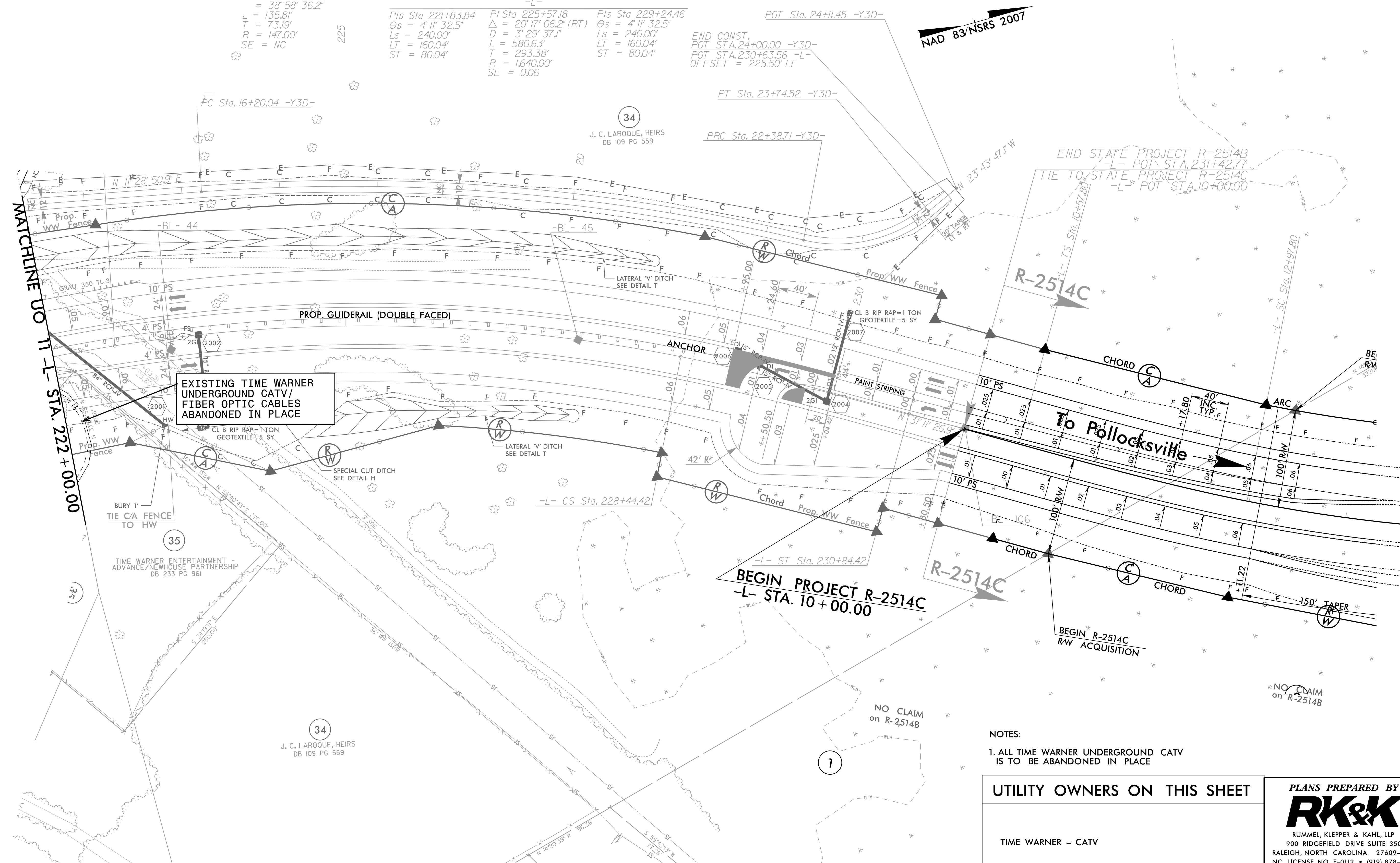

**NOTES:**  
 1. ALL TIME WARNER UNDERGROUND CATV IS TO BE ABANDONED IN PLACE

<b>UTILITY OWNERS ON THIS SHEET</b>	<b>PLANS PREPARED BY :</b>
TIME WARNER - CATV	 RUMMEL, KLEPPER & KAHL, LLP 900 RIDGEFIELD DRIVE SUITE 350 RALEIGH, NORTH CAROLINA 27609-3960 NC LICENSE NO. F-0112 • (919) 878-9560



JONES-ONSLow EMC - POWER  
 CENTURYLINK - TELEPHONE/FIBER OPTIC  
 TIME WARNER - CATV

NOTES:

1. ALL CENTURYLINK UNDERGROUND TELEPHONE AND FIBER OPTIC IS TO BE ABANDONED IN PLACE
2. ALL TIME WARNER UNDERGROUND CATV IS TO BE ABANDONED IN PLACE

10 UTILITIES BY OTHERS

NOTE:  
 ALL PROPOSED UTILITY WORK SHOWN ON THIS SHEET WILL BE DONE BY OTHERS. NO PAYMENT WILL BE MADE TO THE CONTRACTOR FOR PROPOSED UTILITY WORK SHOWN ON THIS SHEET.

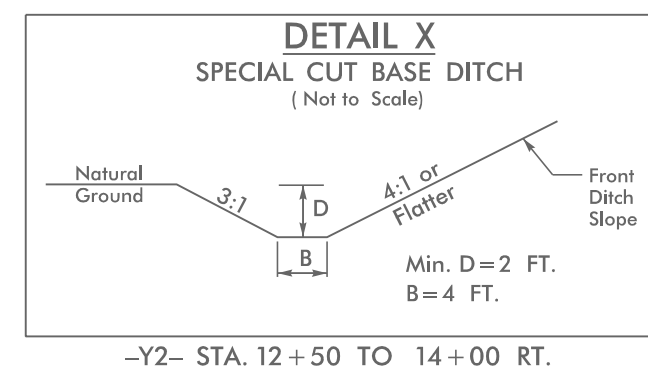
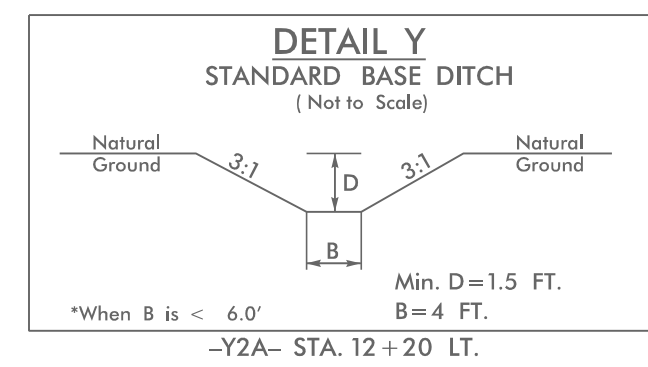
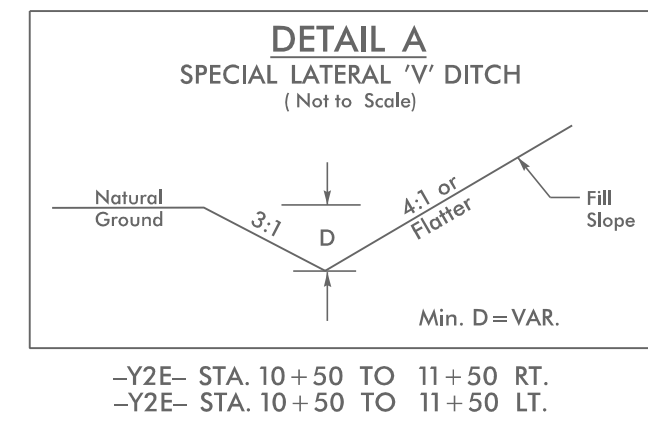
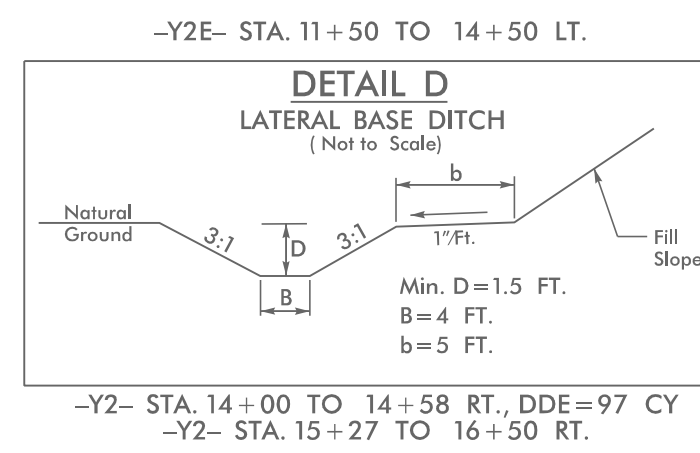

-Y2B-  
 PI Sta 10+62.40  
 $\Delta = 80' 05" 18.0" (RT)$   
 $D = 190' 59" 09.4"$   
 $L = 41.93'$   
 $T = 25.21'$   
 $R = 30.00'$   
 SE = NC

-Y2-  
 PI Sta 19+86.38  
 $\Delta = 25' 39" 48.5" (RT)$   
 $D = 2' 43" 42.1"$   
 $L = 940.62'$   
 $T = 478.33'$   
 $R = 2,100.00'$   
 SE = 0.04  
 RO = 96'

-Y2A-  
 PI Sta 11+01.04  
 $\Delta = 79' 08" 02.6" (LT)$   
 $D = 57' 17" 44.8"$   
 $L = 138.11'$   
 $T = 82.63'$   
 $R = 100.00'$   
 SE = 0.02  
 RO = See Plans

PI Sta 16+34.72  
 $\Delta = 81' 17" 18.1" (RT)$   
 $D = 32' 44" 25.6"$   
 $L = 248.28'$   
 $T = 150.23'$   
 $R = 175.00'$   
 SE = .04  
 RO = 60'

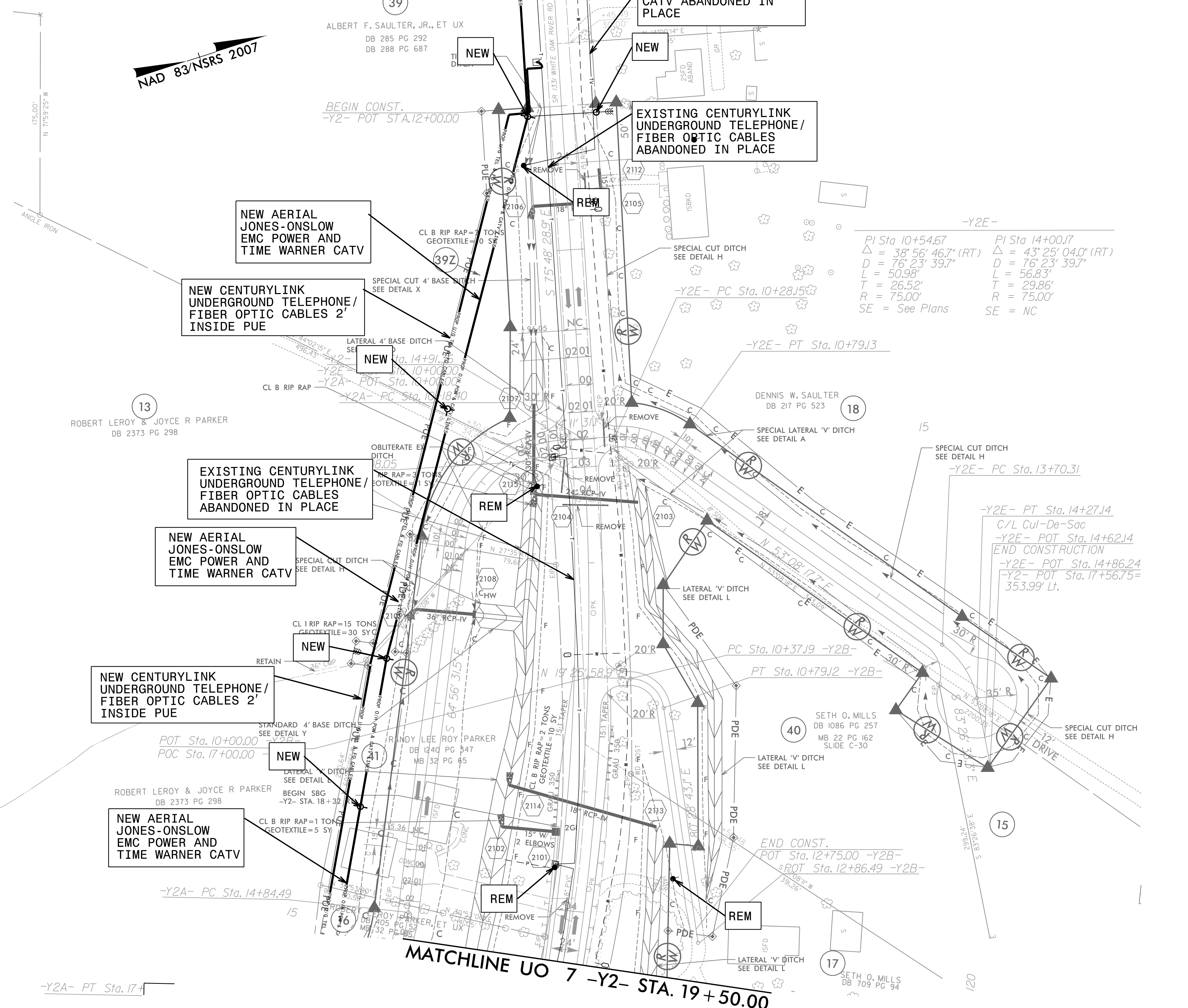

NAD 83/NSRS 2007

MATCHLINE UO 7  
 -Y2A- STA. 18+50.00

MATCHLINE UO 7  
 -Y2- STA. 19+50.00



### UTILITIES BY OTHERS

**NOTE:**  
ALL PROPOSED UTILITY WORK SHOWN ON THIS SHEET WILL BE DONE BY OTHERS. NO PAYMENT WILL BE MADE TO THE CONTRACTOR FOR PROPOSED UTILITY WORK SHOWN ON THIS SHEET.

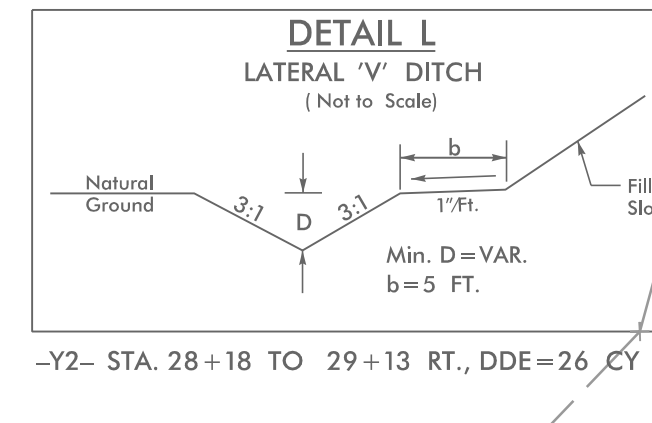
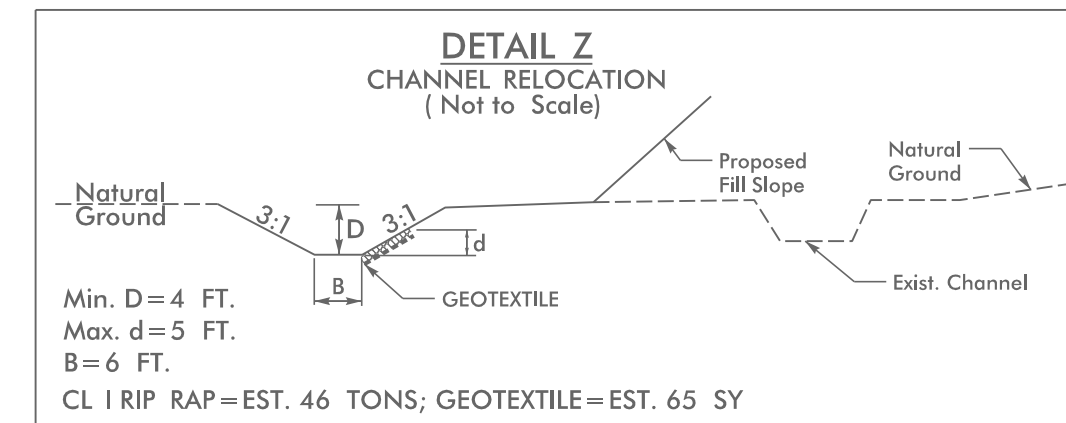
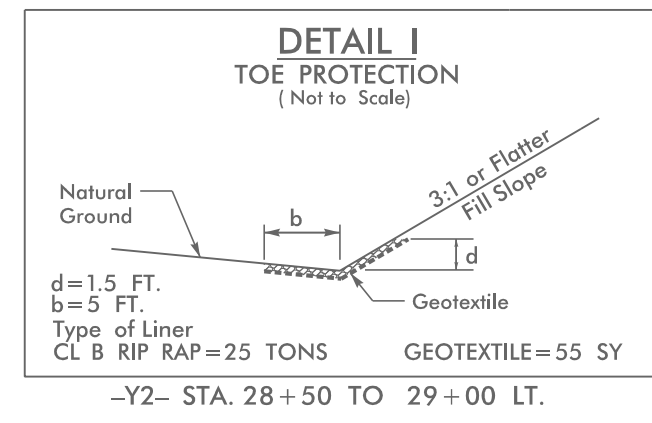
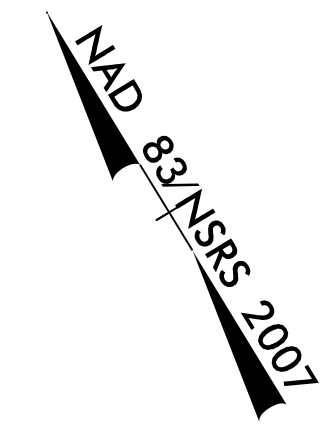

-Y2-  
 $PI Sta. 33+27.72$   
 $\Delta = 4' 54" 06.0" (LT)$   
 $D = 2' 23" 14.4"$   
 $L = 205.32'$   
 $T = 102.72'$   
 $R = 2,400.00'$

MATCHLINE UO 7 -Y2- STA. 28+50.00

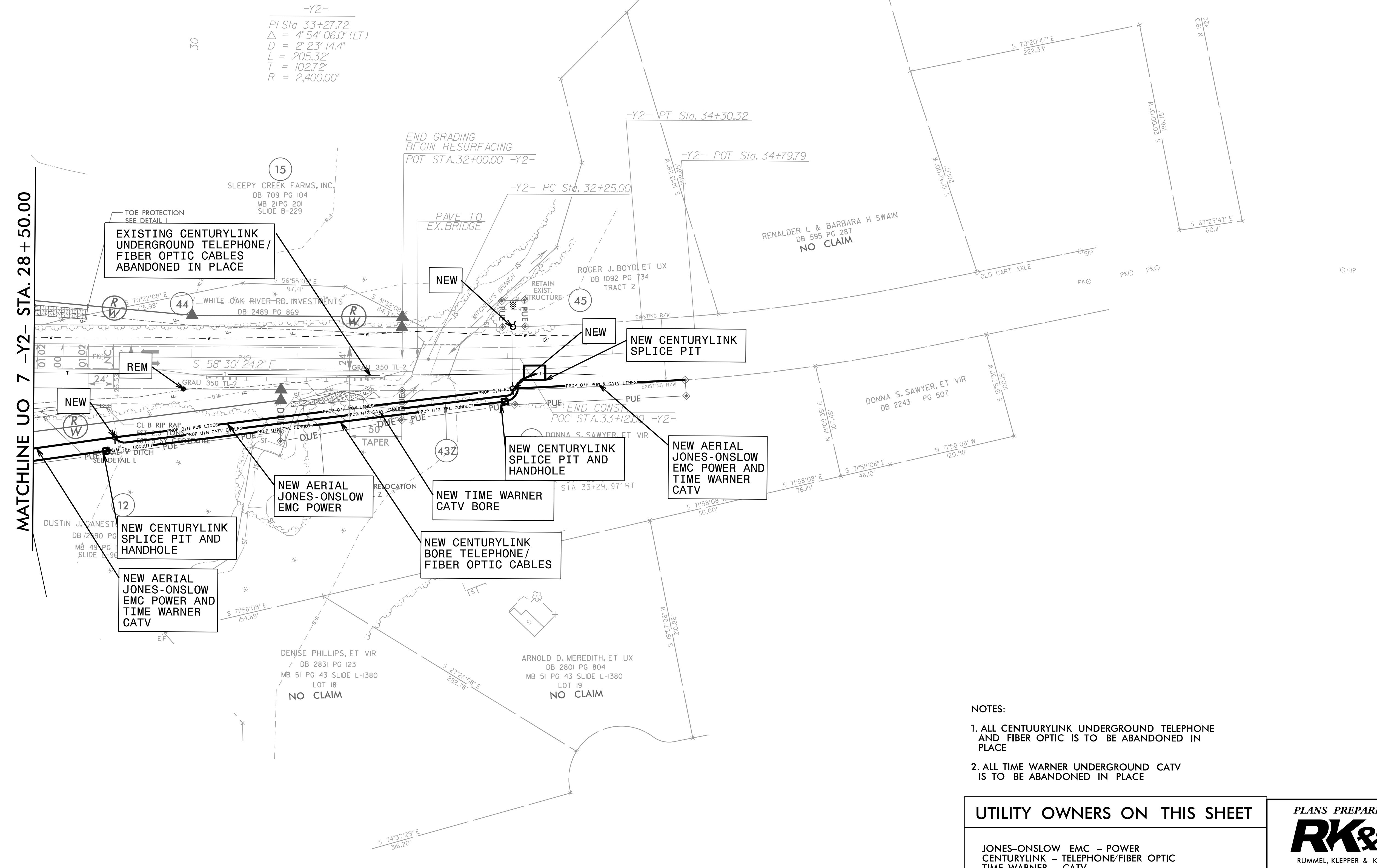

- NOTES:**
1. ALL CENTURYLINK UNDERGROUND TELEPHONE AND FIBER OPTIC IS TO BE ABANDONED IN PLACE
  2. ALL TIME WARNER UNDERGROUND CATV IS TO BE ABANDONED IN PLACE

<b>UTILITY OWNERS ON THIS SHEET</b>	<b>PLANS PREPARED BY :</b>
JONES-ONSLow EMC - POWER CENTURYLINK - TELEPHONE/FIBER OPTIC TIME WARNER - CATV	<b>RK&amp;K</b> RUMMEL, KLEPPER & KAHL, LLP 900 RIDGEFIELD DRIVE SUITE 350 RALEIGH, NORTH CAROLINA 27609-3960 NC LICENSE NO. F-0112 • (919) 878-9560



**UTILITIES BY OTHERS**

**NOTE:**  
 ALL PROPOSED UTILITY WORK SHOWN ON THIS SHEET WILL BE DONE BY OTHERS. NO PAYMENT WILL BE MADE TO THE CONTRACTOR FOR PROPOSED UTILITY WORK SHOWN ON THIS SHEET.

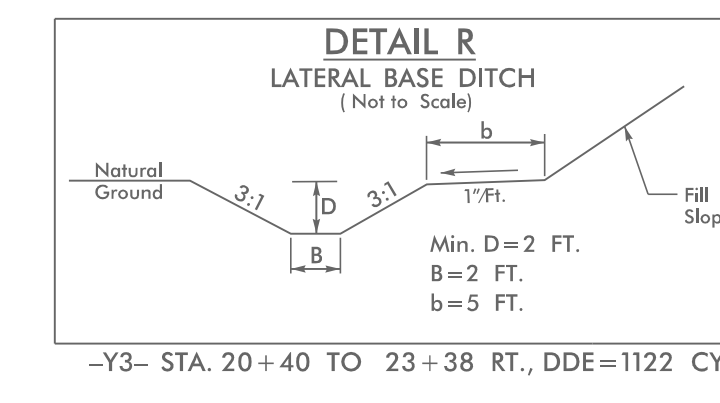
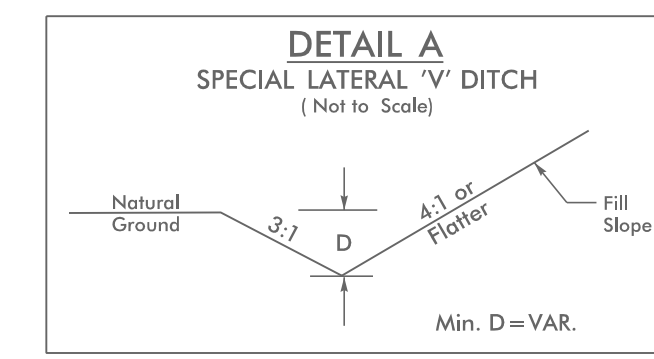
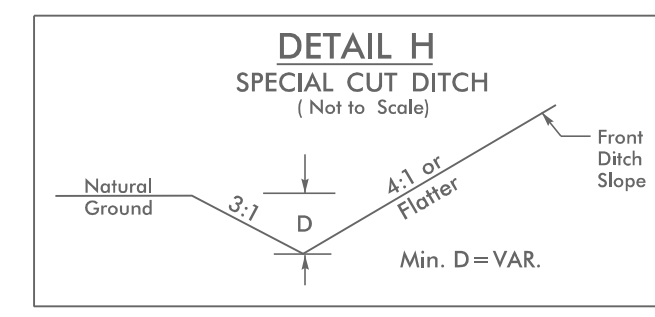

**-Y3-**  
 PI Sta 20+20.29  
 $\Delta = 9^{\circ}18'42.4''$  (RT)  
 $D = 1^{\circ}08'45.3''$   
 $L = 812.60'$   
 $T = 407.20'$   
 $R = 5,000.00'$   
 $SE = 0.02$

**-Y3C-**  
 PI Sta 10+82.52  
 $\Delta = 7^{\circ}00'18.3''$  (LT)  
 $D = 11^{\circ}35'29.6''$   
 $L = 68.07'$   
 $T = 40.49'$   
 $R = 50.00'$   
 $SE = \text{See Plans}$   
 RO = 45'

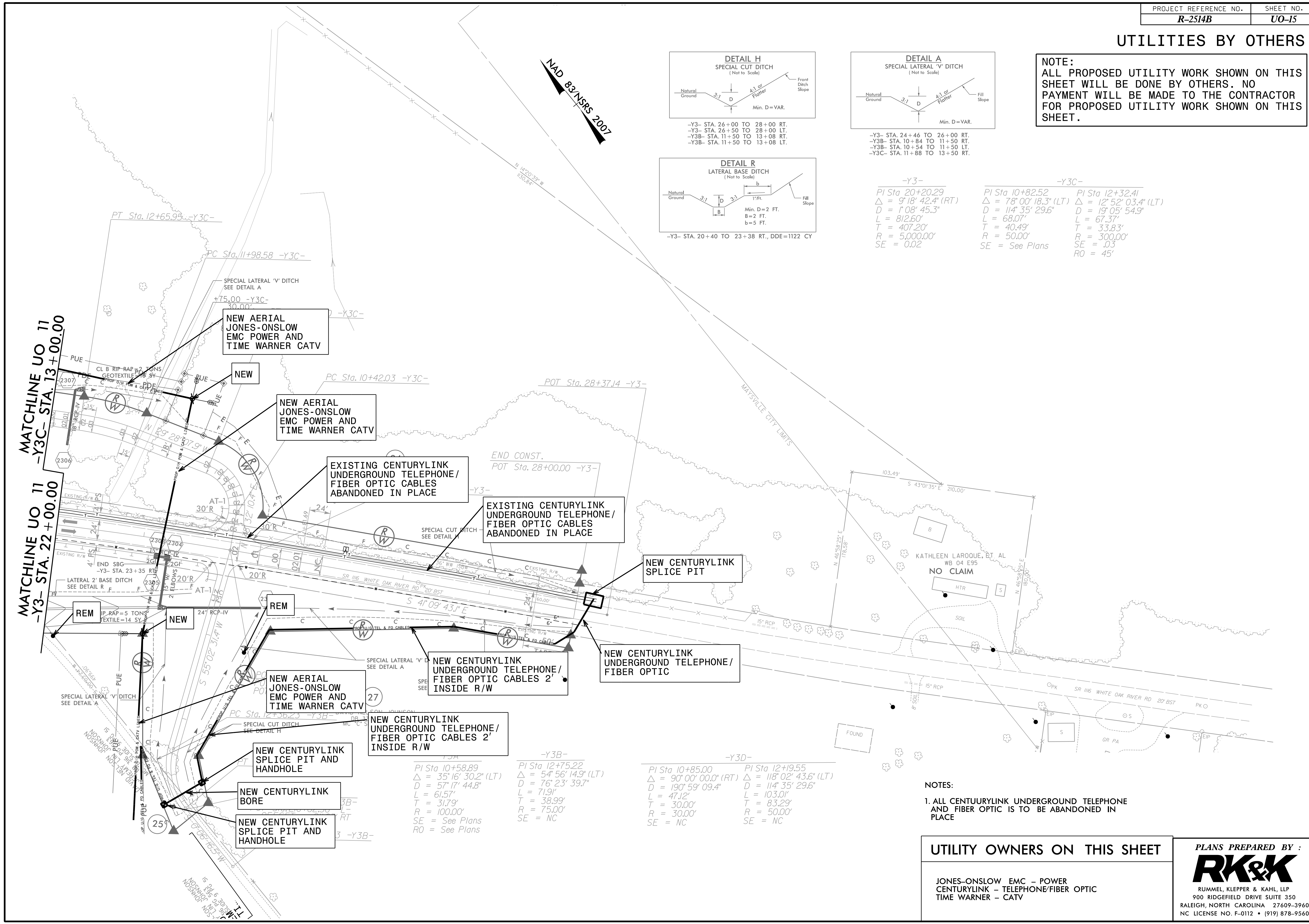

**-Y3B-**  
 PI Sta 10+58.89  
 $\Delta = 35^{\circ}16'30.2''$  (LT)  
 $D = 57^{\circ}17'44.8''$   
 $L = 61.57'$   
 $T = 31.79'$   
 $R = 100.00'$   
 $SE = \text{See Plans}$   
 $RO = \text{See Plans}$

**-Y3B-**  
 PI Sta 12+75.22  
 $\Delta = 54^{\circ}56'14.9''$  (LT)  
 $D = 76^{\circ}23'39.7''$   
 $L = 71.91'$   
 $T = 38.99'$   
 $R = 75.00'$   
 $SE = \text{NC}$

**-Y3D-**  
 PI Sta 10+85.00  
 $\Delta = 90^{\circ}00'00.0''$  (RT)  
 $D = 190^{\circ}59'09.4''$   
 $L = 47.12'$   
 $T = 30.00'$   
 $R = 30.00'$   
 $SE = \text{NC}$

**-Y3D-**  
 PI Sta 12+19.55  
 $\Delta = 118^{\circ}02'43.6''$  (LT)  
 $D = 114^{\circ}35'29.6''$   
 $L = 103.01'$   
 $T = 83.29'$   
 $R = 50.00'$   
 $SE = \text{NC}$

**NOTES:**  
 1. ALL CENTURYLINK UNDERGROUND TELEPHONE AND FIBER OPTIC IS TO BE ABANDONED IN PLACE

<b>UTILITY OWNERS ON THIS SHEET</b>	<b>PLANS PREPARED BY :</b>
JONES-ONSLow EMC - POWER CENTURYLINK - TELEPHONE/FIBER OPTIC TIME WARNER - CATV	 RUMMEL, KLEPPER & KAHL, LLP 900 RIDGEFIELD DRIVE SUITE 350 RALEIGH, NORTH CAROLINA 27609-3960 NC LICENSE NO. F-0112 • (919) 878-9560