

**UTILITIES BY OTHERS**

**NOTE:**  
 ALL PROPOSED UTILITY WORK SHOWN ON THIS SHEET WILL BE DONE BY OTHERS. NO PAYMENT WILL BE MADE TO THE CONTRACTOR FOR PROPOSED UTILITY WORK SHOWN ON THIS SHEET.

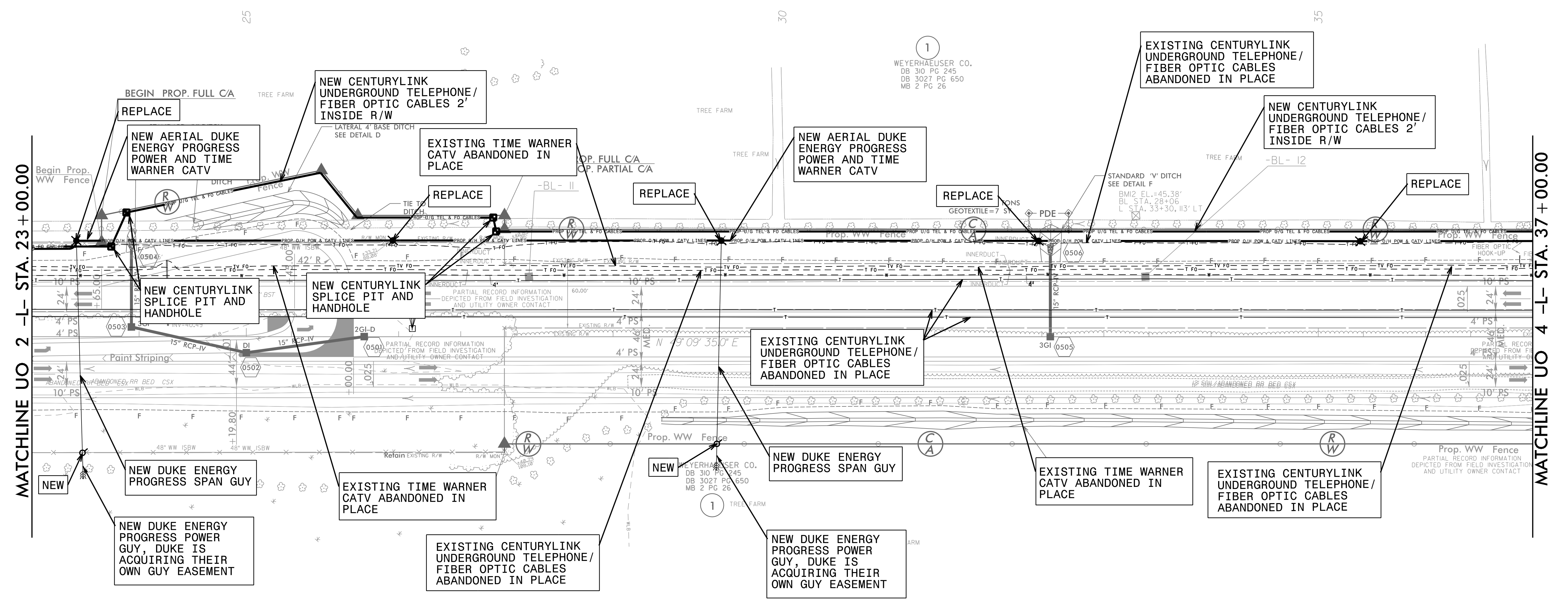
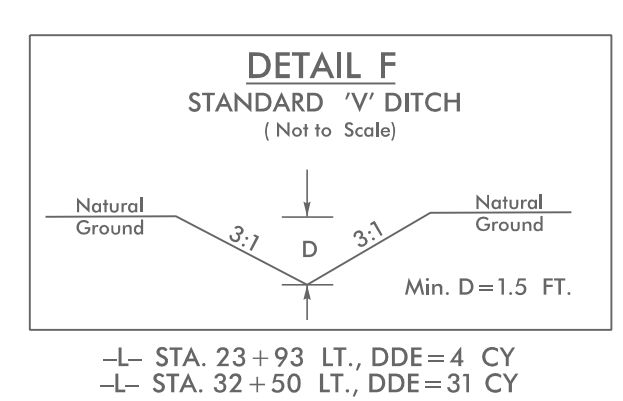
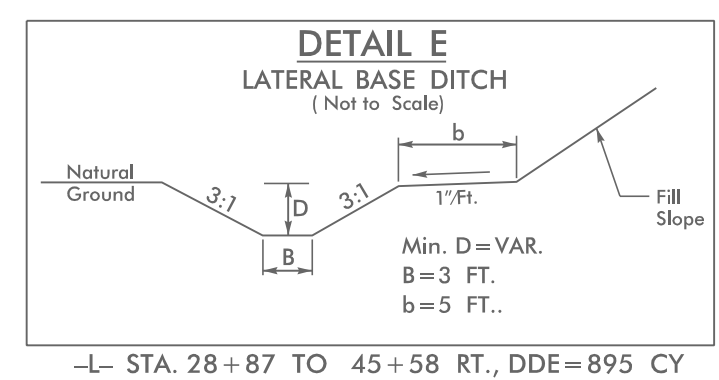
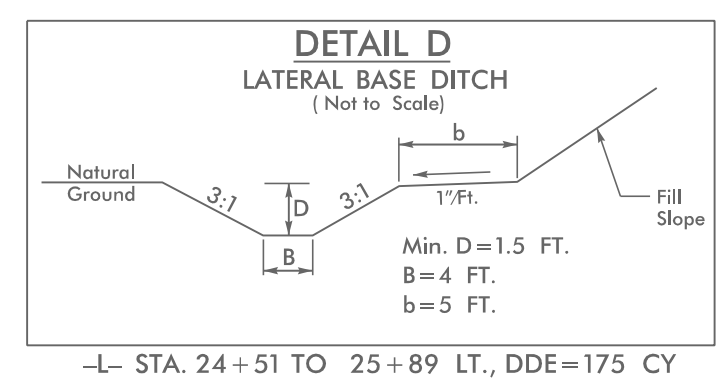
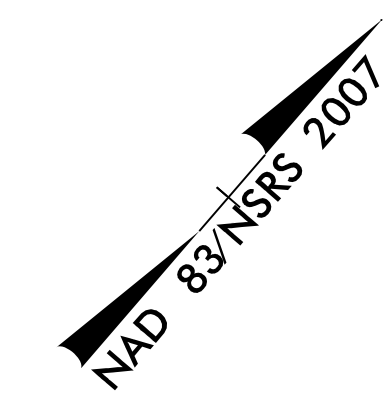

MATCHLINE UO 2 -L- STA. 23+00.00

MATCHLINE UO 4 -L- STA. 37+00.00

- NOTES:**
1. DUKE ENERGY PROGRESS WILL STAY ON EXISTING POLE LINE AND ARE STARTING NEW ALIGNMENT THIS SHEET
  2. ALL CENTURYLINK UNDERGROUND TELEPHONE AND FIBER OPTIC IS TO BE ABANDONED IN PLACE. ALSO, CENTURYLINK TO BORE MINIMUM 15' BELOW WETLAND AND JURISDICTIONAL AREAS.
  3. TIME WARNER CABLE ABANDONED IN PLACE UNDERGROUND FACILITIES AS NOTED

<p><b>UTILITY OWNERS ON THIS SHEET</b></p>	<p><b>PLANS PREPARED BY :</b></p>
<p>DUKE ENERGY PROGRESS - POWER                  CENTURYLINK - TELEPHONE AND FIBER OPTIC                  TIME WARNER - CATV</p>	<p><b>RK&amp;K</b>                  RUMMEL, KLEPPER &amp; KAHL, LLP                  900 RIDGEFIELD DRIVE SUITE 350                  RALEIGH, NORTH CAROLINA 27609-3960                  NC LICENSE NO. F-0112 • (919) 878-9560</p>

3-22-24-38-39-22-2  
 58-00-17-00-5