

| | |
|---|--|
| PROJECT REFERENCE NO. R-2514B | SHEET NO. 13 |
| RW SHEET NO. | HYDRAULICS ENGINEER |
| ROADWAY DESIGN ENGINEER SEAL 033871 DANIEL W. GARDNER, JR. 4/15/2015 | HYDRAULICS ENGINEER SEAL 019660 PAUL ATKINSON 4/15/2015 |

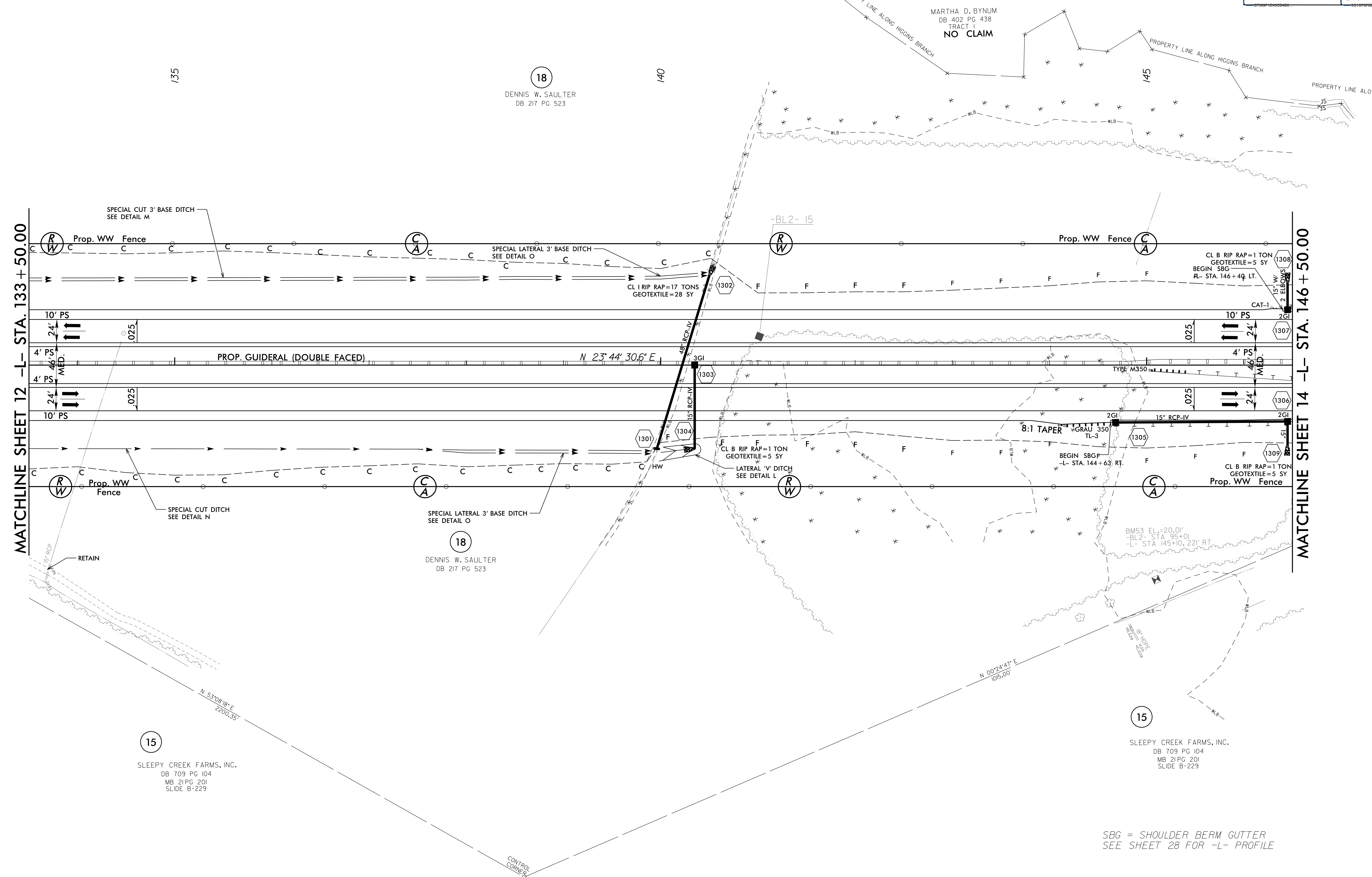
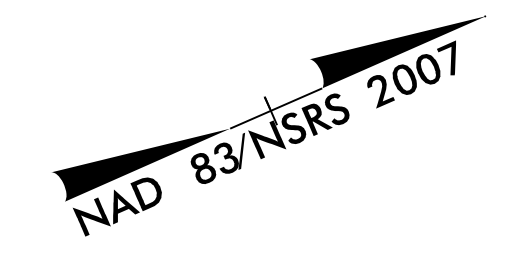
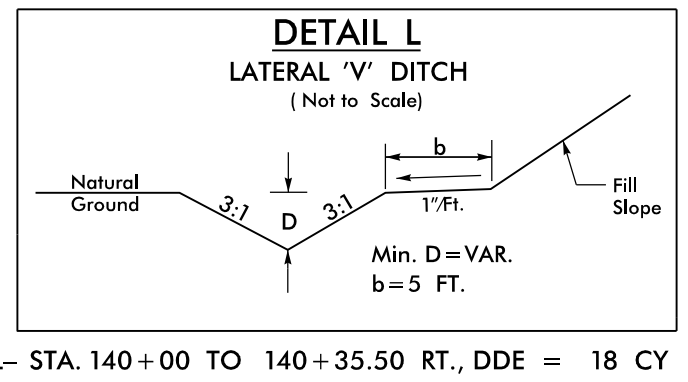
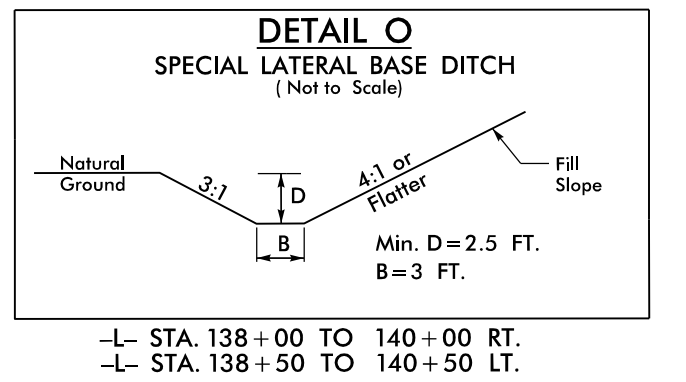
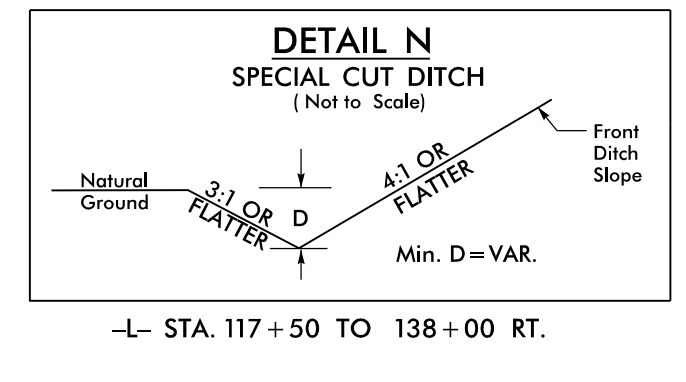
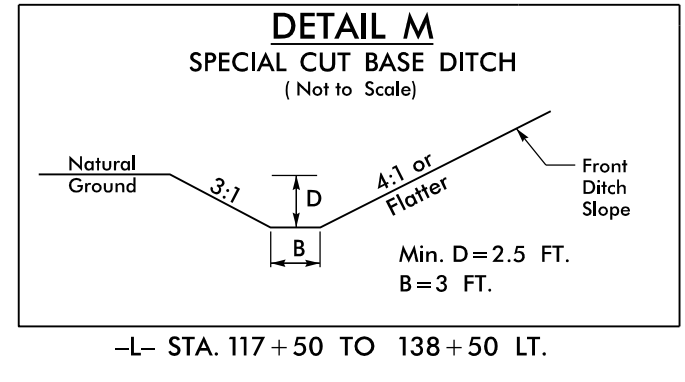

MATCHLINE SHEET 12 -L- STA. 133 + 50.00

MATCHLINE SHEET 14 -L- STA. 146 + 50.00

REVISIONS

3/26/2015 F:\3622015\01\Cadd\2514B\Roadway\Proc\NR2514B_Hy_psh13.dgn

15
SLEEPY CREEK FARMS, INC.
DB 709 PG 104
MB 21PG 201
SLIDE B-229

18
DENNIS W. SAULTER
DB 217 PG 523

15
SLEEPY CREEK FARMS, INC.
DB 709 PG 104
MB 21PG 201
SLIDE B-229

SBG = SHOULDER BERM GUTTER
SEE SHEET 28 FOR -L- PROFILE