

BM29 RR SPIKE IN 9" PINE AT STATION 559+85.00 -L-; 329' LT., ELEVATION = 37.70'

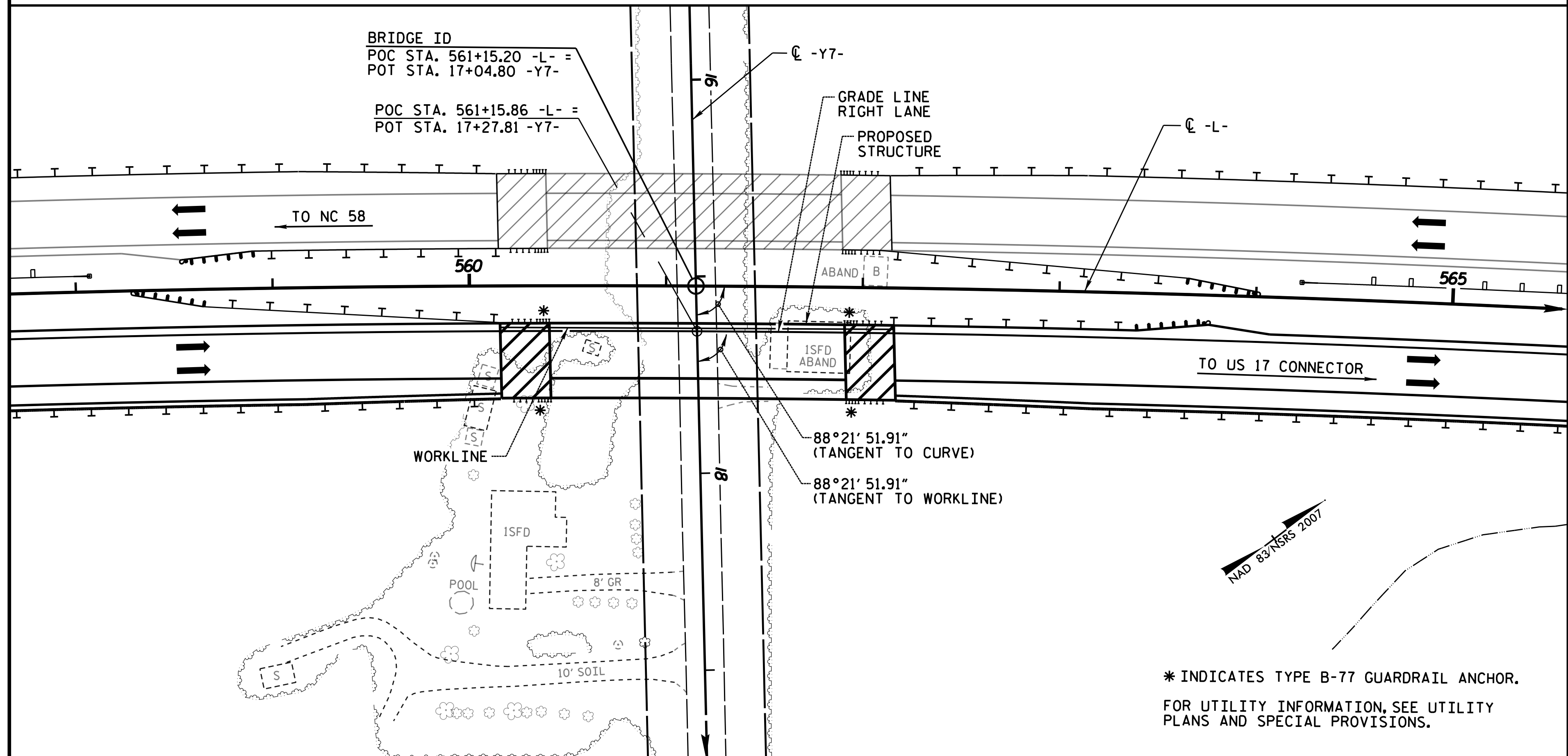

LOCATION SKETCH

NOTES

- ASSUMED LIVE LOAD = HL-93 OR ALTERNATE LOADING.
- THIS BRIDGE HAS BEEN DESIGNED IN ACCORDANCE WITH THE REQUIREMENTS OF THE AASHTO LRFD BRIDGE DESIGN SPECIFICATIONS.
- THIS BRIDGE IS LOCATED IN SEISMIC ZONE 1.
- FOR SUBMITTAL OF WORKING DRAWINGS, SEE SPECIAL PROVISIONS.
- FOR FALSEWORK AND FORMWORK, SEE SPECIAL PROVISIONS.
- FOR CRANE SAFETY, SEE SPECIAL PROVISIONS.
- FOR GROUT FOR STRUCTURES, SEE SPECIAL PROVISIONS.
- FOR OTHER DESIGN DATA AND GENERAL NOTES, SEE SHEET SN.
- FOR EROSION CONTROL MEASURES, SEE EROSION CONTROL PLANS.
- REMOVABLE FORMS MAY BE USED IN LIEU OF METAL STAY-IN-PLACE FORMS IN ACCORDANCE WITH ARTICLE 420-3 OF THE STANDARD SPECIFICATIONS.
- NEEDLE BEAMS WILL NOT BE ALLOWED UNLESS OTHERWISE CALLED FOR ON THE PLANS OR APPROVED BY THE ENGINEER.
- FOR PLACING LOAD ON STRUCTURE MEMBERS, SEE SPECIAL PROVISIONS.
- THE ELEVATION AND CLEARANCE SHOWN ON THE PLANS AT THE POINT OF MINIMUM VERTICAL CLEARANCE IS FROM THE BEST INFORMATION AVAILABLE. PRIOR TO BEGINNING BRIDGE CONSTRUCTION, VERIFY THE ELEVATION ON THE EXISTING PAVEMENT AND CHECK THE CLEARANCE. REPORT ANY VARIATIONS TO THE ENGINEER. ANY PLAN REVISION NECESSARY TO ACHIEVE THE REQUIRED MINIMUM VERTICAL CLEARANCE WILL BE PROVIDED BY THE DEPARTMENT.
- FOR MAINTENANCE AND PROTECTION OF TRAFFIC BENEATH PROPOSED STRUCTURE, SEE SPECIAL PROVISIONS.
- PRESTRESSED CONCRETE DECK PANELS MAY BE USED IN LIEU OF METAL STAY-IN-PLACE FORMS IN ACCORDANCE WITH ARTICLE 420-3 OF THE STANDARD SPECIFICATIONS.
- OBSERVE A TWO MONTH WAITING PERIOD AFTER CONSTRUCTING THE EMBANKMENT TO FINISHED GRADE BEFORE BEGINNING END BENT CONSTRUCTION AT END BENT NO. 1 AND END BENT NO. 2 (STAGE 2 WAITING PERIOD). SEE ROADWAY PLAN TITLED "DETAILS FOR GEOTEXTILE FOR EMBANKMENT STABILIZATION AND STAGE CONSTRUCTION AT -Y7- BRIDGE APPROACHES".

* INDICATES TYPE B-77 GUARDRAIL ANCHOR.
FOR UTILITY INFORMATION, SEE UTILITY PLANS AND SPECIAL PROVISIONS.

TOTAL BILL OF MATERIAL

	PDA TESTING	REINFORCED CONCRETE DECK SLAB	GROOVING BRIDGE FLOORS	CLASS A CONCRETE	BRIDGE APPROACH SLABS	REINFORCING STEEL	54" PRESTRESSED CONCRETE GIRDERS		HP 12 X 53 STEEL PILES		PILE REDRIVES	CONCRETE BARRIER RAIL	4" SLOPE PROTECTION	ELASTOMERIC BEARINGS
	EACH	SQ. FT.	SQ. FT.	CU. YDS.	LUMP SUM	LBS.	NO.	LIN. FEET	NO.	LIN. FT.	EACH	LIN. FT.	SQ. YDS.	LUMP SUM
SUPERSTRUCTURE	-	3597	4782	-	-	-	4	339.33	-	-	-	170.00	-	LUMP SUM
END BENT NO. 1	-	-	-	29.8	-	3958	-	-	8	600	4	-	246	-
END BENT NO. 2	-	-	-	29.8	-	3958	-	-	8	600	4	-	251	-
TOTAL	1	3597	4782	59.6	LUMP SUM	7916	4	339.33	16	1200	8	170.00	497	LUMP SUM

PROJECT NO. R-2514D
JONES COUNTY
STATION: 561+15.20 -L-
=17+04.80 -Y7-

SHEET 3 OF 3

DocuSigned by:
Mark Gustafson
9E00EDB87408456...
3/23/2015

PLAN PREPARED BY:



ALPHA & OMEGA GROUP
CIVIL & STRUCTURAL ENGINEERS
4601 Lake Boone Trail, Ste. 3C Raleigh, NC 27607
Phone 919 981 0310 Fax 919 981 0451
Firm License No. C-1684 www.aogroup.com
A&O PROJECT NO. 2013.044



STATE OF NORTH CAROLINA
DEPARTMENT OF TRANSPORTATION
RALEIGH

GENERAL DRAWING
BRIDGE OVER SR 1330
ON US 17
BETWEEN NC 58
& US 17 CONNECTOR
(RIGHT LANE)

REVISIONS						SHEET NO.
NO.	BY:	DATE:	NO.	BY:	DATE:	
1			3			TOTAL SHEETS
2			4			21

REFERENCE NO. 14- 3

DRAWN BY: JD GOODIN DATE: 5/16/14
CHECKED BY: MEG / JWT DATE: 6/23/14
OC / QA BY: TG ZEBLO DATE: 7/7/14

STRUCTURE NO. 14