

■ VERTICAL CLEARANCE IS CALCULATED BASED ON EXISTING PAVEMENT ELEVATIONS AND 1/2" OVERLAY

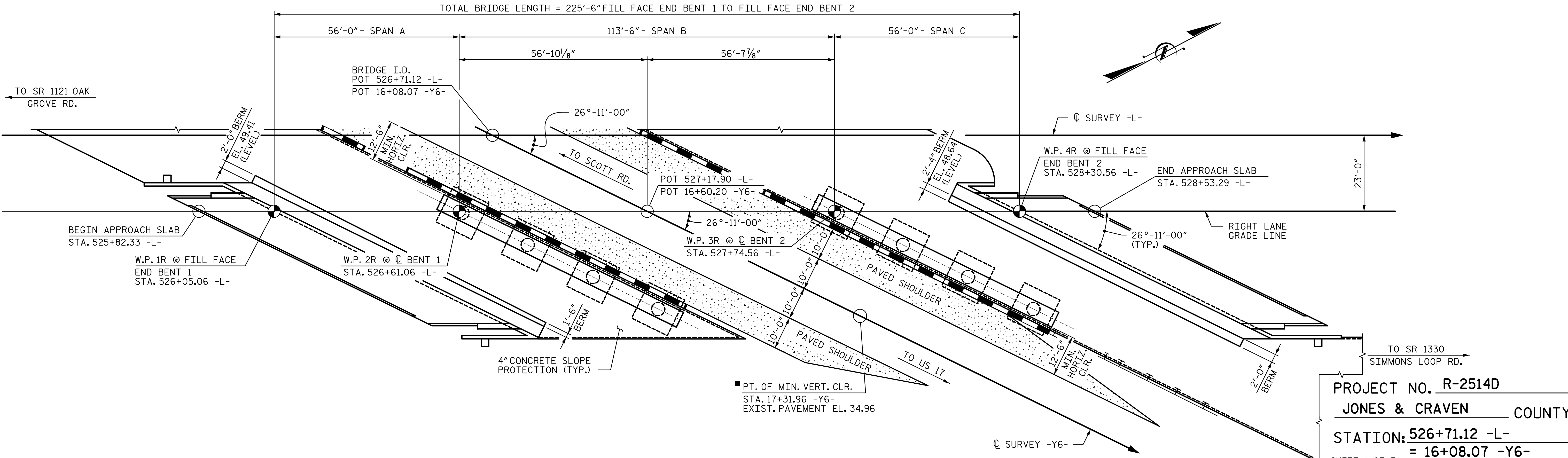

**PLAN**  
 (PILES NOT SHOWN FOR CLARITY)

DocuSigned by:  
 Kevin G. Bailey  
 4625EEC0F794401...

DocuSigned by:  
 Adam J. Peter  
 E3F8AF8D964742A...

**NORTH CAROLINA PROFESSIONAL SEAL**  
 28479  
 ENGINEER  
 KEVIN G. BAILEY  
 3/10/2015

**NORTH CAROLINA PROFESSIONAL SEAL**  
 35695  
 ENGINEER  
 ADAM J. PETER  
 3/10/2015

PROJECT NO. R-2514D  
 JONES & CRAVEN COUNTY  
 STATION: 526+71.12 -L-  
 = 16+08.07 -Y6-  
 SHEET 1 OF 3 BRIDGE NO. 106

STATE OF NORTH CAROLINA  
 DEPARTMENT OF TRANSPORTATION  
 RALEIGH

**GENERAL DRAWING**  
 FOR BRIDGE ON US 17 OVER  
 TEN MILE FORK RD. (SR 1002)  
 BETWEEN SR 1121 AND SR 1330  
 -RIGHT LANE-

DRAWN BY: CLG DATE: 6-14  
 CHECKED BY: TJT DATE: 6-14  
 DESIGN ENGINEER OF RECORD: T. TOWNSEND DATE: 6-14

STV / Ralph Whitehead Associates, Inc.  
 900 West Trade Street, Suite 715  
 Charlotte, NC 28202  
 NC License Number F-0991

REVISIONS				SHEET NO.
NO.	BY:	DATE:	NO.	DATE:
1			3	
2			4	

TOTAL SHEETS: 38

R:\Site 6\usta\Finals\Site 6 RL\12\_001\_R2514D\_SMU\_CD01.dgn  
 8:52:54 AM  
 3/9/2015