

I:\Projects\255550\255550_0002\50_Deliverables & Submittals\R-2514D\Structures\Site 5\usta\Finals\Site 5 RL\410_007_R2514D_SMU_POS.dgn 4/10/2015 9:22:31 AM

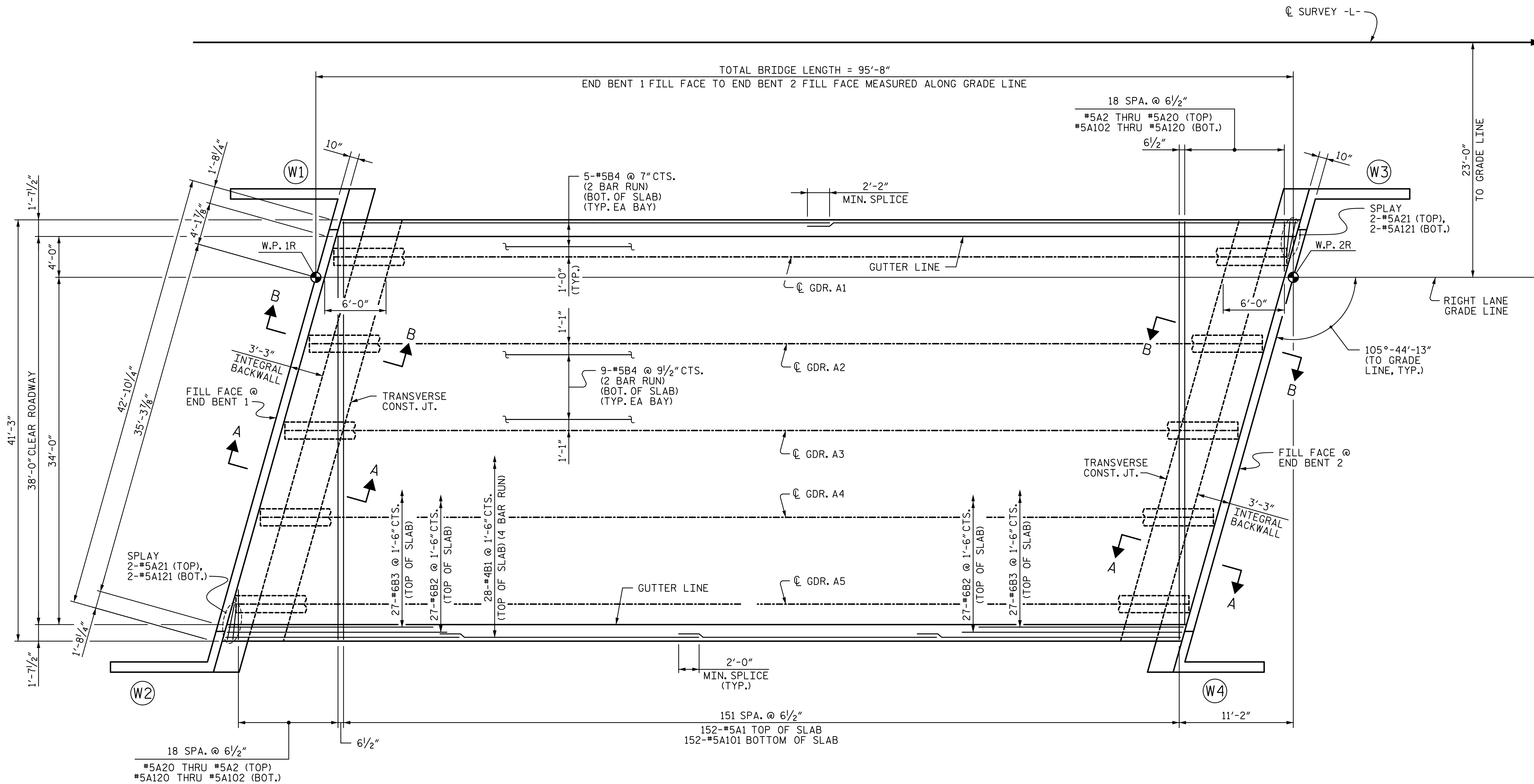

SPAN A

NOTES:

- FOR CONCRETE BARRIER RAIL DIMENSIONS, REINFORCEMENT AND JOINT SPACING, SEE "CONCRETE BARRIER RAIL" SHEET.
- FOR POURING SEQUENCE, SEE "SUPERSTRUCTURE BILL OF MATERIAL" SHEET.
- FOR SECTION A-A, B-B, & TRANSVERSE CONST. JOINT IN DECK SLAB, SEE "SUPERSTRUCTURE DETAILS" SHEET.
- FOR SPACING OF TOP AND BOTTOM "B" BARS, SEE "TYPICAL SECTION AND INTEGRAL BACKWALL" SHEET.
- DIMENSIONS TO CONSTRUCTION JOINTS ARE MEASURED ALONG THE GRADE LINE.

PROJECT NO. R-2514D

JONES & CRAVEN COUNTY

STATION: 428+53.58 -L-
= 13+04.09 -Y5-

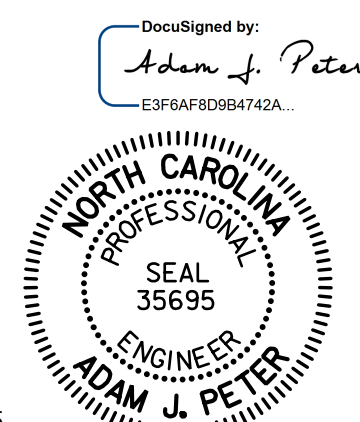

4/10/2015

STATE OF NORTH CAROLINA
DEPARTMENT OF TRANSPORTATION
RALEIGH
SUPERSTRUCTURE
PLAN OF SPAN
-RIGHT LANE-

DRAWN BY: <u>VMW</u>	DATE: <u>6-14</u>	DESIGN ENGINEER OF RECORD: <u>A. PETER</u>	DATE: <u>6-14</u>
CHECKED BY: <u>MLO</u>	DATE: <u>6-14</u>		

STV / Ralph Whitehead Associates, Inc.
900 West Trade Street, Suite 715
Charlotte, NC 28202
NC License Number F-0991

REVISIONS				SHEET NO.
NO.	BY:	DATE:	NO.	DATE:
1			3	
2			4	

TOTAL SHEETS: 24