

**SECTION ALONG RIGHT LANE GRADE LINE**  
(SECTIONS AT RIGHT ANGLES TO END BENTS)

■ VERTICAL CLEARANCE IS CALCULATED BASED ON EXISTING PAVEMENT ELEVATIONS AND 1/2" OVERLAY

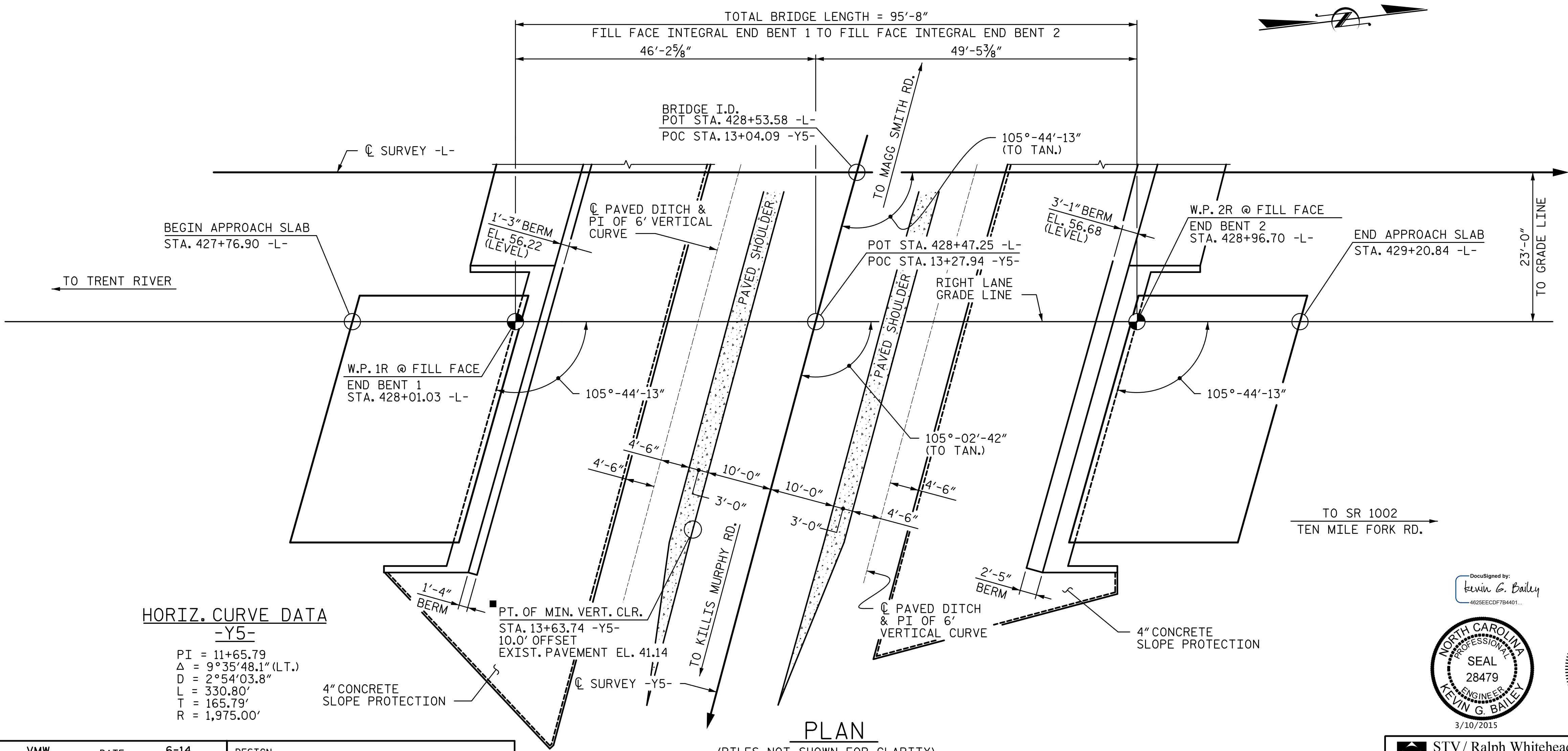

**PLAN**  
(PILES NOT SHOWN FOR CLARITY)

**HORIZ. CURVE DATA**  
-Y5-  
PI = 11+65.79  
Δ = 9°35'48.1" (LT.)  
D = 2°54'03.8"  
L = 330.80'  
T = 165.79'  
R = 1,975.00'

DRAWN BY: **VMW** DATE: **6-14**  
CHECKED BY: **MLO** DATE: **6-14**  
DESIGN ENGINEER OF RECORD: **A. PETER** DATE: **6-14**

DocuSigned by:  
**Kevin G. Bailey**  
4026ECCDF7B4401...  
3/10/2015

DocuSigned by:  
**Adam J. Peter**  
E3F8AF8D0B4742A...  
3/10/2015

**NORTH CAROLINA**  
PROFESSIONAL  
SEAL  
28479  
ENGINEER  
**KEVIN G. BAILEY**  
3/10/2015

**NORTH CAROLINA**  
PROFESSIONAL  
SEAL  
35695  
ENGINEER  
**ADAM J. PETER**  
3/10/2015

PROJECT NO. **R-2514D**  
**JONES & CRAVEN** COUNTY  
STATION: **428+53.58 -L-**  
**= 13+04.09 -Y5-**  
SHEET 1 OF 3 BRIDGE NO. 104

STATE OF NORTH CAROLINA  
DEPARTMENT OF TRANSPORTATION  
RALEIGH

**GENERAL DRAWING**  
FOR BRIDGE ON US 17 OVER  
OAK GROVE RD. (SR 1121) BETWEEN  
TRENT RIVER AND SR 1002  
**-RIGHT LANE-**

REVISIONS				SHEET NO.
NO.	BY:	DATE:	NO.	DATE:
1			3	
2			4	

TOTAL SHEETS: 24

**STV / Ralph Whitehead Associates, Inc.**  
900 West Trade Street, Suite 715  
Charlotte, NC 28202  
NC License Number F-0991