

BM #20 - RR SPIKE SET IN 16" HARDWOOD, -L- STA. 394+12.00, 243.00' RT., ELEV. 3.92

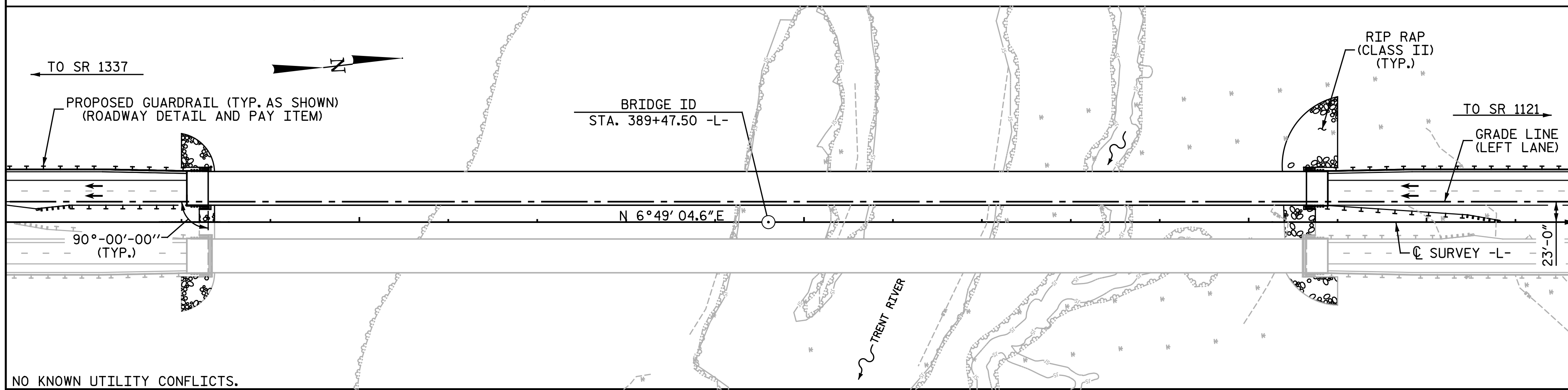

NO KNOWN UTILITY CONFLICTS.

LOCATION SKETCH

TOTAL BILL OF MATERIAL

	CONSTRUCTION, MAINTENANCE & REMOVAL OF TEMP. ACCESS AT STA. 389+47.50 -L-	PDA TESTING	REINFORCED CONCRETE DECK SLAB	GROOVING BRIDGE FLOORS	CLASS A CONCRETE	BRIDGE APPROACH SLABS STA. 389+47.50	REINFORCING STEEL	54" PRESTRESSED CONCRETE GIRDERS		12" PRESTRESSED CONCRETE PILES		PP 24 x 0.50 GALVANIZED STEEL PILES		PP 30 x 0.50 GALVANIZED STEEL PILES		PIPE PILE PLATES	PREDRILLING FOR PILES	PILE DRIVES	CONCRETE BARRIER RAIL	RIP RAP CLASS II (2'-0" THICK)	GEOTEXTILE FOR DRAINAGE	ELASTOMERIC BEARINGS	EXPANSION JOINT SEALS	
								LUMP SUM	EA.	SQ. FT.	SQ. FT.	CU. YDS.	LUMP SUM	LBS.	No.									LIN. FT.
SUPERSTRUCTURE			50,857	44,691				65	6112.1										2,505.8					
END BENT 1					48.2		7,311		9	450							4		330	367				
BENT 1					26.6		4,839				7	315		7			4							
BENT 2					26.6		4,839				7	315		7			4							
BENT 3					26.6		4,839				7	315		7			4							
BENT 4					26.6		4,839				7	315		7			4							
BENT 5					26.6		4,839				7	315		7			4							
BENT 6					26.6		4,839				7	350		7			4							
BENT 7					26.6		4,839				7	420		7			4							
BENT 8					31.9		4,836						6	390	6		4							
BENT 9					31.9		4,836						6	390	6		4							
BENT 10					26.6		4,839				7	455		7			4							
BENT 11					26.6		4,839				7	455		7			4							
BENT 12					26.6		4,839				7	455		7			4							
END BENT 2					48.2		7,311		9	450						4		845	939					
CONTINGENCY																	2580							
TOTAL	LUMP SUM	5	50,857	44,691	426.2	LUMP SUM	72,684	65	6112.1	18	900	70	3,710	12	780	82	2580	56	2,505.8	1175	1306	LUMP SUM	LUMP SUM	

NOTES:

- ASSUMED LIVE LOAD = HL-93 OR ALTERNATE LOADING
- FOR OTHER DESIGN DATA AND GENERAL NOTES, SEE SHEET SN.
- THIS BRIDGE HAS BEEN DESIGNED IN ACCORDANCE WITH THE AASHTO LRFD BRIDGE DESIGN SPECIFICATIONS.
- THIS BRIDGE IS LOCATED IN SEISMIC ZONE 1.
- FOR SUBMITTAL OF WORKING DRAWINGS, SEE SPECIAL PROVISIONS.
- FOR FALSEWORK AND FORMWORK, SEE SPECIAL PROVISIONS.
- FOR GROUT FOR STRUCTURES, SEE SPECIAL PROVISIONS.
- FOR CRANE SAFETY, SEE SPECIAL PROVISIONS.
- FOR EROSION CONTROL MEASURES, SEE EROSION CONTROL PLANS.
- THIS STRUCTURE HAS BEEN DESIGNED IN ACCORDANCE WITH "HEC 18-EVALUATING SCOUR AT BRIDGES".
- FOR INTERIOR BENTS 1 THRU 12, ONLY PARTIAL GALVANIZING OF THE PILES IS REQUIRED. SEE INTERIOR BENT SHEETS FOR REQUIRED GALVANIZED LENGTHS. PAYMENT FOR PARTIALLY GALVANIZED PILES WILL BE MADE UNDER THE CONTRACT UNIT PRICE FOR GALVANIZED STEEL PILES.
- FOR SECURING OF VESSELS, SEE SPECIAL PROVISIONS.
- REMOVABLE FORMS MAY BE USED IN LIEU OF METAL STAY-IN-PLACE FORMS IN ACCORDANCE WITH ARTICLE 420-3 OF THE STANDARD SPECIFICATIONS.
- NEEDLE BEAMS WILL NOT BE ALLOWED UNLESS OTHERWISE CALLED FOR ON THE PLANS OR APPROVED BY THE ENGINEER.
- FOR PLACING LOAD ON STRUCTURE MEMBERS, SEE SPECIAL PROVISIONS.
- THE CONTRACTOR WILL BE REQUIRED TO CONSTRUCT, MAINTAIN AND AFTERWARDS REMOVE A TEMPORARY STRUCTURE AT STATION 389+47.50 -L- FOR USE DURING CONSTRUCTION OF THE PROPOSED STRUCTURE. FOR CONSTRUCTION, MAINTENANCE AND REMOVAL OF TEMPORARY STRUCTURE, SEE SPECIAL PROVISIONS.

PROJECT NO. R-2514D
JONES COUNTY
 STATION: 389+47.50 -L-

SHEET 5 OF 5

nbspeaks 3/5/2015 4:09:47 PM
 File Name: Y:\Projects\NCDDOT\R-2514D\Site 4\Drawings\Left\Final\407_005_R2514D_SMLLS01.dgn

DRAWN BY: N. B. SPEAKS DATE: 7-12-13
 CHECKED BY: A. M. HOUSTON DATE: 7-18-13

DWG. 5 OF 68

DocuSigned by:
Andrew Phillips
5752848F5084459...
3/13/2015

DocuSigned by:
Dwan Hathaway
283786071DA0460...
3/13/2015

Michael Baker Engineering
8000 Regency Parkway, Suite 600
Cary, North Carolina 27518
NC License No.: F-1084

STATE OF NORTH CAROLINA
 DEPARTMENT OF TRANSPORTATION
 RALEIGH

GENERAL DRAWING
 BRIDGE OVER TRENT RIVER ON
 US17 BETWEEN SR 1337 & SR 1121
 LEFT LANE

REVISIONS						SHEET NO.
NO.	BY:	DATE:	NO.	BY:	DATE:	SHEET NO.
1			3			TOTAL SHEETS
2			4			68