

**SECTION A-A**

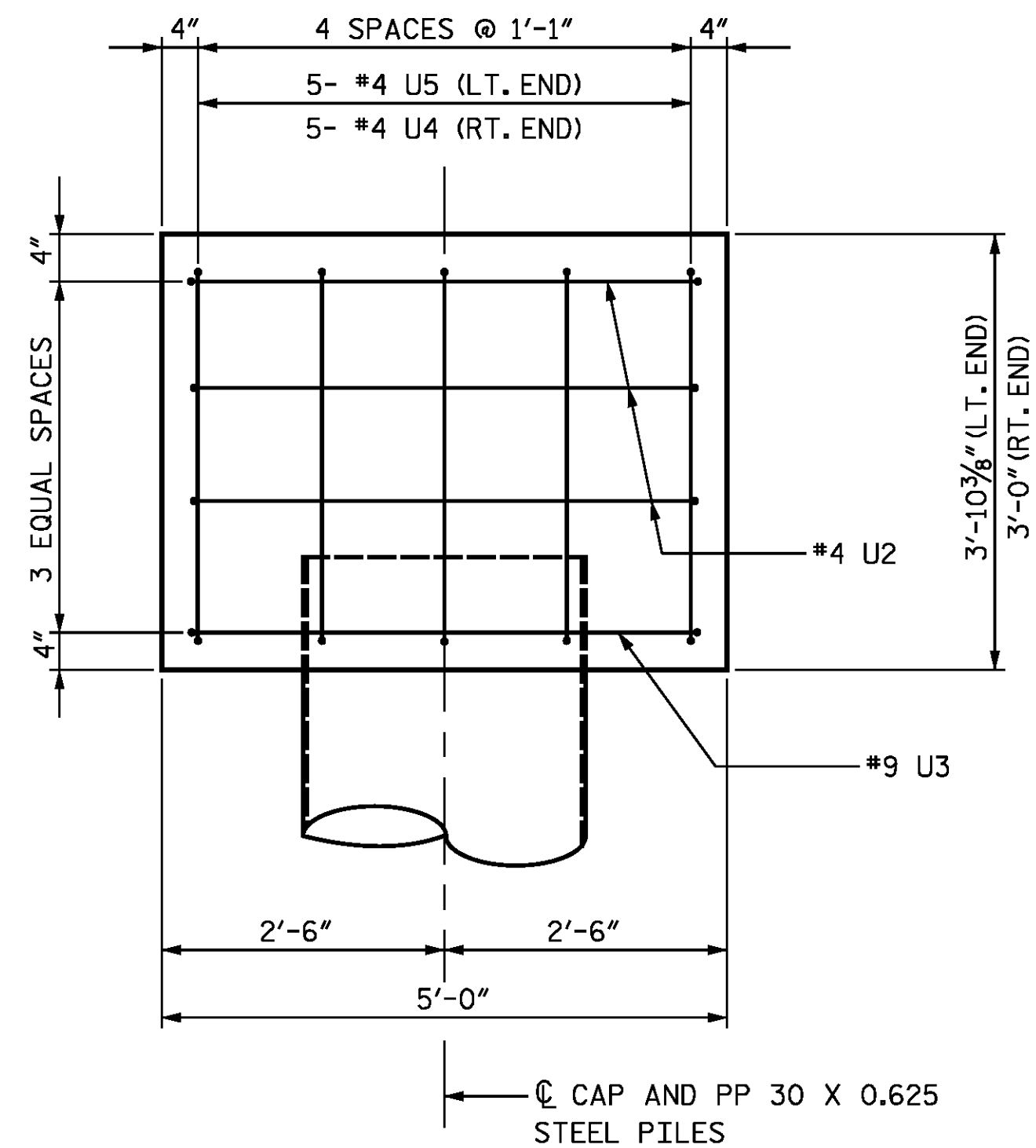

**END OF CAP VIEW B-B**  
(TYP. EA. END)

**BAR TYPES**

ALL BAR DIMENSIONS ARE OUT TO OUT.

BILL OF MATERIAL FOR ONE BENT					
BAR	NO.	SIZE	TYPE	LENGTH	WEIGHT
B1	7	9		31'-3"	744
B2	6	10	STR.	38'-8"	998
B3	10	4	STR.	20'-7"	137
B4	2	6	STR.	38'-8"	116
B5	10	4	STR.	4'-8"	31
B6	7	4	STR.	12'-6"	58
B7	7	9	1	16'-11"	403
B8	7	4	STR.	4'-2"	19
B9	2	4	STR.	11'-1"	15
S1	40	5	2	10'-2"	424
S2	28	5	2	11'-4"	331
S3	12	4	3	12'-3"	98
U1	34	4	4	7'-8"	174
U2	6	4	4	7'-6"	30
U3	2	9	4	11'-10"	80
U4	5	4	4	5'-6"	18
U5	5	4	4	6'-0"	20
REINFORCING STEEL, LBS.					3696
CLASS A CONCRETE, CU. YD.					23.1
PP 30 X 0.625 GALVANIZED STEEL PILES					
NO.					6
LIN. FT.					510
STEEL PILE POINTS, EA.					6
PILE REDRIVES, EA.					3
(NOTE: PILE HEADS HAVE BEEN DEDUCTED FROM CLASS A CONCRETE)					

PROJECT NO. R-2514D  
JONES COUNTY  
 STATION: 373+02.50 -L-

SHEET 2 OF 2

STATE OF NORTH CAROLINA  
 DEPARTMENT OF TRANSPORTATION  
 RALEIGH

**SUBSTRUCTURE**  
**BENT 1-4**

RIGHT LANE STR-#6

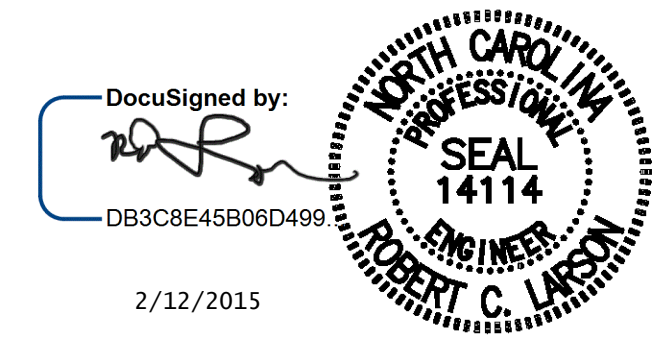

DocuSigned by:  
 DB3C8E45B06D499  
 2/12/2015

DESIGN ENGINEER OF RECORD: DATE : 2/12/2015  
 DRAWN BY : Z. SU DATE : 03/01/14  
 CHECKED BY : R.C. LARSON DATE : 03/25/14

KCI Associates of North Carolina, P.A.  
 DWG. REF. NO. 26 OF 34

REVISIONS					
NO.	BY:	DATE:	NO.	BY:	DATE:
1			3		
2			4		

SHEET NO. S06-26  
 TOTAL SHEETS S06-34