

**SECTION A-A**

**BAR TYPES**

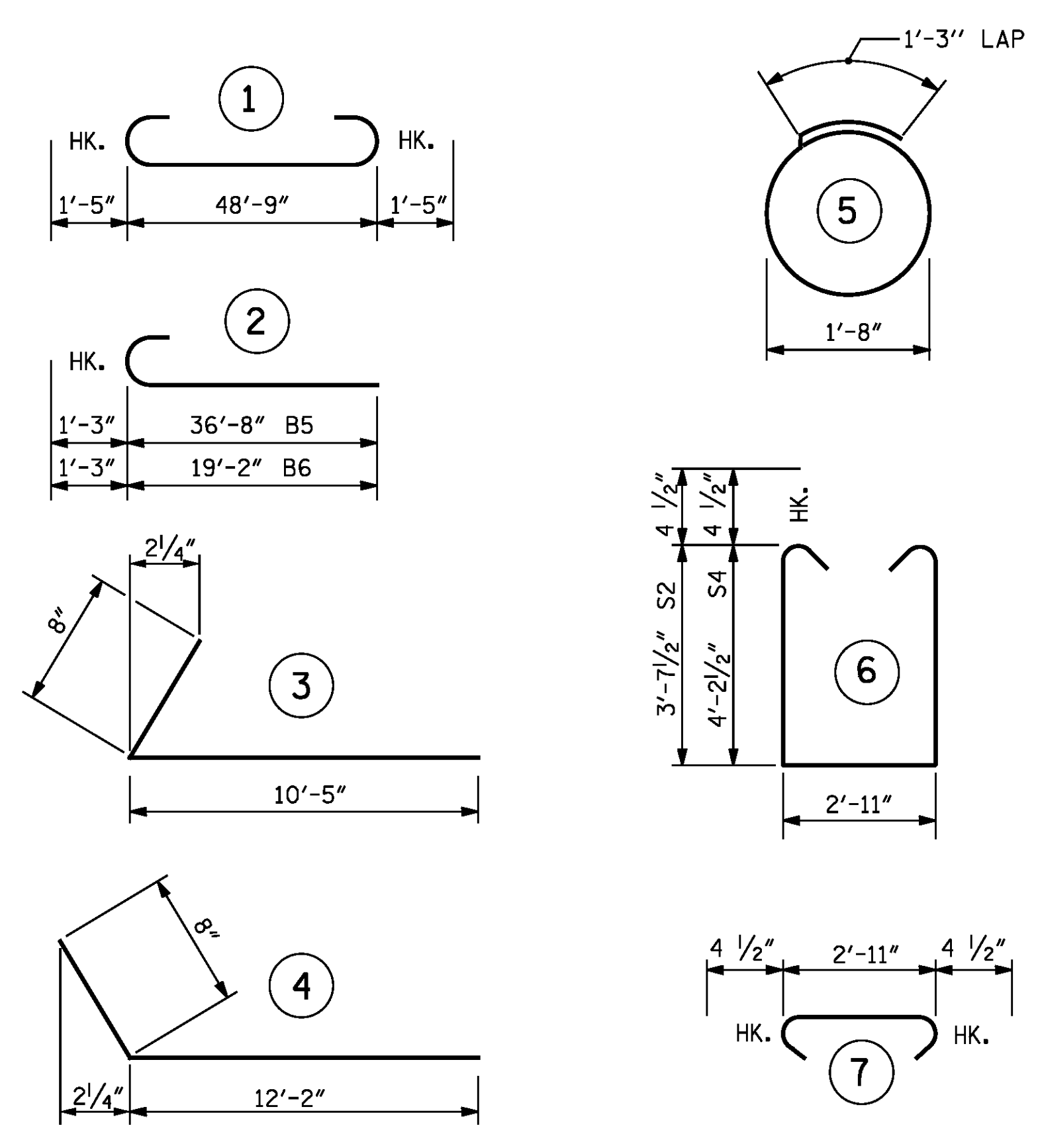

ALL BAR DIMENSIONS ARE OUT TO OUT.

**BILL OF MATERIAL**

END BENT 2					
BAR	NO.	SIZE	TYPE	LENGTH	WEIGHT
B1	4	10	1	51'-7"	888
B2	12	4	STR.	2'-11"	23
B3	28	4	STR.	25'-8"	480
B4	2	4	STR.	14'-7"	19
B5	5	9	2	37'-11"	645
B6	5	9	2	20'-5"	347
D1	62	4	STR.	6'-8"	276
H1	26	5	3	11'-1"	301
H2	42	6	4	12'-10"	810
K1	16	4	STR.	2'-9"	29
S1	28	4	5	6'-6"	122
S2	23	4	6	10'-11"	168
S3	38	4	7	3'-8"	93
S4	15	4	6	12'-0"	120
V1	28	4	STR.	9'-8"	181
V2	32	5	STR.	10'-7"	353
REINFORCING STEEL, LB					4855
CLASS A CONCRETE, CY POUR 1					30.5
(POUR 2 INCLUDED IN SUPERSTRUCTURE)					
HP 12X53 STEEL PILES NO.					7
LF					420
PILE REDRIVES, EA					3

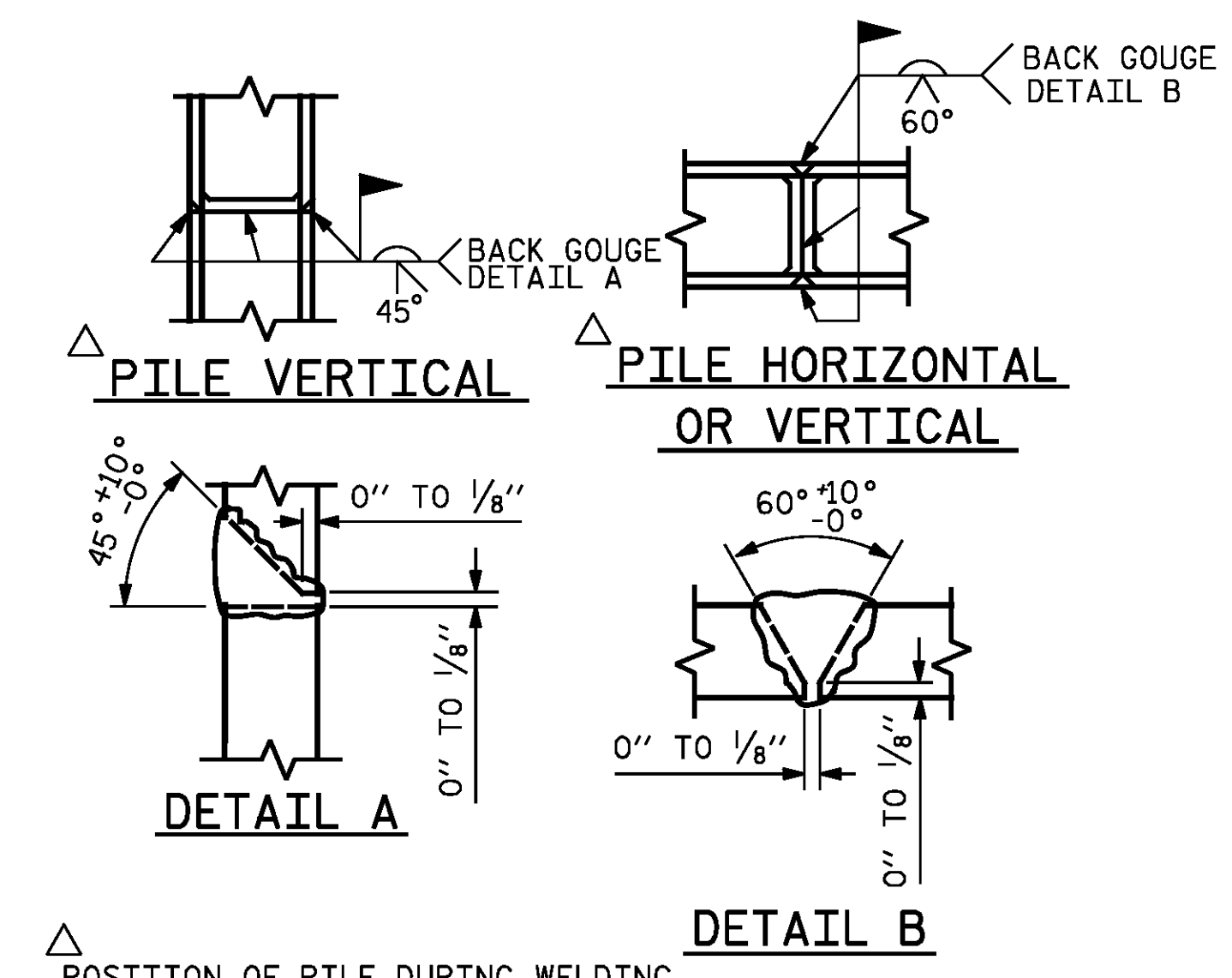

**PILE SPLICE DETAILS**

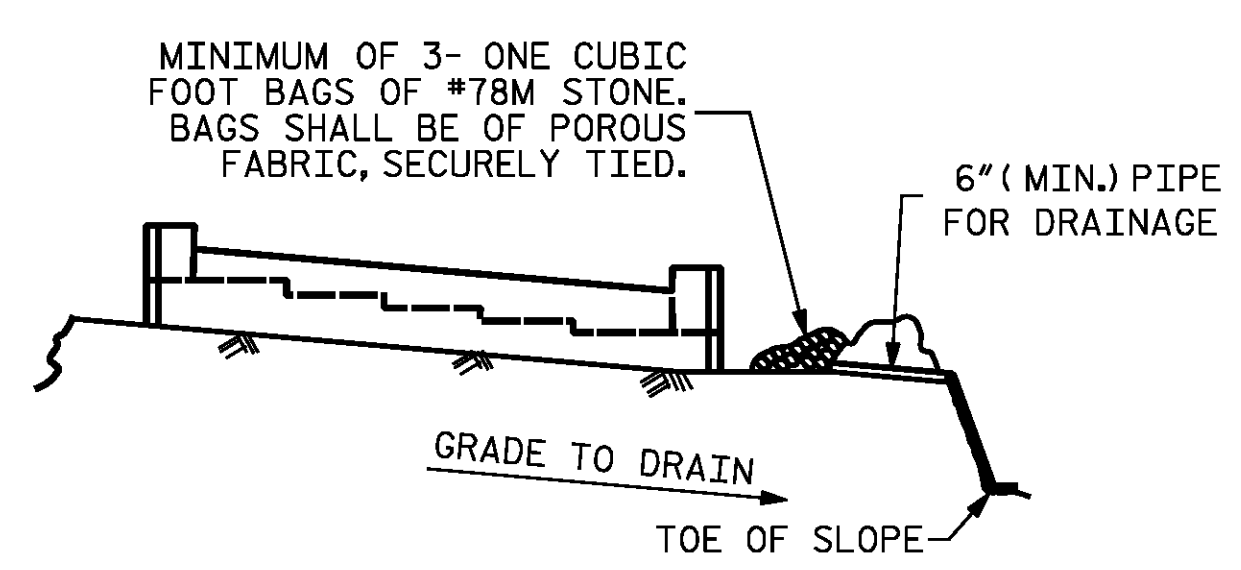

BAGGED STONE AND PIPE SHALL BE PLACED IMMEDIATELY AFTER COMPLETION OF END BENT EXCAVATION. PIPE MAY BE EITHER CONCRETE, CORRUGATED STEEL, CORRUGATED ALUMINUM ALLOY, OR CORRUGATED PLASTIC. PERFORATED PIPE WILL NOT BE ALLOWED.

BAGGED STONE SHALL REMAIN IN PLACE UNTIL THE ENGINEER DIRECTS THAT IT BE REMOVED. THE CONTRACTOR SHALL REMOVE AND DISPOSE OF SILT ACCUMULATIONS AT BAGGED STONE WHEN SO DIRECTED BY THE ENGINEER. BAGS SHALL BE REMOVED AND REPLACED WHENEVER THE ENGINEER DETERMINES THAT THEY HAVE DETERIORATED AND LOST THEIR EFFECTIVENESS.

NO SEPARATE PAYMENT WILL BE MADE FOR THIS WORK AND THE ENTIRE COST OF THIS WORK SHALL BE INCLUDED IN THE UNIT CONTRACT PRICE BID FOR THE SEVERAL PAY ITEMS.

**TEMPORARY DRAINAGE AT END BENT**

PROJECT NO. R-2514D  
JONES COUNTY  
 STATION: 363+38.90 -L-

SHEET 3 OF 3

STATE OF NORTH CAROLINA  
 DEPARTMENT OF TRANSPORTATION  
 RALEIGH

**SUBSTRUCTURE  
 END BENT 2**

RIGHT LANE STR-#4

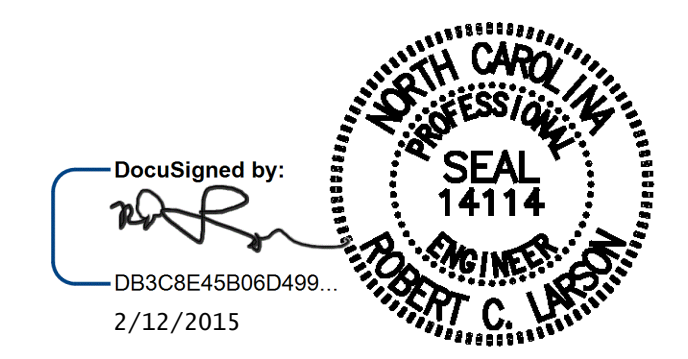

DocuSigned by:

DESIGN ENGINEER OF RECORD:	DATE : 2/12/2015
DRAWN BY : R. J. FLORY	DATE : 3/02/14
CHECKED BY : R. C. LARSON	DATE : 3/05/14

REVISIONS						SHEET NO. S04-20
NO.	BY:	DATE:	NO.	BY:	DATE:	
1			3			TOTAL SHEETS S04-23
2			4			

DWG. REF. NO. 20 OF 23