

**SECTION A-A**

\* THE TOP SURFACE OF THE CAP AND WINGS SHALL BE RAKED TO A DEPTH OF 1/4" EXCEPT THE BEARING AREAS AND CAP OUTSIDE OF SUPERSTRUCTURE.

**BAR TYPES**

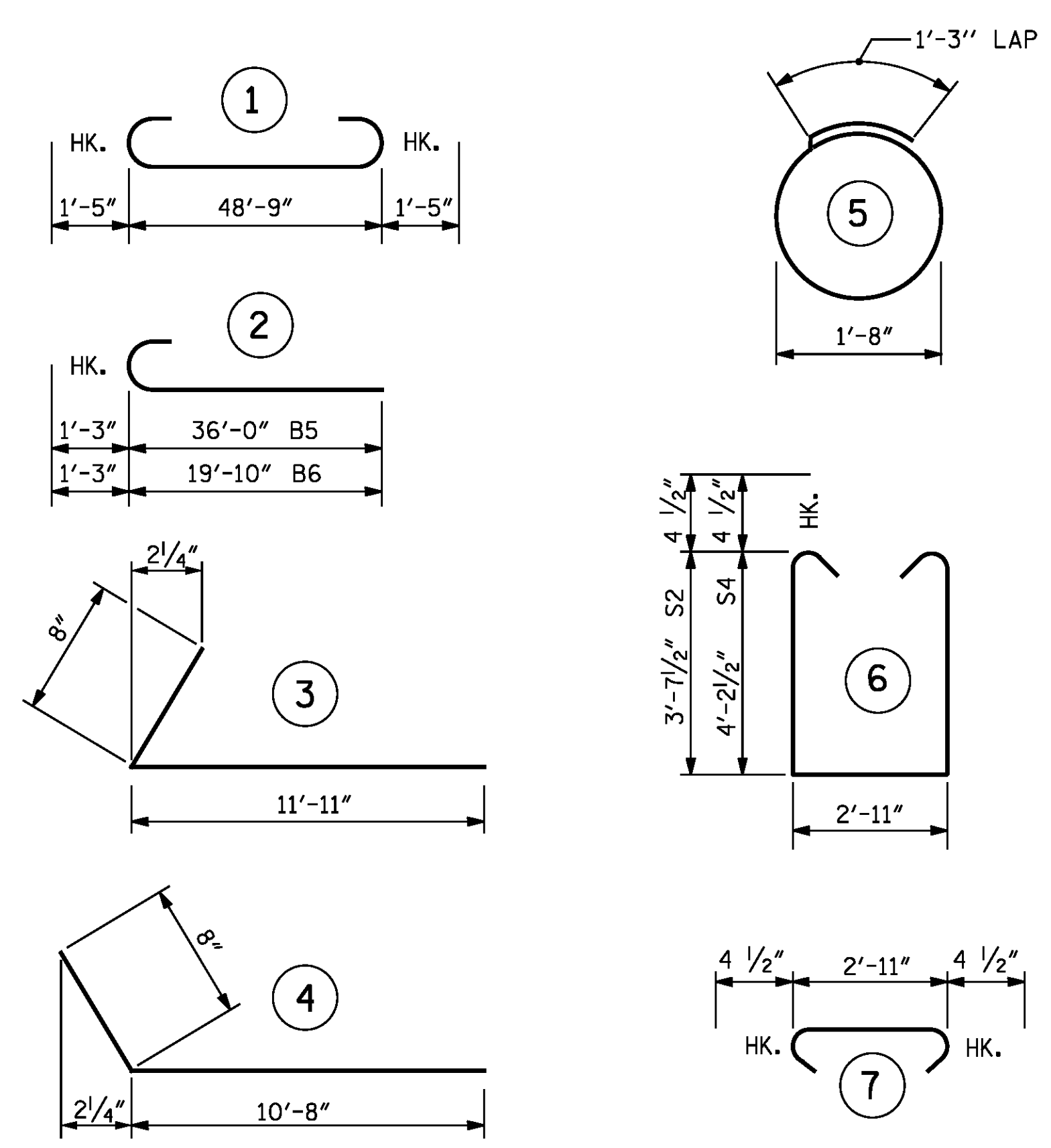

ALL BAR DIMENSIONS ARE OUT TO OUT.

**BILL OF MATERIAL**

END BENT 1					
BAR	NO.	SIZE	TYPE	LENGTH	WEIGHT
B1	4	10	1	51'-7"	888
B2	12	4	STR.	2'-11"	23
B3	28	4	STR.	25'-8"	480
B4	2	4	STR.	15'-3"	20
B5	5	9	2	37'-3"	633
B6	5	9	2	21'-1"	358
D1	62	4	STR.	6'-8"	276
H1	28	5	4	11'-4"	331
H2	44	6	3	12'-7"	832
K1	16	4	STR.	2'-9"	29
S1	28	4	5	6'-6"	122
S2	23	4	6	10'-11"	168
S3	38	4	7	3'-8"	93
S4	15	4	6	12'-1"	121
V1	28	4	STR.	9'-7"	179
V2	30	5	STR.	10'-8"	334
REINFORCING STEEL, LB					4887
CLASS A CONCRETE, CY POUR 1					30.6
(POUR 2 INCLUDED IN SUPERSTRUCTURE)					
HP 12X53 STEEL PILES					NO. 7
					LF 420
PILE REDRIVES, EA					4

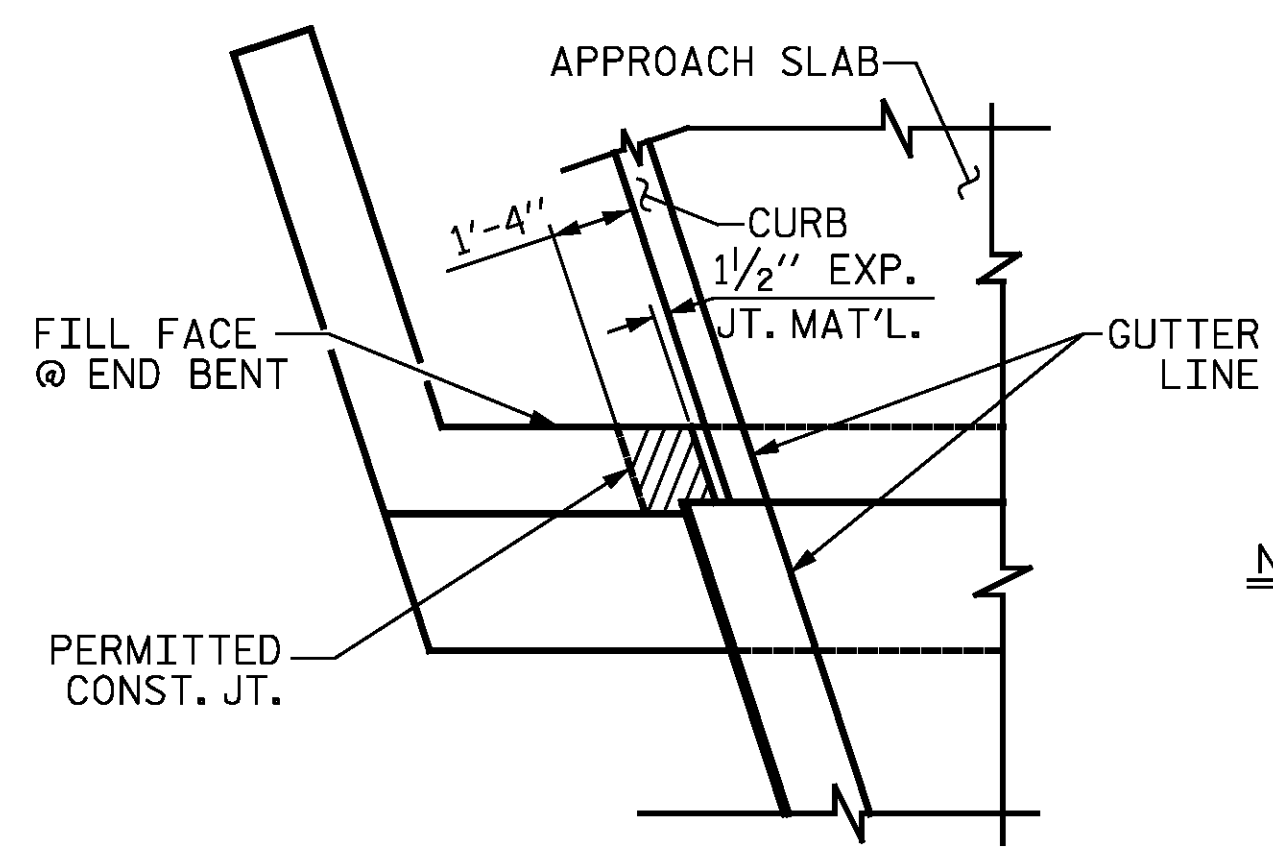

**PLAN**

**NOTE**  
THE CONCRETE IN THE SHADED AREA OF THE WING SHALL BE POURED AFTER THE BARRIER RAIL IS CAST IF SLIP FORMING IS USED.

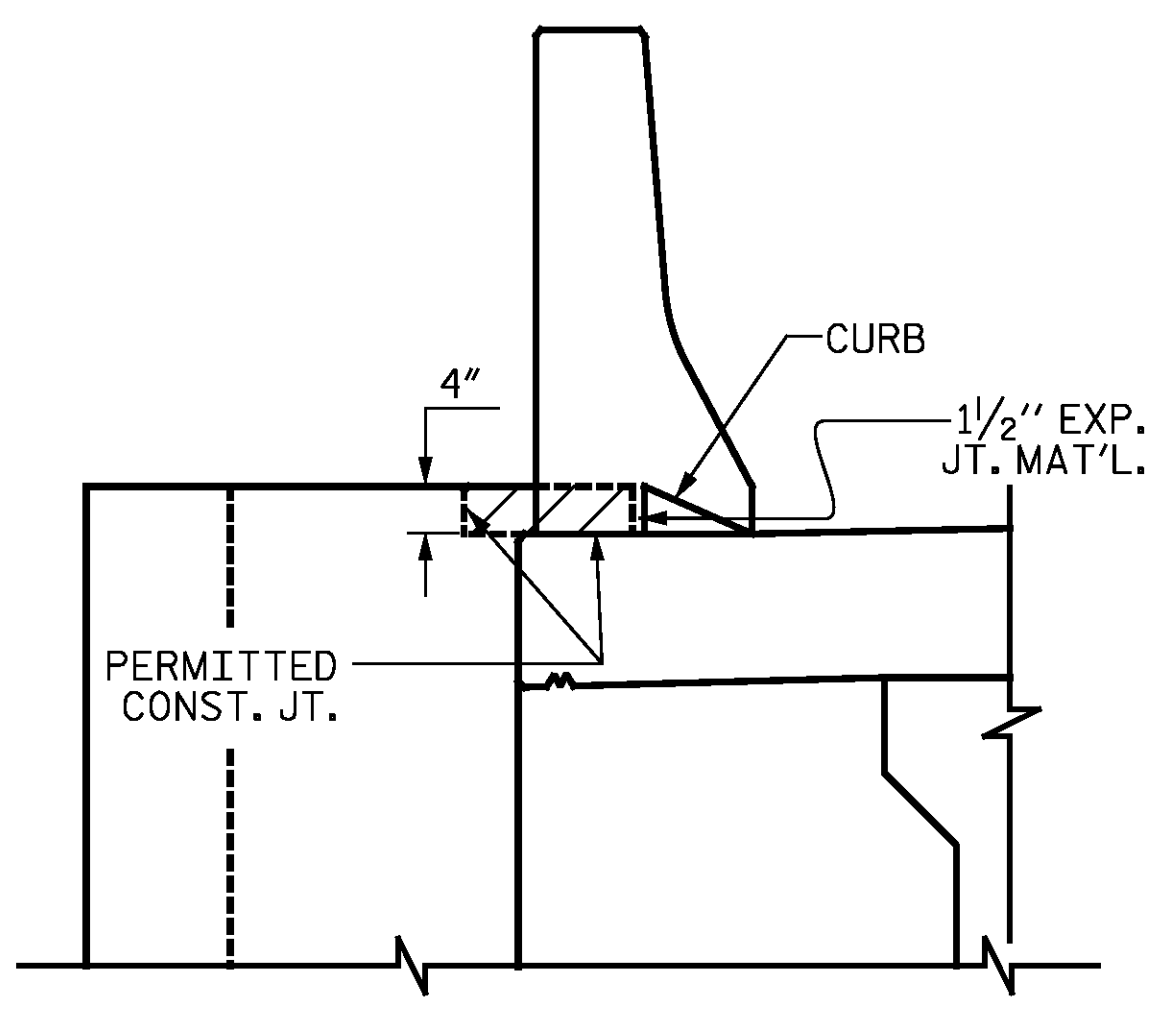

**ELEVATION**

PROJECT NO. R-2514D  
JONES COUNTY  
STATION: 363+38.90 -L-

SHEET 3 OF 3

STATE OF NORTH CAROLINA  
DEPARTMENT OF TRANSPORTATION  
RALEIGH

**SUBSTRUCTURE  
END BENT 1**

RIGHT LANE STR-#4

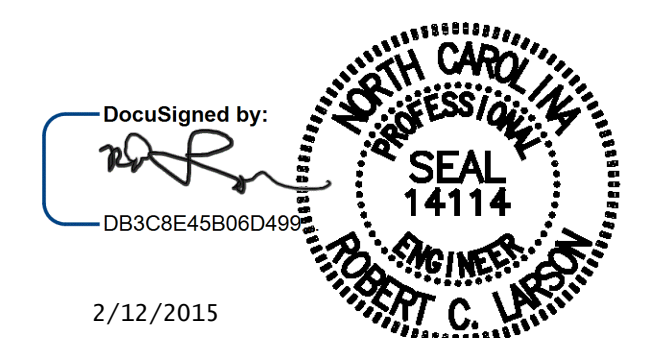

2/12/2015

DocuSigned by:  
R. C. Larson  
DB3C8E45806D499

DESIGN ENGINEER OF RECORD:	DATE: 2/12/2015
DRAWN BY: R. C. LARSON	DATE: 2/28/14
CHECKED BY: R. J. FLORY	DATE: 3/3/14

KCI Associates  
of North Carolina, P.A.  
DWG. REF. NO. 17 OF 23

REVISIONS					
NO.	BY:	DATE:	NO.	BY:	DATE:
1			3		
2			4		

TOTAL SHEETS	S04-17
S04-23	